

(SUBMIT IN TRIPLICATE)

Indian Agency

Jicarilla

Contract #120

Allottee

Lease No.

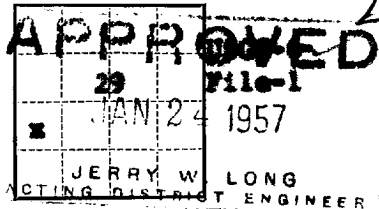
UNITED STATES  
DEPARTMENT OF THE INTERIOR  
GEOLOGICAL SURVEY

## SUNDRY NOTICES AND REPORTS ON WELLS

NOTICE OF INTENTION TO DRILL	<input checked="" type="checkbox"/>	SUBSEQUENT REPORT OF WATER SHUT-OFF	
NOTICE OF INTENTION TO CHANGE PLANS		SUBSEQUENT REPORT OF SHOOTING OR ACIDIZING	
NOTICE OF INTENTION TO TEST WATER SHUT-OFF		SUBSEQUENT REPORT OF ALTERING CASING	
NOTICE OF INTENTION TO REDRILL OR REPAIR WELL		SUBSEQUENT REPORT OF REDRILLING OR REPAIR	
NOTICE OF INTENTION TO SHOOT OR ACIDIZE		SUBSEQUENT REPORT OF ABANDONMENT	
NOTICE OF INTENTION TO PULL OR ALTER CASING		SUPPLEMENTARY WELL HISTORY	
NOTICE OF INTENTION TO ABANDON WELL			

(INDICATE ABOVE BY CHECK MARK NATURE OF REPORT, NOTICE, OR OTHER DATA)

January 22, 1957

Well No. "C" 2-29 is located 1830 ft. from <sup>XXX</sup>[N] line and 870 ft. from <sup>XXX</sup>[E] line of sec. 29

<sup>NE 1/4 SW 1/4</sup> 29 <sup>26N</sup> <sup>4W</sup> <sup>100PM</sup>

<sup>Blanco Mesa Extn. & Wildcat (Graneros-Dakota)</sup> <sup>(Twp.)</sup> <sup>Rio Arriba</sup> <sup>(Range)</sup> <sup>New Mexico</sup> <sup>(Meridian)</sup>

(Field) (County or Subdivision) (State or Territory)

The elevation of the <sup>ungr. ground</sup> derrick floor above sea level is 6775.0 ft.

## DETAILS OF WORK

(State names of and expected depths to objective sands; show sizes, weights, and lengths of proposed casings; indicate mudding jobs, cementing points, and all other important proposed work)

TD 7852'. The Dakota formation has been fractured in open hole from 7800-7852, and thru perfs in the 5" liner fr 7634-72, 7686-7716, 7736-32, 7762-72 and 7780-88. The Graneros has been fractured thru perfs fr 7534-50, 7570-76, 7584-90 & 7610-16. It is proposed to set a BP @ 7525' and perf the 5" liner opposite the Masaverde form fr 4496-5590. The Masaverde will then be fractured in three stages using approx 40,000 gals wtr for each stage. The well will be cleaned out to total depth, 2-3/8" OD tubing will be run with Hookwall packer set @ approx 7504' to separate the Masaverde and the Graneros-Dakota formations. The well will be completed to produce the Graneros-Dakota thru the 2-3/8" tubing and the Masaverde thru the tubing-casing annulus. The W/2 of Section 29, containing 320 acres, is dedicated to the Masaverde formation and the SW/4 of Section 29, containing 160 acres, is dedicated to the Graneros-Dakota formation.

I understand that this plan of work must receive approval in writing by the Geological Survey before operations may be commenced.

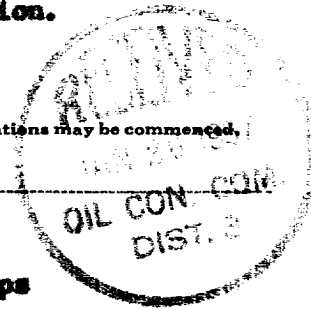
Company **NORTHWEST PRODUCTION CORPORATION**Address **520 Sierra Building****Albuquerque, New Mexico**By **RAY PHILLIPS**  
**Ray Phillips**Title **Asst. Mgr., Prod. Operations**

NEW MEXICO  
OIL CONSERVATION COMMISSION

Form C-128

Well Location and/or Gas Proration Plat

Date January 22, 1957

Operator Northwest Production Corporation Lease 76

Well No. 4-29 Section 29 Township 26 North Range 4 West NMPM

Located 1830 Feet From South Line, 870 Feet From West Line,

Rio Arriba County, New Mexico. G. L. Elevation 6775.0 ungraded

Name of Producing Formation Mesaverde Pool Blanco Estn Dedicated Acreage 320

(Note: All distances must be from outer boundaries of Section)

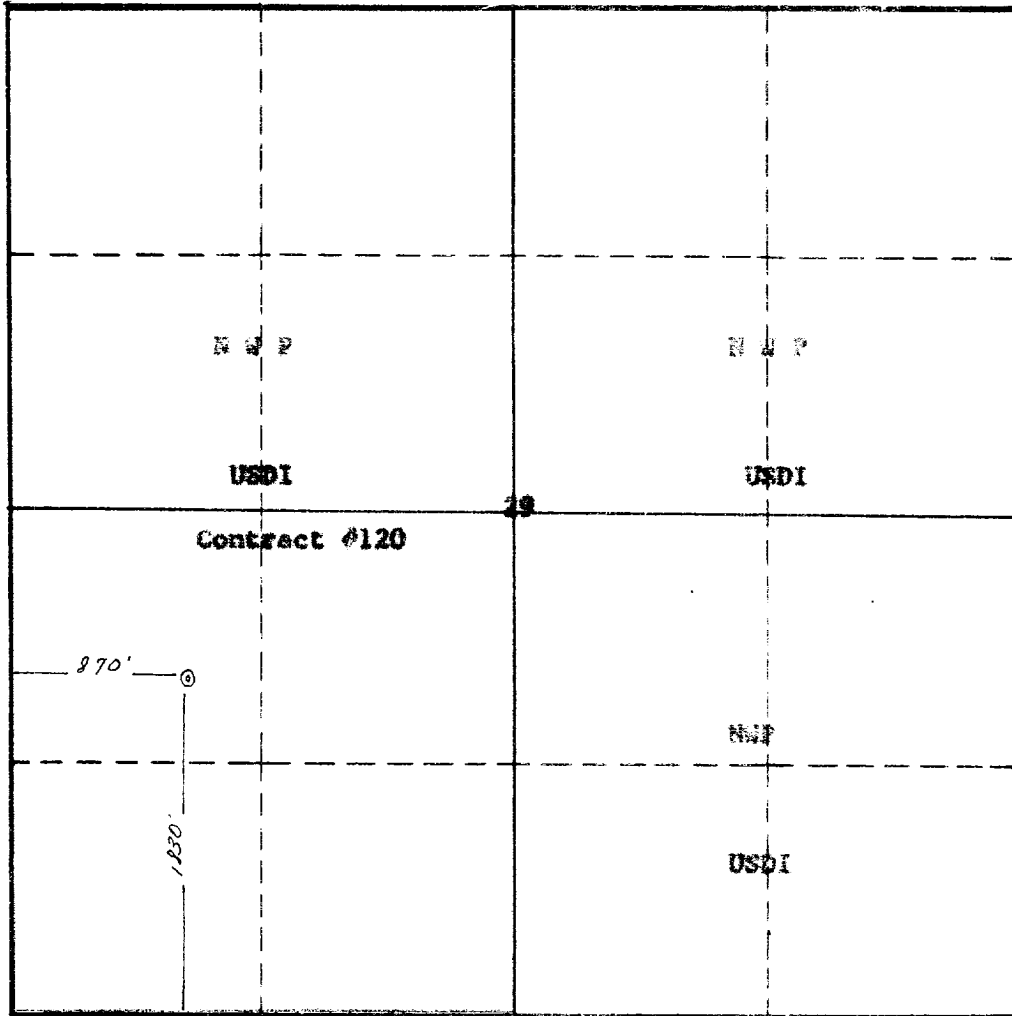

NOTE

This section of  
form is to be  
used for gas  
wells only.



SCALE: 1"=1000'

1. Is this Well a Dual Comp. ? Yes x No   .
2. If the answer to Question 1 is yes, are there any other dually completed wells within the dedicated acreage ? Yes    No x.

This is to certify that the above plat was prepared from field notes of actual surveys made by me or under my supervision and that the same are true and correct to the best of my knowledge and belief.

Name Ray Phillips  
Position Asst. Mgr., Production Operations  
Representing Northwest Production Corporation  
Address 520 S. Main Bldg., Albuquerque, N.M.

Date Surveyed July 26, 1956  
/s/ Ernest V. Eckenbark  
Registered Professional Engineer and/or  
Land Surveyor

NEW MEXICO  
OIL CONSERVATION COMMISSION

Form C-128

Well Location and/or Gas Proration Plat

Date January 22, 1957

Operator Northwest Production Corporation Lease "C"

Well No. 2-29 Section 20 Township 26 North Range 4 West NMPM

Located 1830 Feet From South Line, 870 Feet From West Line,

Rio Arriba County, New Mexico. G. L. Elevation 6775.0 ungraded

Name of Producing Formation Graneros-Bakota Pool Wildcat Dedicated Acreage 160

(Note: All distances must be from outer boundaries of Section)

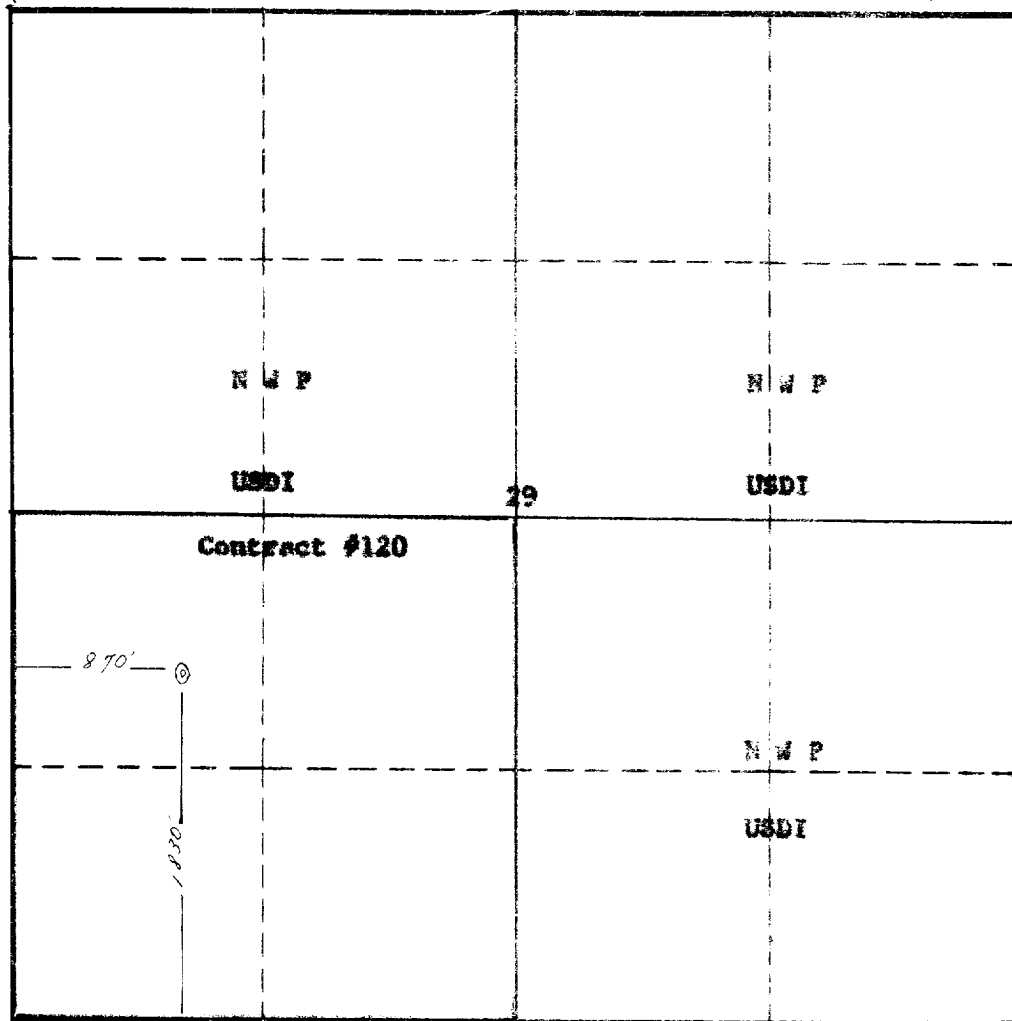

NOTE

This section of  
form is to be  
used for gas  
wells only.



SCALE: 1"=1000'

1. Is this Well a Dual Comp. ? Yes ☒ No ☐.
2. If the answer to Question 1 is yes, are there any other dually completed wells within the dedicated acreage ? Yes ☐ No ☒.

RAY PHILLIPS

Name Ray Phillips  
Position Asst. Mgr., Production Operations  
Representing Northwest Production Corporation  
Address 520 Sims Building, Albuquerque, N.M.

This is to certify that the above plat was prepared from field notes of actual surveys made by me or under my supervision and that the same are true and correct to the best of my knowledge and belief.

Date Surveyed July 26, 1956  
/s/ Ernest V. Schohawk  
Registered Professional Engineer and/or  
Land Surveyor