

COPY TO O. C. C.

STATE OF NEW MEXICO
OIL CONSERVATION
COMMISSION

DISTRICT NO. 3
Phone 99 P. O. Box 697
AZTEC, NEW MEXICO

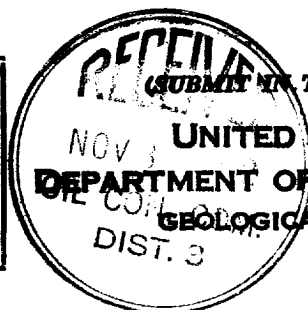

New Mexico
Land Office 079263 (S.F.)
Lease No. 1
Unit SW 1/4 Sec. 30, T26N., R6W.

SUNDRY NOTICES AND REPORTS ON WELLS

NOTICE OF INTENTION TO DRILL	<input checked="" type="checkbox"/>	SUBSEQUENT REPORT OF WATER SHUT-OFF	
NOTICE OF INTENTION TO CHANGE PLANS		SUBSEQUENT REPORT OF SHOOTING OR ACIDIZING	
NOTICE OF INTENTION TO TEST WATER SHUT-OFF		SUBSEQUENT REPORT OF ALTERING CASING	
NOTICE OF INTENTION TO RE-DRILL OR REPAIR WELL		SUBSEQUENT REPORT OF REDRILLING OR REPAIR	
NOTICE OF INTENTION TO SHOOT OR ACIDIZE		SUBSEQUENT REPORT OF ABANDONMENT	
NOTICE OF INTENTION TO PULL OR ALTER CASING		SUPPLEMENTARY WELL HISTORY	
NOTICE OF INTENTION TO ABANDON WELL			

(INDICATE ABOVE BY CHECK MARK NATURE OF REPORT, NOTICE, OR OTHER DATA)

October 20, 1952, 19

Well No. 1 Klein is located 1650 ft. from [N] line and 890 ft. from [E] line of sec. 30
SW 1/4 Section 30 26 North 6 West N.M.P.M.
(1/4 Sec. and Sec. No.) (Twp.) (Range) (Meridian)
Wildcat Dag's Canyon (ext.) Rio Arriba County, New Mexico
(Field) (County or Subdivision) (State or Territory)

The elevation of the derrick floor above sea level is _____ ft. - To be furnished

DETAILS OF WORK

(State names of and expected depths to objective sands; show sizes, weights, and lengths of proposed casings; indicate mudlogging jobs, cementing points, and all other important proposed work)

The objective sand is the Pictured Cliffs. It is expected at about 2300'. The casing program is as follows:

200' of 8-5/8" O.D. cemented to surface.
2300' of 5 1/2" O.D. cemented with 50 sacks.

Well will be drilled with rotary tools to top of Pictured Cliffs sand and at this point 5 1/2" casing will be set. The pay zone will be drilled with cable tools to a depth of approximately 2425'.

The well will be shot with approximately 150 quarts of nitro from 2350' to total depth.

A 1" siphon line will be installed to total depth.

I understand that this plan of work must receive approval in writing by the Geological Survey before operations may be commenced.

Company Wofford Cain, an individual

Address c/o Van Thompson

1009 Burt Building

Dallas 1, Texas

Wofford Cain

By Van Thompson
Van Thompson

Title Agent

RECEIVED
OCT 22 1952

U. S. GEOLOGICAL SURVEY
FARMINGTON, N. M.

Land Office
 License No.
 Unit

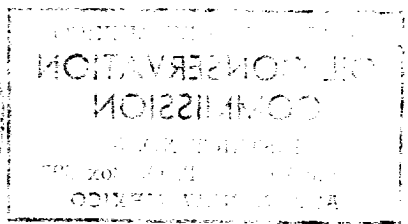
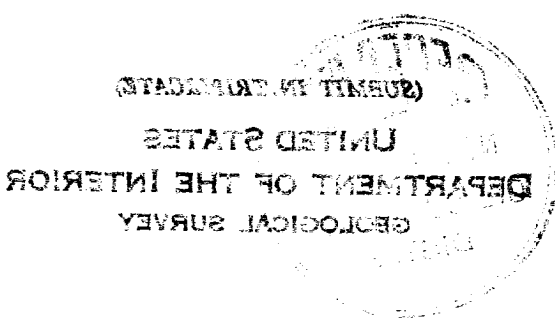

SUNDRY NOTICES AND REPORTS ON WELLS

NOTICE OF INTENTION TO DRILL	
NOTICE OF INTENTION TO CHANGE DEPTH	
NOTICE OF INTENTION TO TEST WATER SHUT-OFF	
NOTICE OF INTENTION TO REPAIR OR REGRIND	
NOTICE OF INTENTION TO SHUT OR ABANDON	
NOTICE OF INTENTION TO PULL OR ALTER CASING	
NOTICE OF INTENTION TO ABANDON WELL	
SUPPLEMENTARY WELL HISTORY	
SUBSEQUENT REPORT OF ABANDONMENT	
SUBSEQUENT REPORT OF REGRINDING OR REPAIR	
SUBSEQUENT REPORT OF ALTERING CASING	
SUBSEQUENT REPORT OF SHUTTING OR ABANDONING	
SUBSEQUENT REPORT OF WATER SHUT-OFF	

(INDICATE ABOVE BY CHECKING IN APPROPRIATE REPORT, NOTICE OR OTHER DATA)

Well No. _____ is located _____ ft. from _____ line and _____ ft. from _____ line of sec. _____

Section _____ Township _____ Range _____

County _____ State _____

Owner _____

Operator _____

Driller _____

Geologist _____

DETAILS OF WORK

The objective of this work is to _____

The work was done on _____

Company _____

Address _____

City _____ State _____

By _____

Title _____

Company.....Wofford Cain.....
 Lease.....~~State~~.....Well No.....~~1~~.....
 Sec.....30....., T. 26 N....., R. 6 W.....N.M.P.M.....
 Location.....1650' from the North line and 890' from
 the West line.....
 Elevation.....

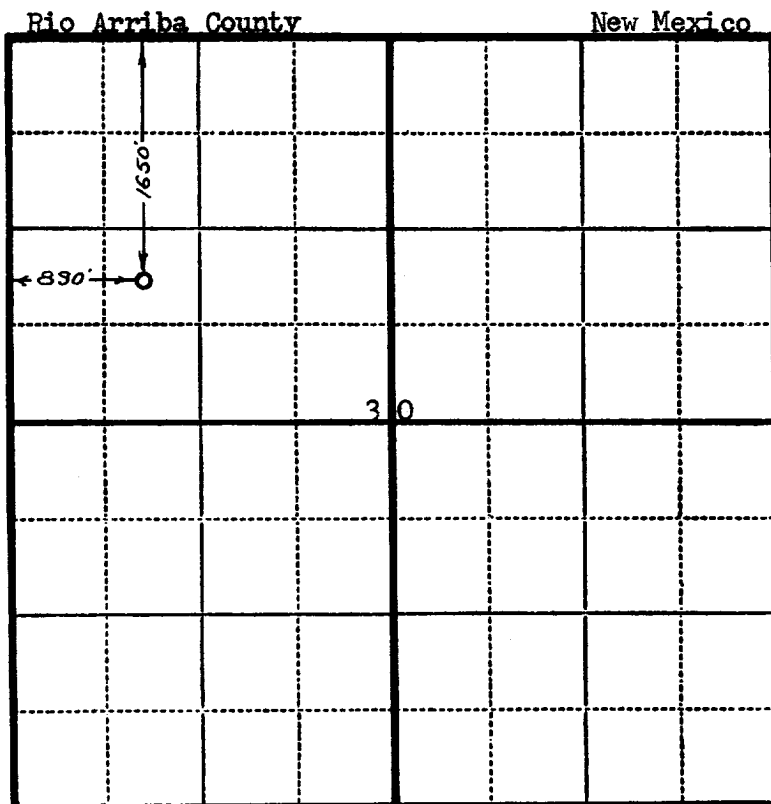

Scale—4 inches equal 1 mile.

This is to certify that the above plat was prepared from field notes of actual surveys made by me or under my supervision and that the same are true and correct to the best of my knowledge and belief.

Charles J. Finklea

Seal:

Registered Professional
 Engineer and Land Surveyor.

Charles J. Finklea
 N. Mex. Reg. No, 1302

Surveyed.....10 October....., 19⁵².....

RECEIVED

OCT 22 1952

U. S. GEOLOGICAL SURVEY
 FARMINGTON, N. M.

NEW MEXICO
OIL CONSERVATION COMMISSION

Gas Well Plat

Date March 10, 1954

El Paso Natural Gas Company

Klein

1

Operator

Lease

Well No.

Name of Producing Formation Pictured Cliffs Pool Debie Canyon Ext

No. Acres Dedicated to the Well 160

Indicate land status and show ownership. Federal

SECTION 30 TOWNSHIP 26N RANGE 6W

S. F. 079265			

I hereby certify that the information given above is true and complete to the best of my knowledge.

Name _____

Position Petroleum Engineer

Representing El Paso Natural Gas Company

Address Box 197, Farmington, New Mexico

(over)

OIL CONSERVATION COMMISSION		
AZTEC DISTRICT OFFICE		
No. Copies Received <u>3</u>		
DISTRIBUTION		
	NO. FURNISHED	
Operator		
Santa Fe	<u>1</u>	
Proration Office		
State Land Office		
U. S. G. S.	<u>1</u>	
Transporter		
File	<u>1</u>	<input checked="" type="checkbox"/>