

(SUBMIT IN TRIPLICATE)

UNITED STATES
DEPARTMENT OF THE INTERIOR
GEOLOGICAL SURVEY

Land Office **Santa Fe**
Lease No. **27 079285**
Unit _____

SUNDRY NOTICES AND REPORTS ON WELLS

NOTICE OF INTENTION TO DRILL	<input checked="" type="checkbox"/>	SUBSEQUENT REPORT OF WATER SHUT-OFF	
NOTICE OF INTENTION TO CHANGE PLANS		SUBSEQUENT REPORT OF SHOOTING OR ACIDIZING	
NOTICE OF INTENTION TO TEST WATER SHUT-OFF		SUBSEQUENT REPORT OF ALTERING CASING	
NOTICE OF INTENTION TO RE-DRILL OR REPAIR WELL		SUBSEQUENT REPORT OF RE-DRILLING OR REPAIR	
NOTICE OF INTENTION TO SHOOT OR ACIDIZE		SUBSEQUENT REPORT OF ABANDONMENT	
NOTICE OF INTENTION TO PULL OR ALTER CASING		SUPPLEMENTARY WELL HISTORY	
NOTICE OF INTENTION TO ABANDON WELL			

(INDICATE ABOVE BY CHECK MARK NATURE OF REPORT, NOTICE, OR OTHER DATA)

February 24, 19 **60**

INTEX-SOUTH FERN SURC USL

Well No. **1-27** is located **660** ft. from **[N]** line and **1980** ft. from **[W]** line of sec. **27**

N2/4 of NW/4
(¼ Sec. and Sec. No.)

25 N R 1 E
(Twp.) (Range)

T.T.P.M.
(Meridian)

Puerto Chiquita
(Field)

Rio Arriba
(County or Subdivision)

New Mexico
(State or Territory)

The elevation of the derrick floor above sea level is **5000** ft.

DETAILS OF WORK

(State names of and expected depths to objective sands; show sizes, weights, and lengths of proposed casings; indicate mudlogging jobs, cementing points, and all other important proposed work)

Drill to approximately 2800' with cable tools.
9 5/8" casing cemented at 700'± with 50 sbs and subsequently smaller strings to 3 1/2" casing as required to T. D.
The Greenhorn Lima will be tested on this well.



I understand that this plan of work must receive approval in writing by the Geological Survey before operations may be commenced.

Company **INTEX OIL COMPANY**

Address **P.O. Box 1411**

Bakersfield, California

FA 4-4936

By **H. C. Miller**
H. C. Miller
Title **Petroleum Engineer**

100-100000-100000

100-100000-100000

100-100000-100000

100-100000-100000

100-100000-100000

100-100000-100000

100-100000-100000

100-100000-100000

100-100000-100000

100-100000-100000

100-100000-100000

100-100000-100000

100-100000-100000

100-100000-100000

100-100000-100000

100-100000-100000

100-100000-100000

100-100000-100000

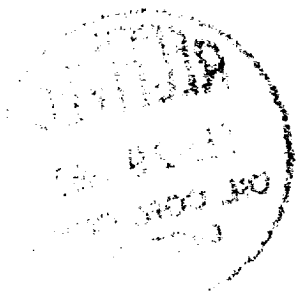

100-100000-100000

100-100000-100000

100-100000-100000

100-100000-100000

100-100000-100000

100-100000-100000

100-100000-100000

NEW MEXICO OIL CONSERVATION COMMISSION
WELL LOCATION AND ACREAGE DEDICATION PLAT

FORM C-128
 Revised 5/1/57

SEE INSTRUCTIONS FOR COMPLETING THIS FORM ON THE REVERSE SIDE

SECTION A

Operator INTEX OIL COMPANY			Lease DURO U.S.L.		Well No. 1
Unit Letter C	Section 27	Township 26 NORTH	Range 1 EAST N.M.P.M.	County RIO ARriba	
Actual Footage Location of Well: 660 feet from the NORTH line and 1980 feet from the WEST line					
Ground Level Elev. 7301.0	Producing Formation		Pool		Dedicated Acreage: 40 Acres

Ref. GLO Plat dated: July 12, 1918

1. Is the Operator the only owner in the dedicated acreage outlined on the plat below? YES _____ NO _____. ("Owner" means the person who has the right to drill into and to produce from any pool and to appropriate the production either for himself or for himself and another. (65-3-29 (e) NMSA 1935 Comp.)
2. If the answer to question one is "no," have the interests of all the owners been consolidated by communication agreement or otherwise? YES _____ NO _____. If answer is "yes," Type of Consolidation _____
3. If the answer to question two is "no," list all the owners and their respective interests below:

Owner	Land Description

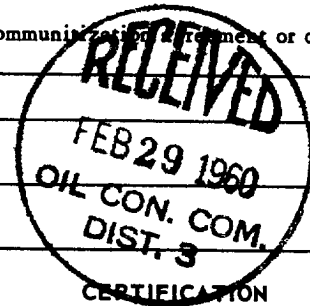

SECTION B

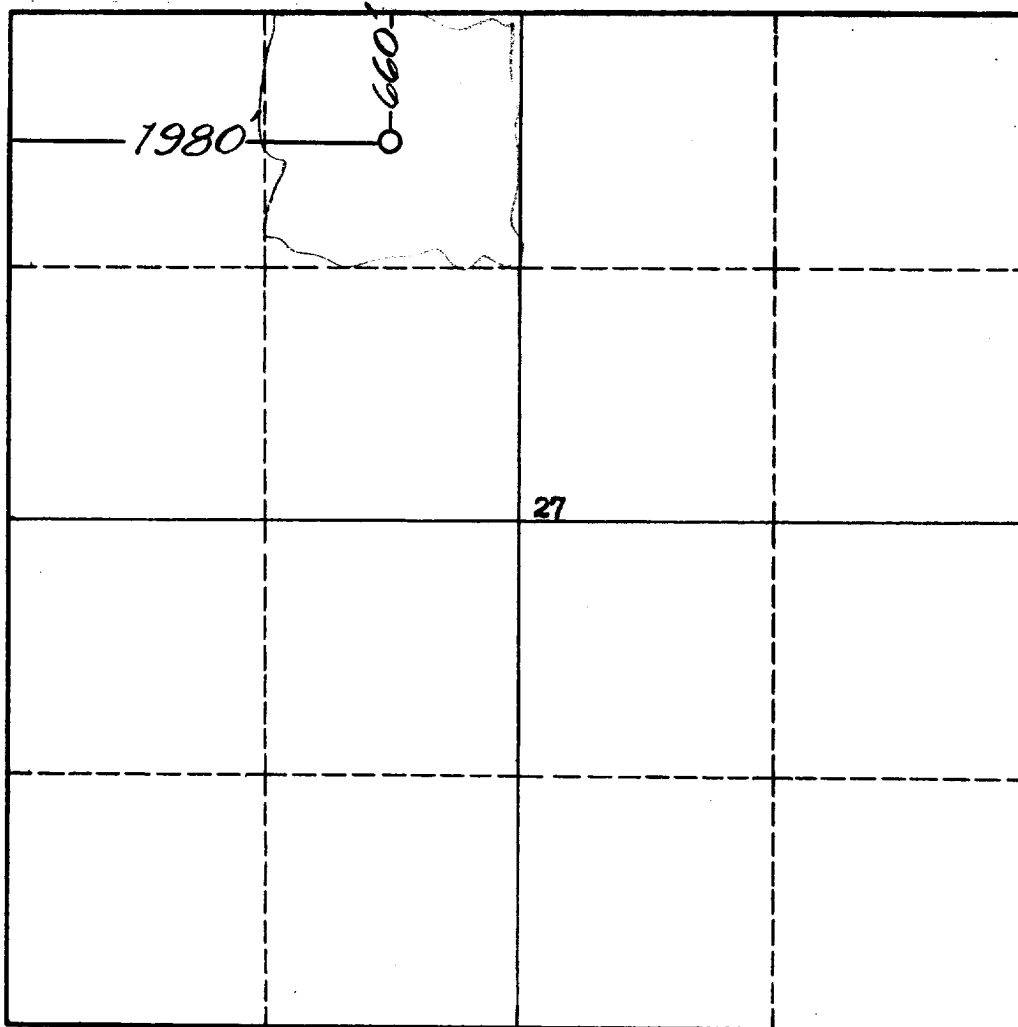

I hereby certify that the information in SECTION A above is true and complete to the best of my knowledge and belief.

H. O. Miller

Name H. O. Miller
Position Petroleum Engineer
Company Intex Oil Company
Date 2-24-60

I hereby certify that the well location shown on the plat in SECTION B was plotted from field notes of actual surveys made by me or under my supervision, and that the same is true and correct to the best of my knowledge and belief.

Date Surveyed Feb. 29, 1960
Registered Professional Engineer and/or Land Surveyor James P. Leese
Certificate No. 1463

0 330 660 990 1320 1650 1980 2310 2640 2000 1500 1000 500 0

INSTRUCTIONS FOR COMPLETION OF FORM C-128

1. Operator shall furnish and certify to the information called for in Section A.
2. Operator shall outline the dedicated acreage for *both* oil and gas wells on the plat in Section B.
3. A registered professional engineer or land surveyor registered in the State of New Mexico or approved by the Commission shall show on the plat the location of the well and certify this information in the space provided.
4. All distances shown on the plat must be from the outer boundaries of the Section.
5. If additional space is needed for listing owners and their respective interests as required in question 3 of Section A, please use space below.