

(SUBMIT IN TRIPLICATE)

UNITED STATES
DEPARTMENT OF THE INTERIOR
GEOLOGICAL SURVEY

Land Office Santa Fe
Lease No. 079266
Unit Vaughn

SUNDRY NOTICES AND REPORTS ON WELLS

NOTICE OF INTENTION TO DRILL	<input checked="" type="checkbox"/>	SUBSEQUENT REPORT OF WATER SHUT-OFF	
NOTICE OF INTENTION TO CHANGE PLANS		SUBSEQUENT REPORT OF SHOOTING OR ACIDIZING	
NOTICE OF INTENTION TO TEST WATER SHUT-OFF		SUBSEQUENT REPORT OF ALTERING CASING	
NOTICE OF INTENTION TO RE-DRILL OR REPAIR WELL		SUBSEQUENT REPORT OF RE-DRILLING OR REPAIR	
NOTICE OF INTENTION TO SHOOT OR ACIDIZE		SUBSEQUENT REPORT OF ABANDONMENT	
NOTICE OF INTENTION TO PULL OR ALTER CASING		SUPPLEMENTARY WELL HISTORY	
NOTICE OF INTENTION TO ABANDON WELL			

(INDICATE ABOVE BY CHECK MARK NATURE OF REPORT, NOTICE, OR OTHER DATA)

May 21, 1957

Well No. 3 is located 1650 ft. from N line and 1650 ft. from W line of sec. 26

NW Section 26 26N 6W H.M.I.N.
($\frac{1}{4}$ Sec. and Sec. No.) (Twp.) (Range) (Meridian)
So. Blanco P.C. Rio Arriba New Mexico
(Field) (County or Subdivision) (State or Territory)

The elevation of the derrick floor above sea level is 6349 ft.

DETAILS OF WORK

(State names of and expected depths to objective sands; show sizes, weights, and lengths of proposed casings; indicate mudding jobs, cementing points, and all other important proposed work)

It is intended to drill a well thru the Pictured Cliffs formation using rotary tools and to perforate and water fracture possible producing zones. Estimated Total Depth 2740'.

Casing Program:

9-5/8" at 120' with 125 sacks regular cement to surface.
5-1/2" at 2740' with 75 sacks regular cement to mix.

The NW/4 of Section 26 is dedicated to this well.
SP 079266, NW/4.



I understand that this plan of work must receive approval in writing by the Geological Survey before operations may be commenced.

Company El Paso Natural Gas Company

Address Box 997

Farmington, New Mexico

By Original Signed D. G. Johnston

Title Petroleum Engineer

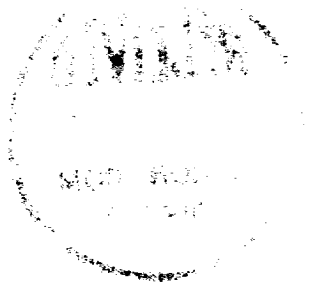

NEW MEXICO
OIL CONSERVATION COMMISSION

WELL LOCATION AND OR LACERATION PLAT

MAY 13, 1957

EL PASO NATURAL GAS COMPANY

VAUGHN

SF 079266

3

26

26-N

6-W

1650

NORTH

1650

WEST

RIO ARRIBA

6339

PICTURED CLIFF

SO. BLANCO

160 ACRES
(1882 PLAT)

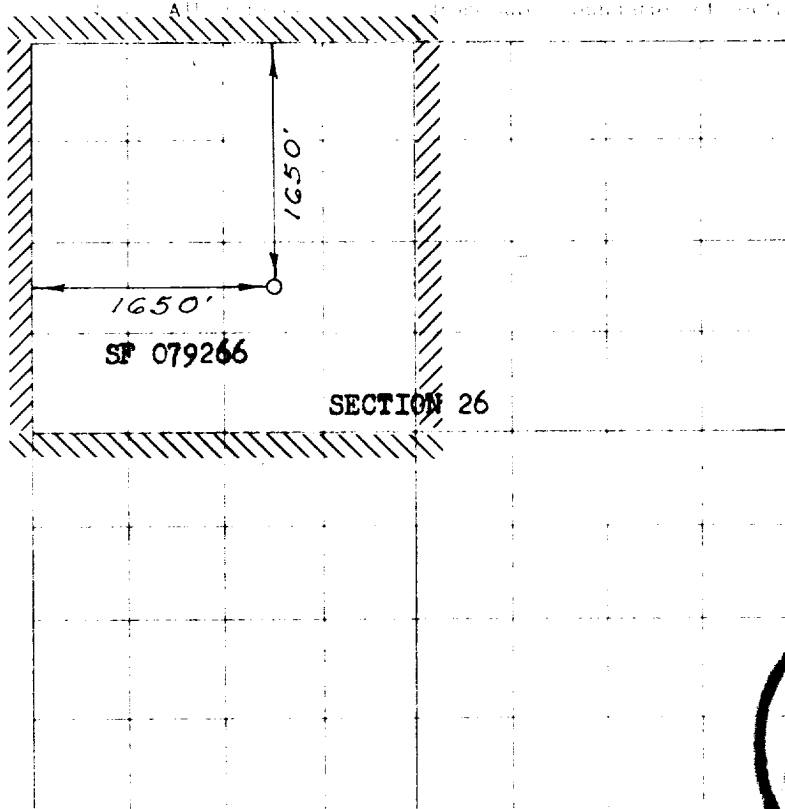

Section 26, T26N, R3E, S4E

I hereby certify that the above plat was prepared by me or under my direct supervision and that the same are true and correct to the best of my knowledge and belief.

Date Surveyed: APRIL 30, 1957

C. O. Walker

Registered Professional Engineer and/or Land Surveyor

1. Is this well a Dual Core? Yes ☐ No ☒
2. If the answer to question 1 is yes, are there any other fully completed wells within the adjacent location? Yes ☐ No ☐

Original Signed D. C. John

Position: Petroleum Engineer

Representing: El Paso Natural Gas

Address: Box 997, Farmington, N.M.