

Section 19

(SUBMIT IN TRIPPLICATE)

Indian Agency Alvarilla Tribal

Contract # 98

UNITED STATES
DEPARTMENT OF THE INTERIOR
GEOLOGICAL SURVEY

Allottee _____

Lease No. Alvarilla #1

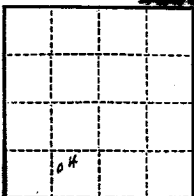

SUNDRY NOTICES AND REPORTS ON WELLS

NOTICE OF INTENTION TO DRILL _____	<input checked="" type="checkbox"/>	SUBSEQUENT REPORT OF WATER SHUT-OFF _____	
NOTICE OF INTENTION TO CHANGE PLANS _____		SUBSEQUENT REPORT OF SHOOTING OR ACIDIZING _____	
NOTICE OF INTENTION TO TEST WATER SHUT-OFF _____		SUBSEQUENT REPORT OF ALTERING CASING _____	
NOTICE OF INTENTION TO REDRILL OR REPAIR WELL _____		SUBSEQUENT REPORT OF REDRILLING OR REPAIRING _____	
NOTICE OF INTENTION TO SHOOT OR ACIDIZE _____		SUBSEQUENT REPORT OF ABANDONMENT _____	
NOTICE OF INTENTION TO PULL OR ALTER CASING _____		SUPPLEMENTARY WELL HISTORY _____	
NOTICE OF INTENTION TO ABANDON WELL _____			

(INDICATE ABOVE BY CHECK MARK NATURE OF REPORT, NOTICE, OR OTHER DATA)

August 7, 1957

Well No. A is located 932 ft. from N line and 1320 ft. from W line of sec. 19

Section 19 (4 Sec. and Sec. No.) 26-2 (Twp.) 3-2 (Range) R. 2, E. 2, N. (Meridian)

Alvarilla, N.V. (Field) Nio Arriba (County or Subdivision) New Mexico (State or Territory)

The elevation of the derrick floor above sea level is 7127 ft.

DETAILS OF WORK

(State names of and expected depths to objective sands; show sizes, weights, and lengths of proposed casings; indicate mudding, cementing points, and all other important proposed work)

We propose to drill the above well to a total depth of 6400' with rotary tools. We expect to test the following zones at the following approximate depth.

MD ALVARILLA
Mesa Verde 6400'

We expect to test any other zones that appear productive of oil or gas.
CASING PROGRAM: Approximately 300' of 10-3/4" Surface Casing w/ approximately 300 oz cement, approximately 1500' of 7-5/8" Intermediate Casing w/ approximately 150 oz cement, approximately 2100' of 5 1/2" Liner w/ approximately 200 oz cement on bottom & will squeeze top of 5 1/2" Liner w/ approximately 300 oz cement. We propose to perforate and sandblast from the Mesa Verde zone for completion.

I understand that this plan of work must receive approval in writing by the Geological Survey before operations may be commenced.

Company MAGNOLIA ENTERPRISE COMPANY

Address P.O. BOX 633

ALVARILLA, TEXAS

By [Signature]
E. F. GIBSON
Title Division Superintendent

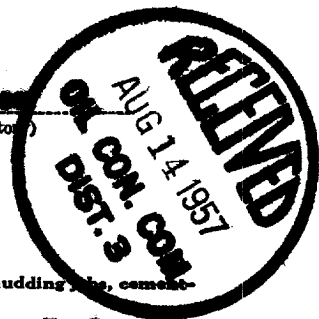

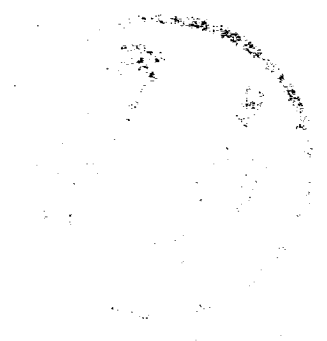

NEW MEXICO OIL CONSERVATION COMMISSION
Well Location and Acreage Dedication Plat

Section A.

Date August 1, 1957

Operator MAGNOLIA PETROLEUM COMPANY Lease JICARILLA "B"
Well No. 4 Unit Letter _____ Section 19 Township 26N Range 3W NMPM
Located 1500 Feet From West Line, 990 Feet From South Line
County Rio Arriba G. L. Elevation 7187 Dedicated Acreage 320 Acres
Name of Producing Formation Mesa Verde Pool Extension of Blanco

1. Is the Operator the only owner* in the dedicated acreage outlined on the plat below?
Yes No _____.
2. If the answer to question one is "no," have the interests of all the owners been consolidated by communitization agreement or otherwise? Yes _____ No _____. If answer is "yes," Type of Consolidation _____
3. If the answer to question two is "no," list all the owners and their respective interests below:

Owner

Land Description

RECEIVED

AUG 1 1957

U. S. GEOLOGICAL SURVEY
FARMINGTON, NEW MEXICO

Section B.

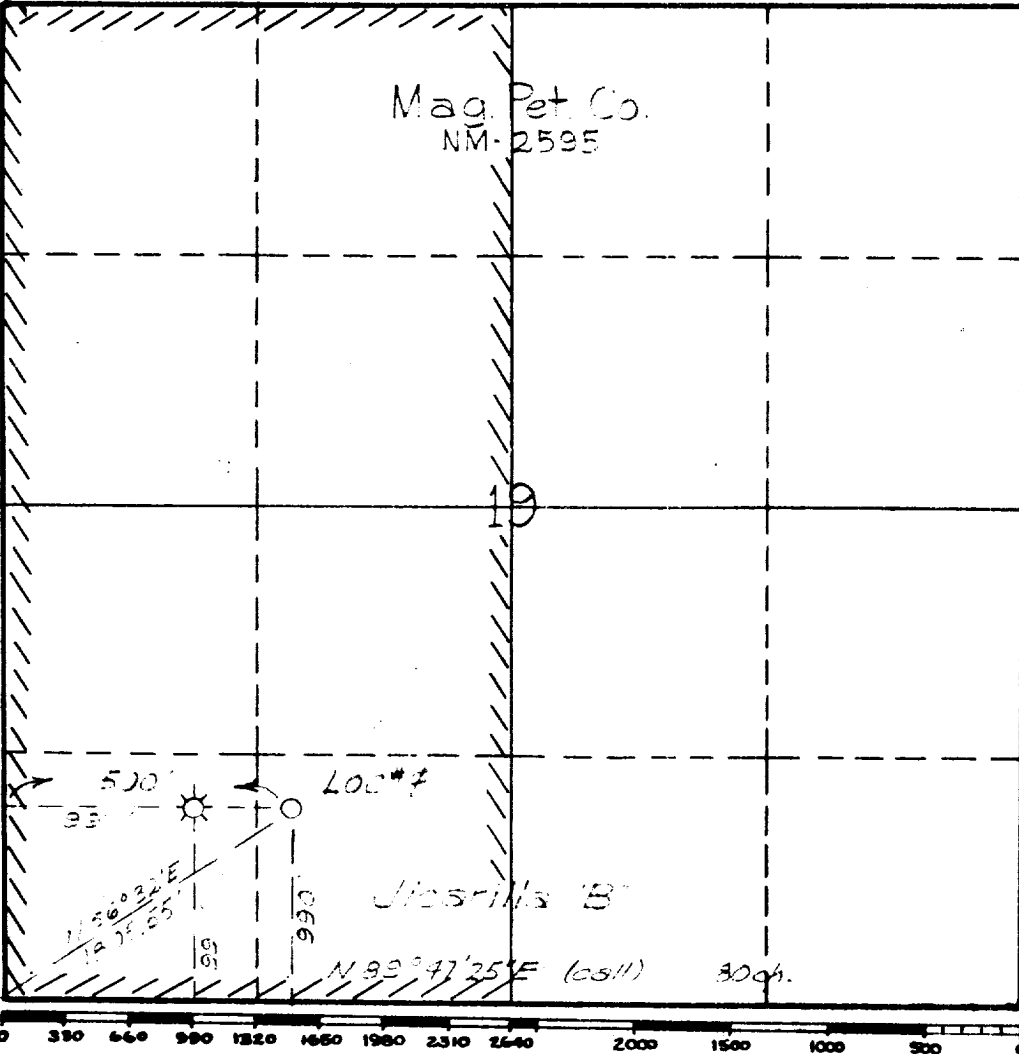

This is to certify that the information in Section A above is true and complete to the best of my knowledge and belief.

Magnolia Petroleum Company
(Operator)

[Signature]
(Representative) R. T. GERMAN
Division Superintendent
Box 633 Midland, Texas
Address

This is to certify that the well location shown on the plat in Section B was plotted from field notes of actual surveys made by me or under my supervision and that the same is true and correct to the best of my knowledge and belief.

Date Surveyed July 28, 1957
[Signature]
Registered Professional
Engineer and/or Land Surveyor.

Certificate No. 2490

1

Handwritten notes or markings, possibly including a date and some illegible text.

