

NEW MEXICO OIL CONSERVATION COMMISSION
Well Location and Acreage Dedication Plat

Section A.

Date June 18, 1958

Operator MAGNOLIA PETROLEUM COMPANY Lease JICARILLA "B"
Well No. 3 Unit Letter Section 20 Township 26N Range 3W NMPM
Located 1190 Feet From West Line, 990 Feet From South Line
County Rio Arriba G. L. Elevation 7114 Dedicated Acreage 160 Acres
Name of Producing Formation Pictured Cliffs Pool Tasasito Pictured Cliffs Gas

1. Is the Operator the only owner* in the dedicated acreage outlined on the plat below?
Yes X No .
2. If the answer to question one is "no," have the interests of all the owners been consolidated by communitization agreement or otherwise? Yes No . If answer is "yes," Type of Consolidation
3. If the answer to question two is "no," list all the owners and their respective interests below:

Owner

Land Description

Section B.

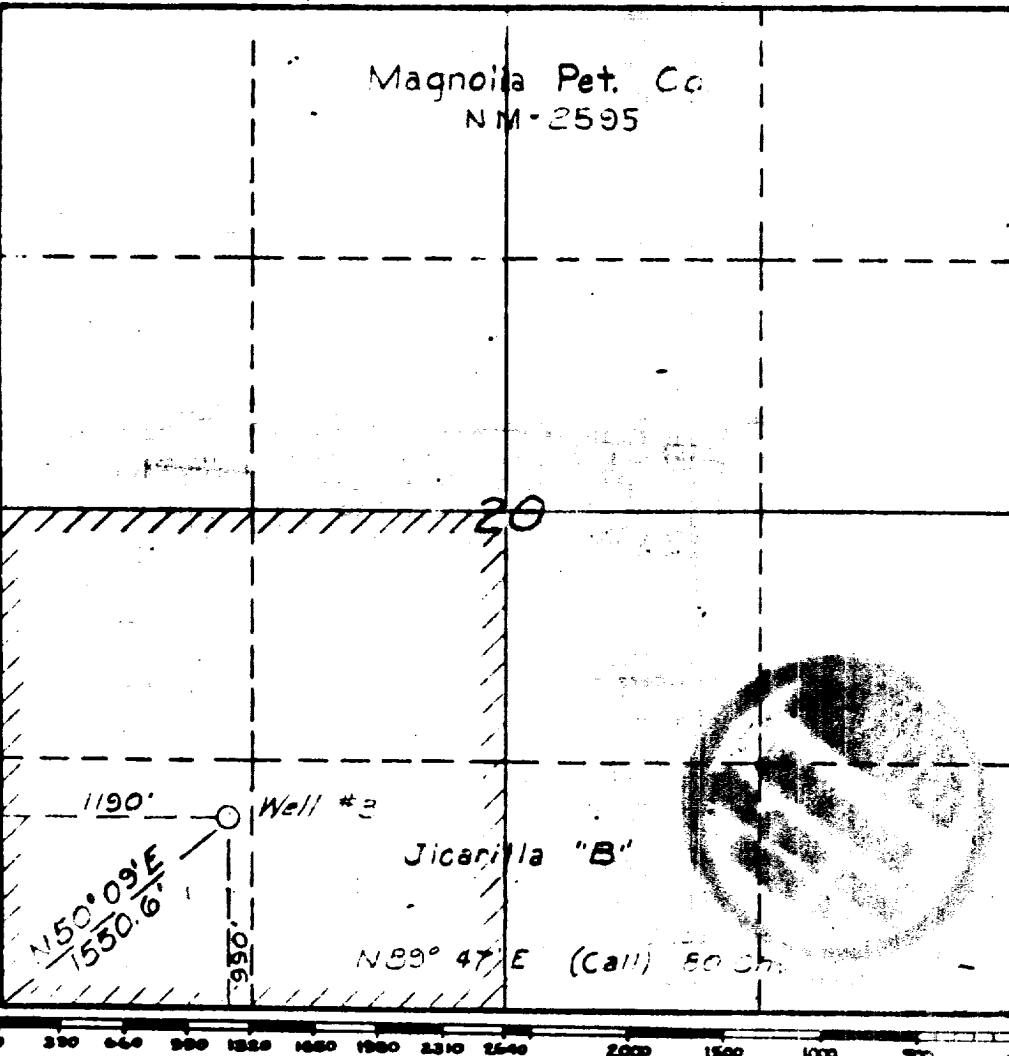

This is to certify that the information in Section A above is true and complete to the best of my knowledge and belief.

MAGNOLIA PETROLEUM COMPANY
(Operator)

W. Young, Jr.
(Representative)

Box 2406, Hobbs, New Mexico
Address

This is to certify that the well location shown on the plat in Section B was plotted from field notes of actual surveys made by me or under my supervision and that the same is true and correct to the best of my knowledge and belief.

Date Surveyed 7-25-57

Carl E. Turner
Registered Professional
Engineer and/or Land Surveyor
2402

Certificate No.

