

STATE OF NEW MEXICO
OIL CONSERVATION
COMMISSION
DISTRICT NO. 3
Phone 99 P. O. Box 697
AZTEC, NEW MEXICO

(SUBMIT IN TRIPLICATE)
UNITED STATES
DEPARTMENT OF THE INTERIOR
GEOLOGICAL SURVEY

Land Office Santa Fe
Lease No. 079295
Unit SW 1/4 Sec. 19

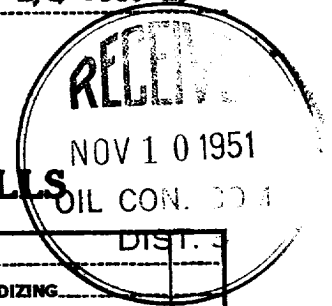

SUNDRY NOTICES AND REPORTS ON WELLS

	<input checked="" type="checkbox"/>		DIST. 3
NOTICE OF INTENTION TO DRILL		SUBSEQUENT REPORT OF WATER SHUT-OFF	
NOTICE OF INTENTION TO CHANGE PLANS		SUBSEQUENT REPORT OF SHOOTING OR ACIDIZING	
NOTICE OF INTENTION TO TEST WATER SHUT-OFF		SUBSEQUENT REPORT OF ALTERING CASING	
NOTICE OF INTENTION TO RE-DRILL OR REPAIR WELL		SUBSEQUENT REPORT OF REDRILLING OR REPAIR	
NOTICE OF INTENTION TO SHOOT OR ACIDIZE		SUBSEQUENT REPORT OF ABANDONMENT	
NOTICE OF INTENTION TO PULL OR ALTER CASING		SUPPLEMENTARY WELL HISTORY	
NOTICE OF INTENTION TO ABANDON WELL			

(INDICATE ABOVE BY CHECK MARK NATURE OF REPORT, NOTICE, OR OTHER DATA)

November 8, 1951

Ora E. Reames
Well No. #1 is located 990 ft. from S line and 890 ft. from W line of sec. 19

SW 1/4 of Sec. 19 T-26-N R-6-W NMPM
(1/4 Sec. and Sec. No.) (Twp.) (Range) (Meridian)
Wildcat Rio Arriba New Mexico
(Field) (County or Subdivision) (State or Territory)

The elevation of the derrick floor above sea level is _____ ft. (Will Be furnished later)

DETAILS OF WORK

(State names of and expected depths to objective sands; show sizes, weights, and lengths of proposed casings; indicate mudding jobs, cementing points, and all other important proposed work)

We propose to drill with rotary tools to top of Picture Cliff formation set $5\frac{1}{2}$ casing, then move in Cable Rig to drill in, then shoot with SNG. for gas completion in Picture cliff.

Casing Program :

100' of 9 5/8" surface—circulate cement to surface.
2600' of 5 1/2" production string—cement with 200 sacks.
2700' of 1" siphon line.

I understand that this plan of work must receive approval in writing by the Geological Survey before operations may be commenced.

Company Delhi Oil Corporation

Address P. O. Box 1175

Farmington, N. M.

By J. B. Howell
J. B. Howell
Title Superintendent

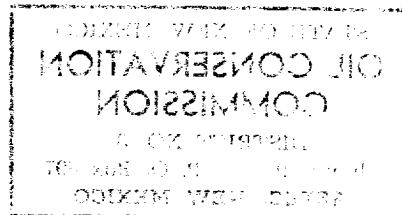

(SUBMIT IN TRIPLICATE)
UNITED STATES
DEPARTMENT OF THE INTERIOR
GEOLOGICAL SURVEY

Land Office _____
License No. _____
Unit _____

SUNDRY NOTICES AND REPORTS ON WELLS

NOTICE OF INTENTION TO DRILL	SUBSEQUENT REPORT OF WATER SHUT-OFF
NOTICE OF INTENTION TO CHANGE PLANS	SUBSEQUENT REPORT OF SHOOTING OR ACIDIZING
NOTICE OF INTENTION TO TEST WATER SHUT-OFF	SUBSEQUENT REPORT OF ALTERING CASING
NOTICE OF INTENTION TO REDRILL OR REPAIR WELL	SUBSEQUENT REPORT OF REDRILLING OR REPAIR
NOTICE OF INTENTION TO SHOOT OR ACIDIZE	SUBSEQUENT REPORT OF ABANDONMENT
NOTICE OF INTENTION TO PULL OR ALTER CASING	SUPPLEMENTARY WELL HISTORY
NOTICE OF INTENTION TO ABANDON WELL	

(INDICATE ABOVE BY CHECK MARK NATURE OF REPORT, NOTICE OR OTHER DATA)

Well No. _____ is located _____ ft. from _____ line and _____ ft. from _____ line of section _____
_____ (Twp.) _____ (Range) _____ (Meridian)
_____ (State or Territory) _____ (County or Subdivision) _____ (Twp.)

The elevation of the derrick floor above sea level is _____ ft. (will be indicated by _____)

DETAILS OF WORK

(State names of and expected depths to objective sands; show sizes, weights, and lengths of proposed casing; indicate mudlogging jobs, etc., as well as points, and all other important proposed work)

I understand that this plan of work must receive approval in writing by the Geological Survey before operations may be commenced.

Company _____

Address _____

By _____

Title _____



Company Delhi Oil Corporation

Lease Ora L. Reames Well No. 1

Sec. 19 T. 26 N., R. 6 W., N.M.P.M.

Location 990' from the South line and 890'
from the West line.

Santa Fe
079295

Rio Arriba County

New Mexico

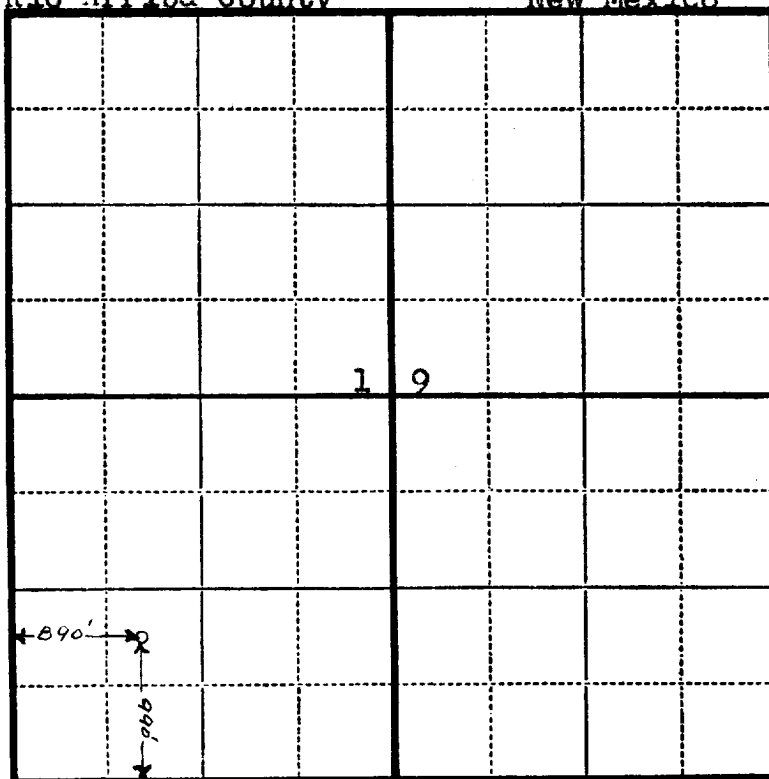

Scale—4 inches equals 1 mile.

This is to certify that the above plat was prepared from field notes of actual surveys made by me or under my supervision and that the same are true and correct to the best of my knowledge and belief.

Seal:

Registered Professional **Charles J. Finklea**
Engineer and Land Surveyor. N. Mex. Reg. No. 1302

Surveyed November 4, 1951