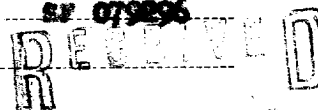

COPY TO O.C.G.

(SUBMIT IN TRIPLICATE)

 UNITED STATES
 DEPARTMENT OF THE INTERIOR
 GEOLOGICAL SURVEY
Land Office Santa FeLease No. SP 079896

Unit

U. S. GEOLOGICAL SURVEY
FARMINGTON, N. M.

SUNDRY NOTICES AND REPORTS ON WELLS

NOTICE OF INTENTION TO DRILL	<input checked="" type="checkbox"/>	SUBSEQUENT REPORT OF WATER SHUT-OFF	
NOTICE OF INTENTION TO CHANGE PLANS		SUBSEQUENT REPORT OF SHOOTING OR ACIDIZING	
NOTICE OF INTENTION TO TEST WATER SHUT-OFF		SUBSEQUENT REPORT OF ALTERING CASING	
NOTICE OF INTENTION TO RE-DRILL OR REPAIR WELL		SUBSEQUENT REPORT OF RE-DRILLING OR REPAIR	
NOTICE OF INTENTION TO SHOOT OR ACIDIZE		SUBSEQUENT REPORT OF ABANDONMENT	
NOTICE OF INTENTION TO PULL OR ALTER CASING		SUPPLEMENTARY WELL HISTORY	
NOTICE OF INTENTION TO ABANDON WELL			

(INDICATE ABOVE BY CHECK MARK NATURE OF REPORT, NOTICE, OR OTHER DATA)

June 25, 1953

Well No. Batterson Federal 819-1 is located 1650 ft. from S line and 1800 ft. from E line of sec. 19SE 1/4 Sec. 19
(1/4 Sec. and Sec. No.)T86N
(Twp.)R6W
(Range)N.M.P.M.
(Meridian)Deleg Canyon
(Field)Hio Arriba
(County or Subdivision)New Mexico
(State or Territory)The elevation of the derrick floor above sea level is 6197 ft.

DETAILS OF WORK

(State names of and expected depths to objective sands; show sizes, weights, and lengths of proposed casings; indicate mudding jobs, cementing points, and all other important proposed work)

It is proposed to drill with rotary to the top of the Pictured Cliff formation, estimated to be at a depth of 2800 feet, and thereafter to drill with cable tools through the Pictured Cliff formation or to the top of the Lewis shale. Final total depth estimated to be 2900 feet. It is further proposed to shoot the Pictured Cliff formation with solid nitroglycerine. Tentative casing program is as follows:

10-5/8" surface casing	90' - 150'	cement circulated
5-1/2" casing	2800 feet	cement w/200 sacks

The SE 1/4 of Section 19-T86N-R6W is the designated drilling unit. A blanketed bond (drilling) has been executed.

I understand that this plan of work must receive approval in writing by the Geological Survey before operations may be commenced.

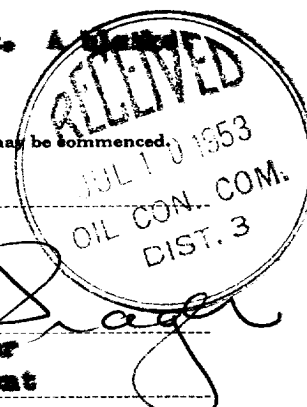
Company Pulse Development, Inc.Address Post Office Box 1360Albuquerque, New MexicoBy Arthur Frazer
Title Vice President

Company..... Pubco Development, Inc.

Lease..... Well No.....

Sec. 19....., T. 26 N....., R. 6 W., N.M.P.M.....

Location 1650' from the South line and 1800' from
the East line.

Elevation 6197 Ungraded ground.....

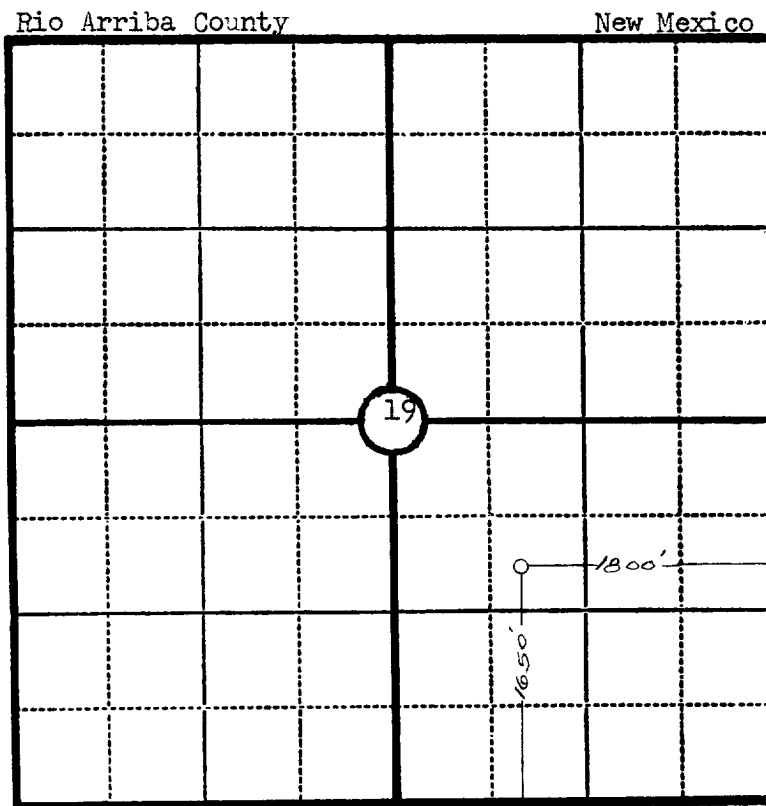

Scale—4 inches equal 1 mile.

This is to certify that the above plat was prepared from field notes of actual surveys made by me or under my supervision and that the same are true and correct to the best of my knowledge and belief.

Ernest V. Echohawk

Seal:

Registered Professional
Engineer and Land Surveyor.

Ernest V. Echohawk
N. Mex. Reg. No. 1545

Surveyed June 21....., 19 53.

