

Company.....Pubco Development, Inc.....

Lease..... Well No.....

Sec.....23....., T.....26 N....., R.....6 W., N.M.P.M....

Location 1500' from the South line and 790' from
the East line.

Elevation 6372 Ungraded ground.....

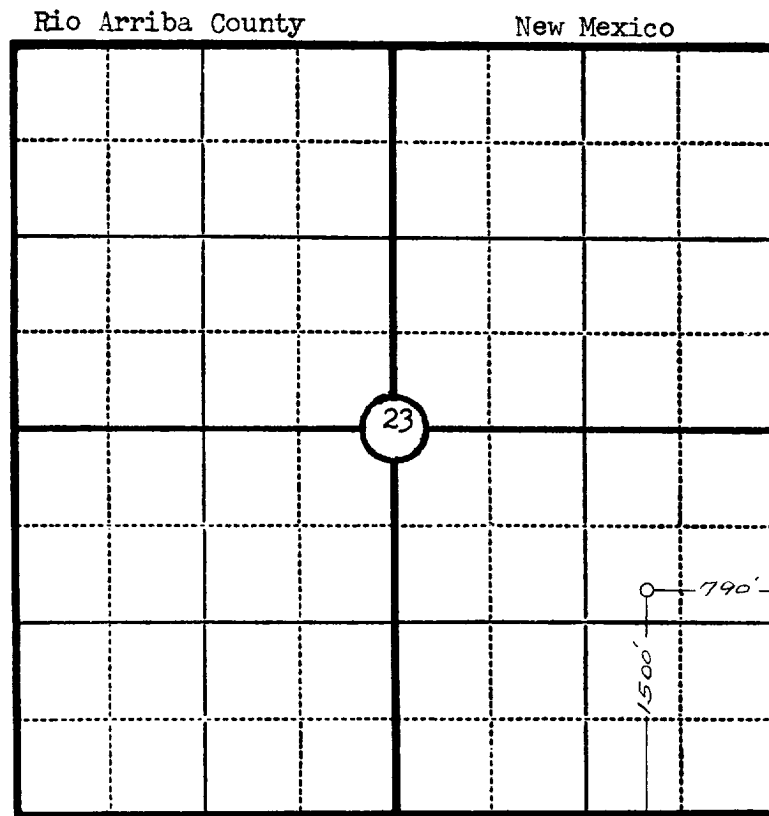

This is to certify that the above plat was prepared from field notes of actual surveys made by me or under my supervision and that the same are true and correct to the best of my knowledge and belief.

Seal:

Registered Professional
Engineer and Land Surveyor.

Charles J. Finklea
N. Mex. Reg. No. 1302

Surveyed May 14, 1953

