

NEW MEXICO OIL CONSERVATION COMMISSION

Well Location and Acreage Dedication Plat

Section A.

Date Nov. 19, 1957

Operator MAGNOLIA PETROLEUM COMPANY Lease JICARILLA "B"  
Well No. 5 Unit Letter        Section 20 Township 26N Range 3W NMPM  
Located 990 Feet From North Line, 990 Feet From East Line  
County Rio Arriba G. L. Elevation 7253 Dedicated Acreage 320 Acres  
Name of Producing Formation Mesa Verde Pool Blanco

1. Is the Operator the only owner\* in the dedicated acreage outlined on the plat below?  
Yes x No       .
2. If the answer to question one is "no," have the interests of all the owners been consolidated by communitization agreement or otherwise? Yes        No       . If answer is "yes," Type of Consolidation
3. If the answer to question two is "no," list all the owners and their respective interests below:

Owner

Land Description

Section B.

N 89° 48' E (Call) 80 Ch.

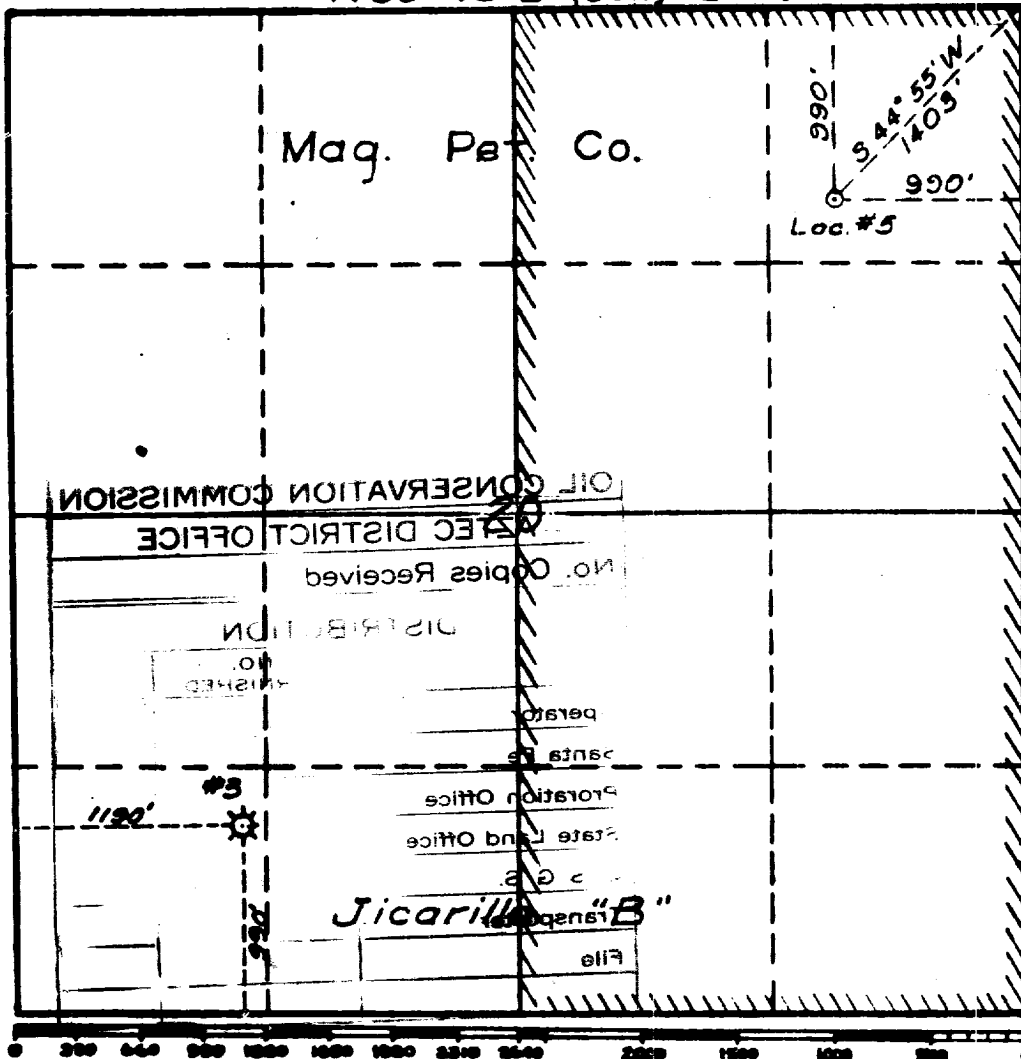

This is to certify that the information in Section A above is true and complete to the best of my knowledge and belief.

Magnolia Petroleum Company  
(Representative)

P.O. Box 2405, Hobbs, New Mex.

This is to certify that the well location shown on the plat in Section B was plotted from field notes of actual surveys made by me or under my supervision and that the same is true and correct to the best of my knowledge and belief.

Date Surveyed Sept. 23, 1957

Carl E. Turner  
Registered Professional  
Engineer and/or Land Surveyor.

Certificate No. 2490