

(SUBMIT IN TRIPLICATE)

UNITED STATES  
DEPARTMENT OF THE INTERIOR  
GEOLOGICAL SURVEY

Budget Bureau No. 42-R359.4.  
Approval expires 12-31-60.

Indian Agency Siouxville

Allottee Siouxville Tribal

Lease No. Contract 108

SUNDRY NOTICES AND REPORTS ON WELLS

NOTICE OF INTENTION TO DRILL	<input checked="" type="checkbox"/>	SUBSEQUENT REPORT OF WATER SHUT-OFF	
NOTICE OF INTENTION TO CHANGE PLANS		SUBSEQUENT REPORT OF SHOOTING OR ACIDIZING	
NOTICE OF INTENTION TO TEST WATER SHUT-OFF		SUBSEQUENT REPORT OF ALTERING CASING	
NOTICE OF INTENTION TO REDRILL OR REPAIR WELL		SUBSEQUENT REPORT OF REDRILLING OR REPAIR	
NOTICE OF INTENTION TO SHOOT OR ACIDIZE		SUBSEQUENT REPORT OF ABANDONMENT	
NOTICE OF INTENTION TO PULL OR ALTER CASING		SUPPLEMENTARY WELL HISTORY	
NOTICE OF INTENTION TO ABANDON WELL			

RECEIVED

APR 11 1958

U. S. GEOLOGICAL SURVEY  
FARMINGTON, NEW MEXICO

(INDICATE ABOVE BY CHECK MARK NATURE OF REPORT, NOTICE, OR OTHER DATA)

April 11th

19 58

Well No. 5-0 is located 1650 ft. from [N] line and 990 ft. from [E] line of sec. 24

SE/4 NE/4 Sec. 24  
(1/4 Sec. and Sec. No.)

T6N  
(Twp.)

5N  
(Range)

N.M.P.M.  
(Meridian)

S. Blanco FC Ext.  
(Field)

Rio Arriba  
(County or Subdivision)

New Mexico  
(State or Territory)

The elevation of the derrick floor above sea level is 6041 ft.

DETAILS OF WORK

(State names of and expected depths to objective sands; show sizes, weights, and lengths of proposed casings; indicate mud logging points, and all other important proposed work)

Pictured Cliffs Sand test. Estimated total depth 3100'.

Surface Casing: 90' of 8-1/8" OD 24# J-55 cemented to surface.  
Production " : Approximately 3100' of 5-1/2" OD 15.5# J-55 cemented with 100 sacks.

If commercial production is indicated, the producing section will be sand-water fractured.

I understand that this plan of work must receive approval in writing by the Geological Survey before operations may be commenced.

Company EL PASO NATURAL GAS COMPANY

Address Box 997

Farmington, New Mexico

By Dr Johnston

Title Petroleum Engineer

NEW MEXICO OIL CONSERVATION COMMISSION  
Well Location and Acreage Dedication Plat

Section A.

Date 18 JANUARY 1958

**EL PASO NATURAL GAS COMPANY**  
Operator ~~EL PASO NATURAL GAS COMPANY~~ Lease JICARILLA  
Well No. 5-0 Unit Letter H Section 24 Township 26 NORTH Range 5 WEST NMPM  
Located 1650 Feet From THE NORTH Line, 990 Feet From THE EAST Line  
County RIO ARriba G. L. Elevation 6635.0 Dedicated Acreage 160 Acres  
Name of Producing Formation Pictured Cliffs Pool 3. Blanco FC Ext.

1. Is the Operator the only owner\* in the dedicated acreage outlined on the plat below?  
Yes ☒ No ☐.
2. If the answer to question one is "no," have the interests of all the owners been consolidated by communitization agreement or otherwise? Yes ☐ No ☐. If answer is "yes," Type of Consolidation \_\_\_\_\_
3. If the answer to question two is "no," list all the owners and their respective interests below:  
REF. GLO Plat dated: 4 November 1882

Owner

Land Description

Section B

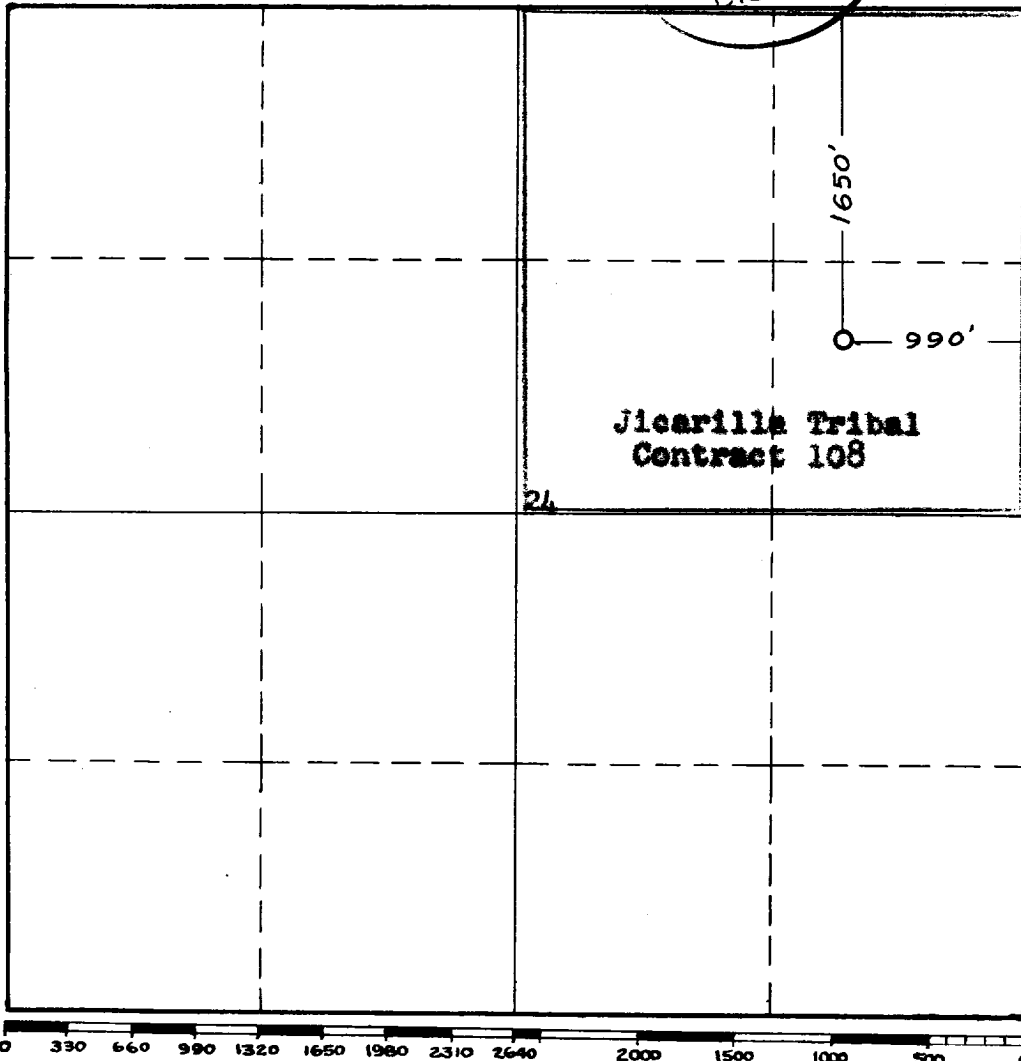

This is to certify that the information in Section A above is true and complete to the best of my knowledge and belief.

**EL PASO NATURAL GAS COMPANY**

(Operator)

Dr. Johnston  
(Representative)

Box 997

Address

**Farmington, New Mexico**

This is to certify that the well location shown on the plat in Section B was plotted from field notes of actual surveys made by me or under my supervision and that the same is true and correct to the best of my knowledge and belief.

Date Surveyed 13 JANUARY 1958

James P. Leese  
Registered Professional  
Engineer and/or Land Surveyor.

**JAMES P. LEESE**

Certificate No. 1462

(See instructions for completing this form on the reverse side)