

(SUBMIT IN TRIPLICATE)

Indian Agency **Florilla**

UNITED STATES  
DEPARTMENT OF THE INTERIOR  
GEOLOGICAL SURVEY

Allottee **Florilla Tribal**

Lease No. **Contract 108**

2		

SUNDRY NOTICES AND REPORTS ON WELLS

NOTICE OF INTENTION TO DRILL	<input checked="" type="checkbox"/>	SUBSEQUENT REPORT OF WATER SHUT-OFF	
NOTICE OF INTENTION TO CHANGE PLANS		SUBSEQUENT REPORT OF SHOOTING OR ACIDIZING	
NOTICE OF INTENTION TO TEST WATER SHUT-OFF		SUBSEQUENT REPORT OF ALTERING CASING	
NOTICE OF INTENTION TO REDRILL OR REPAIR WELL		SUBSEQUENT REPORT OF REDRILLING OR REPAIR	
NOTICE OF INTENTION TO SHOOT OR ACIDIZE		SUBSEQUENT REPORT OF ABANDONMENT	
NOTICE OF INTENTION TO PULL OR ALTER CASING		SUPPLEMENTARY WELL HISTORY	
NOTICE OF INTENTION TO ABANDON WELL			

**RECEIVED**  
JUN 16 1958  
U. S. GEOLOGICAL SURVEY  
FARMINGTON, NEW MEXICO

(INDICATE ABOVE BY CHECK MARK NATURE OF REPORT, NOTICE, OR OTHER DATA)

June 12th, 1958

Well No. 6-2 is located 1110 ft. from N line and 1550 ft. from W line of sec. 24

NE 1/4 NE 1/4 Sec. 24 26N 2W R.M.P.M.  
(1/4 Sec. and Sec. No.) (Twp.) (Range) (Meridian)  
S. Blanco PC Ext. El Arriba New Mexico  
(Field) (County or Subdivision) (State or Territory)

The elevation of the derrick floor above sea level is 6042 ft.

DETAILS OF WORK

(State names of and expected depths to objective sands; show sizes, weights, and lengths of proposed casings; indicate mudding jobs, cementing points, and all other important proposed work)

**Pictured Cliffs Sand test. Estimated total depth 3300'.**

**Surface Casing: 90' of 8-1/8" OD 24# J-55 cemented to surface.**  
**Production : Approximately 3300' of 5-1/2" OD 15.5# J-55 cemented with 100 sacks.**

**If commercial production is indicated, the producing section will be sand-water fractured.**

I understand that this plan of work must receive approval in writing by the Geological Survey before operations may be commenced.

Company **EL PASO NATURAL GAS COMPANY**

Address **Box 997**  
**Farmington, New Mexico**

By OC Johnston  
Title **Petroleum Engineer**

**RECEIVED**  
JUN 17 1958  
CON. COM.  
DIST. 3

NEW MEXICO OIL CONSERVATION COMMISSION  
Well Location and Acreage Dedication Plat

Section A.

Date June 12th. 1958

Operator EL PASO NATURAL GAS COMPANY Lease JICARILLA APACHE  
Well No. 6-G Unit Letter C Section 24 Township 26 NORTH Range 5 WEST NMPM  
Located 1110 Feet From THE NORTH Line, 1550 Feet From THE WEST Line  
County RIO ARriba G. L. Elevation 6634.8 Dedicated Acreage 160 Acres  
Name of Producing Formation Pictured Cliffs Pool A. Elanco PC Ext.

1. Is the Operator the only owner\* in the dedicated acreage outlined on the plat below?  
Yes X No       .
2. If the answer to question one is "no," have the interests of all the owners been consolidated by communitization agreement or otherwise? Yes        No       . If answer is "yes," Type of Consolidation
3. If the answer to question two is "no," list all the owners and their respective interests below:  
REF. GLO Plat dated: 4 November 1882

Owner

Land Description

**RECEIVED**

JUN 16 1958

U. S. GEOLOGICAL SURVEY  
FARMINGTON, NEW MEXICO

Section B

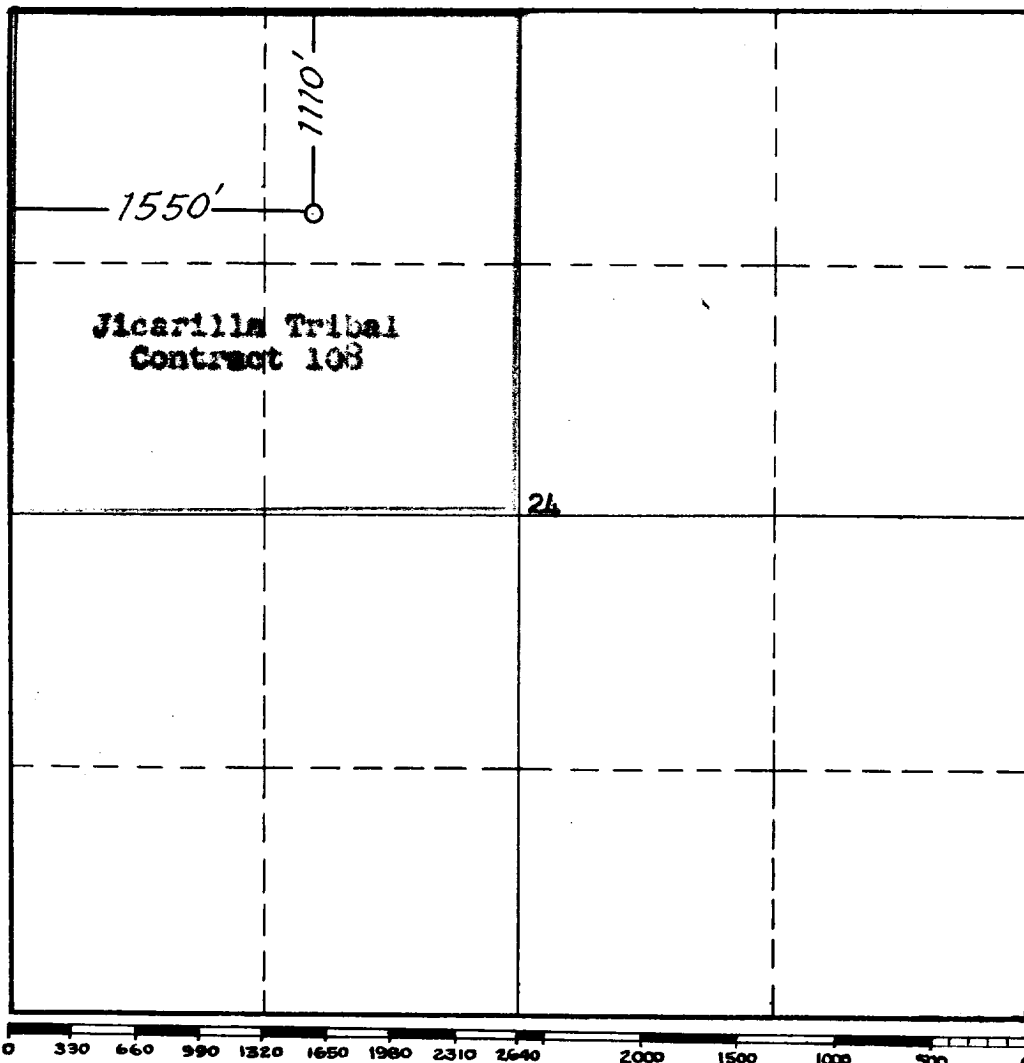

This is to certify that the information in Section A above is true and complete to the best of my knowledge and belief.

EL PASO NATURAL GAS COMPANY

(Operator)

D. C. Johnston  
(Representative)

Box 297

Address

Farmington, New Mexico

This is to certify that the well location shown on the plat in Section B was plotted from field notes of actual surveys made by me or under my supervision and that the same is true and correct to the best of my knowledge and belief.

Date Surveyed 11 JUNE 1958

James P. Leese  
Registered Professional  
Engineer and/or Land Surveyor.

**JAMES P. LEESE**

Certificate No. 1463

(See instructions for completing this form on the reverse side)

INSTRUCTIONS FOR COMPLETION:

1. Operator shall furnish and certify to the information called for in Section A.
2. Operator shall outline the dedicated acreage for both oil and gas wells on the plat in Section B.
3. A registered professional engineer or land surveyor registered in the State of New Mexico or approved by the Commission shall show on the plat the location of the well and certify this information in the space provided.
4. All distances shown on the plat must be from the outer boundaries of Section.
5. If additional space is needed for listing owners and their respective interests as required in question 3, Section A, please use space below

\* "Owner" means the person who has the right to drill into and to produce from any pool and to appropriate the production either for himself or for himself and another. (65-3-29 (e) NMSA 1953 Comp.)