



(SUBMIT IN TRIPLICATE)

UNITED STATES
DEPARTMENT OF THE INTERIOR
GEOLOGICAL SURVEY

Budget Bureau 42-R358.3.
Approval expires 12-31-55.

Jicarilla Apache

Land Office ~~Tribe of Indians~~

Lease No. ~~Contract No. 104~~

Unit ~~NE 1/4 Sec. 22, T26N,~~
R4E, Rio Arriba County,
New Mexico. N.M.P.M.

SUNDRY NOTICES AND REPORTS ON WELLS

| | | | |
|---|-------------------------------------|---|--|
| NOTICE OF INTENTION TO DRILL..... | <input checked="" type="checkbox"/> | SUBSEQUENT REPORT OF WATER SHUT-OFF..... | |
| NOTICE OF INTENTION TO CHANGE PLANS..... | | SUBSEQUENT REPORT OF SHOOTING OR ACIDIZING..... | |
| NOTICE OF INTENTION TO TEST WATER SHUT-OFF..... | | SUBSEQUENT REPORT OF ALTERING CASING..... | |
| NOTICE OF INTENTION TO RE-DRILL OR REPAIR WELL..... | | SUBSEQUENT REPORT OF RE-DRILLING OR REPAIR..... | |
| NOTICE OF INTENTION TO SHOOT OR ACIDIZE..... | | SUBSEQUENT REPORT OF ABANDONMENT..... | |
| NOTICE OF INTENTION TO PULL OR ALTER CASING..... | | SUPPLEMENTARY WELL HISTORY..... | |
| NOTICE OF INTENTION TO ABANDON WELL..... | | | |

(INDICATE ABOVE BY CHECK MARK NATURE OF REPORT, NOTICE, OR OTHER DATA)

March 29, 1955

Well No. 41 Jicarilla is located 800 ft. from N line and 900 ft. from E line of sec. 22

NE 1/4 NE 1/4 Sec. 22 T26N R4E N.M.P.M.
(1/4 Sec. and Sec. No.) (Twp.) (Range) (Meridian)

410001 PC Rio Arriba New Mexico
(Field) (County or Subdivision) (State or Territory)

The elevation of the derrick floor above sea level is _____ ft. to be determined.

DETAILS OF WORK

(State names of and expected depths to objective sands; show sizes, weights, and lengths of proposed casings; indicate mudding jobs, cementing points, and all other important proposed work)

Objective sand will be the Pictured Cliffs Formation anticipated at approximately 3575'.

Proposed casing program: 200' 5-5/8" J-55 cemented to surface.
3575' 5-1/2" J-55 cemented with 150 sacks.

Rotary tools will be employed from surface to top of Pictured Cliffs Formation.

Cable tools will be employed from top of Pictured Cliffs to T.B.

The well will be shot or sand fraced in an effort to stimulate production.

Estimated T.B. 3650'.

I understand that this plan of work must receive approval in writing by the Geological Survey before operations may be commenced.

Company Southern Union Leasing

Address Hurt, Okla.

Okla., Texas

By Paul J. White

Title petroleum engineer

COMPANY Southern Union Gas Company

Well Name & No. Tiara 4-E

Location 870' from the North line and 990' from the East line.

Being in NE 1/4

Sec. 22, T. 26 N., R. 4 W., N.M.P.M., Rio Arriba County, New Mexico.

Ground Elevation

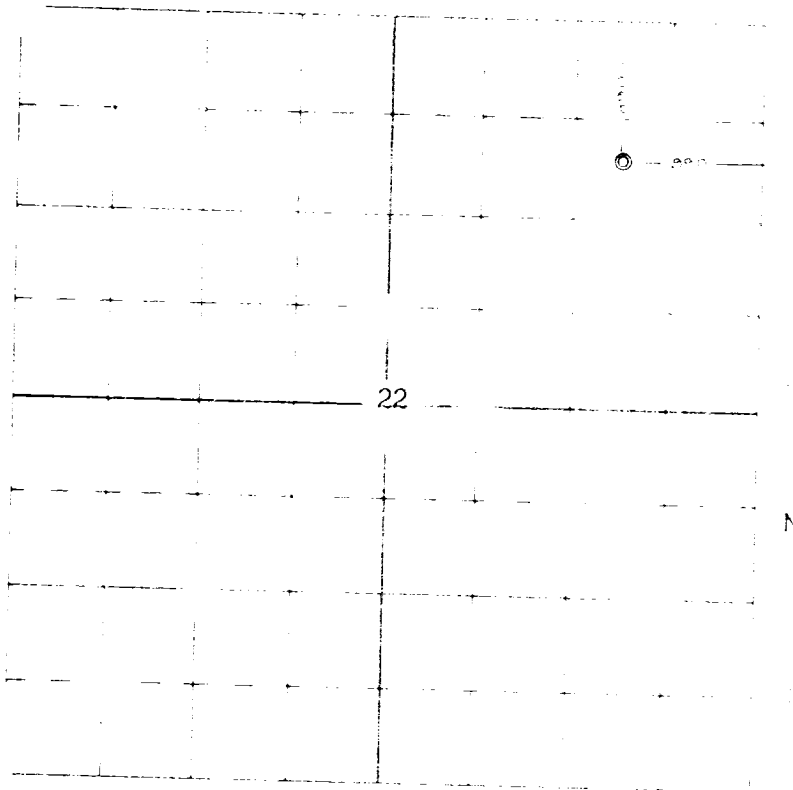

Scale - 4" = 1 mile

Surveyed March 17, 1955

This is to certify that the above plat was prepared from field notes of actual surveys made by me or under my supervision and that the same are true and correct to the best of my knowledge and belief.

Ernest V. Echobawk
Registered Land Surveyor
N. M. Reg. #1545

