

NEW MEXICO OIL CONSERVATION COMMISSION
Well Location and Acreage Dedication Plat

Section A.

Date June 19, 1958

Operator Southern Union Gas Company Lease Jicarilla
Well No. 5-A Unit Letter A Section 23 Township 26N Range 4W NMFM
Located 930 Feet From North Line 960 Feet From East Line
County Rio Arriba G. I. Elevation 7189 Dedicated Acreage 160 Acres
Name of Producing Formation Pictured Cliffs Pool Tapacito P. C.

1. Is the Operator the only owner* in the dedicated acreage outlined on the plat below?
Yes XX No .
2. If the answer to question one is "no," have the interests of all the owners been consolidated by communitization agreement or otherwise? Yes XX No If answer is "yes," Type of Consolidation Contract between Southern Union & Aztec Oil & Gas Company
3. If the answer to question two is "no," list all the owners and their respective interests below:

Owner

Land Description

Section B

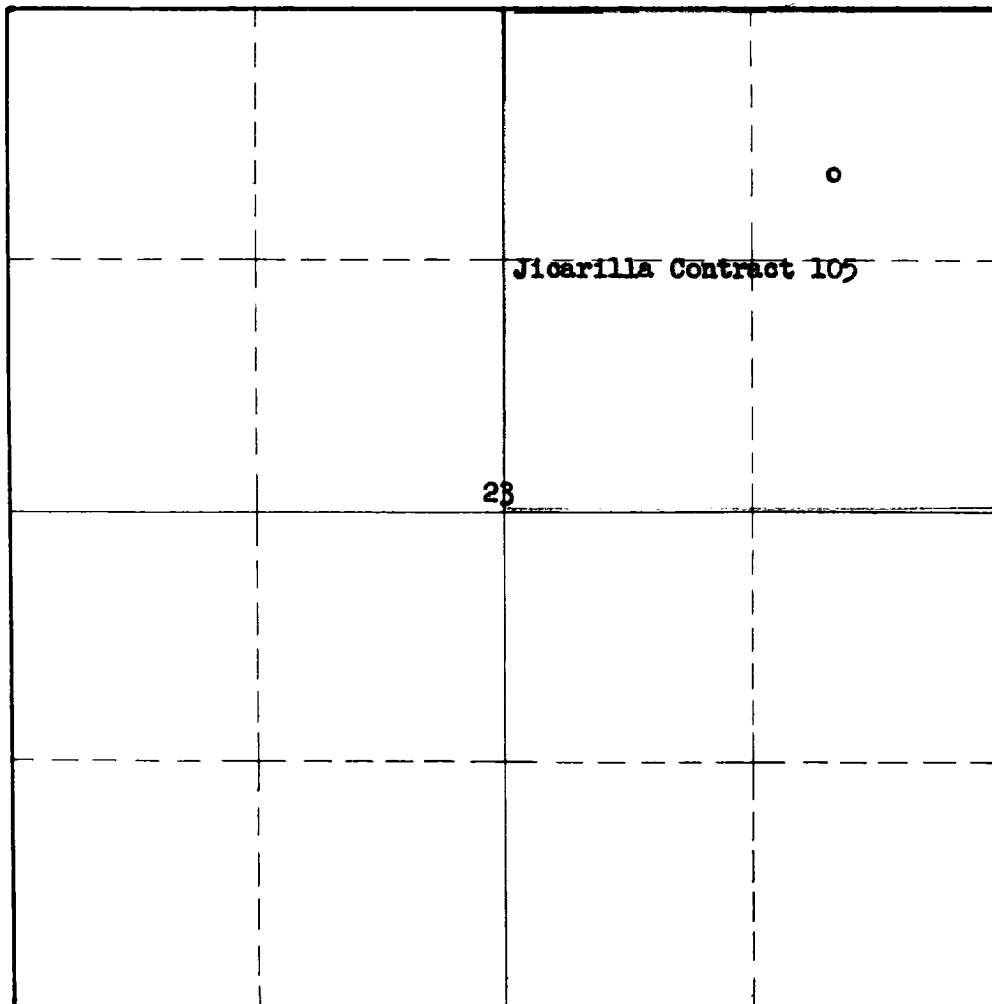

This is to certify that the information in Section A above is true and complete to the best of my knowledge and belief.

SOUTHERN UNION GAS COMPANY

(Operator)
Original Signed by

L. S. MUENNING

L. S. Muennink
(Representative)

1001 Burt Bldg., Dallas, Texas

Address

This is to certify that the well location shown on the plat in Section B was plotted from field notes of actual surveys made by me or under my supervision and that the same is true and correct to the best of my knowledge and belief.

Date Surveyed

Registered Professional
Engineer and/or Land Surveyor.

Certificate No.

INSTRUCTIONS FOR COMPLETION:

1. Operator shall furnish and certify to the information called for in Section A.
2. Operator shall outline the dedicated acreage for both oil and gas wells on the plat in Section B.
3. A registered professional engineer or land surveyor registered in the State of New Mexico or approved by the Commission shall show on the plat, the location of the well and certify this information in the space provided.
4. All distances shown on the plat must be from the outer boundaries of Section.
5. If additional space is needed for listing owners and their respective interests as required in question 3, Section A, please use space below

the right to drill into and to produce

* "Owner" means the person who has the right to drill into and to produce from any pool and to appropriate the production either for himself or for himself and another. (65-3-29 (e) NMSA 1953 Comp.)