

UNITED STATES  
DEPARTMENT OF THE INTERIOR  
GEOLOGICAL SURVEY

## APPLICATION FOR PERMIT TO DRILL, DEEPEN, OR PLUG BACK

1a. TYPE OF WORK DRILL <input checked="" type="checkbox"/> DEEPEN <input type="checkbox"/> PLUG BACK <input type="checkbox"/>		5. LEASE DESIGNATION AND SERIAL NO. Jicarilla Cont. 110	
b. TYPE OF WELL OIL WELL <input checked="" type="checkbox"/> GAS WELL <input checked="" type="checkbox"/> OTHER dual SINGLE ZONE <input type="checkbox"/> MULTIPLE ZONE <input checked="" type="checkbox"/>		6. IF INDIAN, ALLOTTEE OR TRIBE NAME Jicarilla Dulce NM	
2. NAME OF OPERATOR Tenneco Oil Company		7. UNIT AGREEMENT NAME	
3. ADDRESS OF OPERATOR Box 1714, Durango, Colorado		8. FARM OR LEASE NAME Jicarilla A	
4. LOCATION OF WELL (Report location clearly and in accordance with any State requirements.)* At surface 900' FNL 990' FEL At proposed prod. zone		9. WELL NO. # 3	
14. DISTANCE IN MILES AND DIRECTION FROM NEAREST TOWN OR POST OFFICE*		10. FIELD AND POOL, OR WILDCAT Gallup and Basin Dakota	
16. DISTANCE FROM PROPOSED* LOCATION TO NEAREST PROPERTY OR LEASE LINE, FT. (Also to nearest drlg. unit line, if any)		11. SEC., T., R., M., OR BLK. AND SURVEY OR AREA Sec. 19, T26N, R5W	
18. DISTANCE FROM PROPOSED LOCATION* TO NEAREST WELL, DRILLING, COMPLETED, OR APPLIED FOR, ON THIS LEASE, FT.		12. COUNTY OR PARISH Rio Arriba	
21. ELEVATIONS (Show whether DF, RT, GR, etc.) 6599 GR		13. STATE N.M.	
17. NO. OF ACRES ASSIGNED TO THIS WELL 320		20. ROTARY OR CABLE TOOLS Rotary	
19. PROPOSED DEPTH 7590		22. APPROX. DATE WORK WILL START* August 20, 1965	

23.

## PROPOSED CASING AND CEMENTING PROGRAM

SIZE OF HOLE	SIZE OF CASING	WEIGHT PER FOOT	SETTING DEPTH	QUANTITY OF CEMENT
12-1/4	8-5/8	24#	450	225 sacks
7-7/8	5-1/2	14# & 15.5#	7690	1st stage 235 sacks 2nd stage sufficient cement through stage collar to circulate to surface

We propose to drill w/rotary tools to approximately 7590', set casing and perforate and frac producing zones in both Gallup and Dakota formations and complete as a dual. Packer to be set between zones and produce Dakota through one string of tubing and Gallup through second string to surface.

RECEIVED  
AUG 20 1965  
CON. COM.  
DIST. 3RECEIVED  
AUG 19 1965  
U. S. GEOLOGICAL SURVEY

IN ABOVE SPACE DESCRIBE PROPOSED PROGRAM: If proposal is to deepen or plug back, give data on present production and proposed new productive zone. If proposal is to drill or deepen directionally, give pertinent data on subsurface locations and measured and true vertical depths. Give blowout preventer program, if any.

24. Original Signed By  
SIGNED HAROLD C. NICHOLS  
H. C. Nichols  
(This space for Federal or State office use)

TITLE Senior Production Clerk

DATE 8-18-65

PERMIT NO.

APPROVAL DATE

APPROVED BY

TITLE

CONDITIONS OF APPROVAL, IF ANY:

**NEW MEXICO OIL CONSERVATION COMMISSION  
WELL LOCATION AND ACREAGE DEDICATION PLAT**

Form 1-1  
Supersedes C-128  
Effective 1-1-61

Measurements must be from the outer boundaries of the Section

<b>TENNECO OIL COMPANY</b>		<b>JICORILLA "A"</b>		<b>3</b>
<b>A</b>	<b>19</b>	<b>26 North</b>	<b>5 West</b>	<b>Rio Arriba</b>
<b>900</b>	<b>North</b>	<b>990</b>	<b>East</b>	
<b>6599' ungraded</b>	<b>Basin Dakota</b>	<b>Basin Dakota</b>	<b>380</b>	

1. Outline the acreage dedicated to the subject well by colored pencil or hatchure marks on the plat below.
2. If more than one lease is dedicated to the well, outline each and identify the ownership thereof (both as to working interest and royalty).
3. If more than one lease of different ownership is dedicated to the well, have the interests been consolidated by communitization, unitization, force-pooling, etc?

☐ Yes ☐ No If answer is "yes," type of consolidation \_\_\_\_\_

If answer is "no," list the owners and tract descriptions which have actually been consolidated (Use reverse side of this form if necessary) \_\_\_\_\_

No allowable will be assigned to the well until all interests have been consolidated (by communitization, unitization, forced-pooling, or otherwise) or until a non-standard unit, eliminating such interests, has been approved by the Commission.

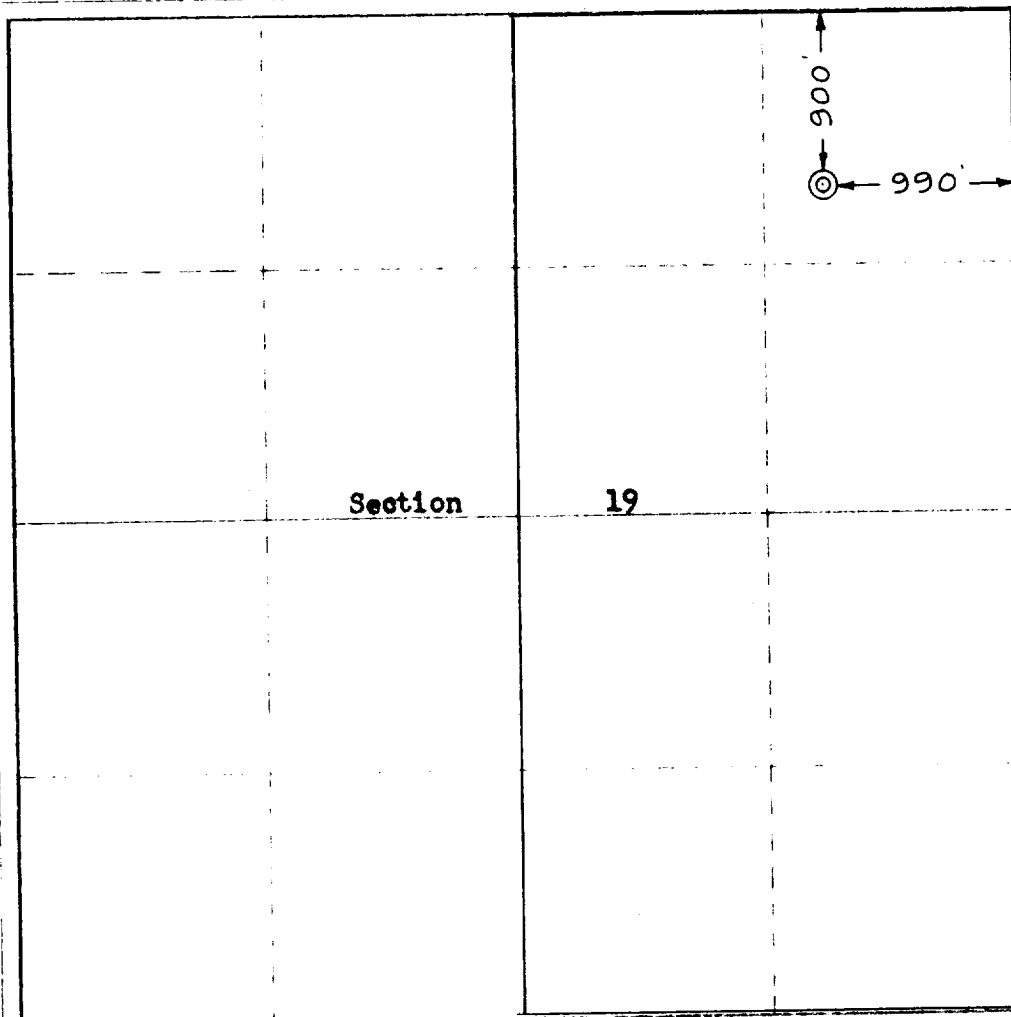
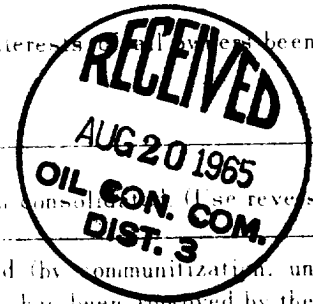

**CERTIFICATION**

I hereby certify that the information contained herein is true and complete to the best of my knowledge and belief

Original Signed By  
**HAROLD C. NICHOLS**

**Senior Production Clerk**

**Tenneco Oil Company**

**Box 1714, Durango, Colo.**

**8-18-65**

I hereby certify that the well location shown on this plat was plotted from field notes of actual surveys made by me or under my supervision, and that the same is true and correct to the best of my knowledge and belief

**17 June 1965**

*Robert H. Ernst*  
**ROBERT H. ERNST**

**N. Mex. PE & IS 2463**