

COPY FOR
STATE OF NEW MEXICO
OIL CONSERVATION
COMMISSION
SUBMIT IN TRIPLICATE TO
DISTRICT OFFICE

UNITED STATES
DEPARTMENT OF THE INTERIOR
GEOLOGICAL SURVEY

Land Office S. H.
Lease No. 0353
Unit N. 1/4, Section 22
is designated drilling unit

SUNDRY NOTICES AND REPORTS ON WELLS

NOTICE OF INTENTION TO DRILL	<input checked="" type="checkbox"/>	SUBSEQUENT REPORT OF WATER SHUT-OFF	
NOTICE OF INTENTION TO CHANGE PLANS		SUBSEQUENT REPORT OF SHOOTING OR ACIDIZING	
NOTICE OF INTENTION TO TEST WATER SHUT-OFF		SUBSEQUENT REPORT OF ALTERING CASING	
NOTICE OF INTENTION TO RE-DRILL OR REPAIR WELL		SUBSEQUENT REPORT OF REDRILLING OR REPAIR	
NOTICE OF INTENTION TO SHOOT OR ACIDIZE		SUBSEQUENT REPORT OF ABANDONMENT	
NOTICE OF INTENTION TO PULL OR ALTER CASING		SUPPLEMENTARY WELL HISTORY	
NOTICE OF INTENTION TO ABANDON WELL			

(INDICATE ABOVE BY CHECK MARK NATURE OF REPORT, NOTICE, OR OTHER DATA)

Well No. P.C. 1-15-36 is located 1045 ft. from N line and 1000 ft. from E line of sec. 22
N. 1/4, Section 22 26N 6W R.M.P.M.
(1/4 Sec. and Sec. No.) (Twp.) (Range) (Meridian)
Dogie Canyon - P.C. Rio Arriba County New Mexico
(Field) (County or Subdivision) (State or Territory)

The elevation of the derrick floor above sea level is _____ ft. To be furnished later.

DETAILS OF WORK

(State names of and expected depths to objective sands; show sizes, weights, and lengths of proposed casings; indicate muddling jobs, cementing points, and all other important proposed work)

It is intended to test Pictured Cliffs formation, expected around 3,000'.

Casing Program:

8-5/8" at 500' with 175 lbs.
5-1/2" at 3,000' with 200 lbs.

I understand that this plan of work must receive approval in writing by the Geological Survey before operations may be commenced.

Company Leary et al Operating Account

Address 636 East Central Avenue

Albuquerque, New Mexico

By E. R. Richardson
Title Business Manager



RECEIVED
JUN 13 1952
U.S. GEOLOGICAL SURVEY
FEDERAL BUREAU OF RESEARCH

Company Lowry et al Operating Account

Lease _____ Well No. _____

Sec. 22 T. 26 N. R. 6 W., N.M.P.M.

Location 1045' from the North line and 1800' from the East line.

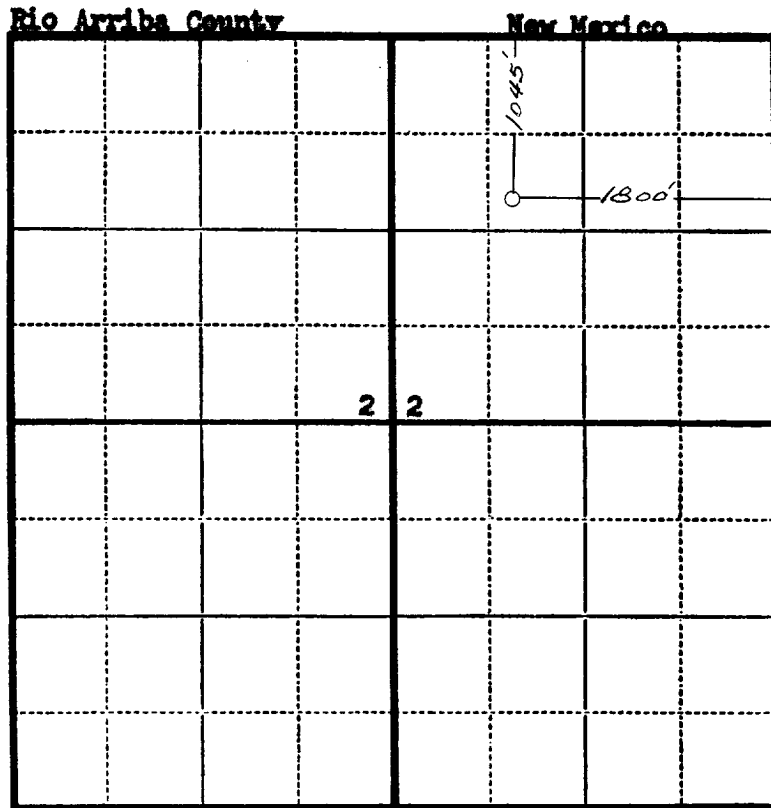

Scale—4 inches equals 1 mile.

This is to certify that the above plat was prepared from field notes of actual surveys made by me or under my supervision and that the same are true and correct to the best of my knowledge and belief.

Charles J. Finklea

Seal:

Registered Professional
Engineer and Land Surveyor.

Charles J. Finklea
N. Mex. Reg. No. 1302

Surveyed June 11, 19 52