

(SUBMIT IN TRIPLICATE)

UNITED STATES  
DEPARTMENT OF THE INTERIOR  
GEOLOGICAL SURVEY

Land Office Santa Fe  
Lease No. NE 018086  
Unit \_\_\_\_\_

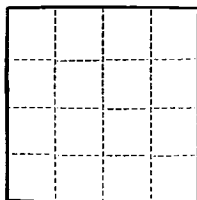

SUNDRY NOTICES AND REPORTS ON WELLS

NOTICE OF INTENTION TO DRILL	<input checked="" type="checkbox"/>	SUBSEQUENT REPORT OF WATER SHUT-OFF	
NOTICE OF INTENTION TO CHANGE PLANS		SUBSEQUENT REPORT OF SHOOTING OR ACIDIZING	
NOTICE OF INTENTION TO TEST WATER SHUT-OFF		SUBSEQUENT REPORT OF ALTERING CASING	
NOTICE OF INTENTION TO RE-DRILL OR REPAIR WELL		SUBSEQUENT REPORT OF RE-DRILLING OR REPAIR	
NOTICE OF INTENTION TO SHOOT OR ACIDIZE		SUBSEQUENT REPORT OF ABANDONMENT	
NOTICE OF INTENTION TO PULL OR ALTER CASING		SUPPLEMENTARY WELL HISTORY	1963
NOTICE OF INTENTION TO ABANDON WELL			

(INDICATE ABOVE BY CHECK MARK NATURE OF REPORT, NOTICE, OR OTHER DATA)

**Jean Road-Federal**

**May 2,** 19**63**

Well No. **1** is located **370** ft. from **EX** line and **1650** ft. from **EX** line of sec. **15**

**SE 1/4 sec. 15**

(1/4 Sec. and Sec. No.)

**26 N**

(Twp.)

**1 E**

(Range)

**N.M.P.**

(Meridian)

**Undesignated**

(Field)

**Rio Arriba**

(County or Subdivision)

**New Mexico**

(State or Territory)

The elevation of the ~~surface~~ above sea level is **7214** ft. **grd.**

DETAILS OF WORK

(State names of and expected depths to objective sands; show sizes, weights, and lengths of proposed casings; indicate mudding jobs, cementing points, and all other important proposed work)

Plan to drill 1850' Gallup test. Casing program as follows:

200' 8-5/8" surface. Cement will be circulated.

1/2" production string will be run if production is indicated,

to depth of 1796' and cemented with 100 sacks.



I understand that this plan of work must receive approval in writing by the Geological Survey before operations may be commenced.

Company **Harold O'Connor**

Address **300 Carlisle, SE**

**Albuquerque, New Mexico**

By

Title **Operator**

## NEW MEXICO OIL CONSERVATION COMMISSION

## Well Location and Acreage Dedication Plat

## Section A.

Date May 2, 1963

Operator HAROLD O'CONNOR Lease JEAN READ (FEDERAL)  
 Well No. 1 Unit Letter N Section 15 Township 26 NORTH Range 1 EAST NMPM  
 Located 370 Feet From the SOUTH Line, 1650 Feet From the WEST Line  
 County RIO ARriba G. L. Elevation 7214.0' Dedicated Acreage 1.0 Acres  
 Name of Producing Formation San Juan Pool San Juan

1. Is the Operator the only owner in the dedicated acreage outlined on the plat below?  
 Yes        No
2. If the answer to question one is "no", have the interests of all the owners been consolidated by communitization agreement or otherwise? Yes        No       . If answer is "yes", Type of Consolidation.
3. If the answer to question two is "no", list all the owners and their respective interests below:

Owner

Land Description

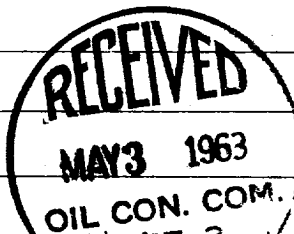

RECEIVED

MAY 2 1963

U.S. GEOLOGICAL SURVEY  
FARMINGTON, NEW MEXICO

## Section B.

Note: All distances must be given in outer boundaries of section.

This is to certify that the information in Section A above is true and complete to the best of my knowledge and belief.

(Operator)

(Representative)

(Address)

Ref: GLO plat dated 12 July 1918

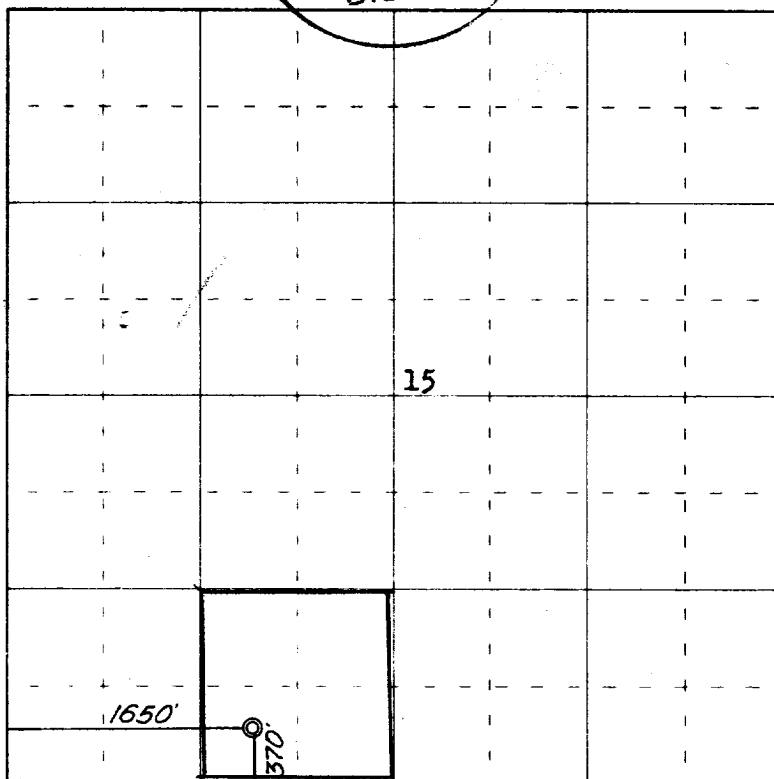

0 330 660 990 1320 1650 1980 2310 2640 2000 1500 1000 500 0

Scale 4 inches equal 1 mile

This is to certify that the above plat was prepared from field notes of actual surveys made by me or under my supervision and that the same are true and correct to the best of my knowledge and belief.

Date Surveyed 1 May 1963

James P. Leese  
 Registered Professional Engineer and/or Land Surveyor  
 James P. Leese, N. Mex. Reg. No. 1463  
 San Juan Engineering Company

(Seal)

Farmington, New Mexico