

(SUBMIT IN TRIPLICATE)

Indian Agency **Jicarilla**

UNITED STATES
DEPARTMENT OF THE INTERIOR
GEOLOGICAL SURVEY

Allottee **Jicarilla Tribal**

Lease No. **Contract 110**

SUNDRY NOTICES AND REPORTS ON WELLS

NOTICE OF INTENTION TO DRILL	<input checked="" type="checkbox"/>	SUBSEQUENT REPORT OF WATER SHUT-OFF	
NOTICE OF INTENTION TO CHANGE PLANS		SUBSEQUENT REPORT OF SHOOTING OR ACIDIZING	
NOTICE OF INTENTION TO TEST WATER SHUT-OFF		SUBSEQUENT REPORT OF ALTERING CASING	
NOTICE OF INTENTION TO REDRILL OR REPAIR WELL		SUBSEQUENT REPORT OF REDRILLING OR REPAIR	
NOTICE OF INTENTION TO SHOOT OR ACIDIZE		SUBSEQUENT REPORT OF ABANDONMENT	
NOTICE OF INTENTION TO PULL OR ALTER CASING		SUPPLEMENTARY WELL HISTORY	
NOTICE OF INTENTION TO ABANDON WELL			

(INDICATE ABOVE BY CHECK MARK NATURE OF REPORT, NOTICE, OR OTHER DATA)

April 13th, 19 **57**

Well No. **5-J** is located **990** ft. from **[N]** line and **1650** ft. from **[E]** line of sec. **19**

NE/4 NE/4 Sec. 19 **26N** **5W** **R.M.P.M.**
(1/4 Sec. and Sec. No.) (Twp.) (Range) (Meridian)
S. Blanco FC Ext. **Rio Arriba** **New Mexico**
(Field) (County or Subdivision) (State or Territory)

The elevation of the derrick floor above sea level is **6626** ft.

DETAILS OF WORK

(State names of and expected depths to objective sands; show sizes, weights, and lengths of proposed casings; indicate mudding jobs, cementing points, and all other important proposed work)

Pictured Cliffs Sand test. Estimated total depth 3200'.

Surface Casing: **90'** of **8-5/8"** OD **32#** cemented to surface.
Production " : **Approximately 3200'** of **5-1/2"** OD **15.5# J-55**
cemented with 100 sacks.

If commercial production is indicated, the 5-1/2" casing will be perforated and the producing section sandfraced.

I understand that this plan of work must receive approval in writing by the Geological Survey before operations may be commenced.

Company **EL PASO NATURAL GAS COMPANY**

Address **Box 997**

Farmington, New Mexico

By

Title **Senior Petroleum Engineer**





NEW MEXICO
OIL CONSERVATION COMMISSION

Form C-128

Well Location and/or Gas Proration Plat

Date 4-13-57

Operator EL PASO NATURAL GAS CO. Lease JICARILLA

Well No. 5-J Section 19 Township 26 NORTH Range 5 WEST NMPM

Located 990 Feet From the NORTH Line, 1650 Feet From the EAST Line,

RIO ARRIBA County, New Mexico. G. L. Elevation 6618.0

Name of Producing Formation Pictured Cliffs Pool S. Blanco
PC Ext. Dedicated Acreage 160

(Note: All distances must be from outer boundaries of Section)

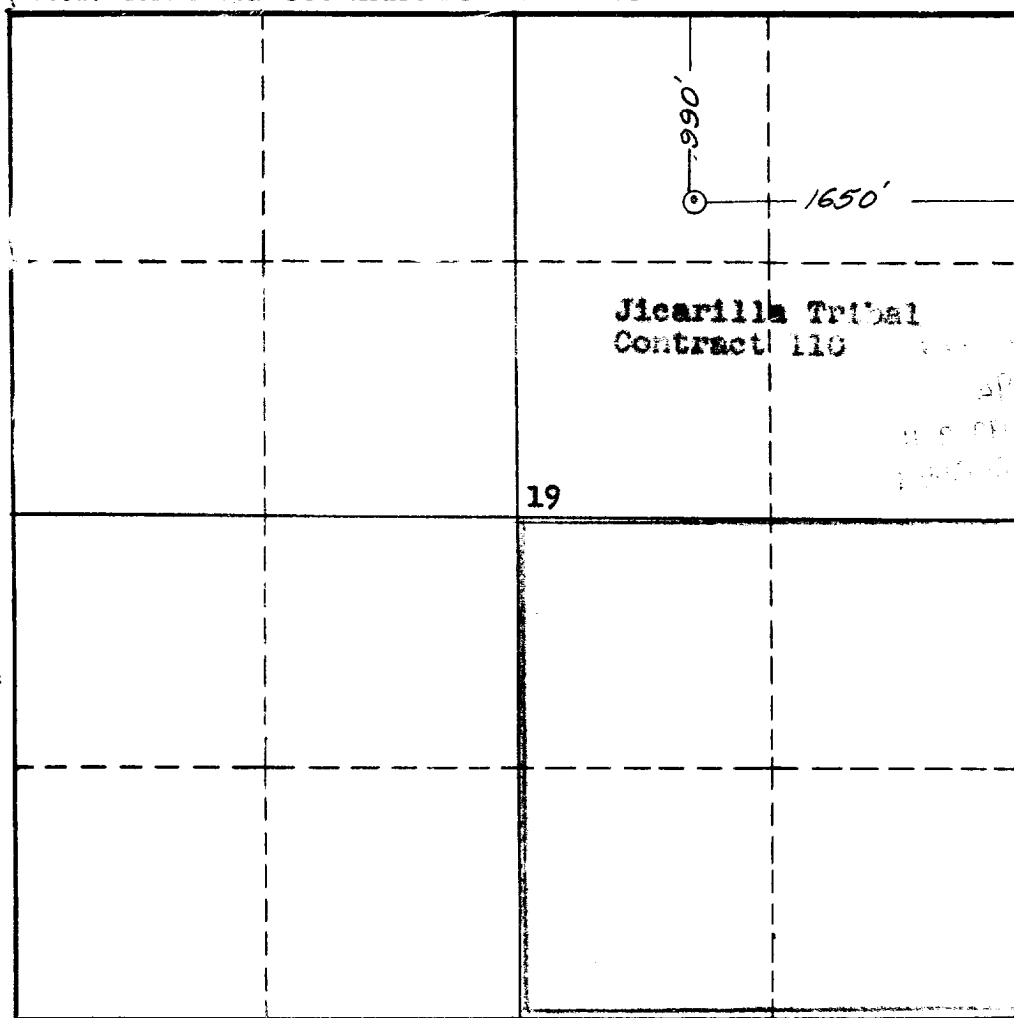

NOTE

This section of form is to be used for gas wells only.



SCALE: 1"=1000'

1. Is this Well a Dual Comp. ? Yes No X
2. If the answer to Question 1 is yes, are there any other dually completed wells within the dedicated acreage? Yes No

Name James P. Leese
Position Senior Petroleum Engineer
Representing El Paso Natural Gas Company
Address Box 997, Farmington, New Mexico

This is to certify that the above plat was prepared from field notes of actual surveys made by me or under my supervision and that the same are true and correct to the best of my knowledge and belief.

Date Surveyed 10 APRIL 1957
James P. Leese
Registered Professional Engineer and/or
Land Surveyor James P. Leese
N. Mex. Reg. No. 1463