

(SUBMIT IN TRIPLICATE)

UNITED STATES
DEPARTMENT OF THE INTERIOR
GEOLOGICAL SURVEYLand Office Santa FeLease No. 079055

Unit

RECEIVED

MAR 23 1952

SUNDRY NOTICES AND REPORTS ON WELLS
GEOLOGICAL SURVEY
FARMINGTON, N. M.

NOTICE OF INTENTION TO DRILL	<input checked="" type="checkbox"/>	SUBSEQUENT REPORT OF WATER SHUT-OFF	
NOTICE OF INTENTION TO CHANGE PLANS		SUBSEQUENT REPORT OF SHOOTING OR ACIDIZING	
NOTICE OF INTENTION TO TEST WATER SHUT-OFF		SUBSEQUENT REPORT OF ALTERING CASING	
NOTICE OF INTENTION TO RE-DRILL OR REPAIR WELL		SUBSEQUENT REPORT OF RE-DRILLING OR REPAIR	
NOTICE OF INTENTION TO SHOOT OR ACIDIZE		SUBSEQUENT REPORT OF ABANDONMENT	
NOTICE OF INTENTION TO PULL OR ALTER CASING		SUPPLEMENTARY WELL HISTORY	
NOTICE OF INTENTION TO ABANDON WELL			

(INDICATE ABOVE BY CHECK MARK NATURE OF REPORT, NOTICE, OR OTHER DATA)

March 20

59

Scott Federal

Well No. 17-3 is located 990 ft. from ^N_S line and 1650 ft. from ^E_W line of sec 17SW 1/4 Section 17
(1/4 Sec. and Sec. No.)26 North 6 West
(Twp.) (Range)M.N.P.M.
(Meridian)Dogie Canyon
(Field)Rio Arriba
(County or Subdivision)New Mexico
(State or Territory)

The elevation of the derrick floor above sea level is 6727 ft.

DETAILS OF WORK

(State names of and expected depths to objective sands; show sizes, weights, and lengths of proposed casings; indicate mudding jobs, cementing points, and all other important proposed work)

It is proposed to drill with rotary to the top of the Pictured Cliff formation, estimated to be at a depth of 2850 + feet, and thereafter to drill with cable tools through the Pictured Cliff formation or to the top of the Lewis shale. Final total depth estimated to be 2950+ feet. It is further proposed to shoot the Pictured Cliff formation with solid nitroglycerine. Tentative casing program is as follows:

10-3/4" surface casing 90' - 150' cement circulated
5-1/2" casing 2850'± cement w/200 sacks

The SW 1/4 of Section 17, Township 26 North, Range 6 West, is the designated drilling unit. A blanket drilling bond has been executed.

I understand that this plan of work must receive approval in writing by the Geological Survey before operations may be commenced.

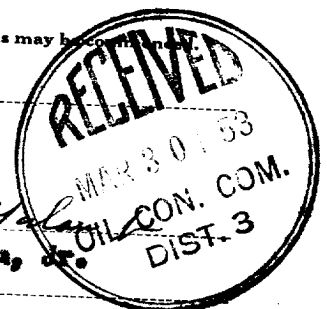
Company Pubco Development, Inc.Address Post Office Box 1360Albuquerque, New MexicoBy Frank D. Gorham, Jr.
Title Vice President

Company..... Pubco Development, Inc.

Lease..... Well No.....

Sec. 17, T. 26 N., R. 6 W., N.M.P.M.....

Location 990' from the South line and 1650' from the West line.

Elevation 6722 Ungraded ground.

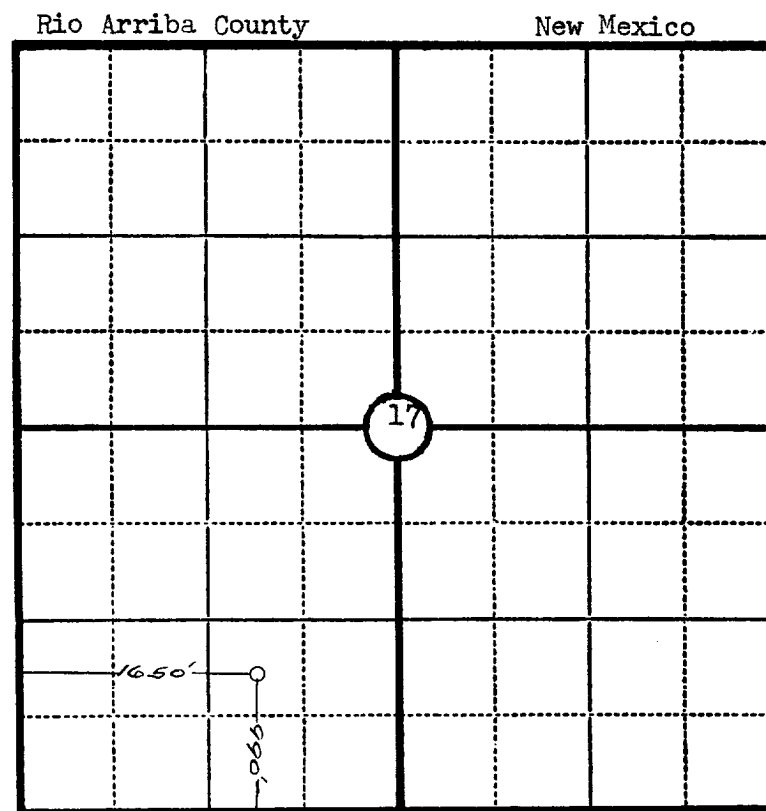

This is to certify that the above plat was prepared from field notes of actual surveys made by me or under my supervision and that the same are true and correct to the best of my knowledge and belief.

Seal:

Registered Professional
Engineer and Land Surveyor.

Ernest V. Echohawk
N. Mex. Reg. No. 1545

Surveyed March 9, 1953