

COPY FOR
STATE OF NEW MEXICO
OIL CONSERVATION
COMMISSION
SUBMIT IN TRIPLICATE TO
DISTRICT OFFICE

UNITED STATES
DEPARTMENT OF THE INTERIOR
GEOLOGICAL SURVEY

Land Office N. M.
Lease No. 0354
Unit SE 1/4, Section 14
is designated drilling unit

SUNDRY NOTICES AND REPORTS ON WELLS

NOTICE OF INTENTION TO DRILL.....	<input checked="" type="checkbox"/>	SUBSEQUENT REPORT OF WATER SHUT-OFF.....	
NOTICE OF INTENTION TO CHANGE PLANS.....		SUBSEQUENT REPORT OF SHOOTING OR ACIDIZING.....	
NOTICE OF INTENTION TO TEST WATER SHUT-OFF.....		SUBSEQUENT REPORT OF ALTERING CASING.....	
NOTICE OF INTENTION TO RE-DRILL OR REPAIR WELL.....		SUBSEQUENT REPORT OF REDRILLING OR REPAIR.....	
NOTICE OF INTENTION TO SHOOT OR ACIDIZE.....		SUBSEQUENT REPORT OF ABANDONMENT.....	
NOTICE OF INTENTION TO PULL OR ALTER CASING.....		SUPPLEMENTARY WELL HISTORY.....	
NOTICE OF INTENTION TO ABANDON WELL.....			

(INDICATE ABOVE BY CHECK MARK NATURE OF REPORT, NOTICE, OR OTHER DATA)

June 12, 1952

Well No. 5-47-301 is located 1650 ft. from XXXX line and 1650 ft. from E line of sec. 14
SE 1/4, Section 14 26N 6W N.M.P.M.
(1/4 Sec. and Sec. No.) (Twp.) (Range) (Meridian)
Wilcox Rio Arriba County New Mexico
(Field) (County or Subdivision) (State or Territory)

The elevation of the derrick floor above sea level is _____ ft. **To be furnished later.**

DETAILS OF WORK

(State names of and expected depths to objective sands; show sizes, weights, and lengths of proposed casings;

It is intended to test Pictured Cliffs formation, expected around 3,000'.

Casing Program:

8-5/8" at 500' with 175 sbp.
5-1/2" at 3,000' with 200 sbp.

I understand that this plan of work must receive approval in writing by the Geological Survey before operations may be commenced.

Company Louvy et al Operating Account

Address 616 East Central Avenue

Albuquerque, New Mexico

By E. F. Richardson
Title Business Manager

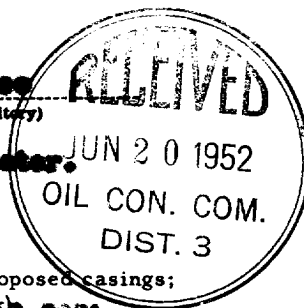

Company Lowry et al Operating Account

Lease _____ Well No. _____

Sec. 14 T. 26 N. R. 6 W., N.M.P.M.

Location 1650' from the South line and 1650' from the East line.

RECEIVED
JUN 11 1952
U.S. GEOLOGICAL SURVEY
FARMER

Rio Arriba County

New Mexico

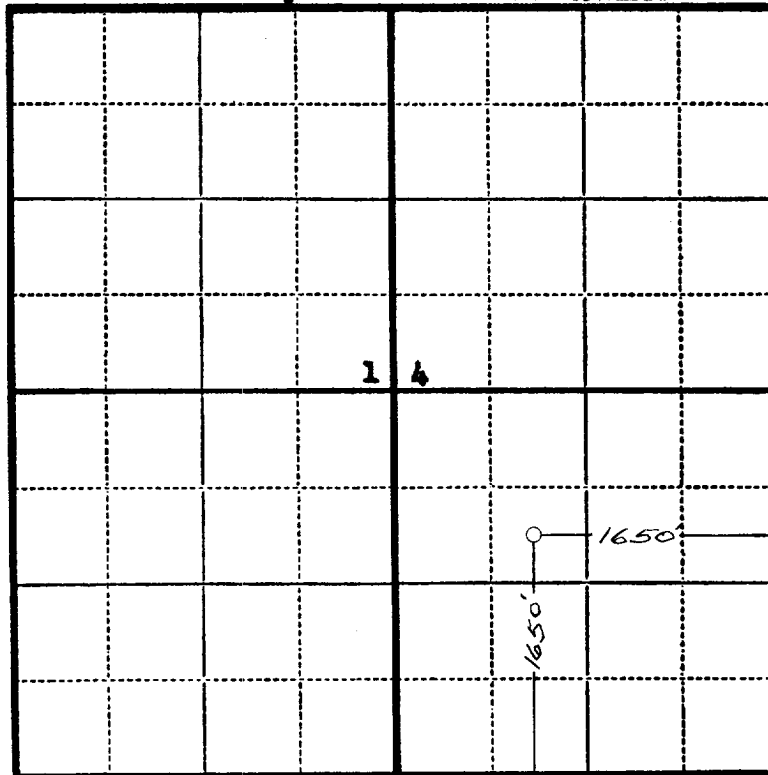

Scale—4 inches equals 1 mile.

This is to certify that the above plat was prepared from field notes of actual surveys made by me or under my supervision and that the same are true and correct to the best of my knowledge and belief.

Charles J. Finklea

Seal:

Registered Professional
Engineer and Land Surveyor.

Charles J. Finklea
N. Mex. Reg. No. 1302

Surveyed June 11, 19 52