

Denny E. Foust
DEPUTY OIL & GAS INSPECTOR

JICARILLA APACHE TRIBE

JUN 23 1998

ENVIRONMENTAL PROTECTION OFFICE

P.O. BOX 507
DULCE, NEW MEXICO 87528

SUBMIT 1 COPY TO
NATURAL
RESOURCE DEPT
AND OIL GAS
ADMINISTRATION

Approved
PIT REMEDIATION AND CLOSURE REPORT

Operator: PNM Gas Services (Amoco) Telephone: 324-3764
Address: 603 W. Elm Street Farmington, NM 87401
Facility or Well Name: Jicarilla A-1 #2
Location: Unit: L Sec. 15 T. 26 N R. 5 W County Rio Arriba
Pit Type: Separator X Dehydrator Other
Land Type: Jicarilla Apache

Pit Location: Pit dimensions: length 18' width 14' depth 16'
(Attach diagram) Reference: wellhead X other
Footage from reference: 117'
Direction from reference: 15 Degrees East North
 West South

Depth to Ground Water:

(Vertical distance from contaminants to seasonal high water elevation of ground water)

Less than 50 feet (20 points)
50 feet to 99 feet (10 points)
Greater than 100 feet (0 points)

Wellhead Protection Area:

(Less than 200 feet from a private domestic water source, or; less than 1,000 feet from all other water sources)

Yes (20 points)
No (0 points)

Distance to Surface Water:

(Horizontal distance to perennial lakes, ponds, rivers, streams, creeks, irrigation canals and ditches)

Less than 200 feet (20 points)
200 feet to 1,000 feet (10 points)
Greater than 1,000 feet (0 points)

Distance to Ephemeral Stream (dry wash):

(Horizontal distance to all downgradient streams having a width of at least 10 feet)

Less than or equal to 100 feet (10 points)
Greater than 100 feet (0 points)

Distance to Nearest Lake, Playa, or Watering Pond:

(Horizontal distance to all downgradient lakes, playas, and livestock or wildlife water ponds)

Less than or equal to 100 feet (10 points)
Greater than 100 feet (0 points)

RANKING SCORE (TOTAL POINTS):

RECEIVED
JAN 10 1961

NOT RECORDED
JAN 10 1961

Date Remediation Started:

9/11/97

Date Completed:

11/20/97

Remediation Method:

Excavation

X

Approx. Cubic Yards

149

(Check all appropriate sections)

Landfarmed

X

Amount Landfarmed (cubic yds):

149

Other _____

Remediation Location:

Onsite

X

Offsite _____

(i.e., landfarmed onsite, name and location of offsite facility)

General Description of Remedial Action:

Removed contaminated soil from all four side walls as to get a below 100ppm head space reading. Bottom is rock.

Ground Water Encountered:

No

X

Yes

Depth _____

Final Pit Closure Sampling:

Sample Location

North, East, South, and West side walls.

Sample depth

1.5'

(if multiple samples, attach sample result and diagram of sample locations and depths.)

Sample date

9/11/97

Sample time

1028

Sample Results

Soil: Benzene (ppm)

ND

Water: Benzene (ppb)

Total BTEX (ppm)

0.047

Toluene (ppb)

Field headspace (ppm)

18.4

Ethylbenzene (ppb)

TPH ND ppm

Method

8015

Total Xylenes (ppb)

Ground Water Sample:

Yes

No

X

(If yes, attach sample results)

I HEREBY CERTIFY THAT THE INFORMATION ABOVE IS TRUE AND COMPLETE TO THE BEST OF MY KNOWLEDGE AND MY BELIEF

DATE

9/18/97

PRINTED NAME

Ronald A. Dedrick

SIGNATURE

Ronald A. Dedrick

AND TITLE

Environmental Technician II

AFTER REVIEW OF THE PIT CLOSURE INFORMATION, PIT CLOSURE IS APPROVED IN ACCORDANCE TO JICARILLA APACHE TRIBE PIT CLOSURE ORDINANCE.

APPROVED: YES

X

NO

(REASON):

SIGNED:

Karl C. Mamm

DATE:

9-30-97

Jicarilla A-1 #2
Sec. 18 T26N R5W Unit L
Amoco

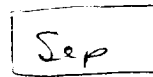
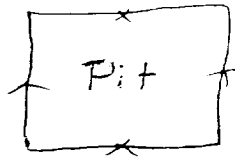
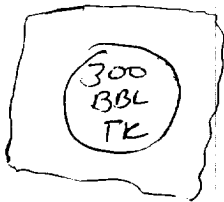
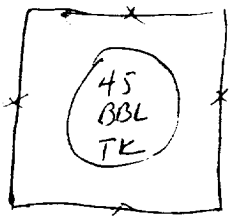
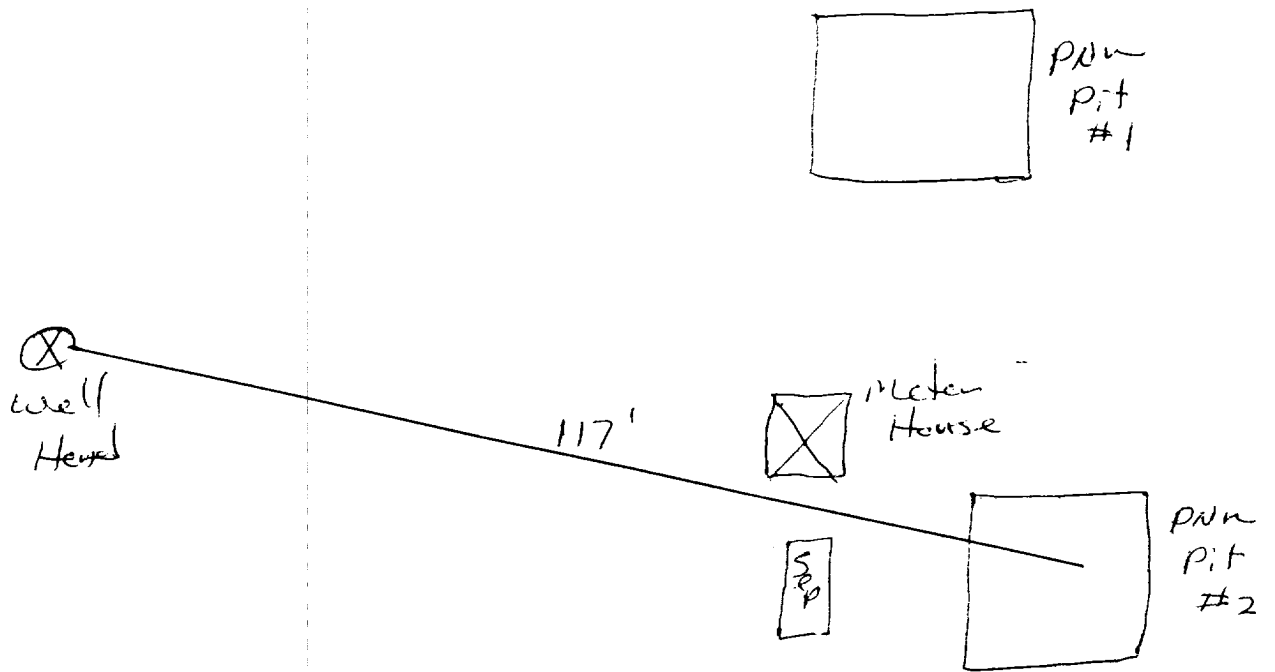

Jicarilla A-1 #2
Sec. 18 T26N R5W Unit L
Amoco

18' x 14' x 16'

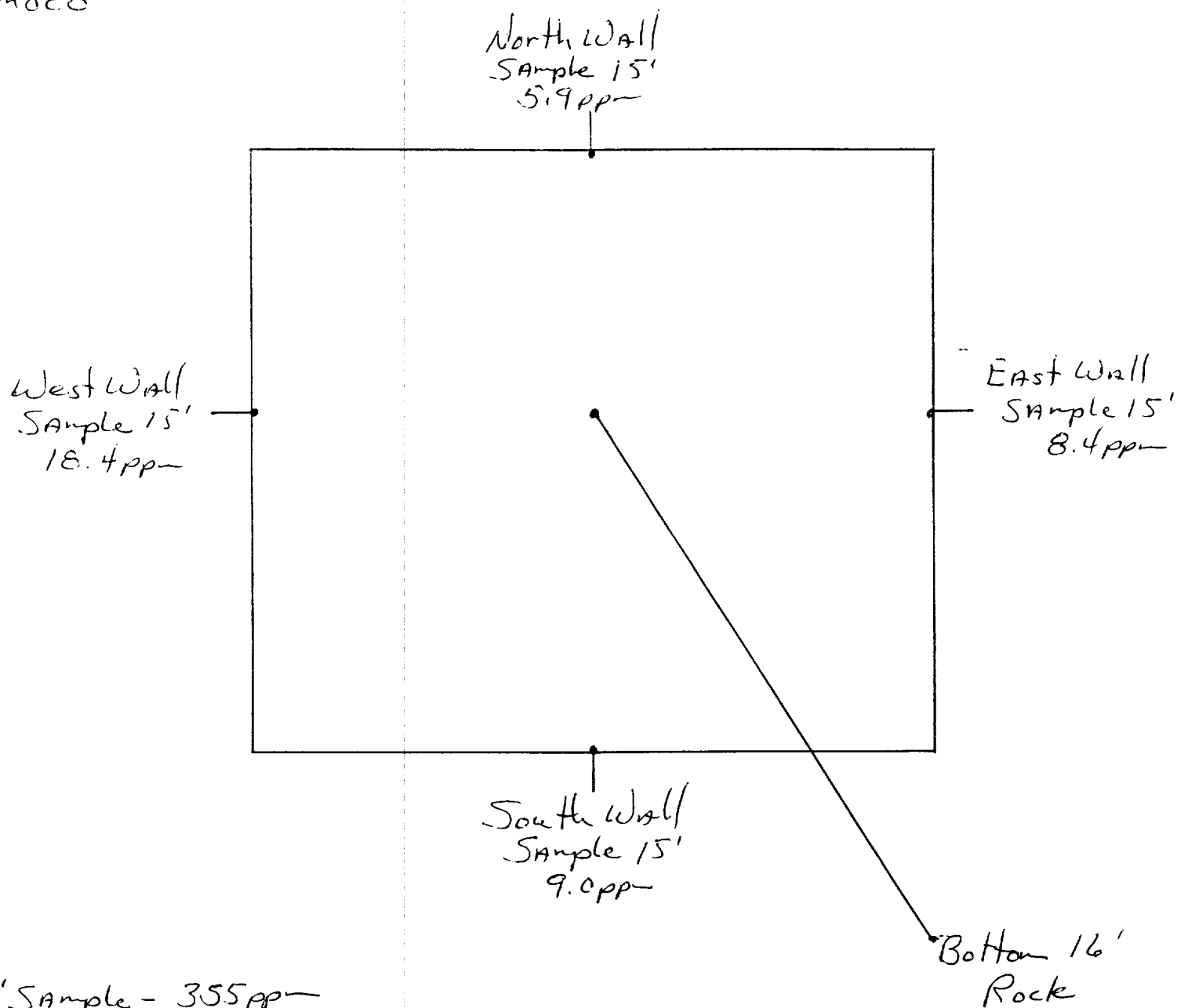

5' Sample - 355 ppm
0' Sample - 180 ppm
5' Sample - 107 ppm

OFF: (505) 325-5667



LAB: (505) 325-1556

ANALYTICAL REPORT

Attn: *Denver Bearden*
Company: *PNM Gas Services*
Address: *603 W. Elm*
City, State: *Farmington, NM 87401*

Date: *18-Sep-97*
COC No.: *5587*
Sample No.: *16163*
Job No.: *2-1000*

Project Name: *PNM Gas Services - Jicarilla A-1 #2*
Project Location: *9709111028; 4pt. Composite*
Sampled by: *PA* Date: *11-Sep-97* Time: *10:28*
Analyzed by: *DC/HR* Date: *17-Sep-97*
Sample Matrix: *Soil*

Laboratory Analysis

Parameter	Results as Received	Unit of Measure	Limit of Quantitation	Unit of Measure
<i>Diesel Range Organics (C10 - C28)</i>	ND	mg/kg	5	mg/kg

ND - Not Detected at Limit of Quantitation

Quality Assurance Report

DRO QC No.: 0555-STD

Continuing Calibration Verification

Parameter	Method Blank	Unit of Measure	True Value	Analyzed Value	RPD	RPD Limit
<i>Diesel Range (C10 - C28)</i>	ND	ppm	200	177	12.5	15%

Matrix Spike

Parameter	1 - Percent Recovered	2 - Percent Recovered	Limit	RPD	RPD Limit
<i>Diesel Range (C10-C28)</i>	87	88	(70-130)	1	20%

Method - SW-846 EPA Method 8015A mod. - Nonhalogenated Volatile Hydrocarbons by Gas Chromatography

Approved by: *[Signature]*
Date: *9/18/97*

P.O. BOX 2606 • FARMINGTON, NM 87499

TECHNOLOGY BLENDING INDUSTRY WITH THE ENVIRONMENT

OFF: (505) 325-5667



LAB: (505) 325-1556

ANALYTICAL REPORT

Attn: *Denver Bearden*
Company: *PNM Gas Services*
Address: *603 W. Elm*
City, State: *Farmington, NM 87401*

Date: *17-Sep-97*
COC No.: *5587*
Sample No.: *16163*
Job No.: *2-1000*

Project Name: *PNM Gas Services - Jicarilla A-1 #2*

Project Location: *9709111028; 4pt. Composite*

Sampled by: *PA* Date: *11-Sep-97* Time: *10:28*

Analyzed by: *DC* Date: *12-Sep-97*

Sample Matrix: *Soil*

Laboratory Analysis

Parameter	Results as Received	Unit of Measure	Limit of Quantitation	Unit of Measure
<i>Benzene</i>	ND	ug/kg	1	ug/kg
<i>Toluene</i>	4	ug/kg	1	ug/kg
<i>Ethylbenzene</i>	3	ug/kg	1	ug/kg
<i>m,p-Xylene</i>	29	ug/kg	1	ug/kg
<i>o-Xylene</i>	12	ug/kg	1	ug/kg
	<i>TOTAL</i>	47		ug/kg

ND - Not Detected at Limit of Quantitation

Method - *SW-846 EPA Method 8020A Aromatic Volatile Organics by Gas Chromatography*

Approved by: *[Signature]*
Date: *9/17/97*

P.O. BOX 2606 • FARMINGTON, NM 87499

TECHNOLOGY BLENDING INDUSTRY WITH THE ENVIRONMENT

JICARILLA APACHE TRIBE
ENVIRONMENTAL
PROTECTION OFFICE
P.O. BOX 507
DULCE, NEW MEXICO 87528

SUBMIT 1 COPY TO
NATURAL
RESOURCE DEPT
AND OIL GAS
ADMINISTRATION

ON-SITE SOIL REMEDIATION REPORT

Operator: PNM Gas Services (Amoco) Telephone: 324-3764
Address: 603 W. Elm Street Farmington, NM 87401
Facility or Well Name: Jicarilla A-1 #2
Location: Unit: 2 Sec. 18 T. 24 N R. 5 W County Rio Arriba
Land Type: Jicarilla Apache

Date Remediation Started: 9/11/97 Date Completed: 11/13/97
Remediation Method: Landfarmed X Approx. cubic yards 149
Composted
Other

Depth to Ground Water: (pts.) 2
Distance to an Ephemeral Stream: (pts.) 2
Distance to Nearest Lake, Playa,
or Watering Pond: (pts.) 2
Wellhead Protection Area: (pts.) 2
Distance to Surface Water: (pts.) 2
Ranking Score (Total Points): 2

Final Closure Sampling:

Sampling Date: 11/12/97 Time 1317
Sampling Results:
Field Headspace (ppm) 7.2
TPH (ppm) 38 Method ECV5
Other

I HEREBY CERTIFY THAT THE INFORMATION ABOVE IS TRUE AND COMPLETE TO THE BEST OF MY KNOWLEDGE AND BELIEF

DATE 11/16/97 PRINTED NAME Ronald A. Dedrick
SIGNATURE Ronald A. Dedrick AND TITLE Environmental Technician II

AFTER REVIEW OF THE SOIL REMEDIATION INFORMATION, ON-SITE REMEDIATION APPROVED IN ACCORDANCE TO THE
JICARILLA APACHE TRIBE PIT CLOSURE ORDINANCE

APPROVED: YES X NO (REASON) we are backfill

SIGNED: Kevin C. Marshall DATE: 11-17-97

Ticarella A-1 #2
Sec. 18 T26N R5W Unit L
Amoco

Land farm

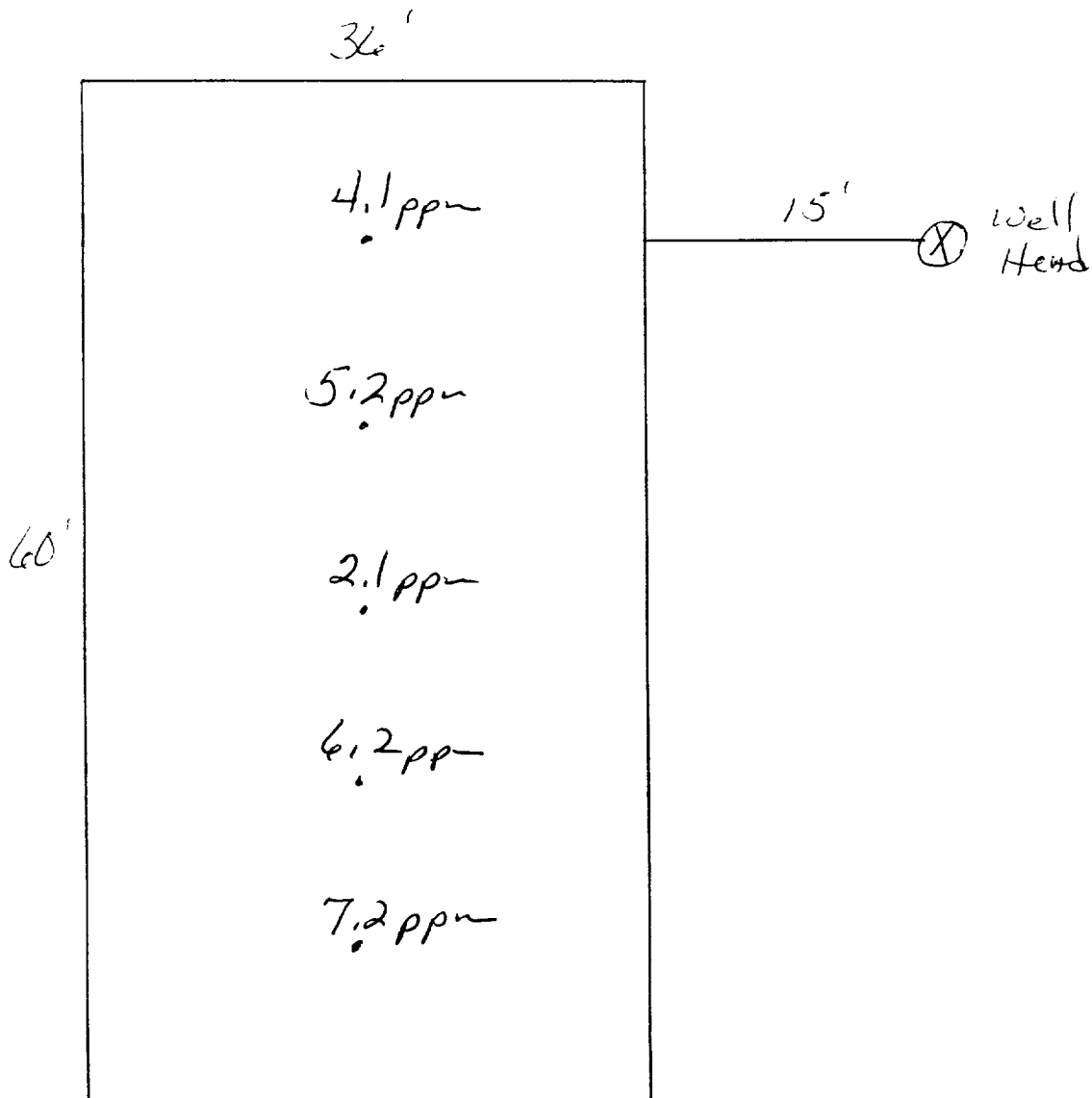

OFF: (505) 325-5667



LAB: (505) 325-1556

ANALYTICAL REPORT

Attn: *Denver Bearden*
Company: *PNM Gas Services*
Address: *603 W. Elm*
City, State: *Farmington, NM 87401*

Date: *13-Nov-97*
COC No.: *5637*
Sample No.: *16865*
Job No.: *2-1000*

Project Name: ***PNM Gas Services - Jicarilla A-1 #2 Landfarm***

Project Location: ***9711121317; 5pt. Composite***

Sampled by: *RB* Date: *12-Nov-97* Time: *13:17*

Analyzed by: *DC/HR* Date: *13-Nov-97*

Sample Matrix: *Soil*

Laboratory Analysis

Parameter	Results as Received	Unit of Measure	Limit of Quantitation	Unit of Measure
<i>Diesel Range Organics (C10 - C28)</i>	38	mg/kg	5	mg/kg

ND - Not Detected at Limit of Quantitation

Quality Assurance Report

DRO QC No.: 0555-STD

Continuing Calibration Verification

Parameter	Method Blank	Unit of Measure	True Value	Analyzed Value	RPD	RPD Limit
<i>Diesel Range (C10 - C28)</i>	ND	ppm	200	204	1.9	15%

Matrix Spike

Parameter	1 - Percent Recovered	2 - Percent Recovered	Limit	RPD	RPD Limit
<i>Diesel Range (C10-C28)</i>	91	90	(70-130)	1	20%

Method - SW-846 EPA Method 8015A mod. - Nonhalogenated Volatile Hydrocarbons by Gas Chromatography

Approved by: *[Signature]*

Date: *11/13/97*

P.O. BOX 2606 • FARMINGTON, NM 87499

- To Improve the Performance of the Industry with the Environment -