

# CERTIFICATE OF SURVEY

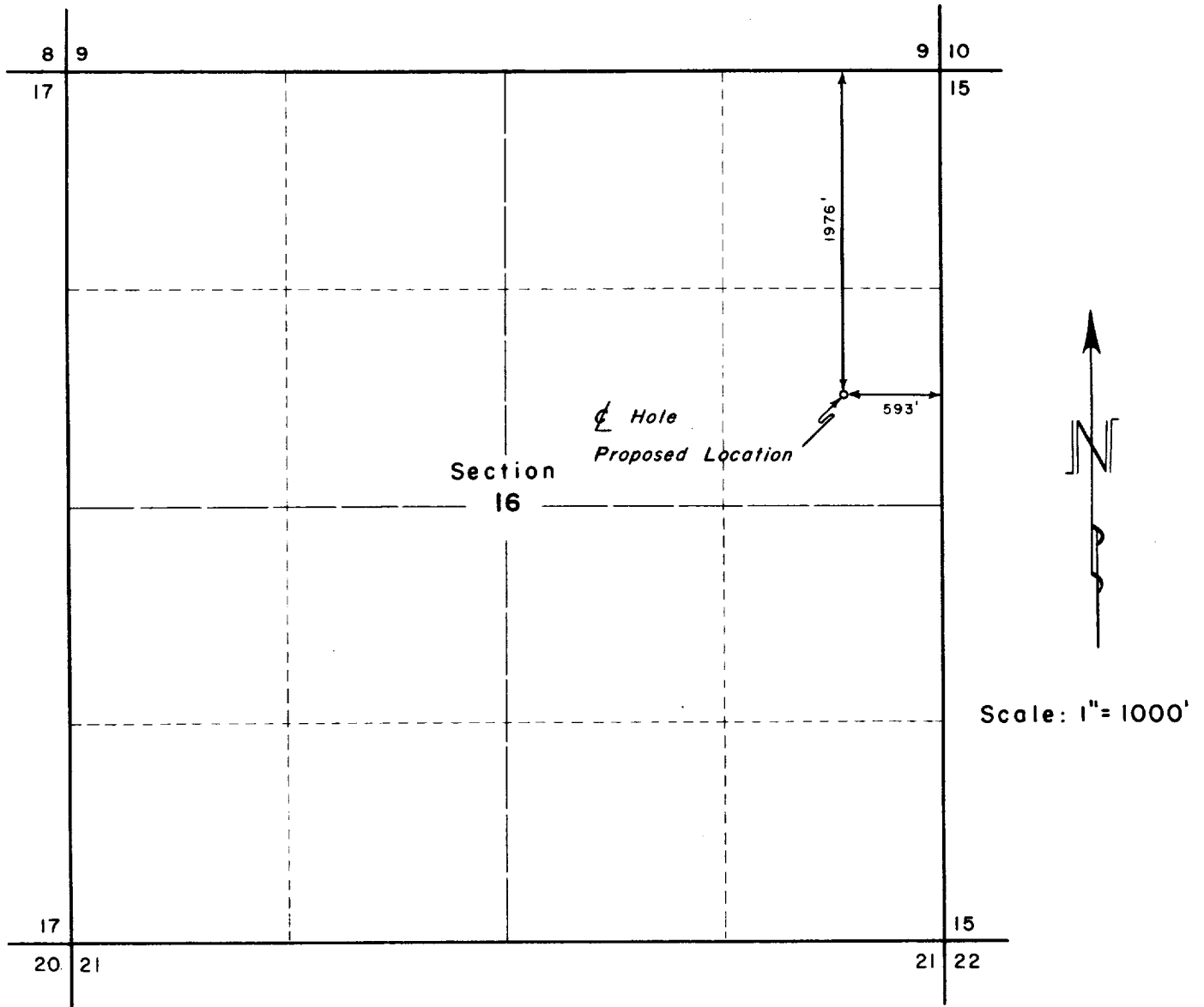

## WELL LOCATION: Intex Oil Co. - U.S.L. Casa No. 1

Located 1976 feet South of the North line and 593 feet West of the East line of Section 16  
 Township 26 North Range 1 East New Mexico Principal Meridian  
 Rio Arriba County, New Mexico  
 Existing ground elevation determined at 7222 feet based on U.S.G.S. datum

I hereby certify the above plat represents a survey made under my supervision and is accurate to the best of my knowledge and belief.

*Elmer M. Clark*

ELMER M. CLARK  
 Registered Land Surveyor  
 State of New Mexico (No. 3189)



**E.M. CLARK & ASSOCIATES**  
 Durango, Colorado  
 JAN 19, 1960