

(SUBMIT IN TRIPLICATE)

UNITED STATES
DEPARTMENT OF THE INTERIOR
GEOLOGICAL SURVEY

Indian Agency _____

Albuquerque

Allottee _____

Lease No. Contract #116

SUNDRY NOTICES AND REPORTS ON WELLS

NOTICE OF INTENTION TO DRILL _____	<input checked="" type="checkbox"/> SUBSEQUENT REPORT OF WATER SHUT-OFF _____
NOTICE OF INTENTION TO CHANGE PLANS _____	SUBSEQUENT REPORT OF SHOOTING OR ACIDIZING _____
NOTICE OF INTENTION TO TEST WATER SHUT-OFF _____	SUBSEQUENT REPORT OF ALTERING CASING _____
NOTICE OF INTENTION TO REDRILL OR REPAIR WELL _____	SUBSEQUENT REPORT OF REDRILLING OR REPAIR _____
NOTICE OF INTENTION TO SHOOT OR ACIDIZE _____	SUBSEQUENT REPORT OF ABANDONMENT _____
NOTICE OF INTENTION TO PULL OR ALTER CASING _____	SUPPLEMENTARY WELL HISTORY _____
NOTICE OF INTENTION TO ABANDON WELL _____	

(INDICATE ABOVE BY CHECK MARK NATURE OF REPORT, NOTICE, OR OTHER DATA)

April 3, 19 57

Well No. "E" 11-15 is located 1600 ft. from [N] line and 1750 ft. from [E] line of sec. 15

NE 1/4 NE 1/4 15
(1/4 Sec. and Sec. No.)

34N
(Twp.)

3W
(Range)

106W
(Meridian)

Wildcat (Graneros-M)
(Field)

San Antonio
(County or Subdivision)

New Mexico
(State or Territory)

The elevation of the well head above sea level is 7134 ft.



DETAILS OF WORK

(State names of and expected depths to objective sands; show sizes, weights, and lengths of proposed casings; indicate mudding, cementing points, and all other important proposed work)

Propose to drill 15' hole to 170', set 2-3/4" OD casing and cement to surface w/200 cu yd. Drill 9-7/8" hole to 3000', set 7-5/8" OD casing and cement w/150 cu yd gal and 90 cu yd. Drill 6-3/4" hole using gun to total depth of 3250', set 3-1/2" OD liner from 3000 to 3250'. Cement bottom of liner w/150 cu yd. Breakdown square top of liner w/30 cu yd. Perforate 3/4" liner opposite Dakota formation (3050-3250) and fracture using 30,000 gals water w/10 cu gal. Perforate 3/4" liner opposite Graneros formation (3000-3050) and fracture using 15,000 gals water w/10 cu gal. Run 2-3/8" OD tubing and seal well in. The NE 1/4 of Section 15, containing 160 acres, is dedicated to this well.

I understand that this plan of work must receive approval in writing by the Geological Survey before operations may be commenced.

Company _____

Address NORTHWEST PRODUCTION CORPORATION
520 Simms Building
Albuquerque, New Mexico

By RAY PHILLIPS
Ray Phillips

Title Asst Mgr, Prod Opr

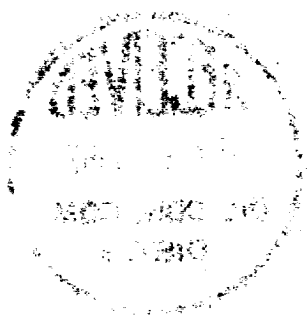

NEW MEXICO
OIL CONSERVATION COMMISSION

Form C-128

Well Location and/or Gas Proration Plat

Date **April 4, 1957**

Operator **Northwest Production Corporation** Lease **"K"**

Well No. **11-15** Section **15** Township **26 North** Range **3 West** NMPM

Located **1600** Feet From **North** Line, **1750** Feet From **East** Line,

Rio Arriba County, New Mexico. G. L. Elevation **7134**

Name of Producing Formation **Graneros-Bakota** Pool **Wildcat** Dedicated Acreage **160**

(Note: All distances must be from outer boundaries of Section)

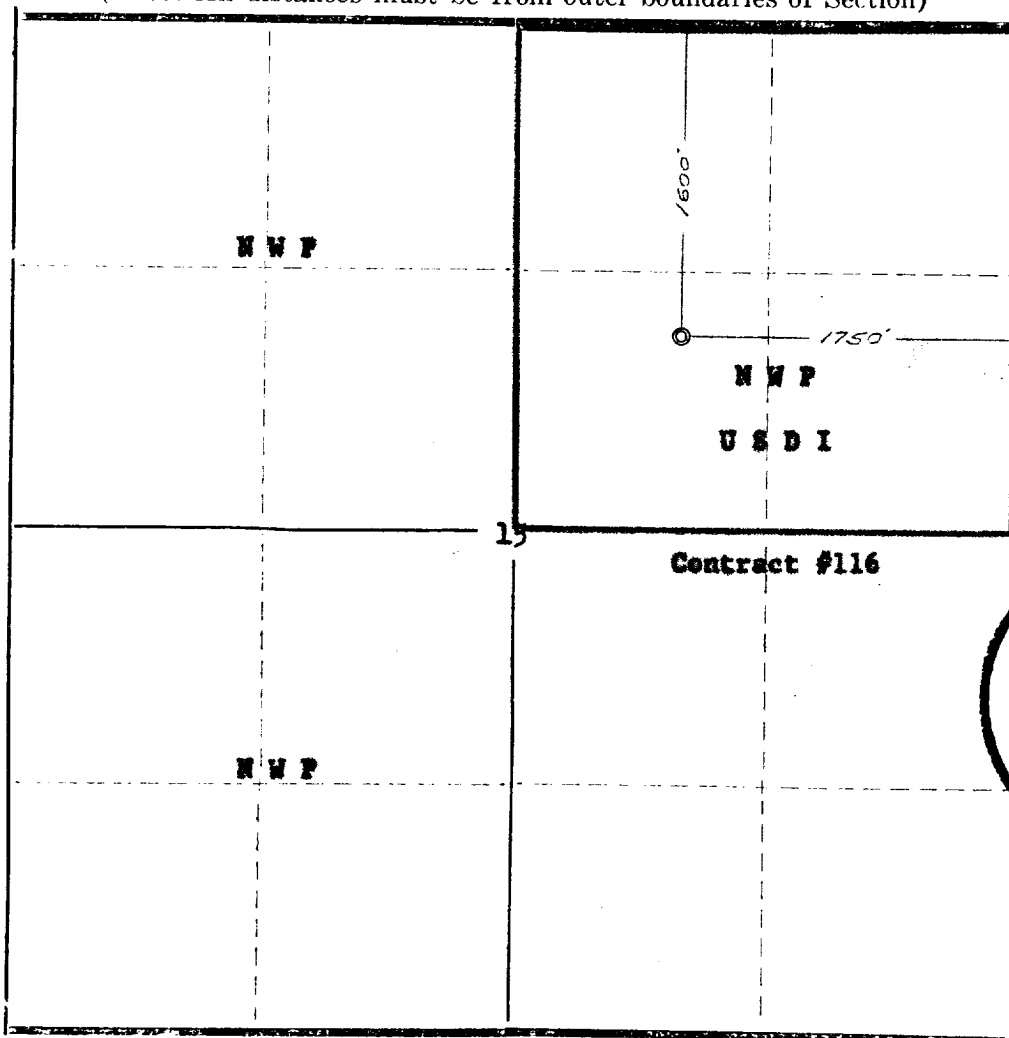

NOTE

This section of form is to be used for gas wells only.



SCALE: 1" = 1000'

1. Is this Well a Dual Comp. ? Yes No **X**
2. If the answer to Question 1 is yes, are there any other dually completed wells within the dedicated acreage?
Yes No

Name **RAY PHILLIPS**
Ray Phillips
Position **Asst Mgr, Production Operations**
Representing **Northwest Production Corporation**
Address **520 Sims Bldg, Albuquerque, N.M.**

This is to certify that the above plat was prepared from field notes of actual surveys made by me or under my supervision and that the same are true and correct to the best of my knowledge and belief.

Date Surveyed **January 16, 1957**

Ernest V. Echohawk
Reg. Land Surveyor, N. Mex., Reg. No. 1545