

NEW MEXICO OIL CONSERVATION COMMISSION  
Well Location and Acreage Dedication Plat

Date Dec. 19, 1957

Section A.

Operator MAGNOLIA PETROLEUM COMPANY Lease JICARILLA "B"  
Well No. 6 Unit Letter        Section 17 Township 26N Range 3W NMPM  
Located 990 Feet From North Line, 990 Feet From East Line  
County Rio Arriba G. L. Elevation 7066 Dedicated Acreage 320 Acres  
Name of Producing Formation Mesa Verde Pool Elanco

1. Is the Operator the only owner\* in the dedicated acreage outlined on the plat below?  
Yes        No       .
2. If the answer to question one is "no," have the interests of all the owners been consolidated by communitization agreement or otherwise? Yes        No       . If answer is "yes," Type of Consolidation
3. If the answer to question two is "no," list all the owners and their respective interests below:

Owner

Land Description

Section B.

N 89° 48' E - 80 ch. (Call)

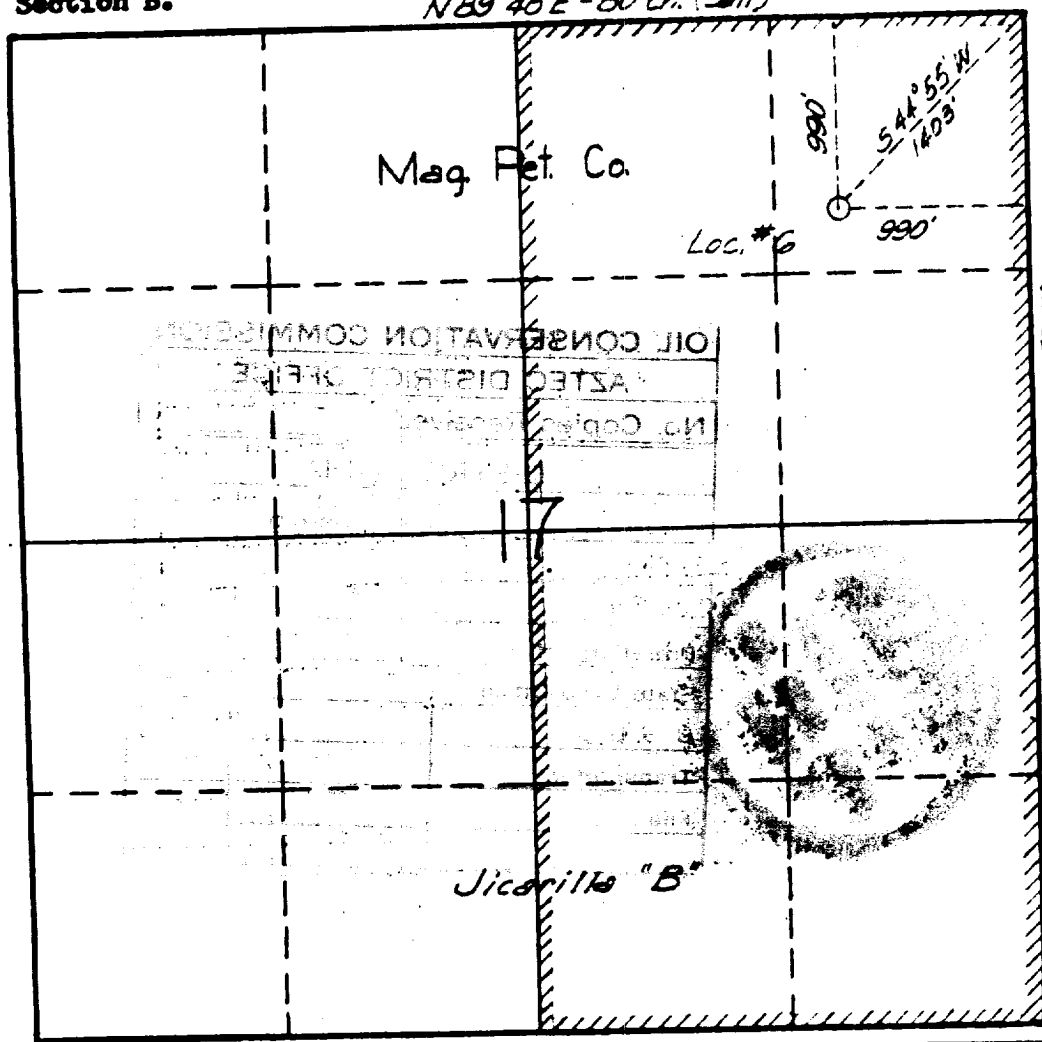

This is to certify that the information in Section A above is true and complete to the best of my knowledge and belief.

Magnolia Petroleum Company

(Operator)  
John Daugherty  
(Representative)  
Box 2406, Hobbs, New Mexico

Address

This is to certify that the well location shown on the plat in Section B was plotted from field notes of actual surveys made by me or under my supervision and that the same is true and correct to the best of my knowledge and belief.

Date Surveyed Sept. 24, 1957

Carl E. Turner  
Registered Professional  
Engineer and/or Land Surveyor

Certificate No. 2400

OIL CONSERVATION COMMISSION		
AZTEC DISTRICT OFFICE		
No. Copies Received <u>5</u>		
DISTRIBUTION		
	NO. FURNISHED	
Operator	<u>2</u>	
Santa Fe	<u>1</u>	
Proration Office		
State Land Office		
U. S. G. S.	<u>1</u>	
Transporter		
File	<u>1</u>	<input checked="" type="checkbox"/>