

NEW MEXICO OIL CONSERVATION COMMISSION

Well Location and Acreage Dedication Plat

Section A.

Date Oct. 7, 1957

Operator MAGNOLIA PETROLEUM COMPANY Lease JICARILLA "D"
Well No. 3 Unit Letter Section 13 Township 26N Range 3W NMPH
Located 99E Feet From North Line, 990 Feet From East Line
County Rio Arriba G. L. Elevation 7298 Dedicated Acreage 320 Acres
Name of Producing Formation Pictured Cliffs Pool Tamarcitos Pictured Cliffs Gas

1. Is the Operator the only owner in the dedicated acreage outlined on the plat below?
Yes No .
2. If the answer to question one is "no," have the interests of all the owners been consolidated by communitisation agreement or otherwise? Yes No . If answer is "yes," Type of Consolidation
3. If the answer to question two is "no," list all the owners and their respective interests below:

Owner

Land Description

Section B.

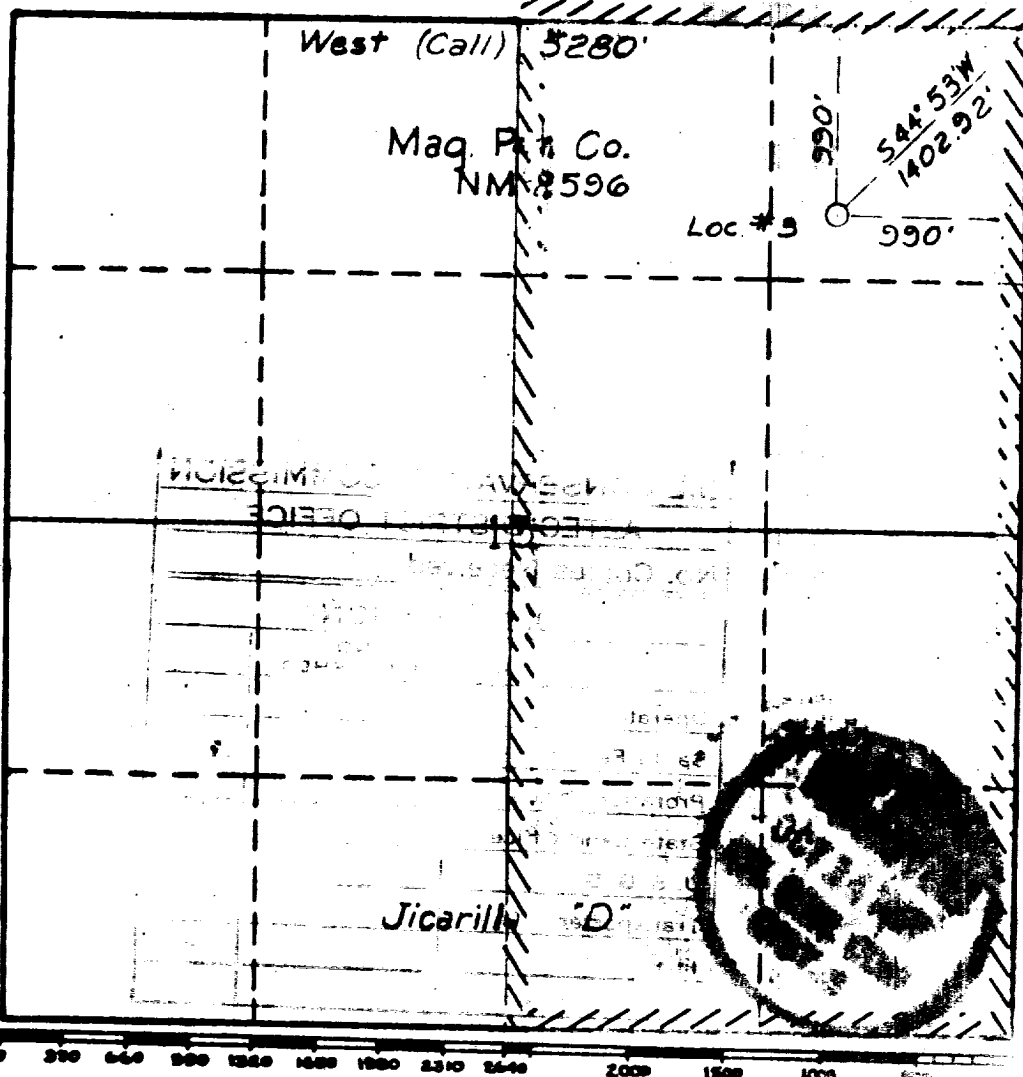

This is to certify that the information in Section A above is true and complete to the best of my knowledge and belief.

Magnolia Petroleum Company
(Operator)
[Signature]
(Representative)

Box 2406, Hobbs, New Mexico
Address

This is to certify that the well location shown on the plat in Section B was plotted from field notes of actual surveys made by me or under my supervision and that the same is true and correct to the best of my knowledge and belief.

Date Surveyed March 23, 1957
[Signature]
Registered Professional Engineer

MAGNOLIA PETROLEUM COMPANY

P. O. Box 2406, Hobbs, New Mexico
October 29, 1957

New Mexico Oil Conservation Commission
P. O. Box 871
Santa Fe, New Mexico

Attention: Mr. A. L. Porter, Jr., Secretary-Director

Re: Jicarilla "D" Well #3
Sec. 13, T-26N, R-3W
Blanco Field
Rio Arriba County, New Mexico

Gentlemen:

Please be advised that we have completed the subject named well as a gas-gas dual completion. Well was completed September 1, 1957.

Attached herewith and in connection with such dual completion, please find schematic diagram showing how the well was equipped and how such well was completed.

Magnolia Petroleum Company's 100% owned property offsets subject well.

Please accept this as our application for administrative approval.

Yours very truly,

Original Signed By
W. C. Dougherty

W. C. Dougherty
District Superintendent



WCD/ees

cc: New Mexico Oil Conservation Commission (Mr. Arnold)

MAGNOLIA PETROLEUM COMPANY

THE MAGNOLIA PETROLEUM COMPANY
IS A FULLY OWNED AND OPERATED
SUBSIDIARY OF THE

AMERICAN PETROLEUM COMPANY
INCORPORATED IN THE STATE OF TEXAS

THE MAGNOLIA PETROLEUM COMPANY
IS A FULLY OWNED AND OPERATED
SUBSIDIARY OF THE

AMERICAN PETROLEUM COMPANY
INCORPORATED IN THE STATE OF TEXAS

THE MAGNOLIA PETROLEUM COMPANY
IS A FULLY OWNED AND OPERATED
SUBSIDIARY OF THE

AMERICAN PETROLEUM COMPANY

THE MAGNOLIA PETROLEUM COMPANY
IS A FULLY OWNED AND OPERATED
SUBSIDIARY OF THE

AMERICAN PETROLEUM COMPANY
INCORPORATED IN THE STATE OF TEXAS

THE MAGNOLIA PETROLEUM COMPANY
IS A FULLY OWNED AND OPERATED
SUBSIDIARY OF THE

AMERICAN PETROLEUM COMPANY

INCORPORATED IN THE STATE OF TEXAS

THE MAGNOLIA PETROLEUM COMPANY
IS A FULLY OWNED AND OPERATED
SUBSIDIARY OF THE

AMERICAN PETROLEUM COMPANY
INCORPORATED IN THE STATE OF TEXAS

AMERICAN PETROLEUM COMPANY

(THE MAGNOLIA PETROLEUM COMPANY IS A FULLY OWNED AND OPERATED
SUBSIDIARY OF THE AMERICAN PETROLEUM COMPANY INCORPORATED IN THE STATE OF TEXAS)

