

Budget Bureau No. 42-R358.4.
Approval expires 12-31-60.

(SUBMIT IN TRIPLICATE)

Land Office **Santa Fe**
Lease No. **NM 03733**
Unit _____

UNITED STATES
DEPARTMENT OF THE INTERIOR
GEOLOGICAL SURVEY

RECEIVED

NOV 4 1957

SUNDRY NOTICES AND REPORTS ON WELLS

NEW MEXICO
FARMINGTON, NEW MEXICO

NOTICE OF INTENTION TO DRILL.....	X	SUBSEQUENT REPORT OF WATER SHUT-OFF.....	
NOTICE OF INTENTION TO CHANGE PLANS.....		SUBSEQUENT REPORT OF SHOOTING OR ACIDIZING.....	
NOTICE OF INTENTION TO TEST WATER SHUT-OFF.....		SUBSEQUENT REPORT OF ALTERING CASING.....	
NOTICE OF INTENTION TO RE-DRILL OR REPAIR WELL.....		SUBSEQUENT REPORT OF RE-DRILLING OR REPAIR.....	
NOTICE OF INTENTION TO SHOOT OR ACIDIZE.....		SUBSEQUENT REPORT OF ABANDONMENT.....	
NOTICE OF INTENTION TO PULL OR ALTER CASING.....		SUPPLEMENTARY WELL HISTORY.....	
NOTICE OF INTENTION TO ABANDON WELL.....			

(INDICATE ABOVE BY CHECK MARK NATURE OF REPORT, NOTICE, OR OTHER DATA)

October 28, 1957

Well No. PC 221 is located 890 ft. from N line and 890 ft. from W line of sec. 13.

NW 1/4 NW 1/4 13 26N 7W 104PM
(1/4 Sec. and Sec. No.) (Twp.) (Range) (Meridian)

South B. lance Rio Arriba New Mexico
(Field) (County or Subdivision) (State or Territory)

The elevation of the Ground surface above sea level is 6506 ft.

DETAILS OF WORK

(State names of and expected depths to objective sands; show sizes, weights, and lengths of proposed casings; indicate mudding jobs, cementing points, and all other important proposed work)

It is proposed to drill well with rotary equipment. Pictured Cliff sand expected at approximately 3000'.

Proposed casing program as follows:

125' 8 5/8" 24# J-55 surface casing cemented with sufficient cement to circulate.

3000' of 5 1/2" casing cemented with 150 sacks.

Well will be perforated and fractured with 42,000# sand for maximum production.

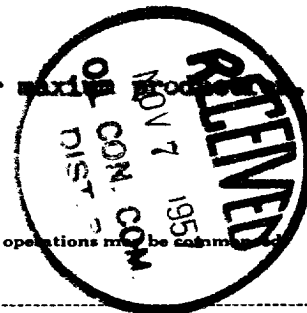

I understand that this plan of work must receive approval in writing by the Geological Survey before operations may be commenced.

Company Tin G. Lowry

Address P. O. Box, 967

Farmington, New Mexico

By Frank Bray

Title Field Superintendent.

APPROVED
JAN 10 1951
JAMES H. HARRIS



NEW MEXICO OIL CONSERVATION COMMISSION

Well Location and Acreage Dedication Plat

Section A.

Date 10-28-57

Operator ~~WILLIAMS STATE OPERATING COMPANY~~ Tim G. Lowry Lease Federal
Well No. R 221 Unit Letter D Section 13 Township 26 North Range 7 West NMPM
Located 890 Feet From North Line, 890 Feet From West Line
County Rio Arriba G. L. Elevation 6506 Dedicated Acreage 160 Acres
Name of Producing Formation Pictured Cliffs Pool South Blanco

1. Is the Operator the only owner* in the dedicated acreage outlined on the plat below?
Yes X No .
2. If the answer to question one is "no," have the interests of all the owners been consolidated by communitization agreement or otherwise? Yes No . If answer is "yes,"
Type of Consolidation
3. If the answer to question two is "no," list all the owners and their respective interests below:

Owner

Land Description

RECEIVED
NOV 4 1957
U. S. GEOLOGICAL SURVEY
FARMINGTON, NEW MEXICO

Section B

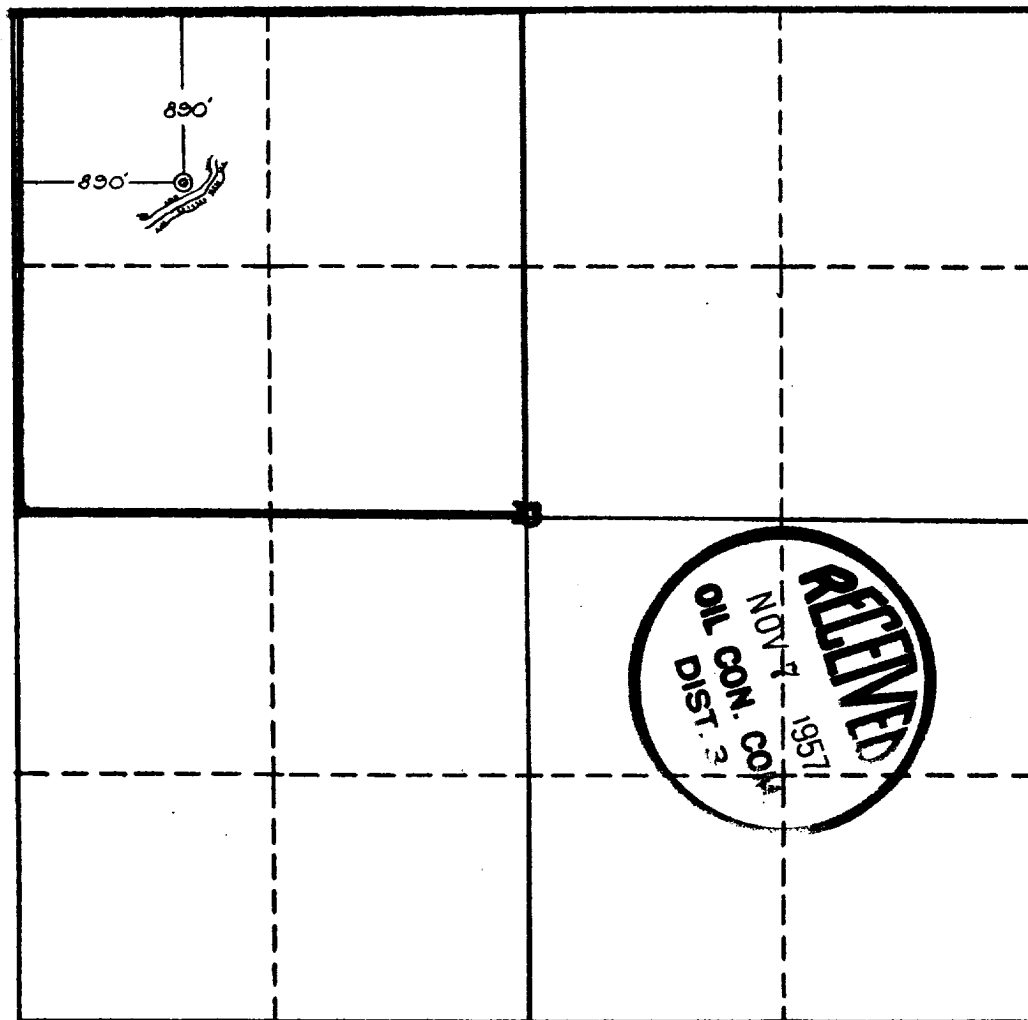

This is to certify that the information in Section A above is true and complete to the best of my knowledge and belief,

Tim G. Lowry
(Operator)

Frank Gray
(Representative)

Farmington, N.M.
Address

This is to certify that the well location shown on the plat in Section B was plotted from field notes of actual surveys made by me or under my supervision and that the same is true to the best of my knowledge and belief.

Date Surveyed October 4, 1957

Ernest V. Echohawk
Ernest V. Echohawk
Registered Land Surveyor.

Certificate No. 1545

