

NEW MEXICO OIL CONSERVATION COMMISSION
Santa Fe, New Mexico

NOTICE OF INTENTION TO DRILL OR RECOMPLETE

Notice must be given to the District Office of the Oil Conservation Commission and approval obtained before drilling or recompletion begins. If changes in the proposed plan are considered advisable, a copy of this notice showing such changes will be returned to the sender. Submit this notice in QUINTUPLICATE. One copy will be returned following approval. See additional instructions in Rules and Regulations of the Commission.

Farmington, New Mexico

(Place)

September 17, 1953

(Date)

OIL CONSERVATION COMMISSION
SANTA FE, NEW MEXICO

Gentlemen:

You are hereby notified that it is our intention to commence the (Drilling) (~~Recompletion~~) of a well to be known as

El Paso Natural Gas Company

(Company or Operator)

Hamilton State

(Lease)

Well No. 1

in NW 1/4

(Unit)

The well is

located 869 feet from the North line and 1110 feet from the

West

line of Section 16, T. 26N

R. 7W, NMPM.

(GIVE LOCATION FROM SECTION LINE)

South Blanco

Pool,

Rio Arriba

County

If State Land the Oil and Gas Lease is No. E-4425 and B-11183

If patented land the owner is

Address

We propose to drill well with drilling equipment as follows: Rotary tools to and through the Pictured Cliffs formation.

The status of plugging bond is

Drilling Contractor

Company Tools

/ We intend to complete this well in the Pictured Cliffs formation at an approximate depth of 220 feet.

CASING PROGRAM

We propose to use the following strings of Casing and to cement them as indicated:

Size of Hole	Size of Casing	Weight per Foot	New or Second Hand	Depth	Sacks Cement
<u>12-1/8</u>	<u>9-5/8</u>	<u>36#</u>	<u>New</u>	<u>160</u>	<u>Circulated</u>
<u>7-7/8</u>	<u>5 1/2</u>	<u>15.5#</u>	<u>New</u>	<u>2221</u>	<u>150 sks</u>

If changes in the above plans become advisable we will notify you immediately.

ADDITIONAL INFORMATION (If recompletion give full details of proposed plan of work.)

The NW 1/4 is dedicated to this well. The necessary committment of the state leases E-4425 and B-11183 will be filed with the state.

Approved
Except as follows:

9-21, 1953

Sincerely yours,

EL PASO NATURAL GAS COMPANY

(Company or Operator)

By

Position Petroleum Engineer.

Send Communications regarding well to

Name D. E. Lockett

Address Box 997 Farmington, New Mexico

OIL CONSERVATION COMMISSION

By

Title

Oil and Gas Inspector Dist. #3

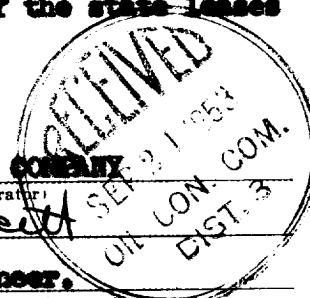

COMPANY El Paso Natural Gas Company
Well Name & No. Hamilton - State #1 Lease No. E-4425
Location 869 ft. from the north line, 1110 ft. from the west line
Being in NW $\frac{1}{4}$ of the NW $\frac{1}{4}$
Sec. 16, T 26N., R 7W., N.M.P.M., Rio Arriba County, N. M.
Ground Elevation 6163.49

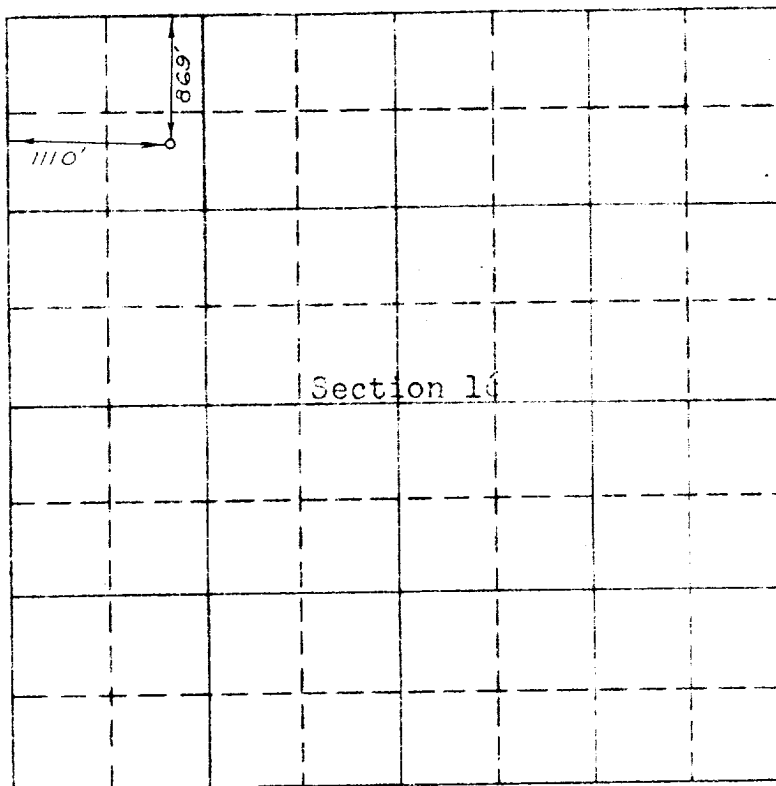

Scale -- 4 inches equals 1 mile

Surveyed September 13, 19 53

This is to certify that the above plat was prepared from field notes of actual surveys made by me or under my supervision and that the same are true and correct to the best of my knowledge and belief.

E. O. Walker

Registered Professional
Engineer and Land Surveyor.

Seal:

Farmington, New Mexico

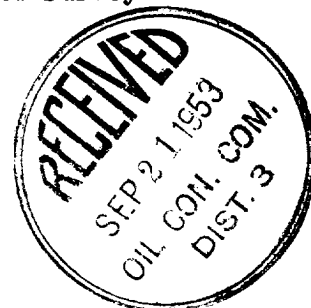

OIL CONSERVATION COMMISSION		
AZTEC DISTRICT OFFICE		
No. Copies Received <u>7</u>		
DISTRIBUTION		
	NO. FURNISHED	
Operator	<u>2</u>	
Santa Fe	<u>1</u>	
Proration Office		
State Land Office	<u>1</u>	
S. G. S.	<u>2</u>	
Transporter		
File	<u>1</u>	<input checked="" type="checkbox"/>