

NEW MEXICO OIL CONSERVATION COMMISSION

Well Location and Acreage Dedication Plat

SECTION A.

Date September 1, 1963

Operator Caulkins Oil Company Lease Breech "C"
 Well No. D-248 Unit Letter A Section 13 Township 26 North Range 6 West NMPM
 Located 1140 Feet From North Line, 900 Feet From East Line
 County Rio Arriba G. L. Elevation 6520 Dedicated Acreage 40 Acres
 Name of Producing Formation Gallup (Tocito) Pool Undesignated Wildcat

1. Is the Operator the only owner* in the dedicated acreage outlined on the plat below? Yes XX No _____
2. If the answer to question One is "No," have the interests of all the owners been consolidated by communitization agreement or otherwise? Yes _____ No _____ If answer is "Yes," Type of Consolidation _____
3. If the answer to question Two is "No," list all the owners and their respective interests below:

OWNER

LAND DESCRIPTION

SECTION B.

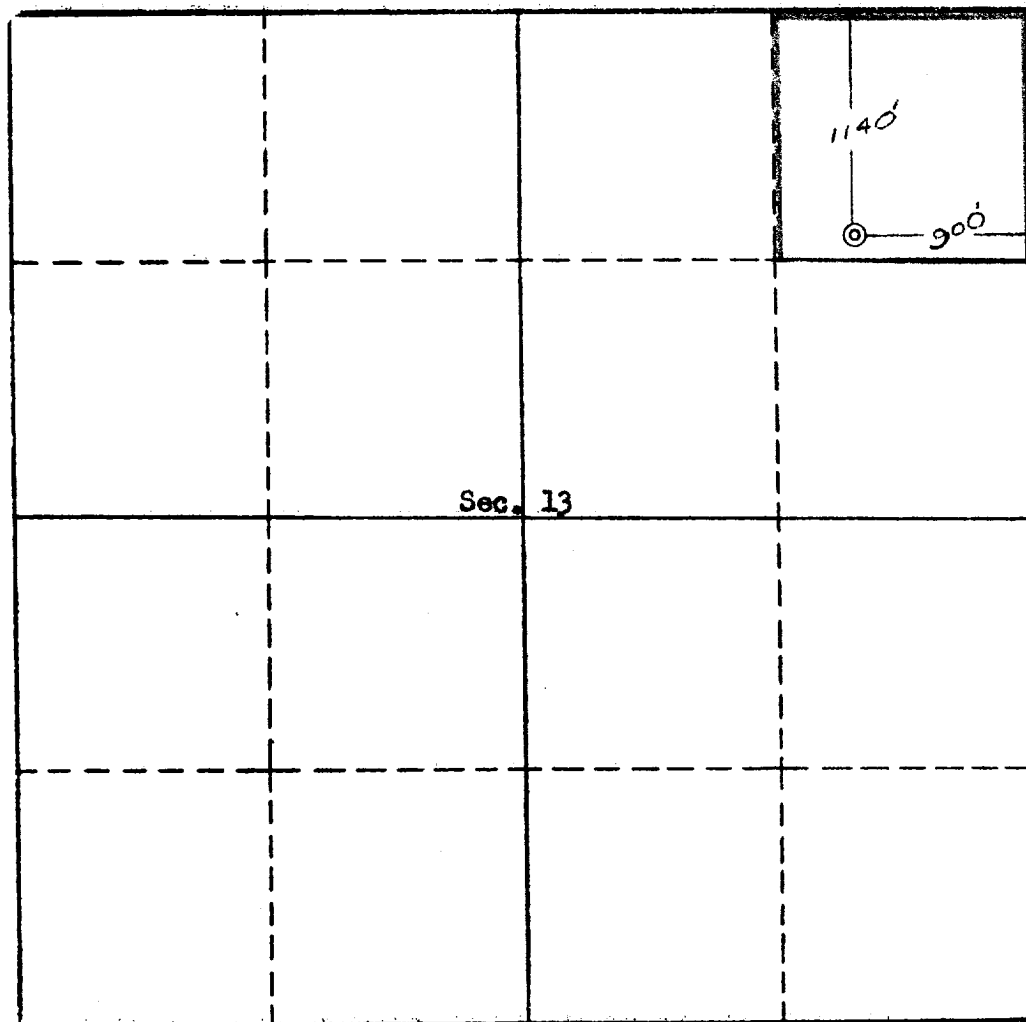

RECEIVED

DEC 17 1963

OIL CON. COM.
DIST. 3

This is to certify that the information in Section A above is true and complete to the best of my knowledge and belief.

Caulkins Oil Company

OPERATOR

Frank Gray
 Frank Gray

(REPRESENTATIVE)

Box 780, Farmington, N.M.

This is to certify that the well location shown on the plat in Section B was plotted from field notes of actual surveys made by me or under my supervision and that the same is true and correct to the best of my knowledge and belief.

Date Surveyed Sept. 1, 1963

Four States Engineering Co.
 FARMINGTON, NEW MEXICO

Carroll W. Cochran
 REGISTERED ENGINEER OR
 LAND SURVEYOR

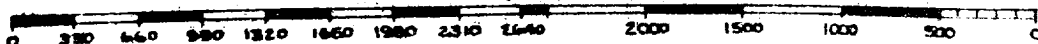
Certificate No. 3602

5

27.

File ✓

2 Waps

6 per