

(SUBMIT IN TRIPLICATE)

UNITED STATES
DEPARTMENT OF THE INTERIOR
GEOLOGICAL SURVEY

Land Office **Santa Fe**
Lease No. **079160**
Unit **Rincon Unit**

SUNDRY NOTICES AND REPORTS ON WELLS

NOTICE OF INTENTION TO DRILL	<input checked="" type="checkbox"/>	SUBSEQUENT REPORT OF WATER SHUT-OFF	
NOTICE OF INTENTION TO CHANGE PLANS		SUBSEQUENT REPORT OF SHOOTING OR ACIDIZING	
NOTICE OF INTENTION TO TEST WATER SHUT-OFF		SUBSEQUENT REPORT OF ALTERING CASING	
NOTICE OF INTENTION TO RE-DRILL OR REPAIR WELL		SUBSEQUENT REPORT OF RE-DRILLING OR REPAIR	
NOTICE OF INTENTION TO SHOOT OR ACIDIZE		SUBSEQUENT REPORT OF ABANDONMENT	
NOTICE OF INTENTION TO PULL OR ALTER CASING		SUPPLEMENTARY WELL HISTORY	
NOTICE OF INTENTION TO ABANDON WELL			

(INDICATE ABOVE BY CHECK MARK NATURE OF REPORT, NOTICE, OR OTHER DATA)

January 8, 1957

Well No. **93** is located **800** ft. from **S** line and **1050** ft. from **E** line of sec. **11**
SE Section 11 **26N** **7W** **14E**
($\frac{1}{4}$ Sec. and Sec. No.) (Twp.) (Range) (Meridian)
So. Blanco P.C. **Rio Arriba** **New Mexico**
(Field) (County or Subdivision) (State or Territory)

The elevation of the derrick floor above sea level is **6517** ft.

DETAILS OF WORK

(State names of and expected depths to objective sands; show sizes, weights, and lengths of proposed casings; indicate mudding jobs, cementing points, and all other important proposed work)

It is intended to drill a well thru the Pictured Cliff formation using rotary tools and to perforate and water fracture possible producing zones. Estimated T.D. 2820'.

Casing Program:

9 5/8" at 120' with 125 sacks regular cement circulated to surface.
5 1/2" at 2820' with 75 sacks regular cement, 75 sacks Pozmix.

The SE $\frac{1}{4}$ of Section 11 is dedicated to this well.
SE $\frac{1}{4}$ SP 079160.

I understand that this plan of work must receive approval in writing by the Geological Survey before operations may be commenced.

Company **El Paso Natural Gas Company**

Address **Box 997**

Farmington, New Mexico

By

Title **Petroleum Engineer**

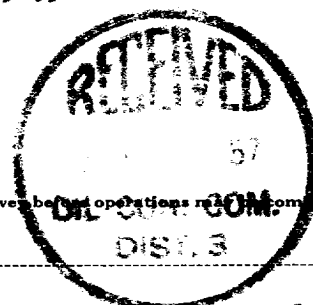

OR G NAL SIGNED E. S. OBERLY

DECEMBER 28, 1956

EL PASO NATURAL GAS COMPANY

RINCON UNIT

SF 079160

93

11

26 N

7 W

800

SOUTH

1050

EAST

RIO ARRIBA

6507

PICTURED CLIFF

SO. BLANCO

160 AC.
(1882 PLAT)

Note: All dimensions are in feet unless otherwise stated.

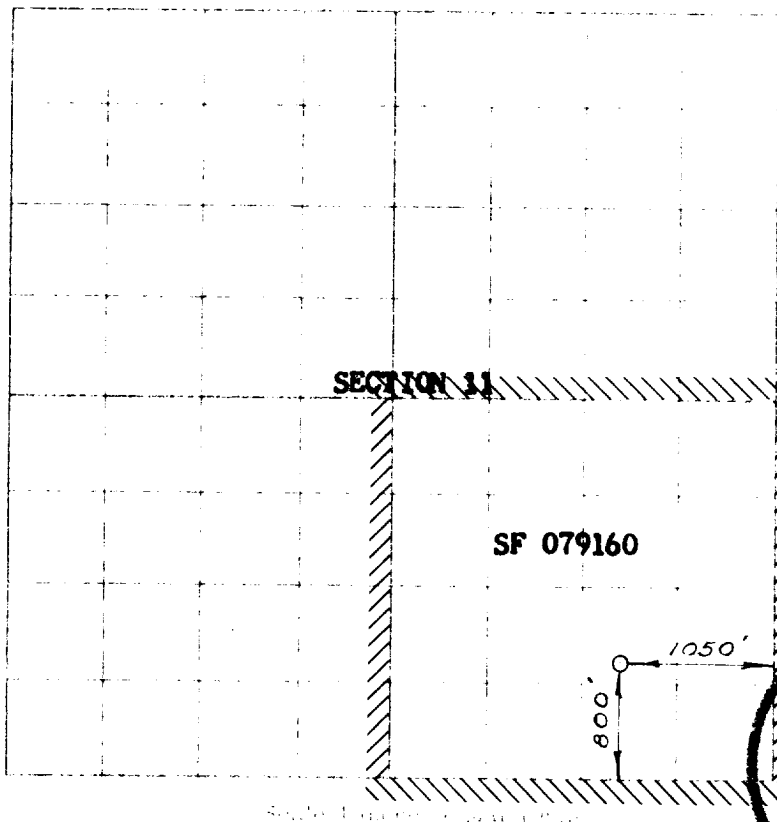

Scale: 1 inch = 100 feet



I hereby certify that the above plat was prepared from the most reliable surveys made from a careful inspection and that the same are true and correct to the best of my knowledge and belief.

Date Surveyed **DECEMBER 26, 1956**

E. O. Walker
Registered Professional Engineer and of Land Surveyor

1. Is the plat correct?
Yes _____
2. If the answer to question 1 is "No", please state the reasons therefor.
No _____
3. If the answer to question 1 is "No", please state the reasons therefor.
No _____

ORIGINAL SIGNED E. S. OBERLY

Petroleum Engineer

El Paso Natural Gas Co.

Box 997, Farmington, N.M.