

Form 9-321a
(Feb. 1961)

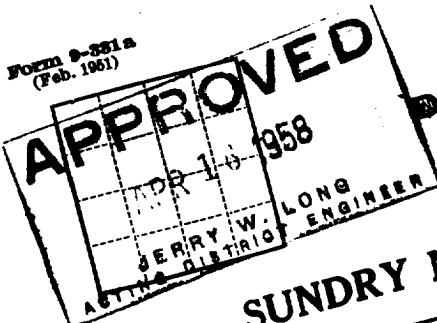

(SUBMIT IN TRIPLICATE)

UNITED STATES
DEPARTMENT OF THE INTERIOR
GEOLOGICAL SURVEY

Land Office
Lease No. 079160
Unit Rincon Unit

FINAL APPROVAL RECEIVED APRIL 16, 1958

SUNDRY NOTICES AND REPORTS ON WELLS

NOTICE OF INTENTION TO DRILL
NOTICE OF INTENTION TO CHANGE PLANS
NOTICE OF INTENTION TO TEST WATER SHUT-OFF
NOTICE OF INTENTION TO RE-DRILL OR REPAIR WELL
NOTICE OF INTENTION TO SHOOT OR ACIDIZE
NOTICE OF INTENTION TO PULL OR ALTER CASING
NOTICE OF INTENTION TO ABANDON WELL

SUBSEQUENT REPORT OF WATER SHUT-OFF
SUBSEQUENT REPORT OF SHOOTING OR ACIDIZING
SUBSEQUENT REPORT OF ALTERING CASING
SUBSEQUENT REPORT OF RE-DRILLING OR REPAIR
SUBSEQUENT REPORT OF ABANDONMENT
SUPPLEMENTARY WELL HISTORY

(INDICATE ABOVE BY CHECK MARK NATURE OF REPORT, NOTICE, OR OTHER DATA)

Well No. 102 is located 990 ft. from S line and 990 ft. from W line of sec. 11, 1958
SW (1/4 Sec. and Sec. No.)
Blanco (Field)
26N (Twp.)
7W (Range)
Rio Arriba (County or Subdivision)
N.M.P.M. (Meridian)
New Mexico (State or Territory)

The elevation of the derrick floor above sea level is 6520 ft.

DETAILS OF WORK

(State names of and expected depths to objective sands; show sizes, weights, and lengths of proposed casings; indicate mudding jobs, ing points, and all other important proposed work)

It is intended to drill a well with rotary tools thru the Mesa Verde formation and circulation will be used thru the Pictured Cliffs and set intermediate gas circulation will be used thru the Mesa Verde and production liner will set. Possible productive intervals will be perforated and fractured. T.D. 5154'.

Casing Program:
10 3/4" at 170' with 150 sacks cement circulated to the
7 5/8" at 2879' with 250 sacks cement.
5 1/2" liner at 2840-5154' with 300 sacks cement.

The 1/2 of Section 11 is dedicated to this well.
1/2: Santa Fe 079160

I understand that this plan of work must receive approval in writing by the Geological Survey before operations may

Company El Paso Natural Gas Company
Address Box 997
Farmington, New Mexico

By [Signature]
Title Petroleum Engineer

10/10/1944
10/10/1944
10/10/1944

NEW MEXICO OIL CONSERVATION COMMISSION

Well Location and Acreage Dedication Plat

Section A.

Date **APRIL 18, 1958**

Operator **EL PASO NATURAL GAS COMPANY** Lease **RINCON** SF **079160**
 Well No. **102** Unit Letter **M** Section **11** Township **26-N** Range **7-N** NMPM
 Located **990** Feet From **SOUTH** Line, **990** Feet From **WEST** Line
 County **RIO ARriba** G. L. Elevation **6510** Dedicated Acreage **320** Acres
 Name of Producing Formation **MESA VERDE** Pool **BLANCO MESA VERDE EXTENSION**

1. Is the Operator the only owner in the dedicated acreage outlined on the plat below?
 Yes ☒ No ☐
2. If the answer to question one is "no", have the interests of all the owners been consolidated by communitization agreement or otherwise? Yes ☐ No ☐ If answer is "yes", Type of Consolidation.

3. If the answer to question two is "no", list all the owners and their respective interests below:

Owner

Land Description

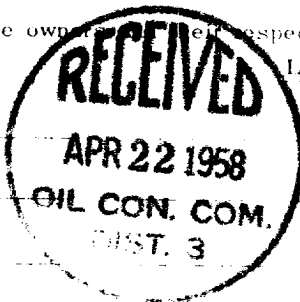

Section B.

This is to certify that the information in Section A above is true and complete to the best of my knowledge and belief.

El Paso Natural Gas Company
 (Operator)

Original Signed **D. C. Johnson**
 (Representative)

Box 997
 (Address)

Farmington, New Mexico

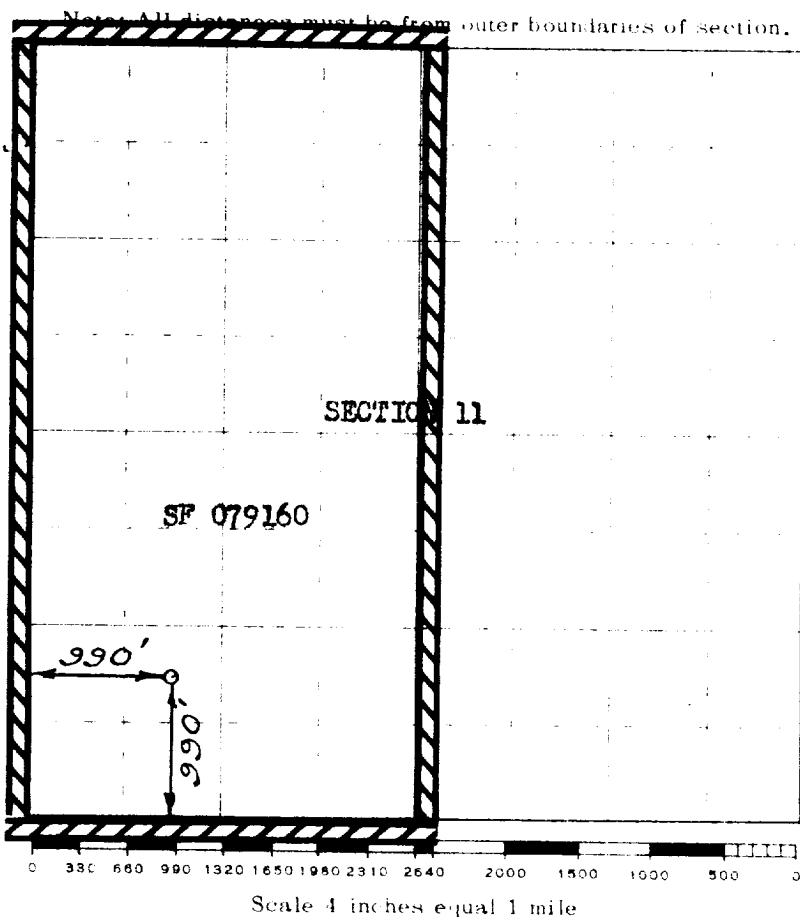

This is to certify that the above plat was prepared from field notes of actual surveys made by me or under my supervision and that the same are true and correct to the best of my knowledge and belief.

(Seal)

Date Surveyed

MARCH 4, 1958

David C. Kilmer
 Registered Professional Engineer and/or Land Surveyor

Farmington, New Mexico