



COPY TO O.C.C.

IN REPLY REFER TO:

UNITED STATES
DEPARTMENT OF THE INTERIOR
GEOLOGICAL SURVEY
P. O. Box 965
Farmington, New Mexico

June 15, 1955

Honolulu Oil Corporation
P. O. Drawer 1391
Midland, Texas

Re: Jicarilla Contract #102

Gentlemen:

Receipt is acknowledged of your "Notice of Intention to Drill" dated June 9, 1955 covering your well No. 1 Jicarilla in SW¹/₄ sec. 10, T. 26 N., R. 4 W., N. M. P. M., Rio Arriba County, New Mexico, Wildcat pool.

Your proposed work is hereby approved subject to compliance with the provisions of the "Oil and Gas Operating Regulations" revised May 25, 1942, a copy of which will be sent to you on request, and subject to the following conditions:

1. Drilling operations so authorized are subject to the attached sheet for general conditions of approval.
2. Furnish copies of all logs.

Very truly yours,

(Orig. Sgd.) P. T. McGRATH

P. T. McGrath
District Engineer

PTMcGrath:ac

Jicarilla Agency



UNITED STATES
DEPARTMENT OF THE INTERIOR
GEOLOGICAL SURVEY
WASHINGTON, D. C. 20540

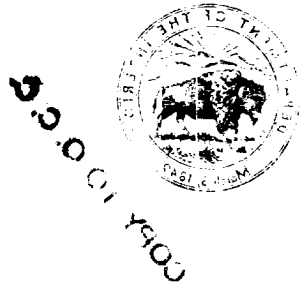

[Faint, mostly illegible text body of the letter]



[Faint text at bottom right]

(SUBMIT IN TRIPLICATE)

UNITED STATES
DEPARTMENT OF THE INTERIOR
GEOLOGICAL SURVEY

Indian Agency INDIAN AGENCY

INDIAN AGENCY

Allottee INDIAN AGENCY

Cont. # 102

Lease No. 102

SUNDRY NOTICES AND REPORTS ON WELLS

RECEIVED
JUN 27 1955
GEOLOGICAL SURVEY
NEW MEXICO

NOTICE OF INTENTION TO DRILL	<input checked="" type="checkbox"/>	SUBSEQUENT REPORT OF WATER SHUT-OFF	
NOTICE OF INTENTION TO CHANGE PLANS		SUBSEQUENT REPORT OF SHOOTING OR ACIDIZING	
NOTICE OF INTENTION TO TEST WATER SHUT-OFF		SUBSEQUENT REPORT OF ALTERING CASING	
NOTICE OF INTENTION TO REDRILL OR REPAIR WELL		SUBSEQUENT REPORT OF REDRILLING OR REPAIR	
NOTICE OF INTENTION TO SHOOT OR ACIDIZE		SUBSEQUENT REPORT OF ABANDONMENT	
NOTICE OF INTENTION TO PULL OR ALTER CASING		SUPPLEMENTARY WELL HISTORY	
NOTICE OF INTENTION TO ABANDON WELL			

(INDICATE ABOVE BY CHECK MARK NATURE OF REPORT, NOTICE, OR OTHER DATA)

June 2, 1955

Well No. 1 is located 920 ft. from S line and 1400 ft. from W line of sec. 30

14 Sec. 30 (1/4 Sec. and Sec. No.) T-46-N (Twp.) R-1-E (Range) 100W (Meridian)
W. C. (Field) INDIAN AGENCY (County or Subdivision) INDIAN AGENCY (State or Territory)

The elevation of the derrick floor above sea level is 1 ft. Not yet surveyed

RECEIVED
JUN 27 1955
OIL CON. COM.
DIST. 3

DETAILS OF WORK

(State names of and expected depths to objective sands; show sizes, weights, and lengths of proposed casings; indicate mudlogging jobs, cementing points, and all other important proposed work)

1. 9 5/8" casing to be set below 200' and cemented from shoe to bottom of casing.
2. Objective sand is Pictured Cliff. Top of this formation will be encountered at 2 1/2'.
3. 7" casing will be set 2 1/2' below the top of the pay sand and cemented with 250 cu.
4. Drill through the pay sand with rotary diamond core barrel with gas after 7" casing is cemented and tested.

I understand that this plan of work must receive approval in writing by the Geological Survey before operations may be commenced.

Company INDIAN OIL CORPORATION

Address P. O. BOX 1391

INDIAN, TEXAS

By H. T. Schneider

Title REGIONAL GEOLOGIST

Company Honolulu Oil Co.

Lease Jicarilla Apache

Well No. 1

Sec. 10

T. 26 N

R. 4 W N.M.P.M.

Location 990 feet from south line; 1650 feet
from west line;

Elevation: 6828 GL

Rio Arriba County

New Mexico

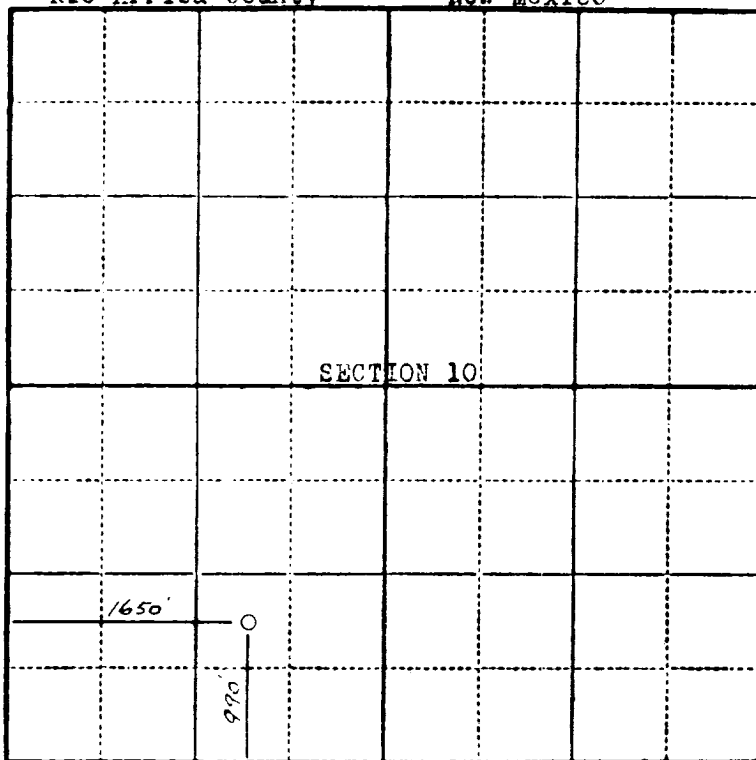

Scale—4 inches equal 1 mile.

This is to certify that the above plat was prepared from field notes of actual surveys made by me or under my supervision and that the same are true and correct to the best of my knowledge and belief

Stephen H. Kinney

STEPHEN H. KINNEY
Registered Professional
Engineer and Land Surveyor

Surveyed June 13

, 19 55

(SUBMIT IN TRIPLICATE)

Indian Agency _____

ARMINGTOWN

UNITED STATES
DEPARTMENT OF THE INTERIOR
GEOLOGICAL SURVEY

WATER WELL RECORD

Lease No. _____

Corb # **202**

APPROVED

JUN 15 1955

DISTRICT ENGINEER

SUNDRY NOTICES AND REPORTS ON WELLS

NOTICE OF INTENTION TO DRILL	<input checked="" type="checkbox"/>	SUBSEQUENT REPORT OF WATER SHUT-OFF	
NOTICE OF INTENTION TO CHANGE PLANS	<input checked="" type="checkbox"/>	SUBSEQUENT REPORT OF SHOOTING OR ACIDIZING	
NOTICE OF INTENTION TO TEST WATER SHUT-OFF		SUBSEQUENT REPORT OF ALTERING CASING	
NOTICE OF INTENTION TO REDRILL OR REPAIR WELL		SUBSEQUENT REPORT OF REDRILLING OR REPAIR	
NOTICE OF INTENTION TO SHOOT OR ACIDIZE		SUBSEQUENT REPORT OF ABANDONMENT	
NOTICE OF INTENTION TO PULL OR ALTER CASING		SUPPLEMENTARY WELL HISTORY	
NOTICE OF INTENTION TO ABANDON WELL			

(INDICATE ABOVE BY CHECK MARK NATURE OF REPORT, NOTICE, OR OTHER DATA)

RECEIVED
JUN 15 1955
U.S. GEOLOGICAL SURVEY
ARMINGTOWN, NEW MEXICO

June 10, 1955

Well No. **1** is located **990** ft. from **S** line and **1000** ft. from **W** line of sec. **20**

21/4 of **NE 1/4** of Sec. **20** **T-10-S** **R-1-E**
(Or Sec. and Sec. No.) (Twp.) (Range) (Meridian)

W.C. **W.C. ADAMS** **NEW MEXICO**
(Field) (County or Subdivision) (State or Territory)

The elevation of the derrick floor above sea level is **Not yet surveyed** ft.

DETAILS OF WORK

(State names of and expected depths to objective sands; show sizes, weights, and lengths of proposed casings; indicate mudding jobs, cementing points, and all other important proposed work)

FOLLOWING IS THE ANTICIPATED CASING PROGRAM:

1. **3 1/2" casing to be set at \pm 250' and cemented from shoe to bottom of casing.**
2. **Objective sand is Pictured Cliffs. Top of this formation will be encountered at \pm 1000'.**
3. **5 1/2" casing will be set \pm 5' below the top of the pay sand and cemented with 250 sand.**
4. **Drill through pay sand with rotary diamond core barrel with gas after 5 1/2" casing is set.**

I understand that this plan of work must receive approval in writing by the Geological Survey before operations may be commenced.

Company **MINUTEMAN OIL CORPORATION**

Address **P. O. BOX 1391**

MURKIN, TEXAS

By **George R. Hoy**

Title **REGIONAL DEVELOPMENT ENGINEER**