

District I
P.O. Box 1980, Hobbs, NM
JAN 2 1989
District II
P.O. Drawer 00, Artesia,
NM 88221

State of New Mexico
Energy, Minerals and Natural Resources Dept.

SUBMIT 1 COPY TO
APPROPRIATE
DISTRICT OFFICE
AND 1 COPY TO
SANTA FE OFFICE

District III
1000 Rio Brazos Rd, Aztec,
NM 87410

OIL CONSERVATION DIVISION
2040 S. Pacheco
Santa Fe, New Mexico 87504

PIT REMEDIATION AND CLOSURE REPORT

Operator: Caulkins Oil Company

Telephone: (505) 632-1544

Address: P.O. Box 340, Bloomfield, NM 87413

Facility or Well Name: Breech "A" 204

Location: Unit or Qtr/Qtr P Sec 9 T 26N R 6W County Rio Arriba

Pit Type: Separator X Dehydrator Other

Land Type: BLM X, State , Fee , Other

Pit Location: Pit dimensions: length 20', width 20', depth 4'
(Attach diagram)

References: wellhead X, other

Footage from reference: 78'

Direction from reference: 300 Degrees East North X
of
X West South

Depth to Ground Water:
(Vertical distance from
contaminants to seasonal high
water elevation of ground water)

Less than 50 feet	(20 points)	
50 feet to 99 feet	(10 points)	
Greater than 100 feet	(0 points)	<u>0</u>

Wellhead Protection Area:
(Less than 200 feet from a
private domestic water source,
or; less than 1000 feet from all
other water sources)

Yes	(20 points)	
No	(0 points)	<u>0</u>

Distance to Surface Water:
(Horizontal distance to perennial
lakes, ponds, rivers, streams,
creeks, irrigation canals and
ditches)

Less than 200 feet	(20 points)	
200 feet to 1000 feet	(10 points)	
Greater than 1000 feet	(0 points)	<u>0</u>

RANKING SCORE (TOTAL POINTS): 0

Remediation Method: Excavation X Approx. cubic yards 74
Check all appropriate sections; Landfarmed X Insitu Bioremediation
Other

General Description of Remedial Action: Aeration and Dilution

Final Pit: Sample Location Bottom of pit and landfarm
 Closure Sampling: _____
 (if multiple samples, _____
 attach sample results _____
 and diagram of sample Sample depth 6' Rock

TPH Landfarm: 387.4 ppm Pit: 559 ppm

SIGNATURE Robert L. Verquer PRINTED NAME
AND TITLE ROBERT L. VERQUER, SUPERINTENDENT

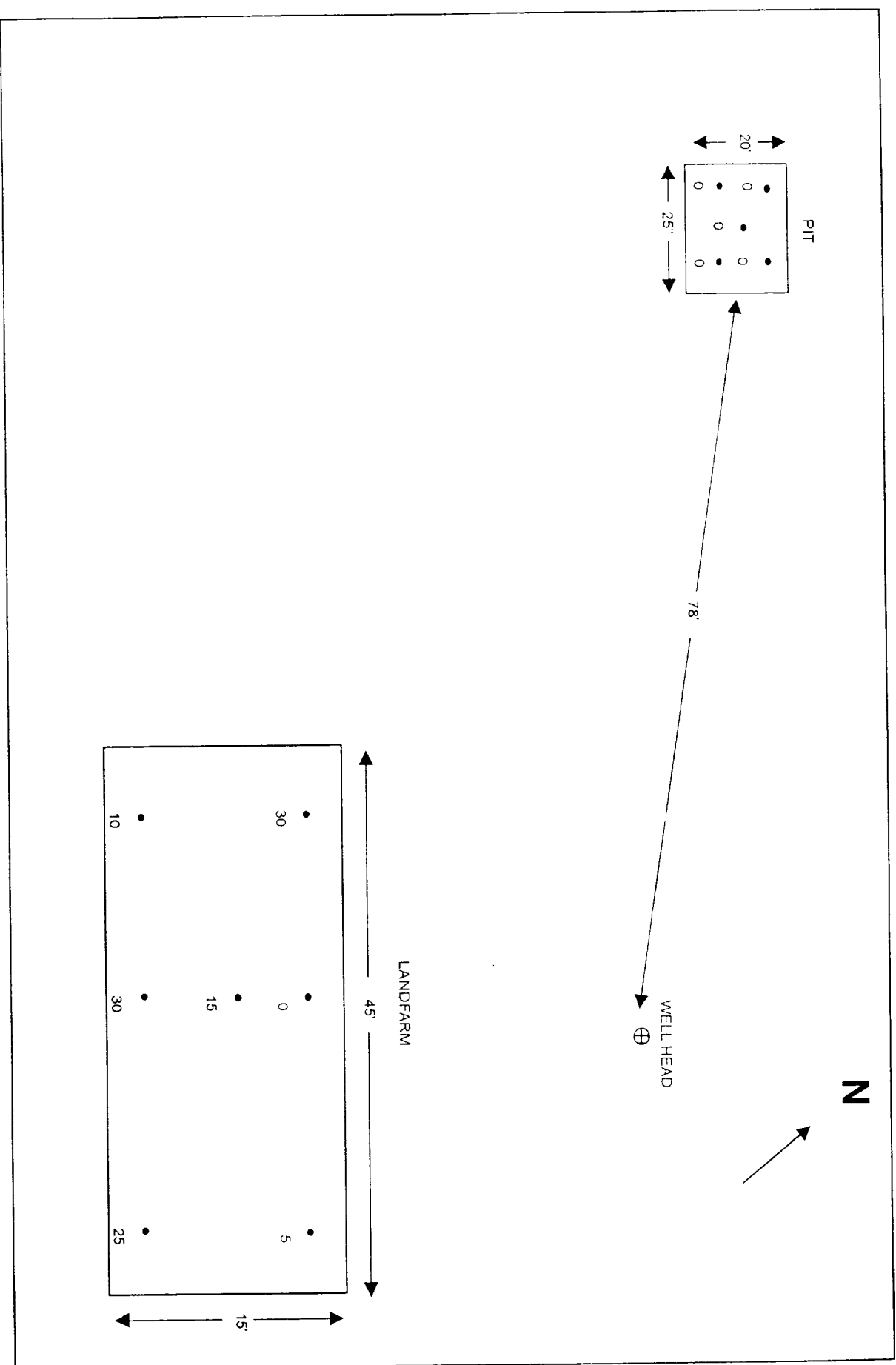

ANAITAS ENVIRONMENTAL LABS
Operated under contract by:
CDS Laboratories
75 Suttle Street
PO Box 2605
Durango, CO 81302

Phone: (970)-247-4220
Fax : (970)-247-4227

Report Date: 09/17/97

ANALYSIS REPORT

Attn:

CAULKINS OIL CO
PO BOX 340
BLOOMFIELD, NM 87413

Our Lab #: A97-133158 (7639)
Sample ID: BREECH A 204 (LAND FARM)
Date Login: 08/19/97
Date Rec'd: 08/18/97

COLLECTION INFORMATION

Date/Time/By: 08/12/97 1310
Location:

Lab#	Testname	Result	Units
<hr/>			
A97-133158	BENZENE	< 0.125	ppm
	ETHYL BENZENE	< 0.125	ppm
	TOLUENE	< 0.125	ppm
	XYLENE (TOTAL)	1.239	ppm
	Diesel Range Organics	375	ppm
	Gasoline Range Organics	12.4	ppm

Approved By: Cynthia Pomeroy Checked By: D3

ANAITAS ENVIRONMENTAL LABS
Operated under contract by:
CDS Laboratories
75 Suttle Street
PO Box 2605
Durango, CO 81302

Phone: (970)-247-4220
Fax : (970)-247-4227

Report Date: 09/17/97

ANALYSIS REPORT

Attn:

CAULKINS OIL CO
PO BOX 340
BLOOMFIELD, NM 87413

Our Lab #: A97-133159 (7639)
Sample ID: BREECH A 204 (PIT BOTTOM)
Date Login: 08/19/97
Date Rec'd: 08/18/97

COLLECTION INFORMATION

Date/Time/By: 08/12/97 1310
Location:

Lab#	Testname	Result	Units
A97-133159	BENZENE	0.158	ppm
	ETHYL BENZENE	< 0.125	ppm
	TOLUENE	< 0.125	ppm
	XYLENE (TOTAL)	< 0.250	ppm
	Diesel Range Organics	544	ppm
	Gasoline Range Organics	15.9	ppm

Approved By: Cynthia Toru Checked By: DZ

WELL NAME: Breech A 204

CAULKINS OIL
SITE SECURITY DIAGRAM

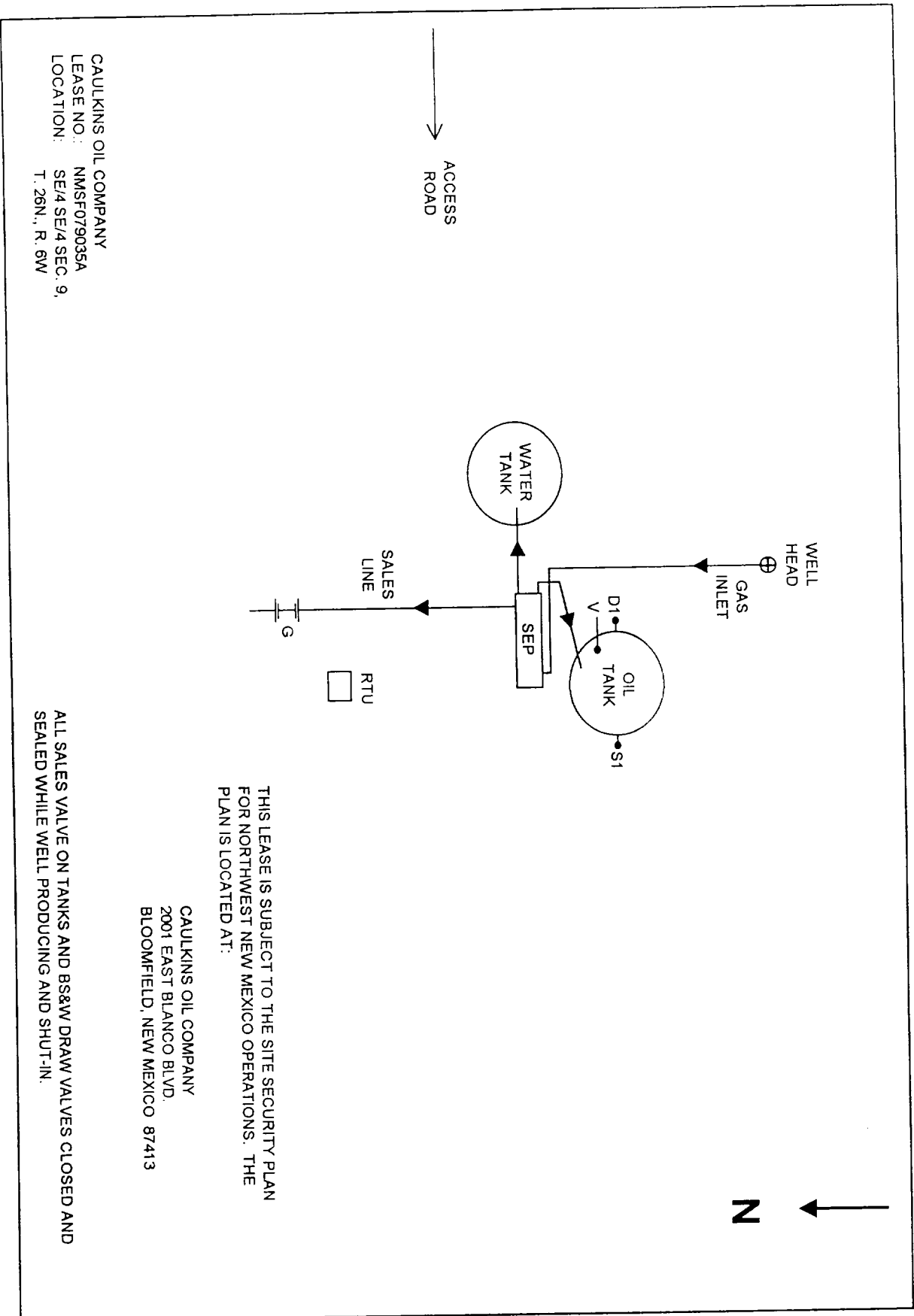

CAULKINS OIL COMPANY
LEASE NO.: NMSF079035A
LOCATION: SE/4 SE/4 SEC. 9,
T. 26N., R. 6W

THIS LEASE IS SUBJECT TO THE SITE SECURITY PLAN
FOR NORTHWEST NEW MEXICO OPERATIONS. THE
PLAN IS LOCATED AT:

CAULKINS OIL COMPANY
2001 EAST BLANCO BLVD.
BLOOMFIELD, NEW MEXICO 87413

ALL SALES VALVE ON TANKS AND BS&W DRAW VALVES CLOSED AND
SEALED WHILE WELL PRODUCING AND SHUT-IN.