

JICARILLA APACHE TRIBE  
ENVIRONMENTAL PROTECTION OFFICE  
P.O. BOX 507  
DULCE, NEW MEXICO 87528

8J655

SUBMIT 1 COPY TO

NATURAL RESOURCE DEPT

AND OIL & GAS ADMINISTRATION

PIT REMEDIATION AND CLOSURE REPORT

RECEIVED  
AUG 09 1999

OIL CON. DIV.  
DIST. 326-9280

Operator: AMOCO PRODUCTION COMPANY Telephone: (505) 326-9280  
Address: 200 Amoco Court, Farmington, NM 87401  
Facility or Well Name: JICARILLA APACHE #102-3  
Location: Unit or Qtr/Qtr Sec K Sec 9 T 26N R 4W County RIO ARRIAGA  
Pit Type: Separator      Dehydrator      Other BLOW  
Land Type: RANGE

Pit Location: Pit dimensions: length 22', width 21', depth 3'  
(Attach diagram) Reference: wellhead X, other       
Footage from reference: 165'  
Direction from reference: 14 Degrees X East of North       
West of South X

Depth To Groundwater: (Vertical distance from contaminants to seasonal high water elevation of groundwater)	Less than 50 feet (20 points) 50 feet to 99 feet (10 points) Greater than 100 feet (0 points)	<u>0</u>
Distance to an Ephemeral Stream (Downgradient dry wash greater than ten feet in width)	Less than 100 feet (10 points) Greater than 100 feet (0 points)	<u>0</u>
Distance to Nearest Lake, Playa, or Watering Pond (Downgradient lakes, playas and livestock or wildlife watering ponds)	Less than 100 feet (10 points) Greater than 100 feet (0 points)	<u>0</u>
Wellhead Protection Area: (Less than 200 feet from a private domestic water source, or: less than 1000 feet from all other water sources)	Yes (20 points) No (0 points)	<u>0</u>
Distance To Surface Water: (Horizontal distance to perennial lakes, ponds, rivers, streams, creeks, irrigation canals and ditches)	Less than 100 feet (20 points) 100 feet to 1000 feet (10 points) Greater than 1000 feet (0 points)	<u>0</u>

RANKING SCORE (TOTAL POINTS): 0

Date Remediation Started: \_\_\_\_\_ Date Completed: 10/7/98

Remediation Method: Excavation ☒ Approx. cubic yards 50  
Check all appropriate sections) Landfarmed ☒ Insitu Bioremediation \_\_\_\_\_  
Other \_\_\_\_\_

Remediation Location: Onsite ☒ Offsite \_\_\_\_\_  
(i.e. landfarmed onsite, name and location of offsite facility)

General Description of Remedial Action: Excavation, BEDROCK BOTTOM.

Groundwater Encountered: No ☒ Yes \_\_\_\_\_ Depth \_\_\_\_\_

Final Pit: Sample location see Attached Documents  
Closure Sampling: \_\_\_\_\_  
(if multiple samples, attach sample results and diagram of sample locations and depths)

Sample depth 2'

Sample date 10/7/98 Sample time 1015

## Sample Results

Soil: Benzene	(ppm)	_____	Water: Benzene	(ppb)	_____
Total BTEX	(ppm)	_____	Toluene	(ppb)	_____
Field Headspace	(ppm)	<u>0.0</u>	Ethylbenzene	(ppb)	_____
TPH	(ppm)	<u>ND</u>	Total Xylenes	(ppb)	_____

Groundwater Sample: Yes \_\_\_\_\_ No ☒ (If yes, attach sample results)

I HEREBY CERTIFY THAT THE INFORMATION ABOVE IS TRUE AND COMPLETE TO THE BEST OF MY KNOWLEDGE AND BELIEF

DATE 10/7/98 PRINTED NAME Buddy D. Shaw  
SIGNATURE Buddy D. Shaw AND TITLE Environmental Coordinator

AFTER REVIEW OF THE PIT CLOSURE INFORMATION, PIT CLOSURE IS APPROVED IN ACCORDANCE TO THE JICARILLA APACHE TRIBE PIT CLOSURE ORDINANCE.

APPROVED: YES ☒ NO \_\_\_\_\_ (REASON) \_\_\_\_\_

SIGNED: Ken C. Mando DATE: 11-18-98

3003906561

CLIENT: <u>AMOCO</u>	BLAGG ENGINEERING, INC. P.O. BOX 87, BLOOMFIELD, NM 87413 (505) 632-1199	LOCATION NO: <u>BTG55</u> C.D.C. NO: _____																																								
FIELD REPORT: CLOSURE VERIFICATION		PAGE No: <u>1</u> of <u>1</u>																																								
LOCATION: NAME: <u>JICA AP. 102</u> WELL #: <u>3</u> PIT: <u>BLOW</u>		DATE STARTED: <u>10/7/98</u> DATE FINISHED: _____																																								
QUAD/UNIT: <u>K</u> SEC: <u>9</u> TWP: <u>ZGN</u> RNG: <u>4W</u> PM: <u>NM</u> CNTY: <u>RA</u> ST: <u>NM</u>		ENVIRONMENTAL SPECIALIST: <u>MV</u>																																								
QTR/FOOTAGE: <u>1450' FSL</u> <u>1450' FWL</u> CONTRACTOR: <u>P &amp; S</u>																																										
EXCAVATION APPROX. <u>22</u> FT. x <u>21</u> FT. x <u>3</u> FT. DEEP. CUBIC YARDAGE: <u>50</u>																																										
DISPOSAL FACILITY: <u>ON-SITE</u> REMEDIATION METHOD: <u>LANDFILL</u>																																										
LAND USE: <u>RANGE</u> LEASE: <u>JICA 102</u> FORMATION: <u>PC</u>																																										
FIELD NOTES & REMARKS: PIT LOCATED APPROXIMATELY <u>165</u> FT. <u>514E</u> FROM WELLHEAD.																																										
DEPTH TO GROUNDWATER: <u>&gt;100'</u> NEAREST WATER SOURCE: <u>&gt;1000'</u> NEAREST SURFACE WATER: <u>&gt;1000'</u>																																										
NMCD RANKING SCORE: <u>0</u> NMCD TPH CLOSURE STD: <u>5000</u> PPM																																										
SOIL AND EXCAVATION DESCRIPTION:																																										
<p>SIDEWALLS - DK. YELL. BROWN SAND, NON COHESIVE, SLIGHTLY MOIST, FIRM, NO APPARENT STAINING, NO APPARENT HC ODDOR DETECTED, WITH EXCAVATION OR IN ANY OF THE OVM SAMPLES.</p> <p>BOTTOM - BEDROCK (SANDSTONE) DK. YELL. BROWN TO LT. GRAY IN COLOR, VERY HARD, NO APPARENT HC ODDOR IN OVM SAMPLE.</p>																																										
<div style="display: flex; justify-content: space-between;"> <div style="width: 30%;"> <p><u>BEDROCK BOTTOM</u></p> <p>SCALE</p> <p>0 FT</p> </div> <div style="width: 30%;"> <p><u>CLOSED</u></p> </div> <div style="width: 35%;"> <p>FIELD 418.1 CALCULATIONS</p> <table border="1" style="width: 100%; border-collapse: collapse;"> <thead> <tr> <th>TIME</th> <th>SAMPLE I.D.</th> <th>LAB No:</th> <th>WEIGHT (g)</th> <th>mL. FREON</th> <th>DILUTION</th> <th>READING</th> <th>CALC. ppm</th> </tr> </thead> <tbody> <tr> <td>1015</td> <td>(4) @ 2'</td> <td>TPH-2049</td> <td>5</td> <td>20</td> <td>1:1</td> <td>5</td> <td>ND</td> </tr> <tr><td> </td><td> </td><td> </td><td> </td><td> </td><td> </td><td> </td><td> </td></tr> <tr><td> </td><td> </td><td> </td><td> </td><td> </td><td> </td><td> </td><td> </td></tr> <tr><td> </td><td> </td><td> </td><td> </td><td> </td><td> </td><td> </td><td> </td></tr> </tbody> </table> </div> </div>			TIME	SAMPLE I.D.	LAB No:	WEIGHT (g)	mL. FREON	DILUTION	READING	CALC. ppm	1015	(4) @ 2'	TPH-2049	5	20	1:1	5	ND																								
TIME	SAMPLE I.D.	LAB No:	WEIGHT (g)	mL. FREON	DILUTION	READING	CALC. ppm																																			
1015	(4) @ 2'	TPH-2049	5	20	1:1	5	ND																																			
PIT PERIMETER		PIT PROFILE																																								
<p>TO WELL HEAD</p>		<p>BEDROCK (SS)</p>																																								
OVM RESULTS																																										
<table border="1" style="width: 100%; border-collapse: collapse;"> <thead> <tr> <th>SAMPLE ID</th> <th>FIELD HEADSPACE PID (ppm)</th> </tr> </thead> <tbody> <tr><td>1 @ 2'</td><td>0.0</td></tr> <tr><td>2 @ 2'</td><td>0.0</td></tr> <tr><td>3 @ 2'</td><td>0.0</td></tr> <tr><td>4 @ 2'</td><td>0.0</td></tr> <tr><td>5 @ 3'</td><td>0.0</td></tr> <tr><td> </td><td> </td></tr> <tr><td> </td><td> </td></tr> <tr><td> </td><td> </td></tr> <tr><td> </td><td> </td></tr> <tr><td> </td><td> </td></tr> </tbody> </table>		SAMPLE ID	FIELD HEADSPACE PID (ppm)	1 @ 2'	0.0	2 @ 2'	0.0	3 @ 2'	0.0	4 @ 2'	0.0	5 @ 3'	0.0																													
SAMPLE ID	FIELD HEADSPACE PID (ppm)																																									
1 @ 2'	0.0																																									
2 @ 2'	0.0																																									
3 @ 2'	0.0																																									
4 @ 2'	0.0																																									
5 @ 3'	0.0																																									
LAB SAMPLES																																										
<table border="1" style="width: 100%; border-collapse: collapse;"> <thead> <tr> <th>SAMPLE ID</th> <th>ANALYSIS</th> <th>TIME</th> </tr> </thead> <tbody> <tr><td> </td><td> </td><td> </td></tr> <tr><td> </td><td> </td><td> </td></tr> <tr><td> </td><td> </td><td> </td></tr> <tr><td> </td><td> </td><td> </td></tr> <tr><td> </td><td> </td><td> </td></tr> </tbody> </table>		SAMPLE ID	ANALYSIS	TIME																																						
SAMPLE ID	ANALYSIS	TIME																																								
TRAVEL NOTES: CALLOUT: _____ ONSITE: <u>10/7/98 - morn.</u>																																										

**BLAGG ENGINEERING, INC.**  
P.O. Box 87, Bloomfield, New Mexico 87413  
Phone: (505)632-1199 Fax: (505)632-3903

**FIELD MODIFIED EPA METHOD 418.1  
TOTAL PETROLEUM HYDROCARBONS**

Client:	Amoco	Project #:	
Sample ID:	4 @ 2'	Date Analyzed:	10-07-98
Project Location:	Jicarilla Apache # 102 - 3	Date Reported:	10-07-98
Laboratory Number:	TPH-2049	Sample Matrix:	Soil

Parameter	Result, mg/kg	Detection Limit, mg/kg
-----	-----	-----
Total Recoverable Petroleum Hydrocarbons	<b>ND</b>	<b>20</b>

ND = Not Detectable at stated detection limits.

QA/QC:	QA/QC Sample TPH mg/kg	Duplicate TPH mg/kg	% *Diff.
	-----	-----	-----
	236	220	7.02

\*Administrative Acceptance limits set at 30%.

Method: Modified Method 418.1, Petroleum Hydrocarbons, Total  
Recoverable, Chemical Analysis of Water and Waste,  
USEPA Storet No.4551, 1978

Comments: Blow Pit - BJ655

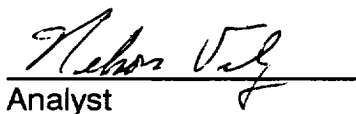
  
Analyst

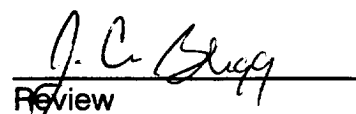
  
Review

**BLAGG ENGINEERING, INC.**

P.O. Box 87, Bloomfield, New Mexico 87413  
Phone: (505)632-1199 Fax: (505)632-3903

**Field TPH-Worksheet**

Max Characters:

\*\*\*\*\*

Client:

Amoco

Project #:

Sample ID:

4 @ 2'

Date Analyzed:

10-07-98

Project Location:

Jicarilla Apache # 102 - 3

Date Reported:

10-07-98

Laboratory Number:

TPH-2049

Sample Matrix:

Soil

Sample Weight:

5.00 grams

Volume Freon:

20.00 mL

Dilution Factor:

1 (unitless)

TPH Reading:

5 mg/kg

TPH Result:

20.0 mg/kg

Reported TPH Result:

20 mg/kg

Actual Detection Limit:

20.0 mg/kg

Reported Detection Limit:

20 mg/kg

QA/QC:

Original  
TPH mg/kg

Duplicate  
TPH mg/kg

%  
Diff.

-----  
236

-----  
220

-----  
7.02

Comments:

\*\*\*\*\*Max Characters\*\*\*\*\*

Comments:

Blow Pit - BJ655

**JICARILLA APACHE TRIBE  
ENVIRONMENTAL PROTECTION OFFICE  
P.O. BOX 507  
DULCE, NEW MEXICO 87528**

SUBMIT 1 COPY TO:  
NATURAL RESOURCE DEPT  
AND OIL & GAS ADMINISTRATION

**ON-SITE SOIL REMEDIATION REPORT**

<b>Operator:</b> <u>AMOCO PRODUCTION COMPANY</u> <b>Telephone:</b> <u>(505) 326-9200</u>	
<b>Address:</b> <u>200 Amoco Court, Farmington, NM 87401</u>	
<b>Facility or Well Name:</b> <u>JICARILLA APACHE 102 - 3</u>	
<b>Location:</b> Unit or Qtr/Qtr Sec <u>K</u> Sec <u>9</u> T <u>26N</u> R <u>4W</u> County <u>DO ARriba</u>	
<b>Land Type:</b> <u>RANGE</u>	
<b>Date Remediation Started:</b> <u>10-7-98</u> <b>Date Completed:</b> <u>5/13/99</u>	
<b>Remediation Method:</b> Landfarmed <input checked="" type="checkbox"/> Approx. cubic yards <u>50</u> Composted <input type="checkbox"/> Other <input type="checkbox"/>	
<b>Depth To Groundwater:</b> (pts.) <u>0</u> <b>Distance to an Ephemeral Stream</b> (pts.) <u>0</u> <b>Distance to Nearest Lake, Playa, or Watering Pond</b> (pts.) <u>0</u> <b>Wellhead Protection Area:</b> (pts.) <u>0</u> <b>Distance To Surface Water:</b> (pts.) <u>0</u> <b>RANKING SCORE (TOTAL POINTS):</b> <u>0</u>	<b>Final Closure Sampling:</b> <b>Sampling Date:</b> <u>5-12-99</u> <b>Time:</b> <u>1135</u> <b>Sample Results:</b> Field Headspace (ppm) <u>3.2</u> TPH (ppm) <u>ND</u> Method <sup>TPH</sup> <u>(8015)</u> Other <input type="checkbox"/>
<b>I HEREBY CERTIFY THAT THE INFORMATION ABOVE IS TRUE AND COMPLETE TO THE BEST OF MY KNOWLEDGE AND BELIEF</b>	
<b>DATE</b> <u>5/13/99</u> <b>PRINTED NAME</b> <u>Buddy D. Shaw</u>	
<b>SIGNATURE</b> <u>Buddy D. Shaw</u> <b>AND TITLE</b> <u>Environmental Coordinator</u>	
<b>AFTER REVIEW OF THE SOIL REMEDIATION INFORMATION, ON-SITE REMEDIATION IS APPROVED IN ACCORDANCE TO THE JICARILLA APACHE TRIBE PIT CLOSURE ORDINANCE.</b>	
<b>APPROVED:</b> YES <input checked="" type="checkbox"/> NO <input type="checkbox"/> (REASON) _____	
<b>SIGNED:</b> <u>Kent M. [Signature]</u> <b>DATE:</b> <u>6-18-99</u>	

CLIENT: <u>AMOCO</u>	BLAGG ENGINEERING, INC. P.O. BOX 87, BLOOMFIELD, NM 87413 (505) 632-1199	LOCATION NO: <u>B3655</u> C.D.C. NO: <u>6922</u>
----------------------	--	---

# FIELD REPORT: LANDFARM/COMPOST PILE CLOSURE VERIFICATION

LOCATION: NAME: <u>SKABILLA APACHE 102 WELL # 3</u>	PITS: <u>BLOW</u>	DATE STARTED: <u>5.12.99</u>
QUAD/UNIT: <u>K SEC: 9 TWP: 26N RNG: 4W PM: NM CNTY: RA ST: NM</u>		DATE FINISHED: _____
QTR/FOOTAGE: <u>NE/4 SW/4</u>	CONTRACTOR: <u>P+S</u>	ENVIRONMENTAL SPECIALIST: <u>REP</u>

## SOIL REMEDIATION:

REMEDICATION SYSTEM: LANDFARM APPROX. CUBIC YARDAGE: 50  
LAND USE: RANGE LIFT DEPTH (ft): 1'

## FIELD NOTES & REMARKS:

DEPTH TO GROUNDWATER: >100' NEAREST WATER SOURCE: >1000' NEAREST SURFACE WATER: >1000'  
NMDD RANKING SCORE: 0 NMDD TPH CLOSURE STD: 5000 PPM

MODERATE BROWN SAND, NON COHESIVE, SLIGHTLY MOIST, FIRM.  
NO APPARENT STAINING, NO HC ODOR DETECTED. SAMPLING  
DEPTHS RANGE FROM 6"-10" COLLECTED A SPT. COMPOSITE  
SAMPLE FOR LAB ANALYSIS.

**CLOSED**

## FIELD 418.1 CALCULATIONS

SAMP. TIME	SAMPLE I.D.	LAB No:	WEIGHT (g)	mL. FREON	DILUTION	READING	CALC. ppm

## SKETCH/SAMPLE LOCATIONS

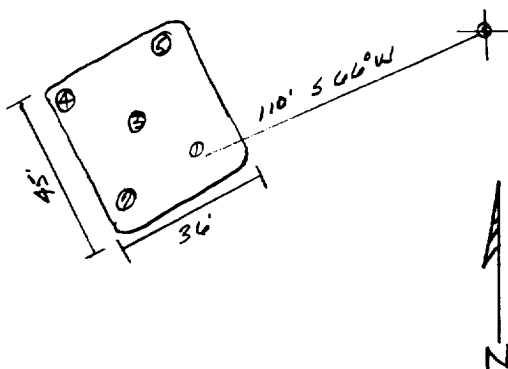

## OVM RESULTS

## LAB SAMPLES

SAMPLE ID	FIELD HEADSPACE PID (ppm)	SAMPLE ID	ANALYSIS	TIME	RESULTS
LF-1	3.2	LF-1	TPH (8015)	1135	ND

## SCALE

0 FT

TRAVEL NOTES: CALLOUT: NA ONSITE: 5.12.99

# ENVIROTECH LABS

PRACTICAL SOLUTIONS FOR A BETTER TOMORROW

EPA METHOD 8015 Modified  
Nonhalogenated Volatile Organics  
Total Petroleum Hydrocarbons

Client:	Blagg / AMOCO	Project #:	403410
Sample ID:	LF - 1	Date Reported:	05-13-99
Laboratory Number:	F218	Date Sampled:	05-12-99
Chain of Custody No:	6922	Date Received:	05-13-99
Sample Matrix:	Soil	Date Extracted:	05-13-99
Preservative:	Cool	Date Analyzed:	05-13-99
Condition:	Cool and Intact	Analysis Requested:	8015 TPH

Parameter	Concentration (mg/Kg)	Det. Limit (mg/Kg)
Gasoline Range (C5 - C10)	ND	0.2
Diesel Range (C10 - C28)	ND	0.1
Total Petroleum Hydrocarbons	ND	0.2

ND - Parameter not detected at the stated detection limit.

References: Method 8015B, Nonhalogenated Volatile Organics, Test Methods for Evaluating Solid Waste, SW-846, USEPA, December 1996.

Comments: Jicarilla Apache 102 - 3 Landfarm. 5 Pt. Composite.

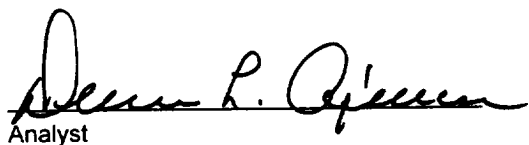
  
Analyst

  
Review



6922

Sample Receipt		
	Y	N/A
Received Intact	✓	
Cool - Ice/Blue Ice	✓	