

Company Doswell & Pettigrew

Lease not to 72-36 Well No. 17 - Doswell

Sec. 9 T. 26 N., R. 6 W., N.M.P.M.

Location 1550' from the South line and 920'
from the West line.

Rio Arriba County

New Mexico

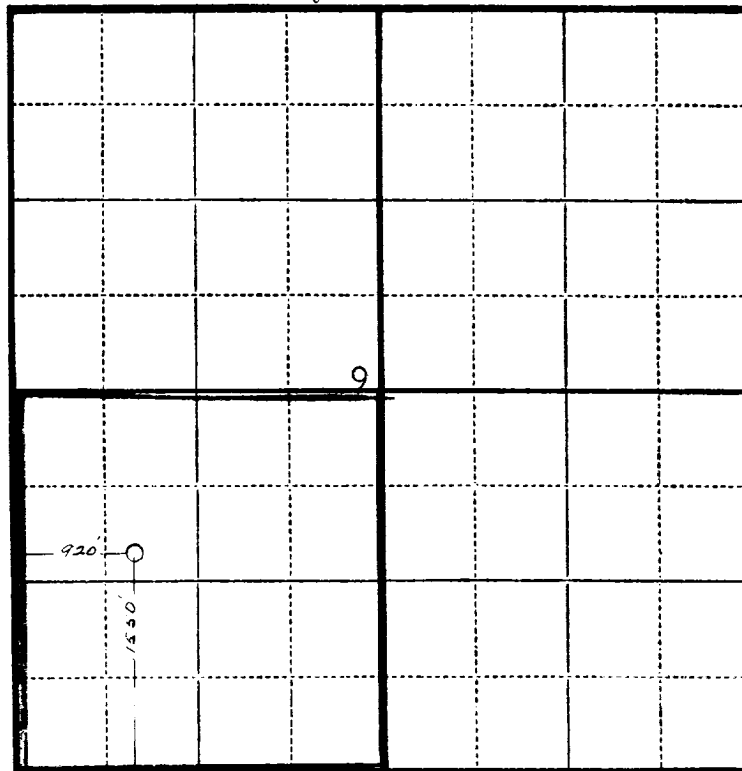

Scale—4 inches equals 1 mile.

This is to certify that the above plat was prepared from field notes of actual surveys made by me or under my supervision and that the same are true and correct to the best of my knowledge and belief.

Seal:

Charles J. Finklea
Registered Professional
Engineer and Land Surveyor.

Charles J. Finklea
N. Mex. Reg. No. 1302

Surveyed August 11, 19 51

