

DOSWELL & PETTIGREW
719 1st National Bank Bldg.
Dallas 1, Texas



August 14, 1951

Mr. Al Greer,
New Mexico Oil Conservation Commission,
Aztec, New Mexico

Re: Santa Fe 079035

Dear Sir:

It is hereby requested that we be granted approval to drill on the subject lease, located in the NW $\frac{1}{4}$ SW $\frac{1}{4}$ Sec. 10, T. 26 N., R. 6 W., N.M.P.M., Rio Arriba County, New Mexico, Wildcat area.

This is to be well No 5-15 Doswell, located 1510' from the south line and 1135' from the west line. It is impossible to drill the well due to rough terrain on the specified footage as set forth in spacing regulations.

FED-DOSWELL # 5-15

Very truly yours,

C. WILSON MOORE,
Supt.

CWM/jhb

THE UNIVERSITY OF CHICAGO

1961

THE UNIVERSITY OF CHICAGO
1961

1961

THE UNIVERSITY OF CHICAGO
1961

THE UNIVERSITY OF CHICAGO
1961

1961

1961

1961

1961

(SUBMIT IN TRIPLICATE)

UNITED STATES
DEPARTMENT OF THE INTERIOR
GEOLOGICAL SURVEY

Land Office Santa Fe

Lease No. 079086

Unit No. 10 in
Designated Drilling Unit

SUNDRY NOTICES AND REPORTS ON WELLS

NOTICE OF INTENTION TO DRILL	<input checked="" type="checkbox"/>	SUBSEQUENT REPORT OF WATER SHUT-OFF
NOTICE OF INTENTION TO CHANGE PLANS		SUBSEQUENT REPORT OF SHOOTING OR ACIDIZING
NOTICE OF INTENTION TO TEST WATER SHUT-OFF		SUBSEQUENT REPORT OF ALTERING CASING
NOTICE OF INTENTION TO RE-DRILL OR REPAIR WELL		SUBSEQUENT REPORT OF REDRILLING OR REPAIR
NOTICE OF INTENTION TO SHOOT OR ACIDIZE		SUBSEQUENT REPORT OF ABANDONMENT
NOTICE OF INTENTION TO PULL OR ALTER CASING		SUPPLEMENTARY WELL HISTORY
NOTICE OF INTENTION TO ABANDON WELL		

(INDICATE ABOVE BY CHECK MARK NATURE OF REPORT, NOTICE, OR OTHER DATA)

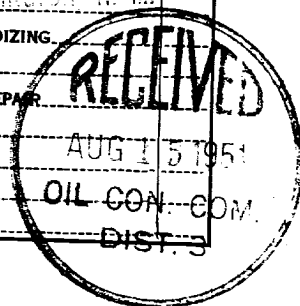

August 14, 1951

Deswell
Well No. 5-15 is located 1610 ft. from SW line and 1135 ft. from W line of sec. 10

SW (1/4 Sec. and Sec. No.) SW (Twp.) S (Range) SW (Meridian)
Willamette (Field) Elizabethton (County or Subdivision) New Mexico (State or Territory)

The elevation of the derrick floor above sea level is ft. (To be furnished later)

DETAILS OF WORK

(State names of and expected depths to objective sands; show sizes, weights, and lengths of proposed casings; indicate mudding jobs, cementing points, and all other important proposed work)

It is intended to drill with Rotary Tools to approximately 3000 feet to test the Pictured Cliffs formation.

Casing Program:

Set 300' - 8-5/8" w/350 sacks and cement to be circulated.

Set approx. 3000' - 5 1/2" w/250 sacks cement.

I understand that this plan of work must receive approval in writing by the Geological Survey before operations may be commenced.

Company DESSELL & PATTERSON

Address 719 1st Nat'l. Bk. Bldg.,

Dallas 1, Texas

By G. Wilson Moore
C. WILSON MOORE,
Supt.

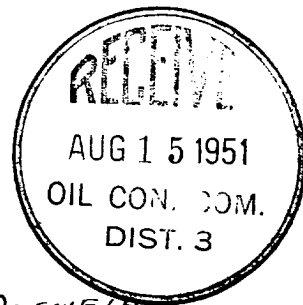

Company Doswell & Pettigrew

Lease Santa Fe 079035 Well No. 5-15 Doswell

Sec. 10 T. 26 N., R. 6 W., N.M.P.M.

Location 1510' from the South line and 1135'
from the West line.

Rio Arriba County

New Mexico

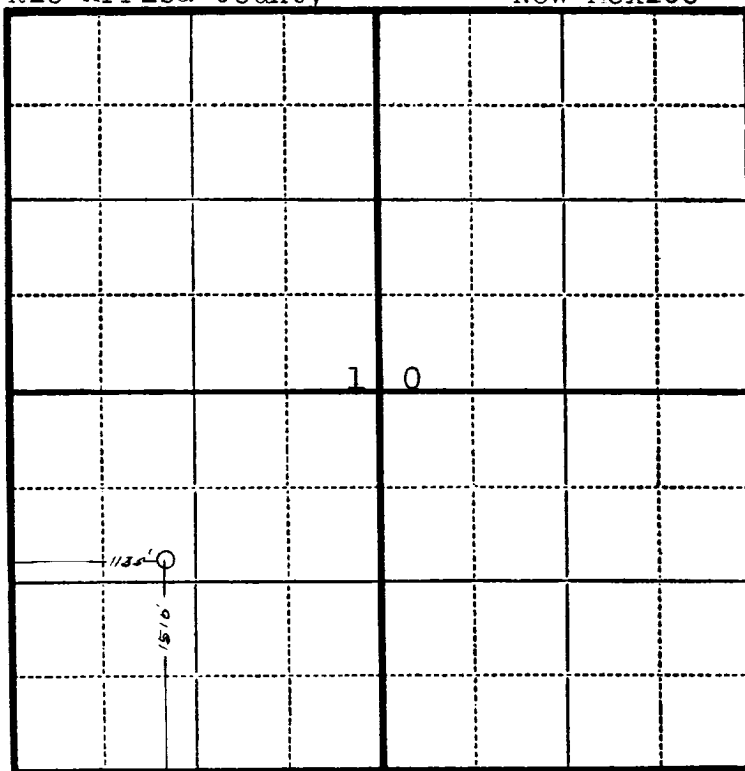

Scale—4 inches equals 1 mile.

This is to certify that the above plat was prepared from field notes of actual surveys made by me or under my supervision and that the same are true and correct to the best of my knowledge and belief.

Seal:

Registered Professional Charles J. Finklea
Engineer and Land Surveyor. N. Mex. Reg. No. 1302

Surveyed August 8, 1951