

District I  
P.O. Box 1980, Hobbs, NM

SUBMIT 1 COPY TO  
APPROPRIATE  
DISTRICT OFFICE  
AND 1 COPY TO  
SANTA FE OFFICE

District II AM 27 1999  
P.O. Drawer DD, Artesia,  
NM 88221

OIL CONSERVATION DIVISION

2040 S. Pacheco

Santa Fe, New Mexico 87504

District III  
1000 Rio Brazos Rd, Aztec,  
NM 87410

# PIT REMEDIATION AND CLOSURE REPORT

Operator: Caulkins Oil Company

Telephone: (505) 632-1544

Address: P.O. Box 340, Bloomfield, NM 87413

Facility or Well Name: Breech "A" 679

Location: Unit or Qtr/Qtr J Sec 9 T 26N R 6W County Rio Arriba

Pit Type: Separator X    Dehydrator \_\_\_\_\_ Other \_\_\_\_\_

Land Type: BLM X, State       , Fee       , Other       

Pit Location: Pit dimensions: length 25', width 23', depth 12'  
(Attach diagram)

References: wellhead X, other

Footage from reference: 165'

Direction from reference: 90 Degrees X East North X  
of  
\_\_\_\_\_ West South

**Depth to Ground Water:**  
(Vertical distance from  
contaminants to seasonal high  
water elevation of ground water)

Less than 50 feet (20 points)

50 feet to 99 feet (10 points)

Greater than 100 feet	(0 points)	<u>0</u>
-----------------------	------------	----------

**Wellhead Protection Area:**  
(Less than 200 feet from a  
private domestic water source,  
or; less than 1000 feet from all  
other water sources;

Yes (20 points)

No (0 points) 0

**Distance to Surface Water:**  
(Horizontal distance to perennial  
lakes, ponds, rivers, streams,  
creeks, irrigation canals and  
ditches)

Less than 200 feet (20 points)

200 feet to 1000 feet (10 points)

Greater than 1000 feet (0 points)	0
-----------------------------------	---

RANKING SCORE (TOTAL POINTS): 0

Remediation Method: Excavation X Approx. cubic yards 255  
Check all appropriate sections) Landfarmed X Insitu Bioremediation

sections) Landfarmed X Insitu Bioremediation       
Other

Remediation Location: Onsite X Offsite \_\_\_\_\_  
(ie. landfarmed onsite,  
name and location of  
offsite facility) \_\_\_\_\_

General Description of Remedial Action: Aeration and Dilution

Ground Water Encountered: No X Yes \_\_\_\_\_ Depth \_\_\_\_\_

Final Pit: Sample Location Bottom of pit and landfarm

Closure Sampling: \_\_\_\_\_  
 (if multiple samples, \_\_\_\_\_  
 attach sample results \_\_\_\_\_  
 and diagram of sample \_\_\_\_\_

Sample depth 14'

Sample depth 14'

Sample date 8-26-97 Sample time 2:00 p.m.

Benzene (ppm) \_\_\_\_\_

Total BTEX (ppm) ND

Field headspace (ppm) \_\_\_\_\_

TPH Landfarm: 200 ppm Pit: 80 ppm

Ground Water Sample: Yes      No X (If yes, attach sample results)

I HEREBY CERTIFY THAT THE INFORMATION ABOVE IS TRUE AND COMPLETE TO THE BEST OF MY KNOWLEDGE AND BELIEF.

DATE      October 6, 1998

SIGNATURE Robert L. Verquer PRINTED NAME  
AND TITLE ROBERT L. VERQUER, SUPERINTENDENT

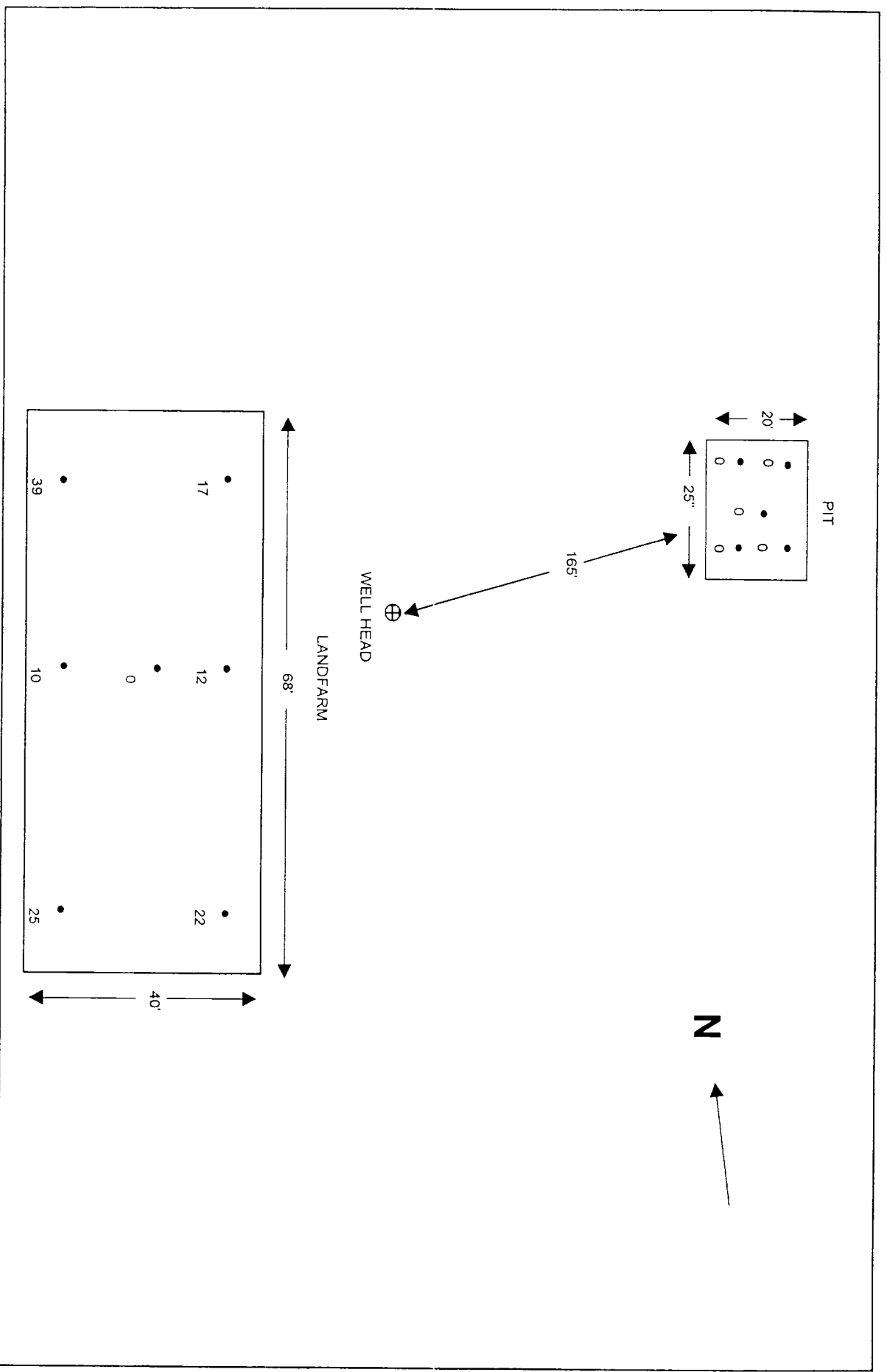



® Certificate of Analysis No. 9708147-07

FARMINGTON LABORATORY  
P.O. BOX 1289  
FARMINGTON, NEW MEXICO 87499-1289  
PHONE (505) 326-2588

Caulkins Oil and Gas Co.  
PO Box 340  
Bloomfield, NM 87413  
Attn: Bobby Verquer

Date: 09/08/97

Project: Landfarm  
Site:  
Sampled By: J. Waggoner  
Sample ID: Breech A 679

Project No:  
Matrix: Soil  
Date Sampled: 08/26/97  
Date Received: 08/27/97

#### Analytical Data

PARAMETER	RESULTS	DETECTION LIMIT	UNITS
Benzene	ND	5.0	µg/Kg
Toluene	ND	5.0	µg/Kg
Ethylbenzene	ND	5.0	µg/Kg
Total Xylene	ND	5.0	µg/Kg
Total Volatile Aromatic Hydrocarbons	ND		µg/Kg

#### Surrogate

#### % Recovery

1,4-Difluorobenzene  
4-Bromofluorobenzene

100  
93

Method 8020A

Analyzed by: JN

Date: 09/04/97

Total Petroleum Hydrocarbons-Diesel

200

4.0

mg/Kg

#### Surrogate

#### % Recovery

n-Pentacosane  
Modified 8015A

MI 260

Analyzed by: RR

Date: 09/03/97

Petroleum Hydrocarbons-Gasoline

ND

0.5

mg/Kg

#### Surrogate

#### % Recovery

1,4-Difluorobenzene  
4-Bromofluorobenzene

100  
67

Method 8020A

Analyzed by: JN

Date: 09/04/97

Test Methods for Evaluating Solid Waste, EPA SW846, 3rd Ed.

MI - Matrix Interference

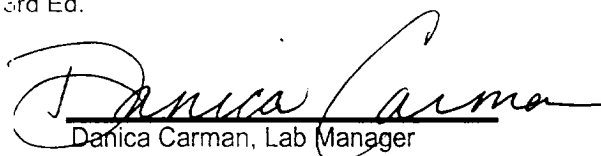
  
Danica Carman, Lab Manager



® Certificate of Analysis No. 9708147-08

FARMINGTON LABORATORY  
P.O. BOX 1289  
FARMINGTON, NEW MEXICO 87499-1289  
PHONE (505) 326-2588

Caulkins Oil and Gas Co.  
PO Box 340  
Bloomfield, NM 87413  
Attn: Bobby Verquer

Date: 09/08/97

Project: Pit  
Site:  
Sampled By: J. Waggoner  
Sample ID: Breech A 679

Project No:  
Matrix: Soil  
Date Sampled: 08/26/97  
Date Received: 08/27/97

#### Analytical Data

PARAMETER	RESULTS	DETECTION LIMIT	UNITS
Benzene	NC	5.0	µg/Kg
Toluene	NC	5.0	µg/Kg
Ethylbenzene	NC	5.0	µg/Kg
Total Xylene	NC	5.0	µg/Kg
Total Volatile Aromatic Hydrocarbons	NC		µg/Kg

**Surrogate**                      % Recovery  
1,4-Difluorobenzene              100  
4-Bromofluorobenzene            100  
Method 8020A  
Analyzed by: JN  
Date: 09/04/97

Total Petroleum Hydrocarbons-Diesel              80              4.0              mg/Kg

**Surrogate**                      % Recovery  
n-Pentacosane                      MI 176  
Modified 8015A  
Analyzed by: RR  
Date: 09/03/97

Petroleum Hydrocarbons-Gasoline              NC              0.5              mg/Kg

**Surrogate**                      % Recovery  
1,4-Difluorobenzene              103  
4-Bromofluorobenzene            70  
Method 8020A  
Analyzed by: JN  
Date: 09/04/97

Test Methods for Evaluating Solid Waste, EPA SW846, 3rd Ed.

MI - Matrix Interference

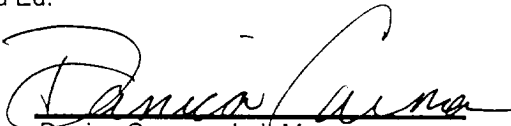
  
Danica Carman, Lab Manager

WELL NAME: Breech A 679

CAULKINS OIL  
SITE SECURITY DIAGRAM

