

NEW MEXICO OIL CONSERVATION COMMISSION  
Santa Fe, New Mexico

Form C-101  
Revised (12/1/55)

Application for unorthodox location and non-standard gas proration unit  
NOTICE OF INTENTION TO DRILL

Notice must be given to the District Office of the Oil Conservation Commission and approval obtained before drilling or recompletion begins. If changes in the proposed plan are considered advisable, a copy of this notice showing such changes will be returned to the sender. Submit this notice in QUINTUPLICATE. One copy will be returned following approval. See additional instructions in Rules and Regulations of the Commission. If State Land submit 6 Copies Attach Form C-128 in triplicate to first 3 copies of form C-101

February 5, 1957

(Place)

(Date)

OIL CONSERVATION COMMISSION  
SANTA FE, NEW MEXICO

Gentlemen:

You are hereby notified that it is our intention to commence the Drilling of a well to be known as

John J. Eisner

Welvin D. Rueckhaus et al

(Company or Operator)

1

A

The well is

(Lease)

Well No.

in (Unit)

located 990 feet from the

North

line and

700

feet from the

(GIVE LOCATION FROM SECTION LINE)

Blanco Mesaverte and  
Undesignated Pictured Cliffs

T. 26 N.

R. 2 W.

NMPM.

Rio Arriba

County

If State Land the Oil and Gas Lease is No.

If patented land the owner is Melvin D. Rueckhaus et al

Address 211 Central NW, Albuquerque, New Mexico

We propose to drill well with drilling equipment as follows: Rotary tools using  
water and mud to 4000' and gas to total depth

The status of plugging bond is \$10,000.00 blanket bond for John J.  
Eisner filed at Santa Fe

Drilling Contractor not contracted as yet

We intend to complete this well in the Pictured Cliffs and Mesaverte  
formation at an approximate depth of 3600 and 6200 feet.

approximately

CASING PROGRAM

We propose to use the following strings of Casing and to cement them as indicated:

Size of Hole	Size of Casing	Weight per Foot	New or Second Hand	Depth	Sacks Cement
12 3/4"	10 3/4"	32.75	New	300	200
8 3/4"	7 5/8"	26.40	New	4000	180
7 7/8"	5 1/2"	15.80	New	3900-6200	200
We propose to squeeze top of 5 1/2" liner with approximately 200 sack cement					

If changes in the above plans become advisable we will notify you immediately.

ADDITIONAL INFORMATION (If recompletion give full details of proposed plan of work.)  
We propose to complete in the Pictured Cliffs and Mesaverte formations  
if productive by perforating and fracturing each zone with approximately  
40,000 gallons water and one pound sand per gallon at an injection rate of  
not less than 40 barrels per minute.

Sincerely yours,

John J. Eisner

(Company or Operator)

By

Bew Donegan  
Geologist

Position

Send Communications regarding well to

Name

John J. Eisner

Address

Box 1158, Abilene, Texas

Approved

Except as follows:

Subject to Commission's Consideration  
Case 1227

OIL CONSERVATION COMMISSION

By

Ernest C. Arnold

RECEIVED

MAR 21 1957

OIL CON. COM.

DIST. 2

NEW MEXICO  
OIL CONSERVATION COMMISSION

Form C-128

Well Location and/or Gas Proration Plat

Date 2-5-57

Operator John J. Eisner Lease Melvin D. Rueckhaus et al

Well No. 1 Section 7 Township 26 N. Range 2 W. NMPM

Located 990 Feet From North Line, 700 Feet From West Line,

Approx 7126, will  
furnish corrected  
elevation later

Rio Arriba County, New Mexico. G. L. Elevation  
Name of Producing Formation Mesaverde Pool Blanco Dedicated Acreage 335.66

(Note: All distances must be from outer boundaries of Section)

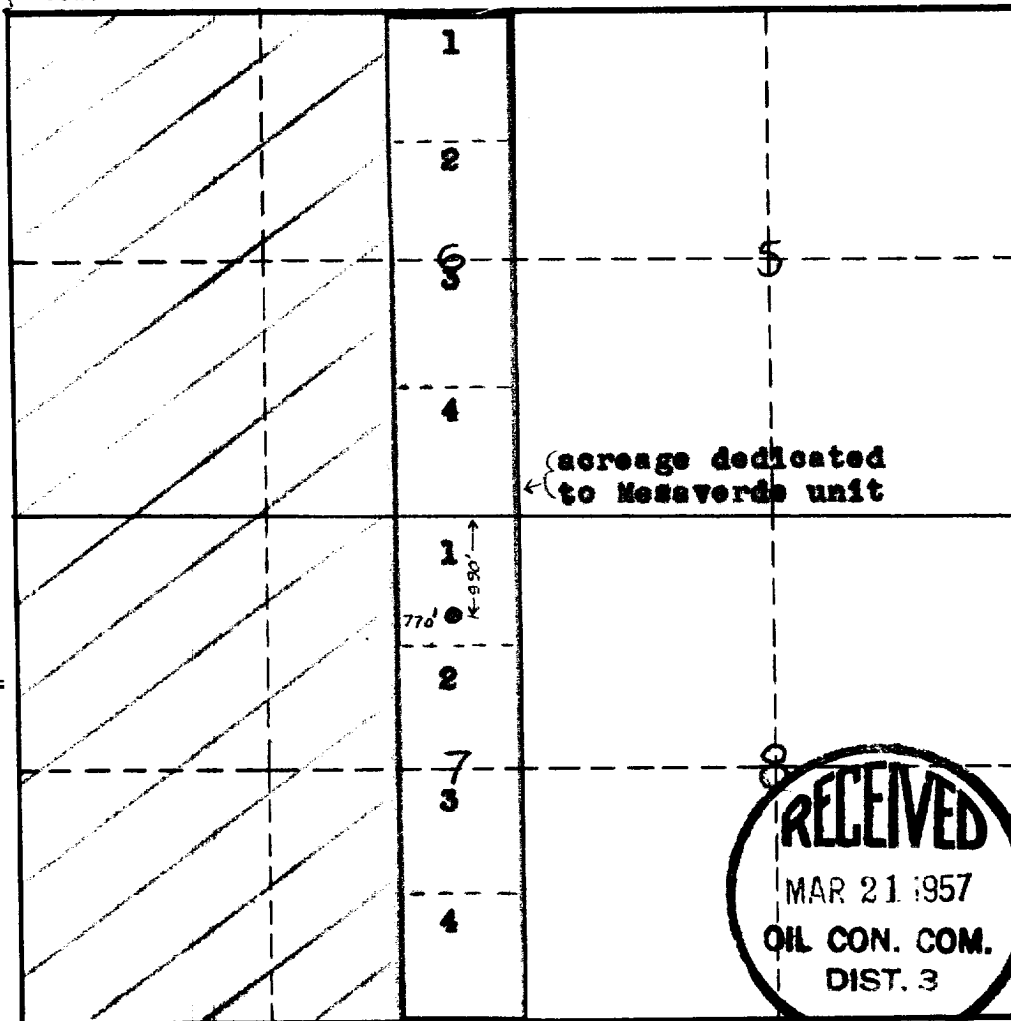

LOT AREAS:

Fractional  
Section 6-  
1. 39.88 acres  
2. 41.53 "  
3. 41.82 "  
4. 42.11 "

Fractional  
Section 7-  
1. 42.34 acres  
2. 42.50 "  
3. 42.66 "  
4. 42.82 "

NOTE

This section of  
form is to be  
used for gas  
wells only.



1. Is this Well a Dual Comp. ? Yes ☒ No ☐.
2. If the answer to Question 1 is yes, are there any other dually completed wells within the dedicated acreage? Yes ☐ No ☒.

Name Ben Donegan  
Position Geologist  
Representing John J. Eisner  
Address Box 1158, Abilene, Texas

This is to certify that the above plat was prepared from field notes of actual surveys made by me or under my supervision and that the same are true and correct to the best of my knowledge and belief.

Date Surveyed 1-30-57  
Ernest V. Echohawk  
Registered Professional Engineer and/or  
Land Surveyor Reg. No. 1545

NEW MEXICO  
OIL CONSERVATION COMMISSION

Form C-128

Well Location and/or Gas Proration Plat

Operator John J. Eisner Lease Melvin D. Reackhaus Date 2-5-57  
Well No. 1 Section 7 Township 26 North Range 2 West NMPM  
Located 990 Feet From North Line, 700 Feet From West Line,  
Rio Arriba County, New Mexico. G. L. Elevation 7117, UNGRADED

Name of Producing Formation Pictured Cliffs Pool Undesignated Dedicated Acreage 170.32  
(all of Sec. 7)  
(Note: All distances must be from outer boundaries of Section)

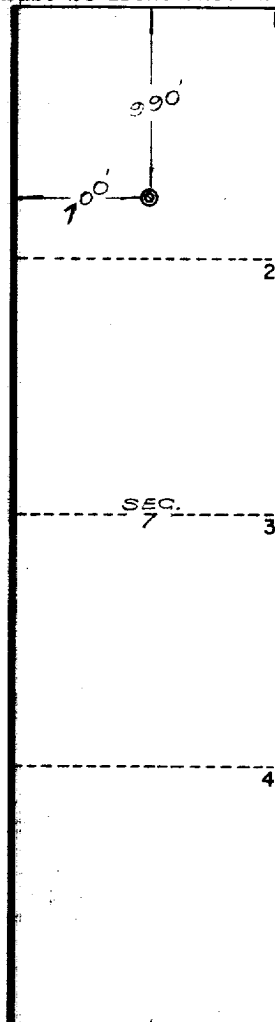

Fractional Section

-Lot Areas-

1.	42.34	Acres
2.	42.50	" "
3.	42.66	" "
4.	42.82	" "

NOTE

This section of form is to be used for gas wells only.

SCALE: 1"=1000'

1. Is this Well a Dual Comp. ? Yes ☒ No ☐
2. If the answer to Question 1 is yes, are there any other dually completed wells within the dedicated acreage?  
Yes ☐ No ☒

Name Bew Doregan  
Position Geologist  
Representing John J. Eisner  
Address Box 1158 Abilene, Texas

This is to certify that the above plat was prepared from field notes of actual surveys made by me or under my supervision and that the same are true and correct to the best of my knowledge and belief.

Date Surveyed February 8, 1957  
Ernest V. Echhawk  
Ernest V. Echhawk  
Reg. Land Surveyor, N. Mex., Reg. No. 1545

<b>OIL CONSERVATION COMMISSION</b>		
<b>AZTEC DISTRICT OFFICE</b>		
<b>No. Copies Received</b> 5		
<b>DISTRIBUTION</b>		
	<b>NO. FURNISHED</b>	
<b>Operator</b>	1	
<b>Santa Fe</b>	1	
<b>Proration Office</b>		
<b>State Land Office</b>		
<b>U. S. G. S.</b>	2	
<b>Transporter</b>		
<b>File</b>	1	✓