

District I
P.O. Box 199, Hobbs, NM 88240

District II
P.O. Drawer 60, Artesia, NM 88221

District III
1000 Rio Brazos Rd, Aztec, NM 87401

State of New Mexico
Energy, Minerals and Natural Resources Department

OIL CONSERVATION DIVISION

2040 South Pacheco Street
Santa Fe, New Mexico 87505

SUBMIT 1 COPY TO
APPROPRIATE
DISTRICT OFFICE
AND 1 COPY TO
SANTA FE OFFICE

JUN 8 3 1998

PIT REMEDIATION AND CLOSURE REPORT

Operator: PNM Gas Services (Caulkins) Telephone: 324-3764

Address: 603 W. Elm Street Farmington, NM 87401

Facility or Well Name: Breach A #127

Location: Unit B Sec 8 T 26 N R 6 W County Rio Arriba

Pit Type: Separator ☐ Dehydrator ☐ Other Drip

Land Type: BLM ☒ State ☐ Fee ☐ Other ☐

Pit Location: Pit dimensions: length 20 width 20 depth 3

(Attach diagram) Reference: wellhead ☒ other ☐

Footage from reference: 90'

Direction from reference: 15 Degrees ☒ East ☐ North ☒
of ☐ West ☐ South ☐

Depth to Ground Water: Less than 50 feet (20 points)
50 feet to 99 feet (10 points)
Greater than 100 feet (0 points) 0

(Vertical distance from contaminants to
seasonal high water elevation of ground
water)

Wellhead Protection Area:

(Less than 200 feet from a private
domestic water source, or, less than 1,000
feet from all other water sources)

Yes (20 points)
No (0 points) 0

Distance to Surface Water:

(Horizontal distance to perennial lakes
ponds, rivers, streams, creeks, irrigation
canals and ditches)

Less than 200 feet (20 points)
200 feet to 1,000 feet (10 points)
Greater than 1,000 feet (0 points) 0

RANKING SCORE (TOTAL POINTS): 0

RECEIVED
FEB - 3 1998
OIL CON. DIV.
DIST. 3

Breach A #127

Date Remediation Started: 10/6/97

Date Completed: 10/6/97

Remediation Method: Excavation ☒

Approx. Cubic Yard 128

(Check all appropriate sections)

Landfarmed ☒

Amount Landfarmed (cubic yds) 128

Other

Remediation Location:

Onsite

☒

Offsite

(i.e., landfarmed onsite, name and location of offsite facility)

Backfill Material Location:

General Description of Remedial Action:

Excavated contaminated soil to pit size of 18' X 16' X 12' and landfarmed soil onsite within a bermed area at a depth of 6" to 12". Soil was aerated by plowing until soil met regulatory levels.

Ground Water Encountered:

No

☒

Yes

☐

Depth

Final Pit Closure Sampling:

Sample Location

5 pt composite-4 side walls and center of pit bottom

(if multiple samples, attach sample result and diagram of sample locations and depths.)

Sample depth

9' walls and 12' bottom.

Sample date

10/6/97

Sample time

10:30:00 AM

Sample Results

Benzene (ppm) < 0.0020

Total BTEX (ppm) 0.1380

Field headspace (ppm)

TPH (ppm)

29.00

Method

8015A

Vertical Extent (ft)

Risk Assessment form attached

Yes

No

Ground Water Sample:

Yes

No

☒

(If yes, see attached Groundwater Site Summary Report)

I HEREBY CERTIFY THAT THE INFORMATION ABOVE IS TRUE AND COMPLETE TO THE BEST OF MY KNOWLEDGE AND MY BELIEF

DATE January 27, 1998

SIGNATURE

PRINTED NAME
AND TITLEDenver Bearden
Administrator III

Breach A#127

10/6/97

Can/Kins O:1

Sec. 8, 26N, 6W, B

Start of excavation:

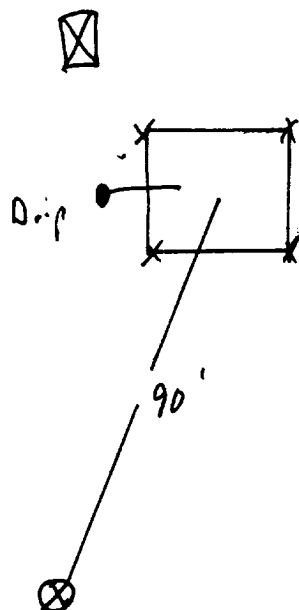

End of excavation:

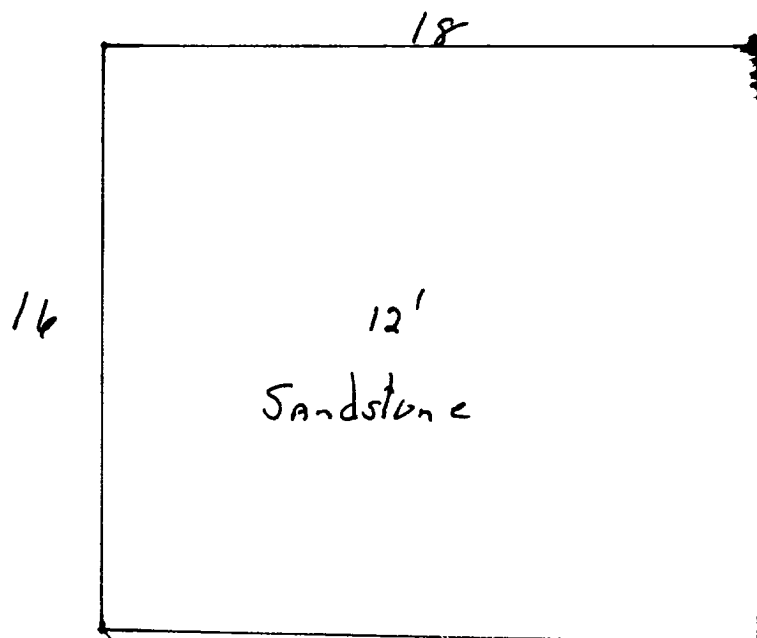

OFF: (505) 325-5667



LAB: (505) 325-1556

ANALYTICAL REPORT

Attn: *Denver Bearden*
Company: *PNM Gas Services*
Address: *603 W. Elm*
City, State: *Farmington, NM 87401*

Date: *17-Oct-97*
COC No.: *5820*
Sample No.: *16510*
Job No.: *2-1000*

Project Name: *PNM Gas Services - Breech A #127*
Project Location: *9710061030; Composite, Walls @ 9' and Bottom @ 12'*
Sampled by: *GC* Date: *6-Oct-97* Time: *10:30*
Analyzed by: *DC/HR* Date: *14-Oct-97*
Sample Matrix: *Soil*

Laboratory Analysis

Parameter	Results as Received	Unit of Measure	Limit of Quantitation	Unit of Measure
<i>Diesel Range Organics (C10 - C28)</i>	29	mg/kg	5	mg/kg

ND - Not Detected at Limit of Quantitation

Quality Assurance Report

DRO QC No.: 0555-STD

Continuing Calibration Verification

Parameter	Method Blank	Unit of Measure	True Value	Analyzed Value	RPD	RPD Limit
<i>Diesel Range (C10 - C28)</i>	ND	ppm	200	185	8.0	15%

Matrix Spike

Parameter	1- Percent Recovered	2 - Percent Recovered	Limit	RPD	RPD Limit
<i>Diesel Range (C10-C28)</i>	87	87	(70-130)	0	20%

Method - *SW-846 EPA Method 8015A mod. - Nonhalogenated Volatile Hydrocarbons by Gas Chromatography*

Approved by:

Date:

Jag
10/12/97

P.O. BOX 2606 • FARMINGTON, NM 87499

- TECHNOLOGY BLENDING INDUSTRY WITH THE ENVIRONMENT -

OFF: (505) 325-5667



LAB: (505) 325-1556

ANALYTICAL REPORT

Attn: *Denver Bearden*
Company: *PNM Gas Services*
Address: *603 W. Elm*
City, State: *Farmington, NM 87401*

Date: *17-Oct-97*
COC No.: *5820*
Sample No.: *16510*
Job No.: *2-1000*

Project Name: *PNM Gas Services - Breech A #127*
Project Location: *9710061030; Composite, Walls @ 9' and Bottom @ 12'*
Sampled by: *GC* Date: *6-Oct-97* Time: *10:30*
Analyzed by: *HR* Date: *10-Oct-97*
Sample Matrix: *Soil*

Laboratory Analysis

Parameter	Results as Received	Unit of Measure	Limit of Quantitation	Unit of Measure
<i>Benzene</i>	ND	ug/kg	2	ug/kg
<i>Toluene</i>	17	ug/kg	10	ug/kg
<i>Ethylbenzene</i>	9	ug/kg	2	ug/kg
<i>m,p-Xylene</i>	66	ug/kg	2	ug/kg
<i>o-Xylene</i>	47	ug/kg	2	ug/kg
	<i>TOTAL</i>	138	ug/kg	

ND - Not Detected at Limit of Quantitation

Method - SW-846 EPA Method 8020A Aromatic Volatile Organics by Gas Chromatography

Approved by: *[Signature]*
Date: *10/17/97*

P.O. BOX 2606 • FARMINGTON, NM 87499

- TECHNOLOGY BLENDING INDUSTRY WITH THE ENVIRONMENT -

11-3-97 @ 1045

Breach A #127

Coulkins

(B) 8-26N-6W

RIO Arriba

Sample # 9711031045

Land farm field head space: 0ppm

N

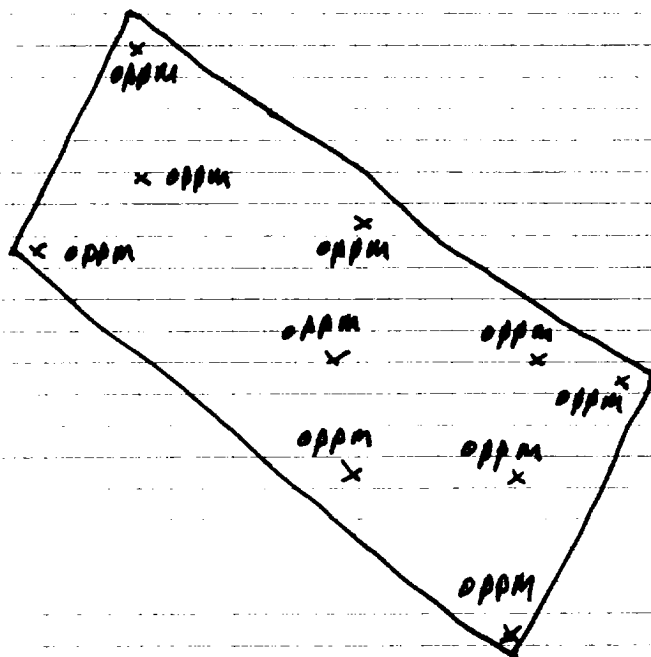

WH

2"-10"

OFF: (505) 325-5667



LAB: (505) 325-1556

ANALYTICAL REPORT

Attn: *Denver Bearden*
Company: *PNM Gas Services*
Address: *603 W. Elm*
City, State: *Farmington, NM 87401*

Date: *5-Nov-97*
COC No.: *5985*
Sample No.: *16754*
Job No.: *2-1000*

Project Name: *PNM Gas Services - Breech A #127 Landfarm*
Project Location: *9711031045; Composite*
Sampled by: *RH* Date: *3-Nov-97* Time: *10:45*
Analyzed by: *DC/HR* Date: *3-Nov-97*
Sample Matrix: *Soil*

Laboratory Analysis

Parameter	Results as Received	Unit of Measure	Limit of Quantitation	Unit of Measure
<i>Diesel Range Organics (C10 - C28)</i>	ND	mg/kg	5	mg/kg

ND - Not Detected at Limit of Quantitation

Quality Assurance Report

DRO QC No.: 0555-STD

Continuing Calibration Verification

Parameter	Method Blank	Unit of Measure	True Value	Analyzed Value	RPD	RPD Limit
<i>Diesel Range (C10 - C28)</i>	ND	ppm	200	214	6.5	15%

Matrix Spike

Parameter	1- Percent Recovered	2 - Percent Recovered	Limit	RPD	RPD Limit
<i>Diesel Range (C10-C28)</i>	95	94	(70-130)	1	20%

Method - *SW-846 EPA Method 8015A mod. - Nonhalogenated Volatile Hydrocarbons by Gas Chromatography*

Approved by: *JAC*
Date: *11/5/97*

P.O. BOX 2606 • FARMINGTON, NM 87499

- TECHNOLOGY BLENDING INDUSTRY WITH THE ENVIRONMENT -