

District I  
P.O. Box 1980, Hobbs, NM

State of New Mexico  
Energy, Minerals and Natural Resources Dept.

SUBMIT 1 COPY  
TO APPROPRIATE  
DISTRICT  
OFFICE AND 1  
COPY TO SANTA  
FE OFFICE

District II  
P.O. Drawer DD, Artesia, NM 88221

OIL CONSERVATION DIVISION  
2040 S. Pacheco  
Santa Fe, New Mexico 87504

District III  
1000 Rio Brazos Rd, Aztec, NM 87410

**PIT REMEDIATION AND CLOSURE REPORT**

Operator: Caulkins Oil Company

Telephone: (505) 632-1544

Address: P.O. Box 340, Bloomfield, NM 87413

Facility or Well Name: Breech "A" 625

Location: Unit or Qtr/Qtr Sec D Sec 8 T 26N R 6W County Rio Arriba

Pit Type: Separator ☒ Dehydrator ☐ Other ☐

Land Type: BLM ☒ State ☐ Fee ☐ Other ☐

Pit Location: Pit dimensions: length 25' , width 15' , depth 3'  
(Attach diagram)

References: wellhead ☒ , other ☐

Footage from reference: 45'

Direction from reference: 315 Degrees East North  
of  
☒ West South

Depth to Ground Water: (Vertical distance from contaminants to seasonal high water elevation of ground water)	Less than 50 feet	(20 points)	
	50 feet to 99 feet	(10 points)	
	Greater than 100 feet	(0 points)	0

Wellhead Protection Area: (Less than 200 feet from a private domestic water source, or; less than 1000 feet from all other water sources)	Yes	(20 points)	
	No	(0 points)	0

Distance to Surface Water: (Horizontal distance to perennial lakes, ponds, rivers, streams, creeks, irrigation canals and ditches)	Less than 200 feet	(20 points)	
	200 feet to 1000 feet	(10 points)	
	Greater than 1000 feet	(0 points)	0

RANKING SCORE (TOTAL POINTS): 0

Date Remediation Started: 8-12-96 Date Completed: 8-12-96

Remediation Method: Excavation \_\_\_\_\_ Approx. cubic yards \_\_\_\_\_  
(Check all appropriate sections) Landfarmed \_\_\_\_\_ Insitu Bioremediation \_\_\_\_\_

Other Tested Clean

Remediation Location: Onsite X Offsite \_\_\_\_\_  
(ie. landfarmed onsite,  
name and location of  
offsite facility)

General Description of Remedial Action: Samples taken from pit were within standards.

Pit was closed using clean sandy soil from existing wellpad. Disturbed areas have  
been re-seeded according to guidelines.

Ground Water Encountered: No X Yes \_\_\_\_\_ Depth \_\_\_\_\_

Final Pit: Sample location 3' below bottom of existing pit

Closure Sampling:  
(if multiple samples,  
attach sample results  
and diagram of sample) Sample depth 6'

Sample date 6-25-96 Sample time 1:55 PM

Benzene (ppm) \_\_\_\_\_

Total BTEX (ppm) \_\_\_\_\_

Field headspace (ppm) 17.1

TPH ND

Ground Water Sample: Yes \_\_\_\_\_ No X (If yes, attach sample results)

I HEREBY CERTIFY THAT THE INFORMATION ABOVE IS TRUE AND COMPLETE TO THE BEST OF MY  
KNOWLEDGE AND BELIEF.

DATE October 11, 1996

SIGNATURE Robert L. Verquer

PRINTED NAME  
AND TITLE

ROBERT L. VERQUER, SUPERINTENDENT

WELL NAME: Breech A 625

CAULKINS OIL  
SITE SECURITY DIAGRAM

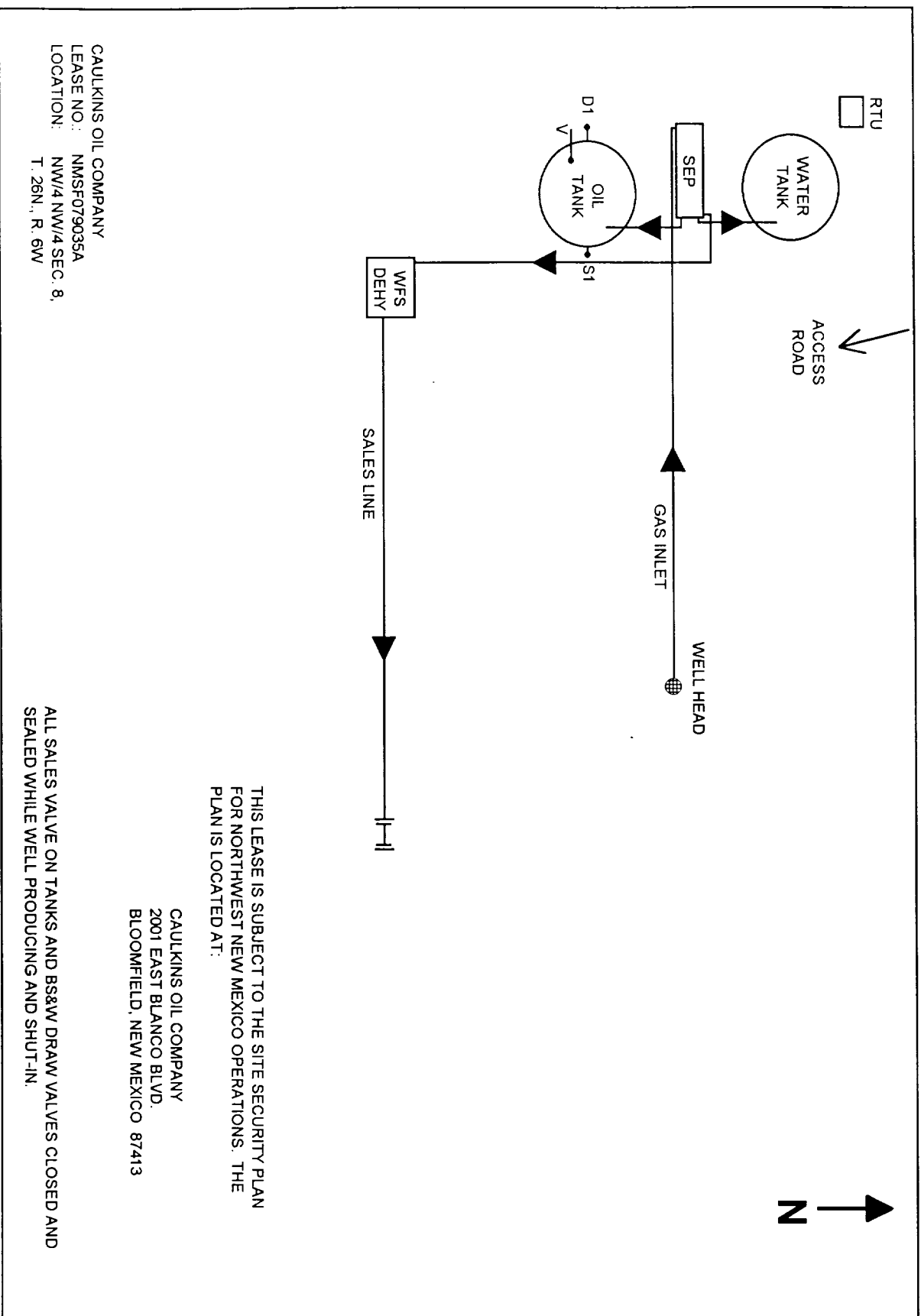



## TOTAL RECOVERABLE PETROLEUM HYDROCARBONS

Diesel Range Organics

Caulkins Oil Company

Project ID: NA  
Sample Matrix: Soil  
Preservative: Cool  
Condition: Intact

Report Date: 07/08/96  
Date Sampled: 06/25/96  
Date Received: 06/26/96  
Date Extracted: 07/02/96  
Date Analyzed: 07/03/96

Sample ID	Lab ID	Concentration (mg/kg)	Detection Limit (mg/kg)
Breach A 625	4060	ND	17.2

ND- Analyte not detected at the stated detection limit.

<b>Quality Control:</b>	<u>Surrogate</u>	<u>% Recovery</u>	<u>Acceptance Limits</u>
	o - Terphenyl	54%	50 - 150%

**Reference:** EPA Method 8015A, modified. "Nonhalogenated Volatile Organics by Gas Chromatography." Test Methods for Evaluating Solid Waste, Physical/Chemical Methods, SW-846, 3rd Ed, Final Update I, July, 1992. USEPA.

**Comments:**

  
Analyst

  
Review



**TOTAL VOLATILE PETROLEUM HYDROCARBONS**  
**Gasoline Range Organics**

Caulkins Oil Co.

Project ID: NA  
Sample Matrix: Soil  
Preservative: Cool  
Condition: Intact

Report Date: 07/08/96  
Date Sampled: 06/25/96  
Date Received: 06/26/96  
Date Extracted: 07/01/96  
Date Analyzed: 07/01/96

Sample ID	Lab ID	Concentration (mg/kg)	Detection Limit (mg/kg)
Breach A 625	4060	ND	20.4

ND- Analyte not detected at the stated detection limit.

Quality Control:	<u>Surrogate</u>	<u>% Recovery</u>	<u>Acceptance Limits</u>
	Trifluorotoluene	88%	50 - 150%

**Reference:** Method for the Determination of Gasoline Range Organics,  
State of Tennessee, Department of Environment and Conservation, Division  
of Underground Storage Tanks.

**Comments:**

  
Analyst

  
Review