

04

Denny E. Faust

JICARILLA APACHE TRIBE

DEPUTY OIL & GAS INSPECTOR ENVIRONMENTAL PROTECTION OFFICE

SUBMIT 1 COPY TO
NATURAL
RESOURCE DEPT
AND OIL GAS
ADMINISTRATION

FEB 08 1999

P.O. BOX 507
DULCE, NEW MEXICO 87528

Approved

PIT REMEDIATION AND CLOSURE REPORT

Operator: PNM Gas Services (<u>BRGG</u>)		Telephone: <u>324-3764</u>	
Address: <u>603 W. Elm Street Farmington, NM 87401</u>			
Facility or Well Name: <u>Ticariilla G-1</u>			
Location:	Unit: <u>L</u>	Sec. <u>1</u>	T <u>26</u> N R. <u>5</u> W County <u>Rio Arriba</u>
Pit Type:	Separator <u> </u>	Dehydrator <u>XX</u>	Other <u> </u>
Land Type:	<u>Jicarilla Apache</u>		
Pit Location:		Pit dimensions: length <u>20'</u> width <u>20'</u> depth <u>2'</u>	
(Attach diagram)	Reference: wellhead <u>X</u>		other <u> </u>
		Footage from reference: <u>43'</u>	
		Direction from reference: <u>Due</u> Degrees <u> </u> East of North <u> </u>	
		<u>X</u> West of South <u> </u>	
Depth to Ground Water: <small>(Vertical distance from contaminants to seasonal high water elevation of ground water)</small>		Less than 50 feet 50 feet to 99 feet Greater than 100 feet	(20 points) (10 points) (0 points) <u>0</u>
Wellhead Protection Area: <small>(Less than 200 feet from a private domestic water source, or, less than 1,000 feet from all other water sources)</small>		Yes No	(20 points) (0 points) <u>0</u>
Distance to Surface Water: <small>(Horizontal distance to perennial lakes, ponds, rivers, streams, creeks, irrigation canals and ditches)</small>		Less than 200 feet 200 feet to 1,000 feet Greater than 1,000 feet	(20 points) (10 points) (0 points) <u>0</u>
Distance to Ephemeral Stream (dry wash): <small>(Horizontal distance to all downgradient streams having a width of at least 10 feet)</small>		Less than or equal to 100 feet Greater than 100 feet	(10 points) (0 points) <u>0</u>
Distance to Nearest Lake, Playa, or Watering Pond: <small>(Horizontal distance to all downgradient lakes, playas, and livestock or wildlife water ponds)</small>		Less than or equal to 100 feet Greater than 100 feet	(10 points) (0 points) <u>0</u>
RANKING SCORE (TOTAL POINTS):			<u>0</u>

Date Remediation Started: 4/20/98 Date Completed: 6/29/98

Remediation Method: Excavation X Approx. Cubic Yards 2,616

(Check all appropriate sections)

Landfarmed X Amount Landfarmed (cubic yds): 2,616

Other _____

Remediation Location: Onsite X Offsite _____
(i.e., landfarmed onsite, name and location of offsite facility)

General Description of Remedial Action:

Removed contaminated soil from all four side walls as to get a below 100 ppm head space reading. Bottom was solid sandstone rock. Excavation size 58'x42'x29'

Ground Water Encountered: No X Yes _____ Depth _____

Final Pit Closure Sampling:

Sample Location North, East, South, West side walls and bottom of pit

(if multiple samples, attach sample result and diagram of sample locations and depths.)

Sample depth 29'

Sample date 4/22/98 Sample time 1416

Sample Results

Soil: Benzene (ppm) _____ Water: Benzene (ppb) _____

Total BTEX (ppm) _____ Toluene (ppb) _____

Field headspace (ppm) 98.6 Ethylbenzene (ppb) _____

TPH 300 ppm Method 8015 Total Xylenes (ppb) _____

Ground Water Sample: Yes _____ No X (If yes, attach sample results)

I HEREBY CERTIFY THAT THE INFORMATION ABOVE IS TRUE AND COMPLETE TO THE BEST OF MY KNOWLEDGE AND MY BELIEF

DATE 5/1/98

PRINTED NAME Roy Burnham

SIGNATURE Roy Burnham

AND TITLE Environmental Technician II

AFTER REVIEW OF THE PIT CLOSURE INFORMATION, PIT CLOSURE IS APPROVED IN ACCORDANCE TO JICARILLA APACHE TRIBE PIT CLOSURE ORDINANCE.

APPROVED: YES X NO _____ (REASON): _____

SIGNED: Kent M... DATE: 5-13-98

Jicarilla G-1
Sec. 1 T24N R54W Unit L
BROG

Site Drawing

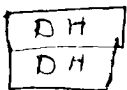
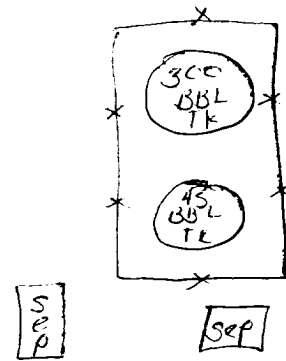

JICANILLA G-1
Sec. 1 T26N R5W Unit L
BROG

58 x 42 x 21

Excavation Drawing

North Wall
Sample 28'
13.9 ppm

West Wall
Sample 26'
5.6 ppm

East Wall
Sample 27'
7.2 ppm

Bottom
Sample 29'
98.6 ppm

South Wall
Sample 26'
2.0 ppm

5' Sample - 1328 ppm
10' Sample - 1024 ppm
15' Sample - 1000 ppm
20' Sample - 751 ppm
25' Sample - 691 ppm
29' Sample - Rock

OFF: (505) 325-5667



LAB: (505) 325-1556

ANALYTICAL REPORT

Date: 29-Apr-98

Client:	PNM - Public Service Company of NM	Client Sample Info:	Jicarilla G-1
Work Order:	9804039	Client Sample ID:	9804221416; 3pt. Bottom
Lab ID:	9804039-02A	Matrix:	SOIL
Project:	Jicarilla G-1	Collection Date:	4/22/98 2:16:00 PM
		COC Record:	7149

Parameter	Result	PQL	Qual	Units	DF	Date Analyzed
DIESEL RANGE ORGANICS		SW8015				Analyst: HR
T/R Hydrocarbons: C10-C28	300	25		mg/Kg	1	4/27/98

Qualifiers:	PQL - Practical Quantitation Limit	S - Spike Recovery outside accepted recovery limits
	ND - Not Detected at Practical Quantitation Limit	R - RPD outside accepted recovery limits
	J - Analyte detected below Practical Quantitation Limit	E - Value above quantitation range
	B - Analyte detected in the associated Method Blank	Surr: - Surrogate

1 of 1

P.O. BOX 2606 • FARMINGTON, NM 87499

- TECHNOLOGY BLENDING INC. UTIL. WITH THE ENVIRONMENT -

OFF: (505) 325-5667



LAB: (505) 325-1556

ANALYTICAL REPORT

Date: 29-Apr-98

Client:	PNM - Public Service Company of NM	Client Sample Info:	Jicarilla G-1
Work Order:	9804039	Client Sample ID:	9804221415; 4pt. Composite
Lab ID:	9804039-01A	Matrix:	SOIL
Project:	Jicarilla G-1	Collection Date:	4/22/98 2:15:00 PM
		COC Record:	7149

Parameter	Result	PQL	Qual	Units	DF	Date Analyzed
DIESEL RANGE ORGANICS		SW8015				Analyst: HR
T/R Hydrocarbons: C10-C28	25	25		mg/Kg	1	4/27/98

Qualifiers:

PQL - Practical Quantitation Limit
ND - Not Detected at Practical Quantitation Limit
J - Analyte detected below Practical Quantitation Limit
B - Analyte detected in the associated Method Blank

S - Spike Recovery outside accepted recovery limits
R - RPD outside accepted recovery limits
E - Value above quantitation range
Surr: - Surrogate

1 of 1

P.O. BOX 2606 • FARMINGTON, NM 87499

- TECHNOLOGY BLENDING INDUSTRY WITH THE ENVIRONMENT -

#1

JICARILLA APACHE TRIBE
ENVIRONMENTAL
PROTECTION OFFICE
P.O. BOX 507
DULCE, NEW MEXICO 87528

SUBMIT 1 COPY TO
NATURAL
RESOURCE DEPT
AND OIL GAS
ADMINISTRATION

ON-SITE SOIL REMEDIATION REPORT

Operator: PNM Gas Services (BROG) Telephone: 324-3764	
Address: 603 W. Elm Street Farmington, NM 87401	
Facility or Well Name: Jicarilla G-1	
Location:	Unit: L Sec. 1 T. 24 N R. 5 W County Rio Arriba
Land Type: Jicarilla Apache	
Date Remediation Started: 4/20/98 Date Completed: 5/11/98	
Remediation Method: Landfarmed <input checked="" type="checkbox"/> Approx. cubic yards 872	
Composted <input type="checkbox"/> Other <input type="checkbox"/>	
Depth to Ground Water: (pts.) <u>2</u>	Final Closure Sampling: Sampling Date: 5/7/98 1217 PM Time 1217 Sampling Results: Field Headspace (ppm) 63.4 TPH (ppm) 98 Method 8C15 Other <input type="checkbox"/>
Distance to an Ephemeral Stream: (pts.) <u>2</u>	
Distance to Nearest Lake, Playa, or Watering Pond: (pts.) <u>2</u>	
Wellhead Protection Area: (pts.) <u>2</u>	
Distance to Surface Water: (pts.) <u>2</u>	
Ranking Score (Total Points): <u>2</u>	
I HEREBY CERTIFY THAT THE INFORMATION ABOVE IS TRUE AND COMPLETE TO THE BEST OF MY KNOWLEDGE AND BELIEF	
DATE 5/13/98 PRINTED NAME Roy Burnham	
SIGNATURE Roy Burnham AND TITLE Environmental Technician II	
AFTER REVIEW OF THE SOIL REMEDIATION INFORMATION, ON-SITE REMEDIATION APPROVED IN ACCORDANCE TO THE JICARILLA APACHE TRIBE PIT CLOSURE ORDINANCE	
APPROVED: YES <input checked="" type="checkbox"/> NO <input type="checkbox"/> (REASON) use as Backfill	
SIGNED: [Signature] DATE: 5-13-98	

JICANILLA G-1
Sec. 1 T26N R5W Unit L
BROG

Landfarm Drawing #1

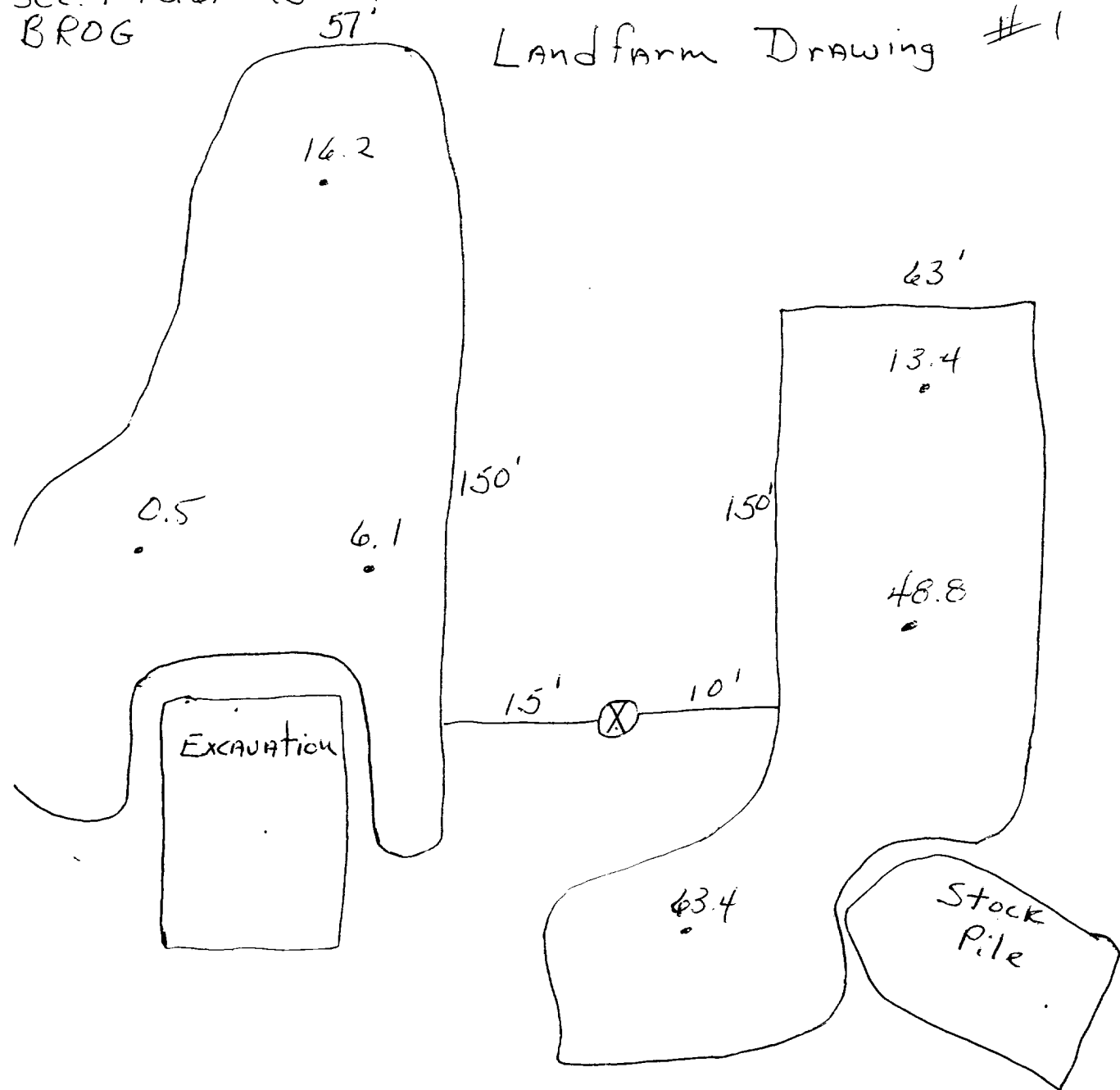

OFF: (505) 325-5667



ON SITE

TECHNOLOGIES, LTD.

LAB: (505) 325-1556

On Site Technologies, LTD.

Date: 12-May-98

CLIENT: PNM - Public Service Company of NM

Project: PNM Pit Remediation

Lab Order: 9805020

CASE NARRATIVE

Samples were analyzed using the methods outlined in the following references:

Test Methods for Evaluating Solid Waste, Physical/Chemical Methods, SW846, 3rd Edition

All method blanks, laboratory spikes, and/or matrix spikes met quality assurance objectives.

OFF: (505) 325-5667



LAB: (505) 325-1556

ANALYTICAL REPORT

Date: 12-May-98

Client:	PNM - Public Service Company of NM	Client Sample Info:	Jicarilla G-1 Landfarm
Work Order:	9805020	Client Sample ID:	9805071217; 6pt. Composite
Lab ID:	9805020-01A	Matrix:	SOIL
Project:	PNM Pit Remediation	Collection Date:	5/7/98 12:17:00 PM
		COC Record:	7145

Parameter	Result	PQL	Qual	Units	DF	Date Analyzed
DIESEL RANGE ORGANICS		SW8015				Analyst: HR
T/R Hydrocarbons: C10-C28	98	25		mg/Kg	1	5/11/98

Qualifiers:

PQL - Practical Quantitation Limit
ND - Not Detected at Practical Quantitation Limit
J - Analyte detected below Practical Quantitation Limit
B - Analyte detected in the associated Method Blank

S - Spike Recovery outside accepted recovery limits
R - RPD outside accepted recovery limits
E - Value above quantitation range
Surr: - Surrogate

1 of 1

P.O. BOX 2606 • FARMINGTON, NM 87499

- TECHNOLOGY BLENDING INDUSTRY WITH THE ENVIRONMENT -

#2

JICARILLA APACHE TRIBE
ENVIRONMENTAL
PROTECTION OFFICE
P.O. BOX 507
DULCE, NEW MEXICO 87528

SUBMIT 1 COPY TO
NATURAL
RESOURCE DEPT
AND OIL & GAS
ADMINISTRATION

ON-SITE SOIL REMEDIATION REPORT

Operator: PNM Gas Services (<u>BROG</u>) Telephone: <u>324-3764</u>	
Address: <u>603 W. Elm Street Farmington, NM 87401</u>	
Facility or Well Name: <u>JICARILLA G-1</u>	
Location:	Unit: <u>L</u> Sec. <u>1</u> T. <u>26</u> N R. <u>5</u> W County <u>Rio Arriba</u>
Land Type: <u>Jicarilla Apache</u>	
Date Remediation Started: <u>4/20/98</u> Date Completed: <u>4/5/98</u>	
Remediation Method: Landfarmed <input checked="" type="checkbox"/> Approx. cubic yards <u>872</u> Composted <input type="checkbox"/> Other <input type="checkbox"/>	
Depth to Ground Water: (pts.) <u>0</u> Distance to an Ephemeral Stream: (pts.) <u>0</u> Distance to Nearest Lake, Playa, or Watering Pond: (pts.) <u>0</u> Wellhead Protection Area: (pts.) <u>0</u> Distance to Surface Water: (pts.) <u>0</u> Ranking Score (Total Points): <u>0</u>	Final Closure Sampling: Sampling Date: <u>4/4/98</u> Time <u>1422</u> Sampling Results: Field Headspace (ppm) <u>10.7</u> TPH (ppm) <u>35</u> Method <u>8015</u> Other _____
I HEREBY CERTIFY THAT THE INFORMATION ABOVE IS TRUE AND COMPLETE TO THE BEST OF MY KNOWLEDGE AND BELIEF	
DATE <u>4/10/98</u> PRINTED NAME <u>Roy Burnham</u>	
SIGNATURE <u>Roy Burnham</u> AND TITLE <u>Environmental Technician II</u>	
AFTER REVIEW OF THE SOIL REMEDIATION INFORMATION, ON-SITE REMEDIATION APPROVED IN ACCORDANCE TO THE JICARILLA APACHE TRIBE PIT CLOSURE ORDINANCE	
APPROVED: YES <input checked="" type="checkbox"/> NO <input type="checkbox"/> (REASON) <u>was as Backfill</u>	
SIGNED: <u>[Signature]</u> DATE: <u>6-10-98</u>	

Jicarilla G-1
Sec-1 T-26N R-SW unit L

#2
LAND FARM
DRAWING

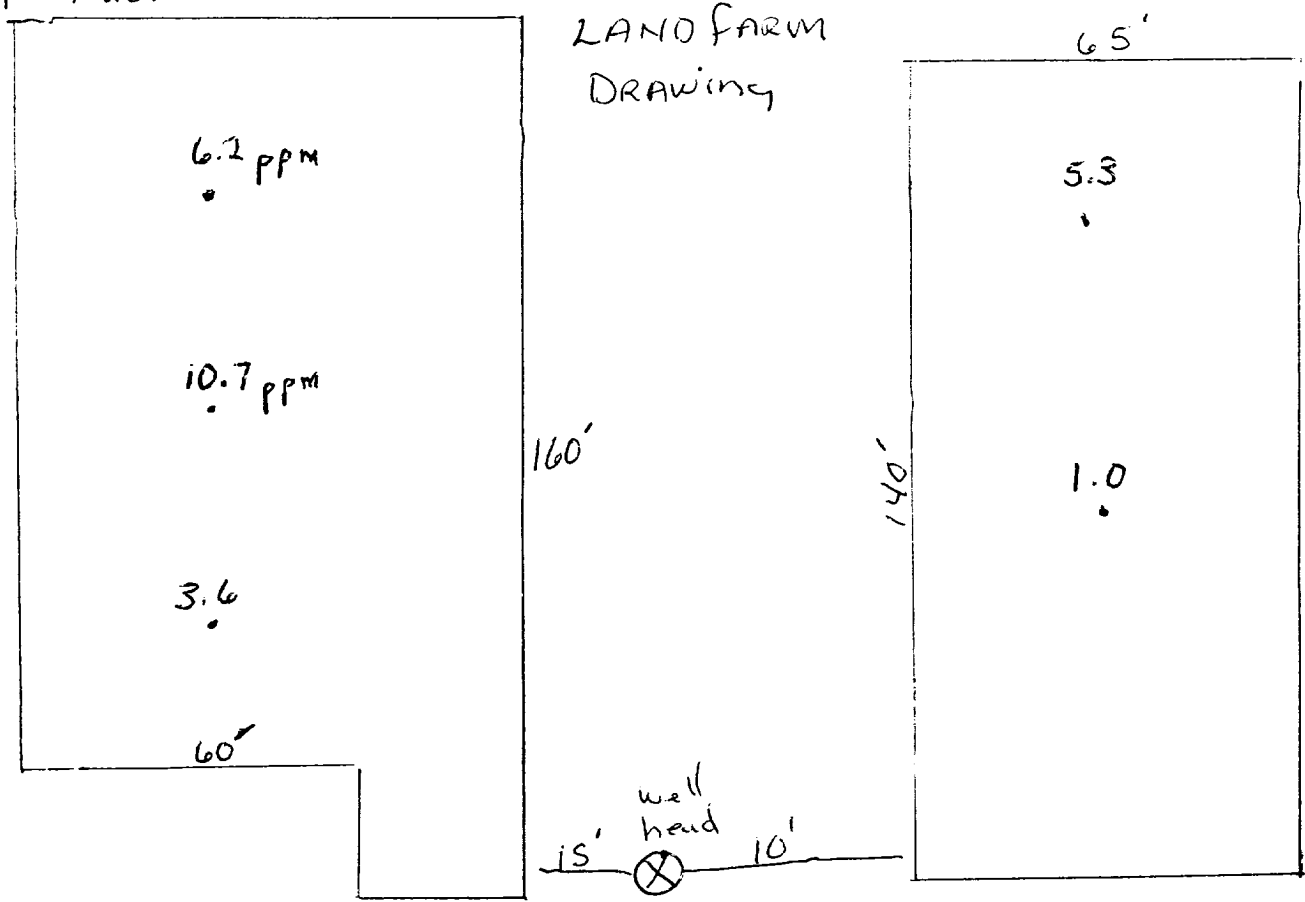

STOCK
Pile

OFF: (505) 325-5667

ON SITE

LAB: (505) 325-1556

TECHNOLOGIES, LTD.

On Site Technologies, LTD.

Date: 08-Jun-98

CLIENT: PNM - Public Service Company of NM

Project: Jicarilla Landfarms

Lab Order: 9806017

CASE NARRATIVE

Samples were analyzed using the methods outlined in the following references:

Test Methods for Evaluating Solid Waste, Physical/Chemical Methods, SW846. 3rd Edition

All method blanks, laboratory spikes, and/or matrix spikes met quality assurance objectives.

ON SITE

OFF: (505) 325-5667

LAB: (505) 325-1556

TECHNOLOGIES, LTD.

ANALYTICAL REPORT

Date: 08-Jun-98

Client:	PNM - Public Service Company of NM	Client Sample Info:	Jicarilla G-1 Landfarm
Work Order:	9806017	Client Sample ID:	9806041422: 5pt. Comp.
Lab ID:	9806017-01A	Matrix:	SOIL
Project:	Jicarilla Landfarms	Collection Date:	6/4/98 2:22:00 PM
		COC Record:	7181

Parameter	Result	PQL	Qual	Units	DF	Date Analyzed
DIESEL RANGE ORGANICS		SW8015				Analyst: HR
T/R Hydrocarbons: C10-C28	35	25		mg/Kg	1	6/5/98

Qualifiers:	PQL - Practical Quantitation Limit	S - Spike Recovery outside accepted recovery limits
	ND - Not Detected at Practical Quantitation Limit	R - RPD outside accepted recovery limits
	J - Analyte detected below Practical Quantitation Limit	E - Value above quantitation range
	B - Analyte detected in the associated Method Blank	Surr: - Surrogate

1 of 1

P.O. BOX 2606 • FARMINGTON, NM 87499

#3

JICARILLA APACHE TRIBE
ENVIRONMENTAL
PROTECTION OFFICE
P.O. BOX 507
DULCE, NEW MEXICO 87528

SUBMIT 1 COPY TO
NATURAL
RESOURCE DEPT
AND OIL-GAS
ADMINISTRATION

ON-SITE SOIL REMEDIATION REPORT

Operator: PNM Gas Services (<u>BROG</u>) Telephone: <u>324-3764</u>	
Address: <u>603 W. Elm Street Farmington, NM 87401</u>	
Facility or Well Name: <u>JICARILLA G-1</u>	
Location:	Unit: <u>L</u> Sec. <u>1</u> T. <u>26</u> N R. <u>5</u> W County <u>Rio Arriba</u>
Land Type: <u>Jicarilla Apache</u>	
Date Remediation Started: <u>4/20/98</u> Date Completed: <u>6/26/98</u>	
Remediation Method: Landfarmed <u>Y</u> Approx. cubic yards <u>872</u> Composted _____ Other _____	
Depth to Ground Water: (pts.) <u>Ø</u> Distance to an Ephemeral Stream: (pts.) <u>Ø</u> Distance to Nearest Lake, Playa, or Watering Pond: (pts.) <u>Ø</u> Wellhead Protection Area: (pts.) <u>Ø</u> Distance to Surface Water: (pts.) <u>Ø</u> Ranking Score (Total Points): <u>Ø</u>	Final Closure Sampling: Sampling Date: <u>6/23/98</u> Time <u>0949</u> Sampling Results: Field Headspace (ppm) <u>10.2</u> TPH (ppm) <u>40</u> Method <u>8015</u> Other _____
I HEREBY CERTIFY THAT THE INFORMATION ABOVE IS TRUE AND COMPLETE TO THE BEST OF MY KNOWLEDGE AND BELIEF	
DATE <u>6/29/98</u> PRINTED NAME <u>Roy Burnham</u>	
SIGNATURE <u>Roy Burnham</u> AND TITLE <u>Environmental Technician II</u>	
AFTER REVIEW OF THE SOIL REMEDIATION INFORMATION, ON-SITE REMEDIATION APPROVED IN ACCORDANCE TO THE JICARILLA APACHE TRIBE PIT CLOSURE ORDINANCE	
APPROVED: YES <u>X</u> NO _____ (REASON) <u>use as Backfill</u>	
SIGNED: <u>Kee M...</u> DATE: <u>6-29-98</u>	

JICAR111A G-1

UNIT L SEC 1 T26N R5W

BURLINGTON

LANDFARM #3

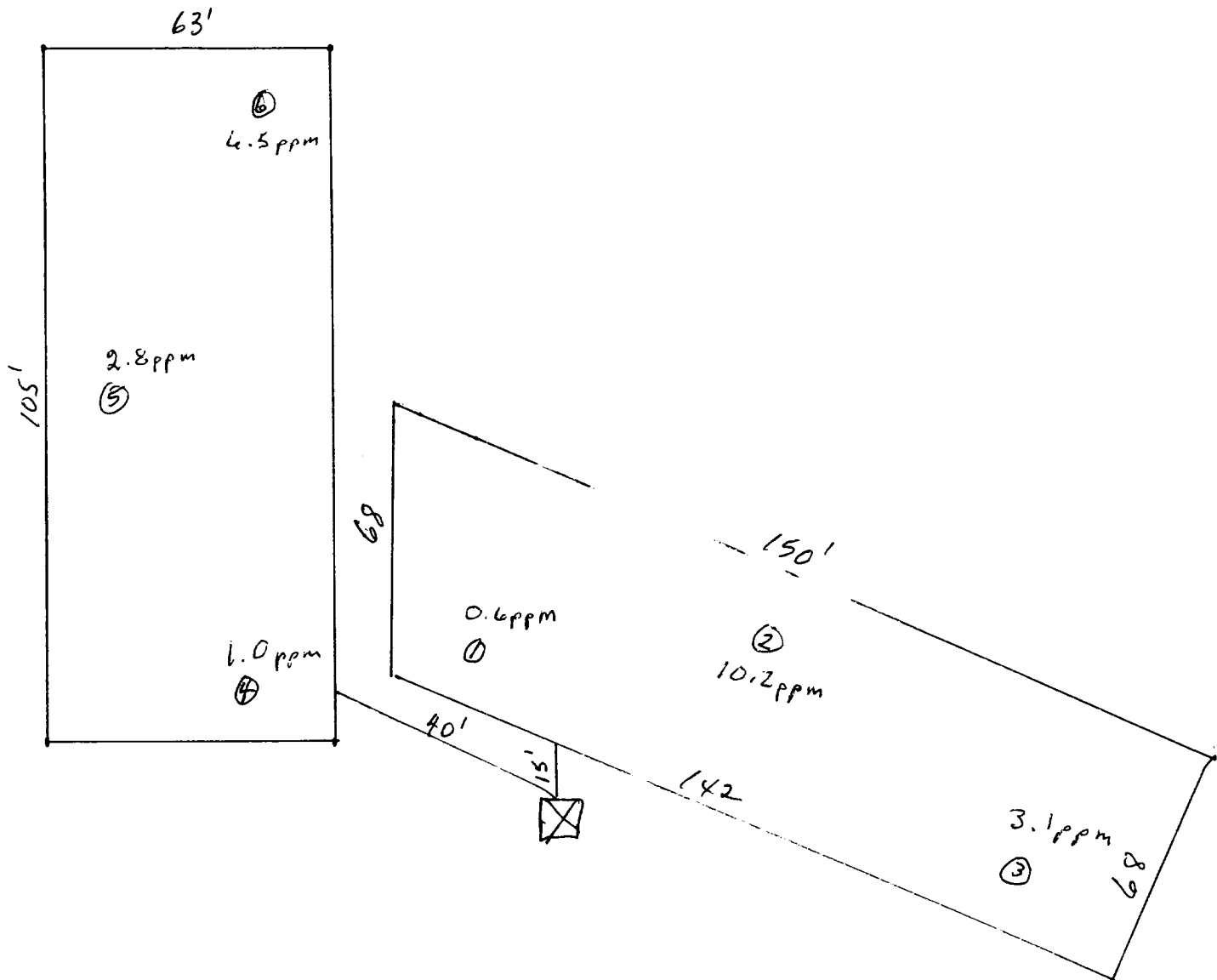

OFF: (505) 325-5667

ON SITE

LAB: (505) 325-1556

TECHNOLOGIES, LTD.

On Site Technologies, LTD.

Date: 29-Jun-98

CLIENT: PNM - Public Service Company of NM

Project: Jicarilla Landfarms

Lab Order: 9806092

CASE NARRATIVE

Samples were analyzed using the methods outlined in the following references:

Test Methods for Evaluating Solid Waste, Physical/Chemical Methods, SW846, 3rd Edition

All method blanks, laboratory spikes, and/or matrix spikes met quality assurance objectives.

OFF: (505) 325-5667

ON SITE
TECHNOLOGIES, LTD.

LAB: (505) 325-1556

ANALYTICAL REPORT

Date: 29-Jun-98

Client:	PNM - Public Service Company of NM	Client Sample Info:	Jicarilla G-1 LF #3
Work Order:	9806092	Client Sample ID:	9806230949; 6pt. Comp.
Lab ID:	9806092-02A	Matrix:	SOIL
Project:	Jicarilla Landfarms	Collection Date:	6/23/98 9:49:00 AM
		COC Record:	7060

Parameter	Result	PQL	Qual	Units	DF	Date Analyzed
DIESEL RANGE ORGANICS		SW8015				Analyst: DC
T/R Hydrocarbons: C10-C28	40	25		mg/Kg	1	6/26/98

Qualifiers:	PQL - Practical Quantitation Limit	S - Spike Recovery outside accepted recovery limits
	ND - Not Detected at Practical Quantitation Limit	R - RPD outside accepted recovery limits
	J - Analyte detected below Practical Quantitation Limit	E - Value above quantitation range
	B - Analyte detected in the associated Method Blank	Surr: - Surrogate

1 of 1