

District I
P O Box 1900 Hobbs, NM

District II
P O Drawer DD, Artesia NM 88221

District III
1000 Rio Brazos Rd Aztec, NM 87410

State of New Mexico
Energy, Minerals and Natural Resources Department

OIL CONSERVATION DIVISION

2040 South Pacheco Street
Santa Fe, New Mexico 87505

SUBMIT 1 COPY TO
APPROPRIATE
DISTRICT OFFICE
AND 1 COPY TO
SANTA FE OFFICE

PIT REMEDIATION AND CLOSURE REPORT

Operator: PNM Gas Services (Caulkins) Telephone: 324-3764

Address: 603 W. Elm Street Farmington, NM 87401

Facility or Well Name: Breach E #85

Location: Unit L Sec 4 T 26 N R 6 W County Rio Arriba

Pit Type: Separator Dehydrator Other Drip Riser

Land Type: BLM ☒ State Fee Other No

Pit Location: Pit dimensions: length 20 width 20 depth 3

(Attach diagram) Reference: wellhead ☒ other

Footage from reference: 100'

Direction from reference: 60 Degrees East North

 of

☒ West South ☒

Depth to Ground Water: Less than 50 feet (20 points)
50 feet to 99 feet (10 points)
Greater than 100 feet (0 points) 0

(Vertical distance from contaminants to
seasonal high water elevation of ground
water)

Wellhead Protection Area:

(Less than 200 feet from a private
domestic water source, or, less than 1,000
feet from all other water sources)

Yes (20 points)
No (0 points) 0

Distance to Surface Water:

(Horizontal distance to perennial lakes,
ponds, rivers, streams, creeks, irrigation
canals and ditches)

Less than 200 feet (20 points)
200 feet to 1,000 feet (10 points)
Greater than 1,000 feet (0 points) 0

RANKING SCORE (TOTAL POINTS): 0

Breach E #85

Date Remediation Started: 7/21/97

Date Completed: 7/21/97

Remediation Method: Excavation ☒

Approx. Cubic Yard 293

(Check all appropriate sections)

Landfarmed ☒

Amount Landfarmed (cubic yds) 293

Other

Remediation Location:

Onsite ☒

Offsite

(i.e., landfarmed onsite, name and location of offsite facility)

Backfill Material Location:

General Description of Remedial Action:

Excavated contaminated soil to a pit size of 22' X 20' X 18' and landfarmed soil onsite within a bermed area at a depth of 6" to 12". Soil was aerated by disking/plowing until soil met regulatory levels.

Ground Water Encountered:

No ☒

Yes

Depth

Final Pit Closure Sampling:

Sample Location

5 pt. composite - 4 side walls and center of pit bottom.

(if multiple samples, attach sample result and diagram of sample locations and depths.)

Sample depth

16' walls and 18' bottom.

Sample date

7/21/97

Sample time

10:30:00 AM

Sample Results

Benzene (ppm) < 0.0010

Total BTEX (ppm) 0.0010

Field headspace (ppm)

TPH (ppm)

< 5.00

Method

8015A

Vertical Extent (ft)

Risk Assessment form attached

Yes ☐No ☒

Ground Water Sample:

Yes ☐No ☒

(If yes, see attached Groundwater Site Summary Report)

I HEREBY CERTIFY THAT THE INFORMATION ABOVE IS TRUE AND COMPLETE TO THE BEST OF MY KNOWLEDGE AND MY BELIEF

DATE October 27, 1997

SIGNATURE



PRINTED NAME AND TITLE

Denver Bearden
Administrator III

Breech E#85
Can/Kins Oil
Sec. 4, 26N, 6W, L

7-21-97

Start of excavation:

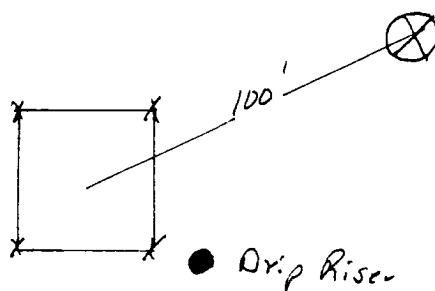

End of excavation:

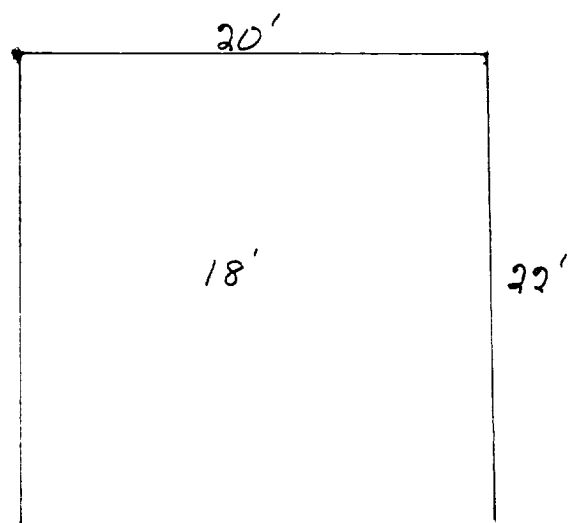

OFF: (505) 325-5667



LAB: (505) 325-1556

ANALYTICAL REPORT

Attn: *Denver Bearden*
Company: *PNM Gas Services*
Address: *603 W. Elm*
City, State: *Farmington, NM 87401*

Date: *24-Jul-97*
COC No.: *5918*
Sample No.: *15419*
Job No.: *2-1000*

Project Name: *PNM Gas Services - Breech E #85*
Project Location: *9707211030; 5pt. Composite, 4 Walls @ 16' and Bottom @ 18'*
Sampled by: *GC* Date: *21-Jul-97* Time: *10:30*
Analyzed by: *DC* Date: *22-Jul-97*
Sample Matrix: *Soil*

Laboratory Analysis

Parameter	Results as Received	Unit of Measure	Limit of Quantitation	Unit of Measure
<i>Benzene</i>	ND	ug/kg	1	ug/kg
<i>Toluene</i>	ND	ug/kg	1	ug/kg
<i>Ethylbenzene</i>	ND	ug/kg	1	ug/kg
<i>m,p-Xylene</i>	1	ug/kg	1	ug/kg
<i>o-Xylene</i>	ND	ug/kg	1	ug/kg
	<i>TOTAL</i>	1	ug/kg	

ND - Not Detected at Limit of Quantitation

Method - SW-846 EPA Method 8020A Aromatic Volatile Organics by Gas Chromatography

Approved by: *[Signature]*
Date: *7/24/97*

P.O. BOX 2606 • FARMINGTON, NM 87499

For more information, please contact: (505) 325-5667

N
N

8-14-97 @1100

Breach E #85

Coulkins

(L) 4-26N-6W

Landfarm Field head space: 0 ppm

Sample # 9708141100

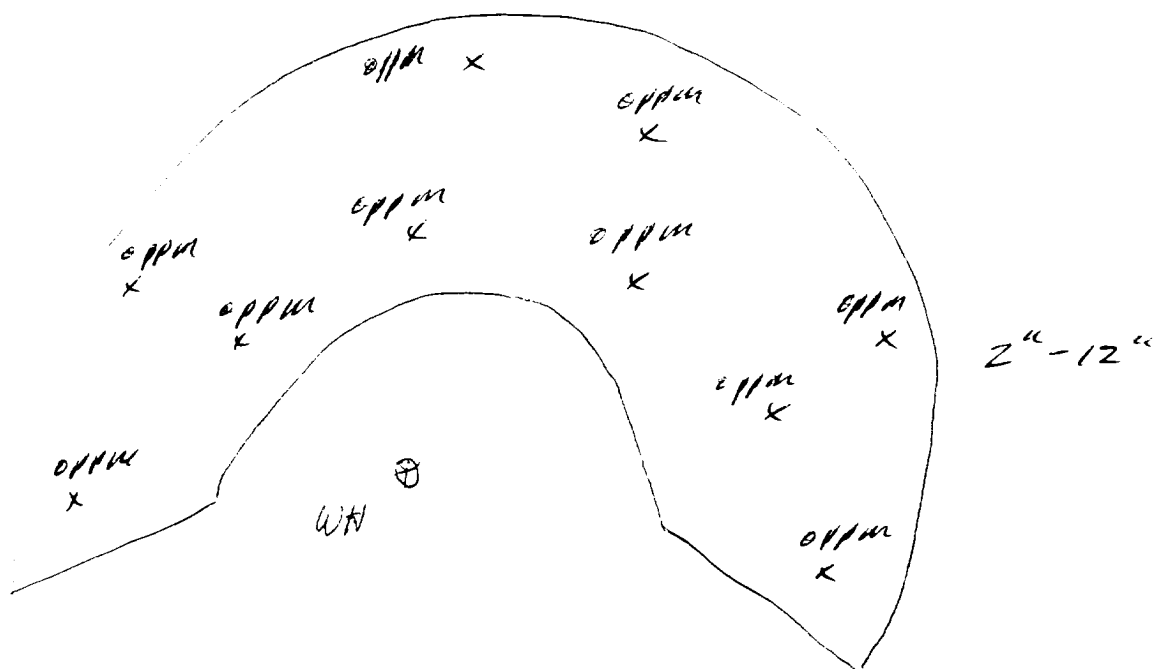

OFF: (505) 325-5667



LAB: (505) 325-1556

ANALYTICAL REPORT

Attn: *Denver Bearden*
Company: *PNM Gas Services*
Address: *603 W. Elm*
City, State: *Farmington, NM 87401*

Date: *19-Aug-97*
COC No.: *5202*
Sample No.: *15802*
Job No.: *2-1000*

Project Name: *PNM Gas Services - Breech E #85 Landfarm*
Project Location: *9708141100; Composite Sample*
Sampled by: *RH* Date: *14-Aug-97* Time: *11:00*
Analyzed by: *HR/DC* Date: *18-Aug-97*
Sample Matrix: *Soil*

Laboratory Analysis

Parameter	Results as Received	Unit of Measure	Limit of Quantitation	Unit of Measure
<i>Diesel Range Organics (C10 - C28)</i>	ND	mg/kg	5	mg/kg

ND - Not Detected at Limit of Quantitation

Quality Assurance Report

DRO QC No.: 0548-STD

Continuing Calibration Verification

Parameter	Method Blank	Unit of Measure	True Value	Analyzed Value	RPD	RPD Limit
<i>Diesel Range (C10 - C28)</i>	ND	ppm	200	183	8.9	15%

Matrix Spike

Parameter	1 - Percent Recovered	2 - Percent Recovered	Limit	RPD	RPD Limit
<i>Diesel Range (C10-C28)</i>	83	82	(70-130)	1	20%

Method - *SW-846 EPA Method 8015A mod. - Nonhalogenated Volatile Hydrocarbons by Gas Chromatography*

Approved by: *[Signature]*
Date: *8/19/97*

P.O. BOX 2606 • FARMINGTON, NM 87499

TEL: (505) 325-5667 FAX: (505) 325-1556