



IN REPLY REFER TO:

UNITED STATES
DEPARTMENT OF THE INTERIOR
GEOLOGICAL SURVEY
P. O. Box 965
Farmington, New Mexico

June 29, 1955

Candado Production Company
1400 Lohrs Tower
Phoenix, Arizona

Re: Santa Fe 079161

Gentlemen:

Receipt is acknowledged of your "Notice of Intention to Drill" dated June 28, 1955 covering your well No. 8 Candado in NE $\frac{1}{4}$ NE $\frac{1}{4}$ sec. 4, T. 26 N., R. 7 W., N. M. P. M., Rio Arriba County, New Mexico, South Blanco P.C. pool.

Your proposed work is hereby approved subject to compliance with the provisions of the "Oil and Gas Operating Regulations" revised May 25, 1942, a copy of which will be sent to you on request, and subject to the following conditions:

1. Drilling operations so authorized are subject to the attached sheet for general conditions of approval.
2. Furnish copies of all logs.

Very truly yours,

(Orig. Sgd.) P. T. McGrath

P. T. McGrath
District Engineer

PTMcGrath:as

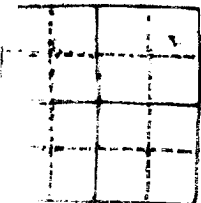

UNITED STATES
DEPARTMENT OF THE INTERIOR
GEOLOGICAL SURVEY



TO THE DIRECTOR, U.S. GEOLOGICAL SURVEY
WASHINGTON, D.C.

FROM THE CHIEF OF BUREAU OF LAND MANAGEMENT
DENVER, COLORADO

SUBJECT: [Illegible]

[The following text is extremely faint and largely illegible, appearing to be a memorandum or letter body.]

Very truly yours,
[Illegible Signature]

Chief of Bureau of Land Management



Santa Fe

Land Office

079161

Lease No.

NE/4 Sec. 4 is

Designated Drilling Unit

(SUBMIT IN TRIPLICATE)
**UNITED STATES
DEPARTMENT OF THE INTERIOR
GEOLOGICAL SURVEY**

SUNDRY NOTICES AND REPORTS ON WELLS

NOTICE OF INTENTION TO DRILL	<input checked="" type="checkbox"/>	SUBSEQUENT REPORT OF WATER SHUT-OFF	<input type="checkbox"/>
NOTICE OF INTENTION TO CHANGE PLANS	<input type="checkbox"/>	SUBSEQUENT REPORT OF SHOOTING OR ACIDIZING	<input type="checkbox"/>
NOTICE OF INTENTION TO TEST WATER SHUT-OFF	<input type="checkbox"/>	SUBSEQUENT REPORT OF ALTERING CASING	<input type="checkbox"/>
NOTICE OF INTENTION TO RE-DRILL OR REPAIR WELL	<input type="checkbox"/>	SUBSEQUENT REPORT OF REDRILLING OR REPAIR	<input type="checkbox"/>
NOTICE OF INTENTION TO SHOOT OR ACIDIZE	<input type="checkbox"/>	SUBSEQUENT REPORT OF ABANDONMENT	<input type="checkbox"/>
NOTICE OF INTENTION TO PULL OR ALTER CASING	<input type="checkbox"/>	SUPPLEMENTARY WELL HISTORY	<input type="checkbox"/>
NOTICE OF INTENTION TO ABANDON WELL	<input type="checkbox"/>		<input type="checkbox"/>

(INDICATE ABOVE BY CHECK MARK NATURE OF REPORT, NOTICE, OR OTHER DATA)

June 26, 19**55**

Well No. **8** is located **1190** ft. from **[N]** line and **990** ft. from **[E]** line of sec. **4**

NE/4 NE/4 Sec. 4
(1/4 Sec. and Sec. No.)

26N
(Twp.)

7W
(Range)

N.M.P.M.
(Meridian)

South Blanco P.C.
(Field)

Rio Arriba
(County or Subdivision)

New Mexico
(State or Territory)

The elevation of the derrick floor above sea level is _____ ft. (Not available. Will furnish later)

DETAILS OF WORK

(State names of and expected depths to objective sands; show sizes, weights, and lengths of proposed casings; indicate mudding jobs, cementing points, and all other important proposed work)

Pictured Cliffs Sand test. Estimated total depth 2300'.

Surface Casing: 90' of 8-5/8" OD 24# J-55 casing cemented with 80 sacks.

Production " : Approximately 2200' of 5-1/2" OD 14# J-55 casing cemented with 100 sacks.

If commercial production is indicated, the producing section will be shot with nitroglycerin and/or sand-oil treated.

I understand that this plan of work must receive approval in writing by the Geological Survey before operations may be commenced.

Company **CANDADO PRODUCTION COMPANY**

Address **1400 Luhrs Tower**

Phoenix, Arizona

By

Title **President**

RECEIVED
FEDERAL BUREAU OF INVESTIGATION
U.S. DEPARTMENT OF JUSTICE
WASHINGTON, D.C. 20535

MEMORANDUM FOR THE DIRECTOR

TO : DIRECTOR, FBI
FROM : SAC, NEW YORK
SUBJECT: [Illegible]

RE: [Illegible]

1. [Illegible]

2. [Illegible]

3. [Illegible]

4. [Illegible]

5. [Illegible]

6. [Illegible]

7. [Illegible]

Company **Candado Production Company**
~~Hess-Candado Drilling Co.~~
Lease **Candado** Well No. **12 8**

Sec. 4 T. 26 N. R. 7 W. N.M.P.M.

Location **1190 feet from north line; 990 feet from east line.**

Elevation: _____

Rio Arriba County

New Mexico

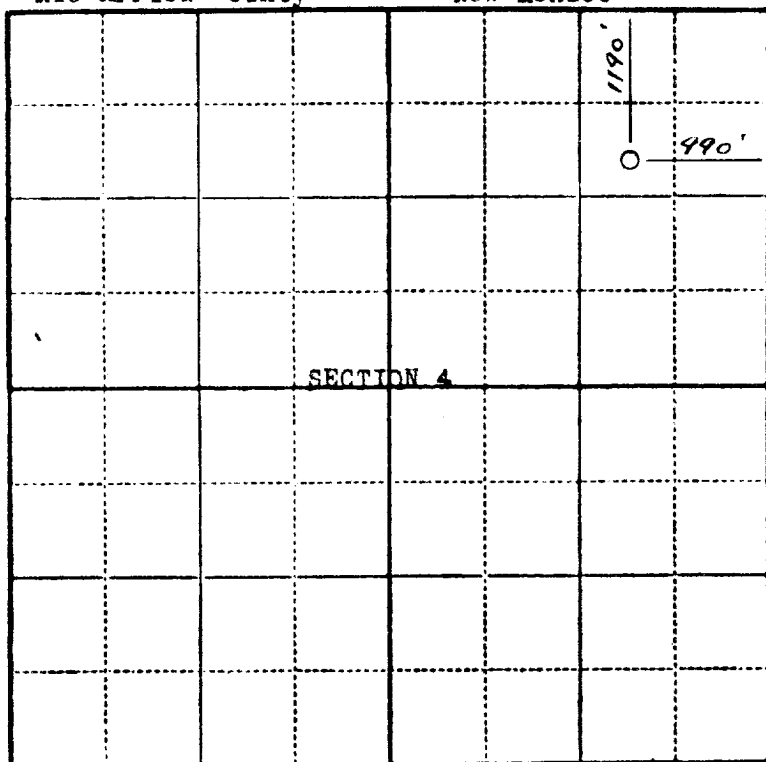

Scale—4 inches equal 1 mile.

This is to certify that the above plat was prepared from field notes of actual surveys made by me or under my supervision and that the same are true and correct to the best of my knowledge and belief.

Stephen H. Kinney

STEPHEN H. KINNEY
Registered Professional
Engineer and Land Surveyor

Surveyed **June 25**, 19 **55**

Seal.

RECEIVED
JUN 25 1955
U.S. GEOLOGICAL SURVEY
FARMINGTON, NEW MEXICO