

Form 9-331b
(April 1962)

(SUBMIT IN TRIPLICATE)

Indian Agency _____

Jicarilla Apache 102

UNITED STATES
DEPARTMENT OF THE INTERIOR
GEOLOGICAL SURVEY

Allottee _____

Lease No. _____

SUNDRY NOTICES AND REPORTS ON WELLS

NOTICE OF INTENTION TO DRILL _____	<input checked="" type="checkbox"/>	SUBSEQUENT REPORT OF WATER SHUT-OFF _____	RECEIVED JUL 10 1963 U. S. GEOLOGICAL SURVEY FARMINGTON, NEW MEXICO
NOTICE OF INTENTION TO CHANGE PLANS _____		SUBSEQUENT REPORT OF SHOOTING OR ACIDIZING _____	
NOTICE OF INTENTION TO TEST WATER SHUT-OFF _____		SUBSEQUENT REPORT OF ALTERING CASING _____	
NOTICE OF INTENTION TO REDRILL OR REPAIR WELL _____		SUBSEQUENT REPORT OF REDRILLING OR REPAIR _____	
NOTICE OF INTENTION TO SHOOT OR ACIDIZE _____		SUBSEQUENT REPORT OF ABANDONMENT _____	
NOTICE OF INTENTION TO PULL OR ALTER CASING _____		SUPPLEMENTARY WELL HISTORY _____	
NOTICE OF INTENTION TO ABANDON WELL _____			

(INDICATE ABOVE BY CHECK MARK NATURE OF REPORT, NOTICE, OR OTHER DATA)

Jicarilla Apache 102

Farmington, New Mexico July 8, 1963

Well No. **10** is located **890** ft. from **N** line and **1030** ft. from **W** line of sec. **4**

NW 1/4, NW 1/4, Section 4 T-36N R-4W NNPM
(1/4 Sec. and Sec. No.) (Twp.) (Range) (Meridian)

Basin Dakota Rio Arriba New Mexico
(Field) (County or Subdivision) (State or Territory)

The elevation of the derrick floor above sea level is _____ ft. (To be reported later) **1963**

DETAILS OF WORK

(State names of and expected depths to objective sands; show sizes, weights, and lengths of proposed casings; indicate mudlogging jobs, cementing points, and all other important proposed work)

We propose to drill the above well to a total depth of **8900'** and test the **Dakota** formation. Stimulation and completion will be selected at total depth. The following casing program is proposed:

SIZE	DEPTH	CEMENT	REMARKS
10-3/4"	200'	140 sz.	Quixtstrength - Circulate to surface.
7-5/8"	4250'	140 sz.	Quixtstrength - Heat
4-1/2"	8900'	500 sz.	400 sz. Quixtstrength with 1/2 Gal, 1-1/2" Tuf Plug per sack followed by 100 sz. Quixtstrength as tail in.

Copies of location plat are attached. Copies of any logs run will be furnished upon completion of well.

I understand that this plan of work must receive approval in writing by the Geological Survey before operations may be commenced.

Company **AN AMER. AN PETROLEUM CORPORATION**

Address **P. O. Box 430**

Farmington, New Mexico

Attn: L. O. Spear, Jr.

Verbal permission 7/8/63
Ward to Hollingsworth.

ORIGINAL SIGNED BY
F. H. HOLLINGSWORTH

By _____

Title **Petroleum Engineer**

NEW MEXICO OIL CONSERVATION COMMISSION
Well Location and Acreage Dedication Plat

SECTION A.

Date **July 8, 1963**

Operator **Pan American Petroleum Corporation** Lease **Jicarilla Apache 102**
Well No. **10** Unit Letter **D** Section **4** Township **26 North** Range **4 West** NMPM
Located **890** Feet From **North** Line **1030** Feet From **West** Line
County **Rio Arriba** G. L. Elevation **Report Later** Dedicated Acreage **322.88** Acres
Name of Producing Formation **Dakota** Pool **Basin Dakota**

1. Is the Operator the only owner* in the dedicated acreage outlined on the plat below? Yes **X** No
2. If the answer to question One is "No," have the interests of all the owners been consolidated by communitization agreement or otherwise? Yes No If answer is "Yes," Type of Consolidation
3. If the answer to question Two is "No," list all the owners and their respective interests below

OWNER

LAND DESCRIPTION

RECEIVED

JUL 10 1963

SECTION B.

Carson Nat. Forest

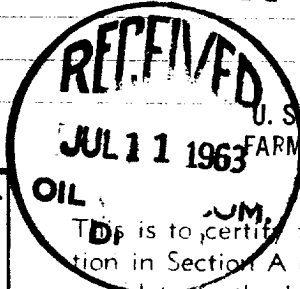
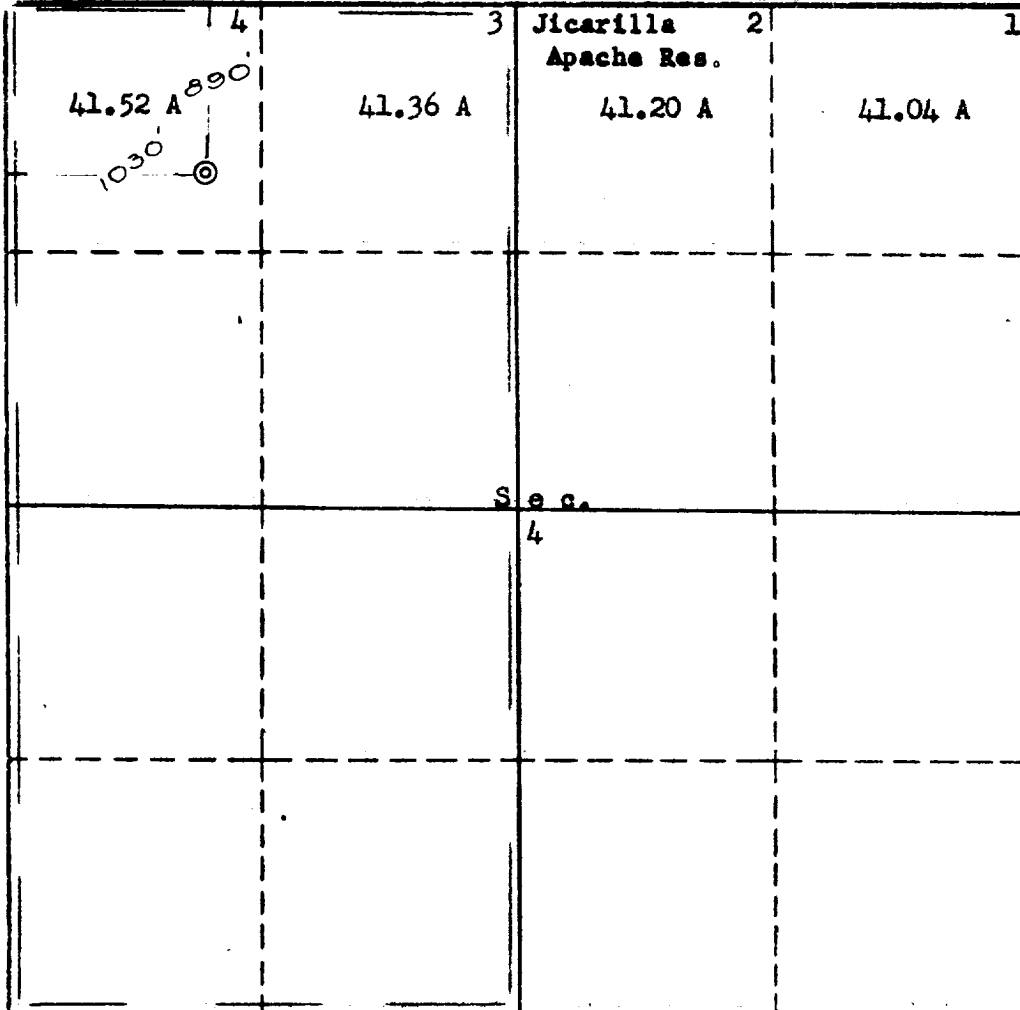

This is to certify that the information in Section A above is true and complete to the best of my knowledge and belief.

Pan American Petroleum Corp.

(OPERATOR)

F. H. Hollingsworth

F. H. Hollingsworth

Petr. (REPRESENTATIVE) Engr.

P. O. Box 480

Farmington, New Mexico

(WITNESS)

This is to certify that the well location shown on the plat in Section B was plotted from field notes of actual survey No. 3602 by me or under my supervision and that the same is true and correct to the best of my knowledge and belief.

Date Surveyed **July 6, 1963**

Four States Engineering Co.

FARMINGTON, NEW MEXICO

Emmett V. Cochran
REGISTERED ENGINEER OR LAND SURVEYOR

Certificate No. **3602**

