

UNITED STATES
DEPARTMENT OF THE INTERIOR
GEOLOGICAL SURVEY

SUBMIT IN TRIPPLICATE*
(Other instructions on
reverse side)

Form approved.
Budget Bureau No. 42-R1425.

30-647-20002

5. LEASE DESIGNATION AND SERIAL NO.
Tract 251; Contract 000154

6. IF INDIAN, ALLOTTED OR TRIBE NAME
Jicarilla Apache

7. UNIT AGREEMENT NAME
Jicarilla Apache

8. FARM OR LEASE NAME
Jicarilla Apache

9. WELL NO.
12

10. FIELD AND POOL, OR WILDCAT
Jicarilla-Basin Dakota

11. SEC., T., R., M., OR BLK.
AND SURVEY OR AREA
Section 33, T.26N., R.5W.

12. COUNTY OR PARISH
Rio Arriba

13. STATE
New Mexico

1. TYPE OF WORK
DRILL ☒ DEEPEN ☐ PLUG BACK ☐

b. TYPE OF WELL
OIL WELL ☐ GAS WELL ☒ OTHER ☐
SINGLE ZONE ☒ MULTIPLE ZONE ☐

2. NAME OF OPERATOR
Marathon Oil Company

3. ADDRESS OF OPERATOR
P. O. Box #97, McFadden, Wyoming 82080

4. LOCATION OF WELL (Report location clearly and in accordance with any State requirements.)*
At surface
800' FNL, 800' FEL, (SW NE NE) Section 33, T.26N., R.5W.,
At proposed prod. zone Rio Arriba County, New Mexico

14. DISTANCE IN MILES AND DIRECTION FROM NEAREST TOWN OR POST OFFICE*

15. DISTANCE FROM PROPOSED*
LOCATION TO NEAREST
PROPERTY OR LEASE LINE, FT.
(A so to nearest drlg. unit line, if any)
16. NO. OF ACRES IN LEASE
2,560 Acres
17. NO. OF ACRES ASSIGNED
TO THIS WELL
320 Acres
18. DISTANCE FROM PROPOSED LOCATION*
TO NEAREST WELL, DRILLING, COMPLETED,
OR APPLIED FOR, ON THIS LEASE, FT.
19. PROPOSED DEPTH
7500'

21. ELEVATIONS (Show whether DF, RT, GR, etc.)
5554' KB; 6541' G.L.

22. APPROX. DATE WORK WILL START*
January 30, 1967

23. PROPOSED CASING AND CEMENTING PROGRAM

SIZE OF HOLE	SIZE OF CASING	WEIGHT PER FOOT	SETTING DEPTH	QUANTITY OF CEMENT
15"	10-3/4"	32.75#	400'	400 sacks
9-5/8"	7-5/8"	24#	3,000'	1300 cubic feet
6-3/4"	4 1/2"	11.60#	7500'	1000 cubic feet

Marathon Oil Company requests permission to drill a development well to the Basin Dakota Sand at the above location. A string of 10-3/4" O.D., 32.75#, H-40 surface casing will be set in a 15" hole at approximately 400' and cemented to the surface. An intermediate string of 7-5/8" O.D., 24#, H-40 casing will be set at approximately 3000' in a 9-5/8" hole and cemented to the surface. A string of 4 1/2" O.D., 11.6#, J-55 casing will be landed from surface to total depth and cemented in two stages with 1,000 cubic feet of cement. The 9-5/8" hole will be drilled with mud and the 6-3/4" hole drilled with natural gas. Our logging program will consist of a Formation-Gamma Ray-Caliper log. Indicated productive intervals in the Basin Dakota Sand will be perforated two holes per foot with jets. Stimulation will consist of sand-water fracture treatment with approximately 3500 pounds of sand per foot of perforations. A Cameron Double Hydraulic blow-out preventer will be used below a rotating head.

IN ABOVE SPACE DESCRIBE PROPOSED PROGRAM: If proposal is to deepen or plug back, give data on present productive zone and proposed new productive zone. If proposal is to drill or deepen directionally, give pertinent data on subsurface locations and measured and true vertical depths. Give blowout preventer program, if any.

24. Lester Brown TITLE Area Superintendent DATE January 21, 1967
(This space for Federal or State office use)

PERMIT NO. _____ APPROVAL DATE _____
APPROVED BY LM TITLE _____
CONDITIONS OF APPROVAL, IF ANY:

*See Instructions On Reverse Side

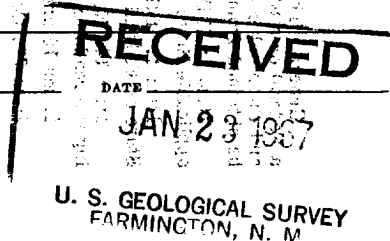

**NEW MEXICO OIL CONSERVATION COMMISSION
WELL LOCATION AND ACERAGE DEDICATION PLAT**

All distances must be from the outer boundaries of the Section

Operator MARATHON OIL COMPANY			Lease JICARILLA APACHE		Well No. 12
Unit Letter A	Section 33	Township 26 North	Range 5 West	County Rio Arriba	
Actual Footage Location of Well: 800 feet from the North line and 800 feet from the East line					
Ground Level Elev. 6541	Producing Formation Dakota		Pool Basin - Dakota		Dedicated Acreage: 320 Acres

1. Outline the acreage dedicated to the subject well by colored pencil or hatchure marks on the plat below.
2. If more than one lease is dedicated to the well, outline each and identify the ownership thereof (both as to working interest and royalty),
3. If more than one lease of different ownership is dedicated to the well, have the interests of all owners been consolidated by communitization, unitization, force-pooling, etc?

() Yes (**X**) No If answer is "yes," type of consolidation

If answer is "no," list the owners and tract descriptions which have actually consolidated. (Use reverse side of this form if necessary) **Marathon Oil Company - Tract 251**

No allowable will be assigned to the well until all interests have been consolidated by communitization, unitization, forced-pooling, or otherwise) or until a non standard unit, eliminating such interests, has been approved by the Commission.

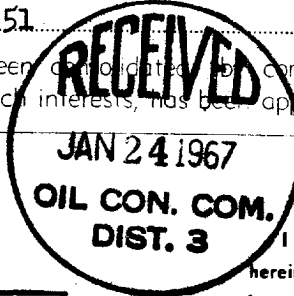

CERTIFICATION

I hereby certify that the information contained herein is true and complete to the best of my knowledge and belief.

Name
Area Superintendent
Position
Marathon Oil Company
Company
January 21, 1967
Date

I hereby certify that the well location shown on this plat was plotted from field notes of actual surveys made by me or under my supervision, and that the same is true and correct to the best of my knowledge and belief.

Date Surveyed
December 15, 1966
Registered Professional Engineer
and/or Land Surveyor

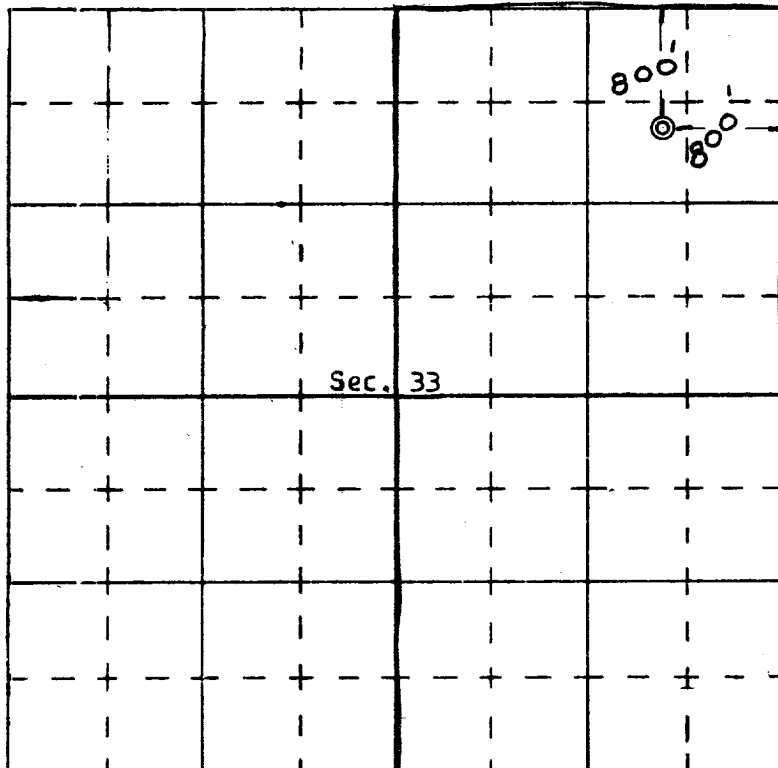

Certificate No. **3602**