

RECEIVED
UNITED STATES
DEPARTMENT OF THE INTERIOR
GEOLOGICAL SURVEY
JUN 5 1968
OIL & GAS
DIST. 3

APPLICATION FOR PERMIT TO DRILL, DEEPEN, OR PLUG BACK

1a. TYPE OF WORK

DRILL ☒DEEPEN ☐PLUG BACK ☐

b. TYPE OF WELL

OIL
WELL ☐GAS
WELL ☒OTHER ☐SINGLE
ZONE ☐MULTIPLE
ZONE ☒

2. NAME OF OPERATOR

SOUTHERN UNION PRODUCTION COMPANY

3. ADDRESS OF OPERATOR

P. O. Box 808, FARMINGTON, NEW MEXICO 87401

4. LOCATION OF WELL (Report location clearly and in accordance with any State requirements.)*

At surface

1450 FT. FROM SOUTH LINE & 1450 FT. FROM EAST LINE

At proposed prod. zone

SAME AS ABOVE

14. DISTANCE IN MILES AND DIRECTION FROM NEAREST TOWN OR POST OFFICE*

30 MILES NORTHWEST OF QUITO, NEW MEXICO

15. DISTANCE FROM PROPOSED*

LOCATION TO NEAREST

PROPERTY OR LEASE LINE, FT.

(Also to nearest drlg. unit line, if any)

1450 FT.

16. NO. OF ACRES IN LEASE

2560

17. NO. OF ACRES ASSIGNED
TO THIS WELL

320 DAKOTA; 160 PICTURED CLIFFS

18. DISTANCE FROM PROPOSED LOCATION*

TO NEAREST WELL, DRILLING, COMPLETED,
OR APPLIED FOR, ON THIS LEASE, FT.

1980 FT.

19. PROPOSED DEPTH

7600 FT.

20. ROTARY OR CABLE TOOLS

ROTARY

21. ELEVATIONS (Show whether DF, RT, GR, etc.)

6630 FT. UNGRADED GROUND LEVEL

22. APPROX. DATE WORK WILL START*

JUNE 12, 1968

23.

PROPOSED CASING AND CEMENTING PROGRAM

SIZE OF HOLE	SIZE OF CASING	WEIGHT PER FOOT	SETTING DEPTH	QUANTITY OF CEMENT
12-1/4"	8-5/8"	24.0#	300 FT.	250 SACKS
7-7/8"	5-1/2"	15.50#	7600 FT.	2000 CU.FT. (3 STAGE)

WE PROPOSE TO DRILL A WELL TO BE DUALY COMPLETED IN THE DAKOTA AND PICTURED CLIFFS FORMATION. ANTICIPATED TOTAL DEPTH 7600 FT.

- CASING PROGRAM: SURFACE - 300 FT. 8-5/8", 24.0#, J-55 CEMENTED W/250 SACKS.
PRODUCTION- 5-1/2", 15.50#, J-55 SET AT T.D. 7600 FT. 1ST STAGE CEMENTED WITH 400 CU.FT. CEMENT; STAGE COLLAR SET UNDER MESABERDE AT APPROXIMATELY 5450 FT. AND CEMENTED WITH 500 CU.FT. CEMENT; STAGE COLLAR SET UNDER PICTURED CLIFFS AT APPROXIMATELY 3240 FT. AND CEMENTED WITH 1100 CU.FT.
- ROTARY TOOLS WILL BE USED TO MUD DRILL WELL FROM SURFACE TO TOTAL DEPTH.
- DAKOTA & PICTURED CLIFFS ZONES WILL BE SAND FRACED TO STIMULATE PRODUCTION.
- 1-1/2" E.U.E., 2.90#, JCH TBG. WILL BE RUN TO DAKOTA & LANDED AT APPROX. 7450 FT.
- 1-1/2", 2.75#, INTEGRAL JOINT TBG. WILL BE RUN TO PICTURED CLIFFS & LANDED AT APPROX. 3100 FT. R.K.B.
- BAKER MODEL "D" 5-1/2" PRODUCTION PACKER WILL BE SET AT APPROXIMATELY 7150 FT. R.K.B.

RECEIVED

JUN 5 1968

IN ABOVE SPACE DESCRIBE PROPOSED PROGRAM: If proposal is to deepen or plug back, give data on present productive zone and proposed new productive zone. If proposal is to drill or deepen directionally, give pertinent data on subsurface locations and measured and true vertical depths. Give blowout preventer program, if any.

Original signed by
24. GILBERT D. NOLAND, JR.

SIGNED GILBERT D. NOLAND, JR.

TITLE

DRILLING SUPERINTENDENT

JUNE 6 1968
U. S. GEOLOGICAL SURVEY
FARMINGTON, N. M.

(This space for Federal or State office use)

PERMIT NO. _____

APPROVAL DATE _____

APPROVED BY _____

TITLE _____

DATE _____

CONDITIONS OF APPROVAL, IF ANY:

Instructions

General: This form is designed for submitting proposals to perform certain well operations, as indicated, on all types of lands and leases for appropriate action by either a Federal or a State agency, or both, pursuant to applicable Federal and/or State laws and regulations. Any necessary special instructions concerning the use of this form and the number of copies to be submitted, particularly with regard to local, area, or regional procedures and practices, either are shown below or will be issued by, or may be obtained from, the local Federal and/or State office.

Item 1: If the proposal is to redrill to the same reservoir at a different subsurface location or to a new reservoir, use this form with appropriate notations. Consult applicable State or Federal regulations concerning subsequent work proposals or reports on the well.

Item 4: If there are no applicable State requirements, locations on Federal or Indian land should be described in accordance with Federal requirements. Consult local State or Federal office for specific instructions.

Item 14: Needed only when location of well cannot readily be found by road from the land or lease description. A plat, or plats, separate or on this reverse side, showing the roads to, and the surveyed location of, the well, and any other required information, should be furnished when required by Federal or State agency offices.

Items 15 and 18: If well is to be, or has been directionally drilled, give distances for subsurface location of hole in any present or objective production zone.

Item 22: Consult applicable Federal or State regulations, or appropriate officials, concerning approval of the proposal before operations are started.



**NEW MEXICO OIL CONSERVATION COMMISSION
WELL LOCATION AND ACERAGE DEDICATION PLAT**

All distances must be from the outer boundaries of the Section

Operator SOUTHERN UNION PRODUCTION COMPANY		Lease JICARILLA		J		Well No 11
Unit Letter J	Section 25	Township 26 NORTH	Range 5 WEST	County RIO ARriba		

Actual Footage Location of Well:
1450 feet from the **SOUTH** line and **1450** feet from the **EAST** line
 Ground Level Elev **6630.0** Producing Formation **PICTURED CLIFFS DAKOTA** Pool **SOUTH BLANCO PICTURED CLIFFS BASIN DAKOTA** Dedicated Acreage: **160 / 320** Acres

1. Outline the acreage dedicated to the subject well by colored pencil or hachure marks on the plat below.
2. If more than one lease is dedicated to the well, outline each and identify the ownership thereof (both as to working interest and royalty),
3. If more than one lease of different ownership is dedicated to the well, have the interests of all owners been consolidated by communitization, unitization, force-pooling, etc?

(X) Yes () No If answer is "yes," type of consolidation **OPERATING AGREEMENT**

If answer is "no," list the owners and tract descriptions which have actually consolidated. (Use reverse side of this form if necessary.)

No allowable will be assigned to the well until all interests have been consolidated (by communitization, unitization, forced-pooling, or otherwise) or until a non standard unit, eliminating all interests, has been approved by the Commission.

DEDICATED DAKOTA ACREAGE

DEDICATED PICTURED CLIFFS ACREAGE

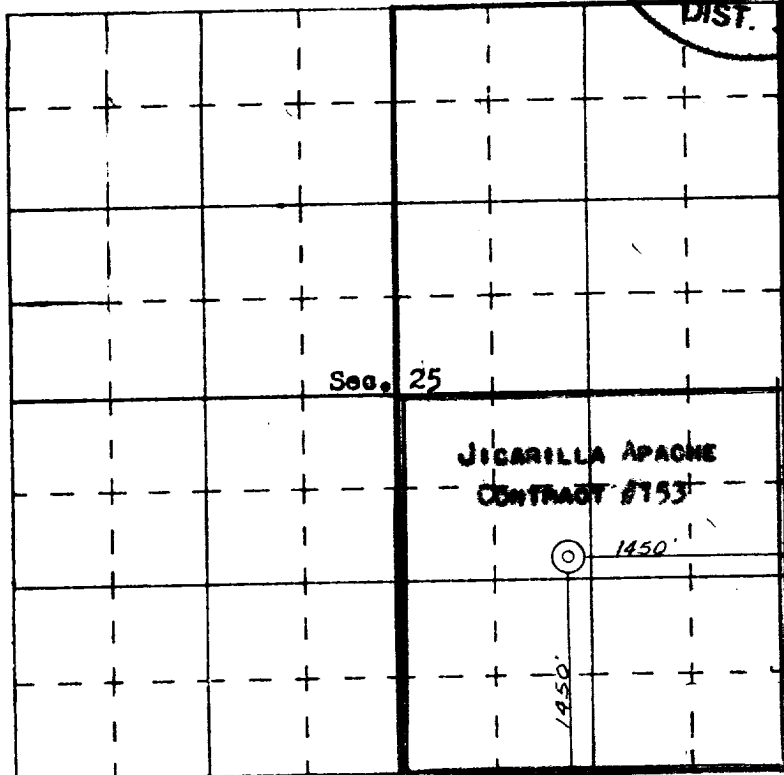

SCALE—4 INCHES EQUALS 1 MILE

CERTIFICATION

I hereby certify that the information contained herein is true and complete to the best of my knowledge and belief.

Original signed by
GILBERT D. NOLAND, JR.

Name
GILBERT D. NOLAND, JR.

Position
DRILLING SUPERINTENDENT

Company
SOUTHERN UNION PRODUCTION CO.

Date
JUNE 4, 1968

I hereby certify that the well location shown on this plat was plotted from field notes of actual surveys made by me or under my supervision, and that the same is true and correct to the best of my knowledge and belief.

31, May, 1968

Date Surveyed

Registered Professional Engineer
and/or Land Surveyor

JAMES P. LEESE

1463

Certificate No.