

Denny E. Foust  
DEPUTY OIL & GAS INSPECTOR

JICARILLA APACHE TRIBE  
ENVIRONMENTAL PROTECTION OFFICE  
P.O. BOX 507  
DULCE, NEW MEXICO 87528

FEB 28 1997

SUBMIT COPY TO  
NATURAL RESOURCE DEPT

RECEIVED  
OCT 31 1999  
OIL & GAS ADMINISTRATION

Approved  
**PIT REMEDIATION AND CLOSURE REPORT**

OIL CON. DIV.  
DULCE

Operator: PNM Gas Service Telephone: 324-3763  
Address: 603 W Elm Farmington, N. Mex. 87401  
Facility or Well Name: Jicarilla J-11 (Meridian)  
Location: Unit or Qtr/Qtr Sec. 1 Sec. 25 T. 26N R. 5W County Rio Arriba  
Pit Type: Separator ☒ Dehydrator ☒ Other \_\_\_\_\_  
Land Type: Jicarilla Apache

Pit Location: Pit dimensions: length 30' width 28' depth 22' 684  
(Attach diagram) 15' 7' 22' 86  
Reference: wellhead ☒ other \_\_\_\_\_  
Footage from reference: 90'  
Direction from reference: 80 Degrees \_\_\_\_\_ East North of West  
\_\_\_\_\_ of \_\_\_\_\_  
\_\_\_\_\_ West South \_\_\_\_\_

**Depth To Groundwater:**

(Vertical distance from  
contaminants to seasonal  
high water elevation of  
groundwater)

Less than 50 feet (20 points)  
50 feet to 99 feet (10 points) 0  
Greater than 100 feet (0 points)

**Distance to an Ephemeral Stream**

(Downgradient dry wash greater than  
ten feet in width)

Less than 100 feet (10 points)  
Greater than 100 feet (0 points) 0

**Distance to Nearest Lake, Playa, or Watering Pond**

(Downgradient lakes, playas and  
livestock or wildlife watering ponds)

Less than 100 feet (10 points)  
Greater than 100 feet (0 points) 0

**Wellhead Protection Area:**

(Less than 200 feet from a private  
domestic water source, or: less than  
1000 feet from all other water sources)

Yes (20 points)  
No (0 points) 0

**Distance To Surface Water:**

(Horizontal distance to perennial  
lakes, ponds, rivers, streams, creeks,  
irrigation canals and ditches)

Less than 100 feet (20 points)  
100 feet to 1000 feet (10 points) 0  
Greater than 1000 feet (0 points)

**RANKING SCORE (TOTAL POINTS):** 0

Date Remediation Started: 7/23/96

Date Completed: 9/5/96

Remediation Method: Excavation X

Approx. cubic yards 770

(Check all appropriate sections)

Landfarmed X

Other \_\_\_\_\_

Remediation Location: Onsite X Offsite \_\_\_\_\_

(i.e. landfarmed onsite,

name and location of

offsite facility) \_\_\_\_\_

General Description of Remedial Action: Removed contaminated soil from all 4 walls and pit bottom as to get a below 100 ppm head space readings.

Groundwater Encountered: No X Yes \_\_\_\_\_ Depth \_\_\_\_\_

Final Pit:

Sample location North, East, South, West side

Closure Sampling:

(if multiple samples,

attach sample results

and diagram of sample

locations and depths)

Sample depth 22'

Sample date 7/24/96

Sample time 1140

Sample Results

Soil: Benzene (ppm) \_\_\_\_\_

Water: Benzene (ppb) \_\_\_\_\_

Total BTEX (ppm) \_\_\_\_\_

Toluene (ppb) \_\_\_\_\_

Field Headspace (ppm) 31.8

Ethylbenzene (ppb) \_\_\_\_\_

TPH 8015 (ppm) 55.0

Total Xylenes (ppb) \_\_\_\_\_

Groundwater Sample: Yes \_\_\_\_\_ No X (If yes, attach sample results)

I HEREBY CERTIFY THAT THE INFORMATION ABOVE IS TRUE AND COMPLETE TO THE BEST OF MY KNOWLEDGE AND BELIEF

DATE

7/24/96

PRINTED NAME

Ronald A Dedrick

SIGNATURE

Ronald A Dedrick

AND TITLE

E.T.

AFTER REVIEW OF THE PIT CLOSURE INFORMATION, PIT CLOSURE IS APPROVED IN ACCORDANCE TO THE JICARILLA APACHE TRIBE PIT CLOSURE ORDINANCE.

APPROVED: YES ✓ NO \_\_\_\_\_ (REASON) \_\_\_\_\_

SIGNED:

Robert J. [Signature]

DATE:

7/31/96

OFF: (505) 325-5667



LAB: (505) 325-1556

### *Diesel Range Organics*

Attn: *Denver Bearden*  
Company: *PNM Gas Services*  
Address: *603 W. Elm*  
City, State: *Farmington, NM 87401*

Date: *29-Jul-96*  
COC No.: *4805*  
Sample No. *11611*  
Job No. *2-1000*

Project Name: *PNM Gas Services - Jicarilla J-11 Run 12-01*  
Project Location: *9607241140; 5pt. Composite*  
Sampled by: *EP* Date: *24-Jul-96* Time: *11:40*  
Analyzed by: *DC* Date: *26-Jul-96*  
Sample Matrix: *Soil*

### *Laboratory Analysis*

<i>Parameter</i>	<i>Result</i>	<i>Unit of Measure</i>	<i>Detection Limit</i>	<i>Unit of Measure</i>
<i>Diesel Range Organics (C10 - C28)</i>	<i>&lt;5.0</i>	<i>mg/kg</i>	<i>5.0</i>	<i>mg/kg</i>

### *Quality Assurance Report*

DRO QC No.: *0479-QC*

#### *Calibration Check*

<i>Parameter</i>	<i>Method Blank</i>	<i>Unit of Measure</i>	<i>True Value</i>	<i>Analyzed Value</i>	<i>% Diff</i>	<i>Limit</i>
<i>Diesel Range (C10 - C28)</i>	<i>&lt;5.0</i>	<i>ppm</i>	<i>2,000</i>	<i>1,977</i>	<i>1.1</i>	<i>15%</i>

#### *Matrix Spike*

<i>Parameter</i>	<i>1- Percent Recovered</i>	<i>2 - Percent Recovered</i>	<i>Limit</i>	<i>%RSD</i>	<i>Limit</i>
<i>Diesel Range (C10-C28)</i>	<i>109</i>	<i>99</i>	<i>(70-130)</i>	<i>7</i>	<i>20%</i>

**Method** - *SW-846 EPA Method 8015A mod. - Nonhalogenated Volatile Hydrocarbons by Gas Chromatography*

Approved by: *[Signature]*  
Date: *7/29/96*

JICANILLA J-11  
Sec. 25 T26N R5W  
Meridian

meter Houses



DH

SEP

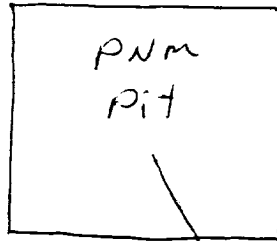

90'

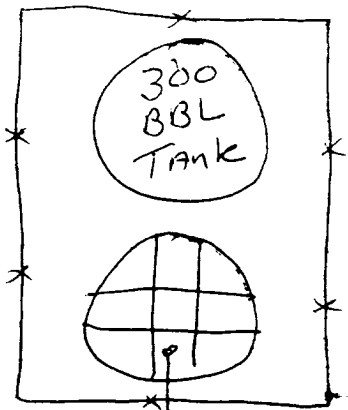

SEP

**JICARILLA APACHE TRIBE  
ENVIRONMENTAL PROTECTION OFFICE  
P.O. BOX 507  
DULCE, NEW MEXICO 87528**

SUBMIT 1 COPY TO  
NATURAL RESOURCE DEPT  
AND OIL & GAS ADMINISTRATION

**ON-SITE SOIL REMEDIATION REPORT**

Operator: PNM Gas Services Telephone: 324-3763  
Address: 603 W Elm Farmington, N Mex. 87401  
Facility or Well Name: Jicarilla J-11 (Meridian)  
Location: Unit or Qtr/Qtr Sec \_\_\_\_\_ Sec 25 T26N R5W County Rio Arriba  
Land Type: Jicarilla Apache

Date Remediation Started: 7/23/96 Date Completed: 8/20/96  
Remediation Method: Landfarmed X Approx. cubic yards 770  
Composted \_\_\_\_\_  
Other \_\_\_\_\_

Depth To Groundwater: (pts.) 0  
Distance to an Ephemeral Stream (pts.) 0  
Distance to Nearest Lake, Playa, or Watering Pond (pts.) 0  
Wellhead Protection Area: (pts.) 0  
Distance To Surface Water: (pts.) 0  
RANKING SCORE (TOTAL POINTS): 0

**Final Closure Sampling:**

Sampling Date: 8/20/96 Time: 1813  
Sample Results:  
Field Headspace (ppm) 51.5  
TPH (ppm) 47.8 Method 8015  
Other \_\_\_\_\_

I HEREBY CERTIFY THAT THE INFORMATION ABOVE IS TRUE AND COMPLETE TO THE BEST OF MY KNOWLEDGE AND BELIEF

DATE 8/25/96 PRINTED NAME Ronald A Dedrick  
SIGNATURE Ronald A Dedrick AND TITLE E.T.

AFTER REVIEW OF THE SOIL REMEDIATION INFORMATION, ON-SITE REMEDIATION IS APPROVED IN ACCORDANCE TO THE JICARILLA APACHE TRIBE PIT CLOSURE ORDINANCE.

APPROVED: YES X NO \_\_\_\_\_ (REASON) \_\_\_\_\_

SIGNED: Kenn C. Merrill DATE: 8-26-96

Jicarilla J-11  
Sec. 25-T26N R5W  
Meridian

Land Farm

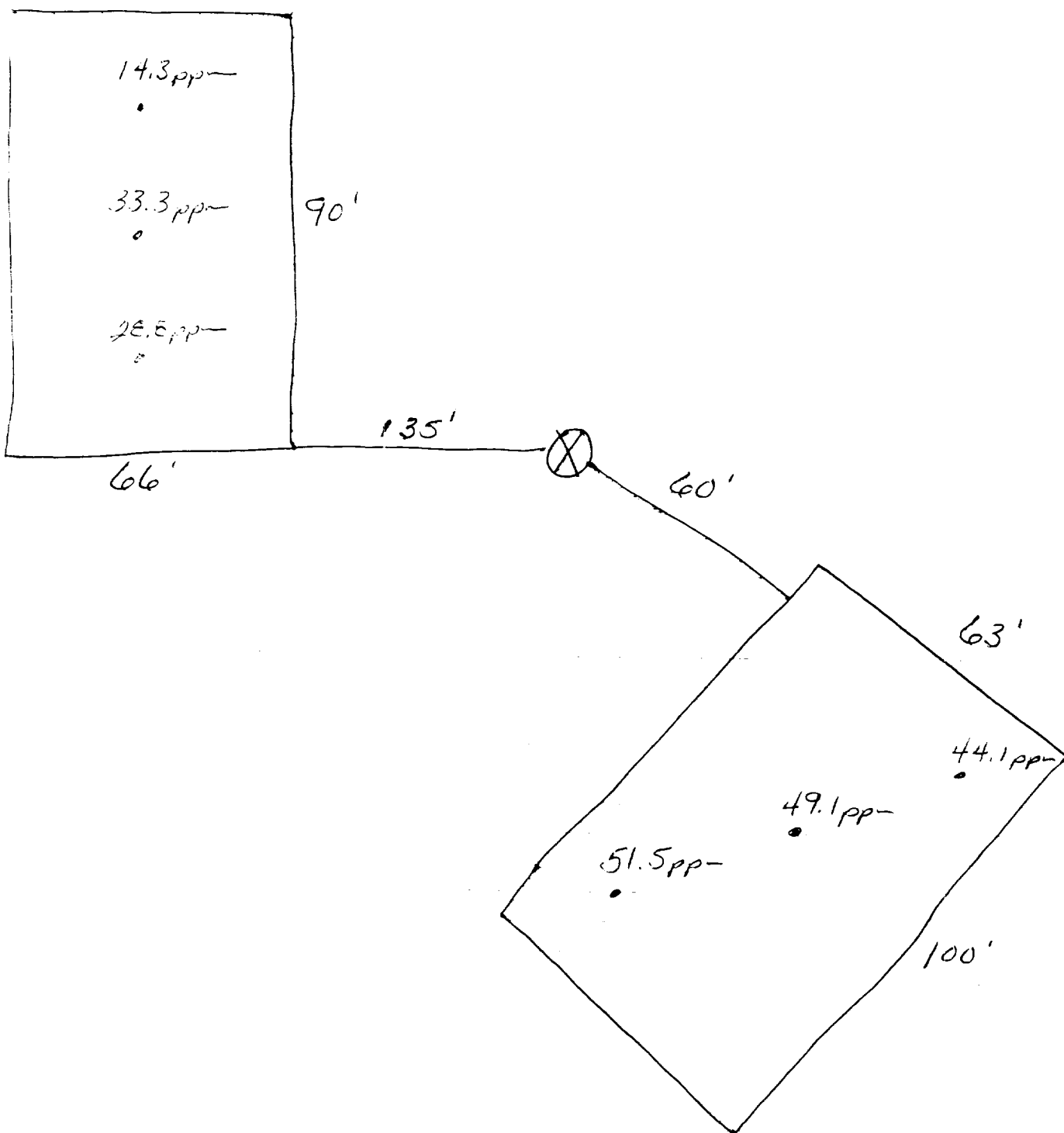

OFF: (505) 325-5667



LAB: (505) 325-1556

### *Diesel Range Organics*

Attn: *Denver Bearden*  
Company: *PNM Gas Services*  
Address: *603 W. Elm*  
City, State: *Farmington, NM 87401*

Date: *23-Aug-96*  
COC No.: *4856*  
Sample No. *11866*  
Job No. *2-1000*

Project Name: *PNM Gas Services - Jicarilla J-11 Landfarm Run 12-01*  
Project Location: *9608201842; 5pt. Composite*  
Sampled by: *RD* Date: *20-Aug-96* Time: *18:42*  
Analyzed by: *DC/HR* Date: *23-Aug-96*  
Sample Matrix: *Soil*

### *Laboratory Analysis*

<i>Parameter</i>	<i>Result</i>	<i>Unit of Measure</i>	<i>Detection Limit</i>	<i>Unit of Measure</i>
<i>Diesel Range Organics (C10 - C28)</i>	<i>47.8</i>	<i>mg/kg</i>	<i>5.0</i>	<i>mg/kg</i>

### *Quality Assurance Report*

*DRO QC No.: 0489-QC*

#### *Calibration Check*

<i>Parameter</i>	<i>Method Blank</i>	<i>Unit of Measure</i>	<i>True Value</i>	<i>Analyzed Value</i>	<i>% Diff</i>	<i>Limit</i>
<i>Diesel Range (C10 - C28)</i>	<i>&lt;5.0</i>	<i>ppm</i>	<i>100</i>	<i>112</i>	<i>12.0</i>	<i>15%</i>

#### *Matrix Spike*

<i>Parameter</i>	<i>1- Percent Recovered</i>	<i>2 - Percent Recovered</i>	<i>Limit</i>	<i>%RSD</i>	<i>Limit</i>
<i>Diesel Range (C10-C28)</i>	<i>112</i>	<i>114</i>	<i>(70-130)</i>	<i>1</i>	<i>20%</i>

**Method** - SW-846 EPA Method 8015A mod. - Nonhalogenated Volatile Hydrocarbons by Gas Chromatography

Approved by: *[Signature]*  
Date: *8/23/96*

P.O. BOX 2606 • FARMINGTON, NM 87499

- TECHNOLOGY BLENDING INDUSTRY WITH THE ENVIRONMENT -