

DISTRICT I
 P.O. Box 1980, Hobbs, NM 88240-1980
 DISTRICT II
 811 South First St. Artesia NM 88210-2835
 DISTRICT III
 1000 Rio Brazos Rd. Aztec, NM 87410-1693

RECEIVED
FEB - 5 1998
OIL CON. DIV.
DISAPPLICATION FOR DOWNHOLE COMMINGLING

State of New Mexico
 Energy, Minerals and Natural Resources Department
OIL CONSERVATION DIVISION
 2040 S. Pacheco
 Santa Fe, New Mexico 87505-6429

Form C-107-A
 New 3-12-96

APPROVAL PROCESS:
 Administrative Hearing
 EXISTING WELLBORE
 YES NO

Operator: Conoco Inc. Address: 10 Desta Dr. Ste 100W, Midland, Tx. 79705-4500

Lease: Jicarilla A Well No: 11 Unit Ltr Sec Twp Rge: Section 14, T-26-N, R-4-W, J County: Rio Arriba

OGRID NO. 005073 Property Code 18018 API NO. 30-039-20122 Spacing Unit Lease Types (check 1 or more)
 Federal State (and/or) Fee

The following facts are submitted in support of downhole commingling:	Upper Zone	Intermediate Zone	Lower Zone
1. Pool Name and Pool Code	Blanco Mesaverde 72319	Wildhorse Gallup 87360	Basin Dakota 71599
2. TOP and Bottom of Pay Section (Perforations)	5954-6086'	7510-7526'	7982-8176'
3. Type of production (Oil or Gas)	Gas	Gas	Gas
4. Method of Production (Flowing or Artificial Lift)	To Flow	Flowing	Flowing
5. Bottomhole Pressure Oil Zones - Artificial Lift: Estimated Current Gas & Oil - Flowing: Measured Current All Gas Zones: Estimated Or Measured Original	a (Current) 583	a 327	a 619
	b(Original) 1411	b. 2132	b. 3152
6. Oil Gravity (°API) or Gas BT Content	1203	1315	1315
7. Producing or Shut-In?	To Be Completed	Producing	Producing
Production Marginal? (yes or no) • If Shut-In give date and oil/gas/water rates of last production Note For new zones with no production history applicant should be required to attach production estimates and supporting data • If Producing, date and oil/gas/water rates of recent test (within 60 days)	Yes	Yes	Yes
	Date Rates	Date Rates	Date Rates
	Date Rates Production Alloc. By Subtraction - See Attached Table	Date Rates Est 7/98 67 MCFD, 0.4 BOPD, 0 BOPD	Date Rates Est 7/98 98 MCFD, 1.9 BOPD, 0 BOPD
8. Fixed Percentage Allocation Formula - % for each zone	% Gas %	% Gas %	% Gas %

9. If allocation formula is based upon something other than current or past production, or is based upon some other method, submit attachments with supporting data and/or explaining method and providing rate projections or other required data.
10. Are all working, overriding, and royalty interests identical in all commingled zones? Yes No
 If not, have all working, overriding, and royalty interests been notified by certified mail? Yes No
 Have all offset operators been given written notice of the proposed downhole commingling? Yes No
11. Will cross-flow occur? Yes No If yes, are fluids compatible, will the formations not be damaged, will any cross-flowed production be recovered, and will the allocation formula be reliable. Yes No (If No, attach explanation)
12. Are all produced fluids from all commingled zones compatible with each others Yes No
13. Will the value of production be decreased by commingling? Yes No (If Yes, attach explanation)
14. If this well is on, or communitized with, state or federal lands, either the Commissioner of Public Lands or the United States Bureau of Land Management has been notified in writing of this application. Yes No
15. NMOCD Reference Cases for Rule 303(D) Exceptions: ORDER NO(S). _____

16. ATTACHMENTS
 * C-102 for each zone to be commingled showing its spacing unit and acreage dedication.
 * Production curve for each zone for at least one year. (If not available, attach explanation.)
 * For zones with no production history, estimated production rates and supporting data.
 * Data to support allocation method or formula.
 * Notification list of all offset operators.
 * Notification list of working, overriding and royalty interests for uncommon interest cases.
 * Any additional statements, data, or documents required to support commingling.

I hereby certify that the information above is true and complete to the best of my knowledge and belief.

SIGNATURE Kay Maddox TITLE Regulatory Agent DATE Feb 5 1998

TYPE OR PRINT NAME Kay Maddox TELEPHONE NO. (915) 686-5798

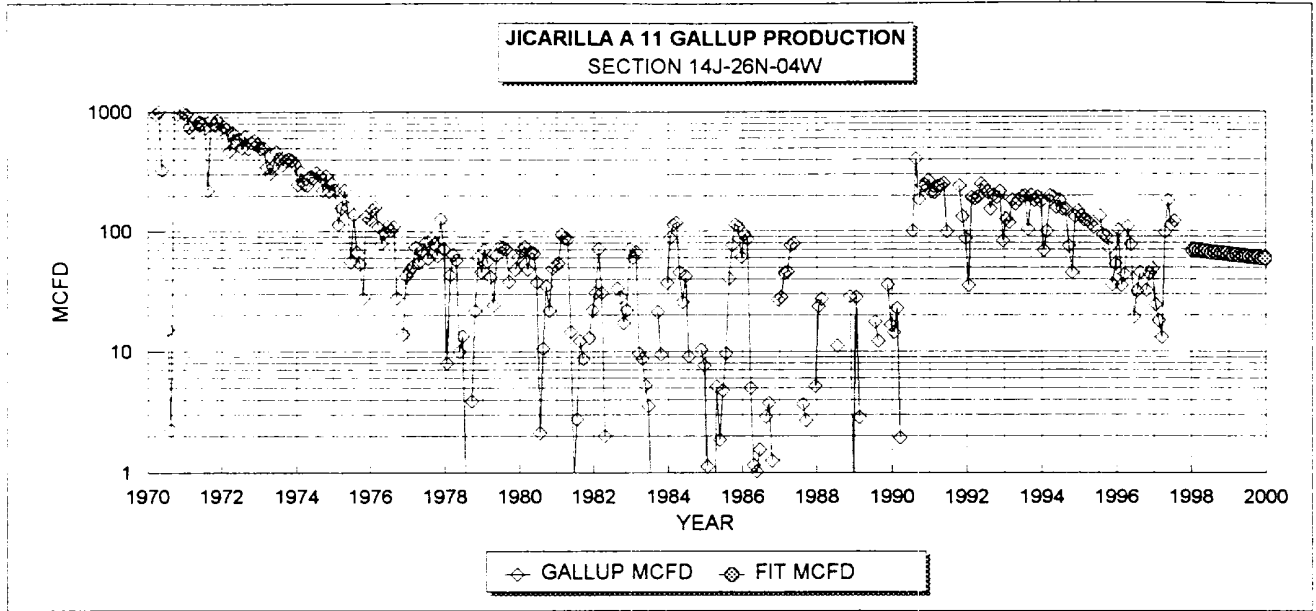

GALLUP HISTORICAL DATA:		1ST PROD: 12/68	PROJECTED DATA	
OIL CUM:	12.65 MBO		7/1/98 Qi:	67 MCFD
GAS CUM:	1833.0 MMCF		DECLINE RATE:	8.0% (EXPONENTIAL)
OIL YIELD:	0.0069 BBL/MCF			

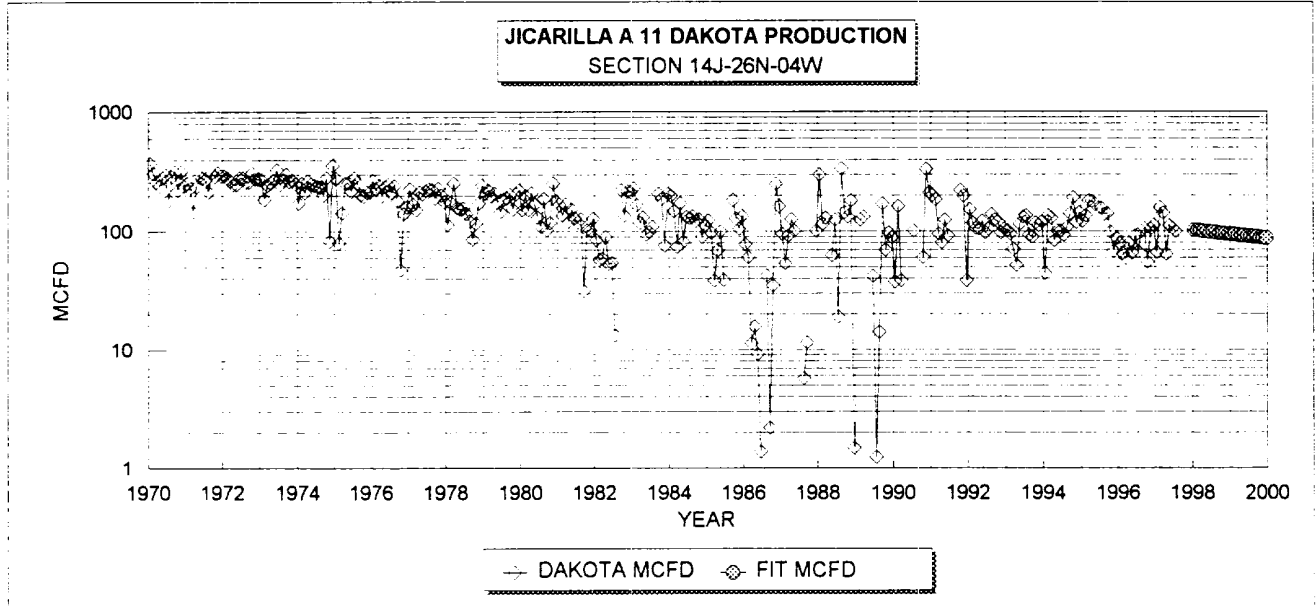

DAKOTA HISTORICAL DATA		1ST PROD: 12/68	DAKOTA PROJECTED DATA	
OIL CUM:	33.7 MBO		7/1/98 Qi:	98 MCFD
GAS CUM:	1658.0 MMCF		DECLINE RATE:	8.0% (EXPONENTIAL)
OIL YIELD:	0.0203 BBL/MCF			

FIXED COMMINGLE ALLOCATION FACTORS:		
	GAS	OIL
CHACRA	40%	19%
DAKOTA	60%	81%

GAS ALLOCATION BASED ON PROJECTED 1997 RATES
OIL ALLOCATION BASED ON WEIGHTED CUM OIL YIELDS
NOTE: ALL PRODUCTION DATA FROM DWIGHTS ENERGYDATA

JICARILLA A 11: GALLUP AND DAKOTA FORECAST FOR SUBTRACTION COMMINGLE WITH MESAVERDE
 14J-26N-04W

(6-12/97 AVG)

YEAR	GALLUP	DAKOTA	TOTAL	GALLUP	DAKOTA	TOTAL
	MCFD	MCFD	MCFD	OIL; BOPD	OIL; BOPD	OIL; BOPD
1998	65	95	160	0.4	1.9	2.4
1998	61	90	152	0.0	1.8	1.8
1999	56	83	140	0.0	1.7	1.7
2000	52	77	128	0.0	1.6	1.6
2001	48	70	118	0.0	1.4	1.4
2002	44	65	109	0.0	1.3	1.3
2003	40	60	100	0.0	1.2	1.2
2004	37	55	92	0.0	1.1	1.1
2005	34	50	85	0.0	1.0	1.0
2006	31	46	78	0.0	0.9	0.9
2007	29	43	72	0.0	0.9	0.9
2008	27	39	66	0.0	0.8	0.8
2009	25	36	61	0.0	0.7	0.7
2010	23	33	56	0.0	0.7	0.7
2011	21	31	51	0.0	0.6	0.6
2012	19	28	47	0.0	0.6	0.6
2013	18	26	43	0.0	0.5	0.5
2014	16	24	40	0.0	0.5	0.5
2015	15	22	37	0.0	0.4	0.4
2016	14	20	34	0.0	0.4	0.4
2017	13	19	31	0.0	0.4	0.4
2018	12	17	29	0.0	0.3	0.3
2019	11	16	26	0.0	0.3	0.3
2020	10	14	24	0.0	0.3	0.3
2021	9	13	22	0.0	0.3	0.3
2022	8	12	21	0.0	0.2	0.2
2023	8	11	19	0.0	0.2	0.2
2024	7	10	17	0.0	0.2	0.2
2025	6	10	16	0.0	0.2	0.2
2026	6	9	15	0.0	0.2	0.2
2027	5	8	14	0.0	0.2	0.2
2028	5	7	12	0.0	0.2	0.2
2029	5	7	11	0.0	0.1	0.1
2030	4	6	11	0.0	0.1	0.1

Dwights

11/14/97

Retrieval Code: 251.039.26N04W14J00DK

Lease: JICARILLA A (11)

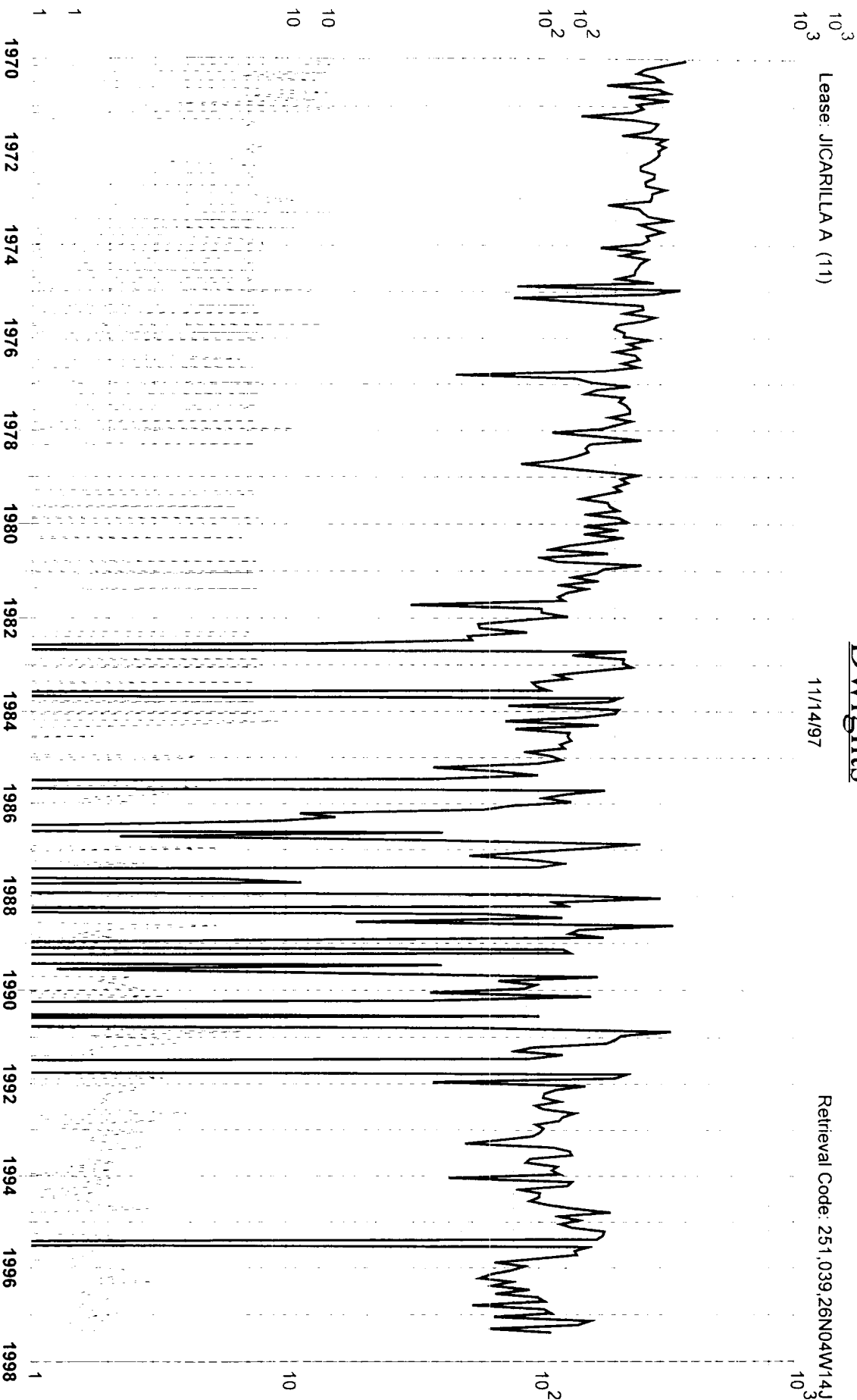

Gas (mcf/day)

County: RIO ARRIBA, NM

F.P. Date: 12/68

Water (bbl/day)

Oil (bbl/day)

Field: BASIN (DAKOTA) DK

Oil Cum: 33.55 mbbl

Reservoir: DAKOTA

Gas Cum: 1652 mmcf

Operator: CONOCO INC

Location: 14J 26N 4W

NEW MEXICO OIL CONSERVATION COMMISSION
WELL LOCATION AND ACREAGE DEDICATION PLAT

Form C-102
Supersedes C-128
Effective 1-1-65

All distances must be from the outer boundaries of the Section.

Operator SOUTHERN UNION PRODUCTION COMPANY		Lease JICANILLA A		Well No. 11
Unit Letter J	Section 14	Township 26 North	Range 4 West	County Rio Arriba
Actual Footage Location of Well: 1550 feet from the South line and 1650 feet from the East line				
Ground Level Elev. 7134	Producing Formation Pictured Cliffs	Pool Basin Dakota	Dedicated Acreage 160	Acres

WILD HORSE GALLUP

- Outline the acreage dedicated to the subject well by colored pencil or hachure marks on the plat below.
- If more than one lease is dedicated to the well, outline each and identify the ownership thereof (both as to working interest and royalty).
- If more than one lease of different ownership is dedicated to the well, have the interests of all owners been consolidated by communitization, unitization, force-pooling, etc?

Yes No If answer is "yes," type of consolidation _____

If answer is "no," list the owners and tract descriptions which have actually been consolidated. (Use reverse side of this form if necessary.) _____

No allowable will be assigned to the well until all interests have been consolidated (by communitization, unitization, forced-pooling, or otherwise) or until a non-standard unit, eliminating such interests, has been approved by the Commission. _____ Dedicated Dakota Acreage _____ Dedicated Pictured Cliffs Acreage

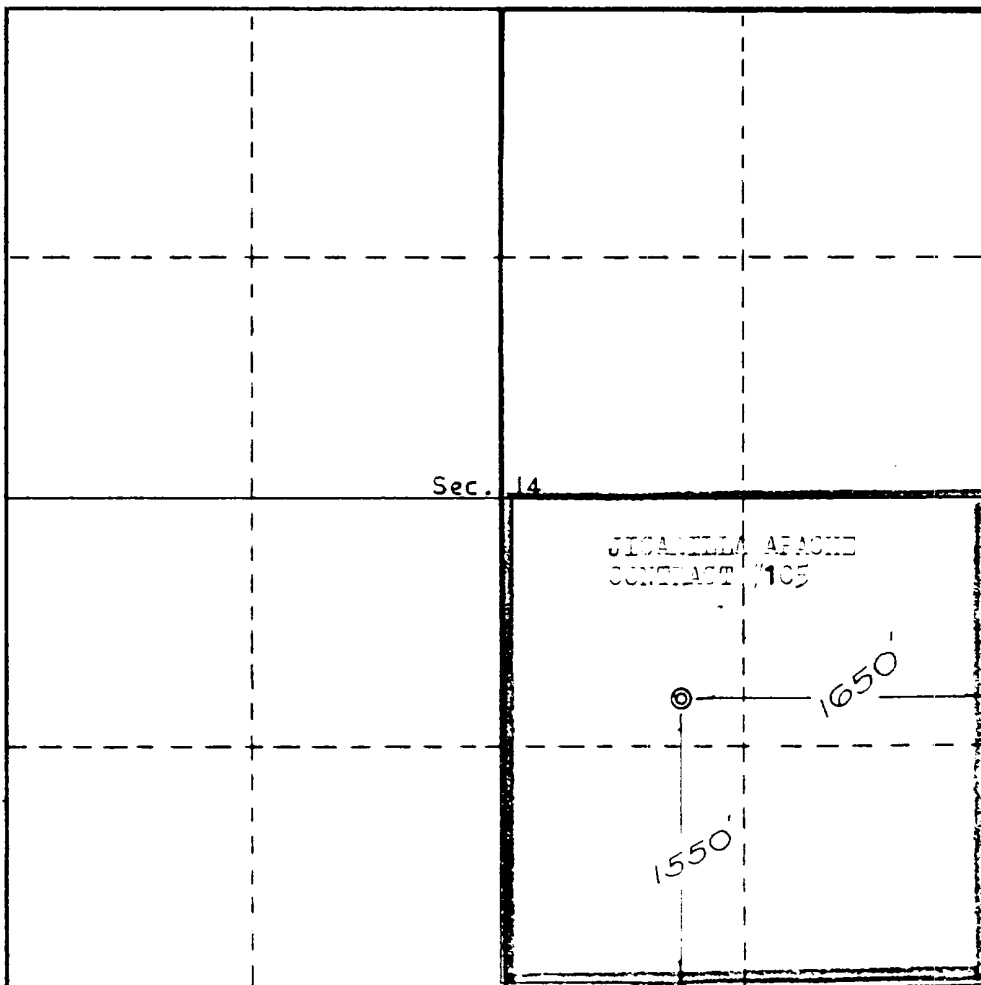

CERTIFICATION

I hereby certify that the information contained herein is true and complete to the best of my knowledge and belief.

B. R. Vanderslice

Name
B. R. Vanderslice

Position
Area Superintendent

Company
Southern Union Production Co.

Date
July 15, 1968

I hereby certify that the well location shown on this plat was plotted from field notes of actual surveys made by me or under my supervision, and that the same are true and correct to the best of my knowledge and belief.

Date Surveyed
March 21, 1955

Registered Professional Engineer and/or Land Surveyor
E. H. Cawker

Certificate No. 3602

**Conoco, Inc.
Jicarilla A #11
Section 14, T-25-N, R-4-W, J
Rio Arriba County, New Mexico**

Re: Application for Downhole Commingling

Offset Operators:

Burlington Resources Oil & Gas
PO Box 4289
Farmington, New Mexico 87499

Amoco Production Co.
PO Box 800
Denver, Co. 80201

Chateau Oil & Gas Inc.
2515 McKinney Ave Ste 840
Dallas, TX 75201