

SOUTHERN UNION PRODUCTION COMPANY

POST OFFICE BOX 808
FARMINGTON, NEW MEXICO 87401

August 15, 1974

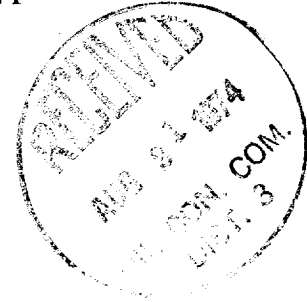

United States Geological Survey
P. O. Box 1809
Durango, Colorado 81301

Dear Sir:

Southern Union Production Company proposes to drill its Jicarilla "D" No. 16 Pictured Cliffs well located 910 feet from the South line and 805 feet from the East line of Section 30, Township 26 North, Range 3 West, N.M.P.M., Rio Arriba County, New Mexico.

Attached are maps showing the following data:

1. Existing roads.
2. Planned access roads.
3. Location of existing wells.
4. Lateral roads to well locations.
5. The location of tank batteries and flow lines are not presently known. After the well has been drilled and the location has been cleaned this equipment will then be installed on the existing location. It is requested that a subsequent map be submitted after determining the exact location.
6. Drilling and completion water will be obtained from our water well located in the SW/4, Section 23, Township 26 North, Range 4 West and from a sump on the Tapacito wash located in the SE/4 of Section 16, Township 26 North, Range 4 West.
7. Waste will be disposed of by being placed in the reserve pit and buried. Some will be burned in burn pit which will be covered after the well has been completed.
8. There will be no camp at or near the proposed well site.
9. There will be no airstrip.
10. A map is attached showing the location of the rig, mud tanks, reserve pit, burn pit, pipe racks, etc. The access road and location will be compacted.
11. After the well is completed the location will be cleaned and bladed. The reserve pit will be fenced until it has dried and then it will be filled and restored to its natural state. The access road will be left as is for well maintenance.
12. The location is near an existing road and is relatively flat. Sage brush is the predominant vegetation.

Yours very truly,

SOUTHERN UNION PRODUCTION COMPANY

ORIGINAL SIGNED BY
B. R. VANDERSLICE

Bill Vanderslice

Area Superintendent

SOUTHERN UNION PRODUCTION COMPANY
 JICARILLA "D" NO. 16
 910/S - 805/E, Sec. 30, T-26N, R-3W
 Rio Arriba County, New Mexico

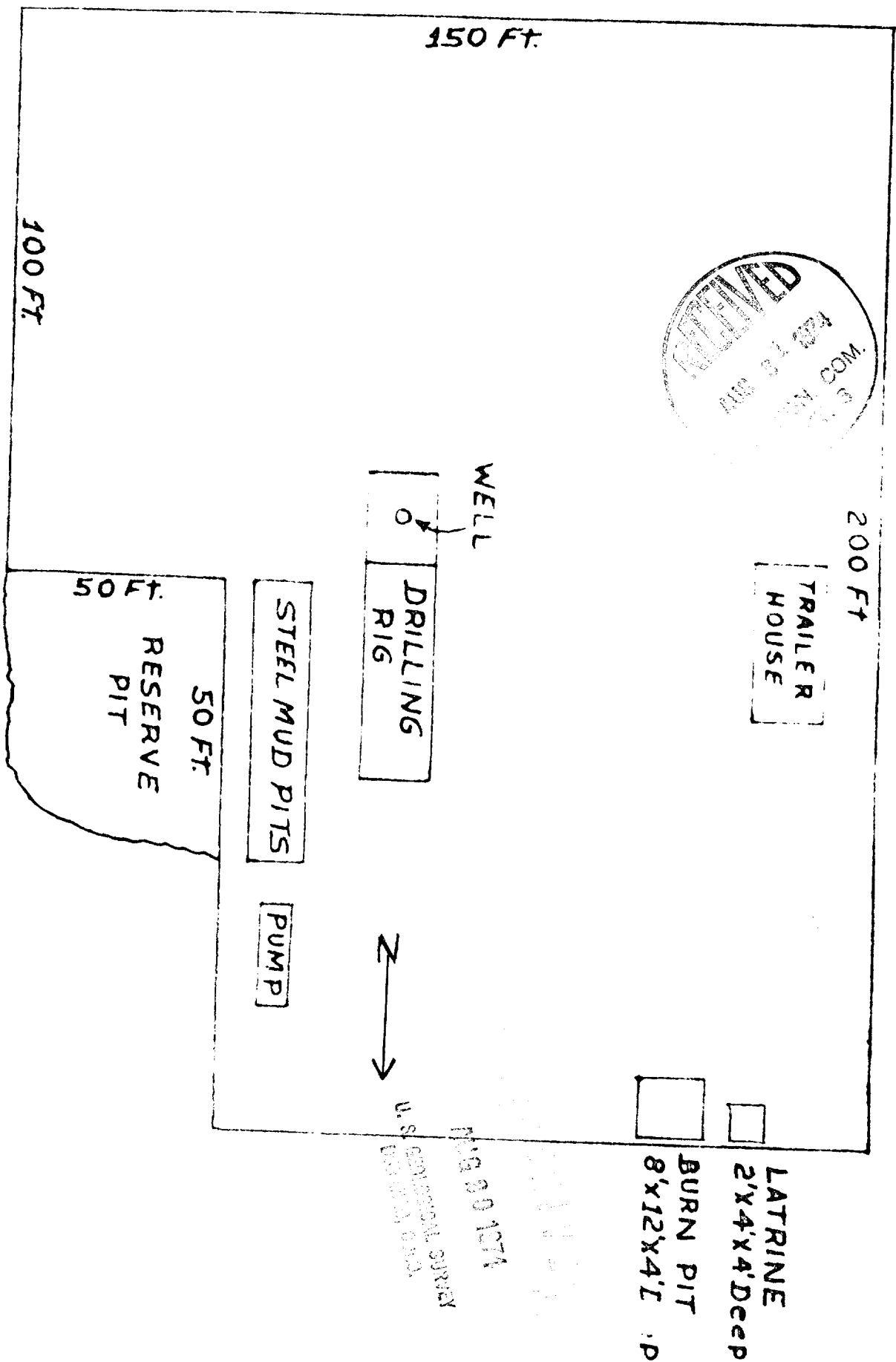

R - 3 - W

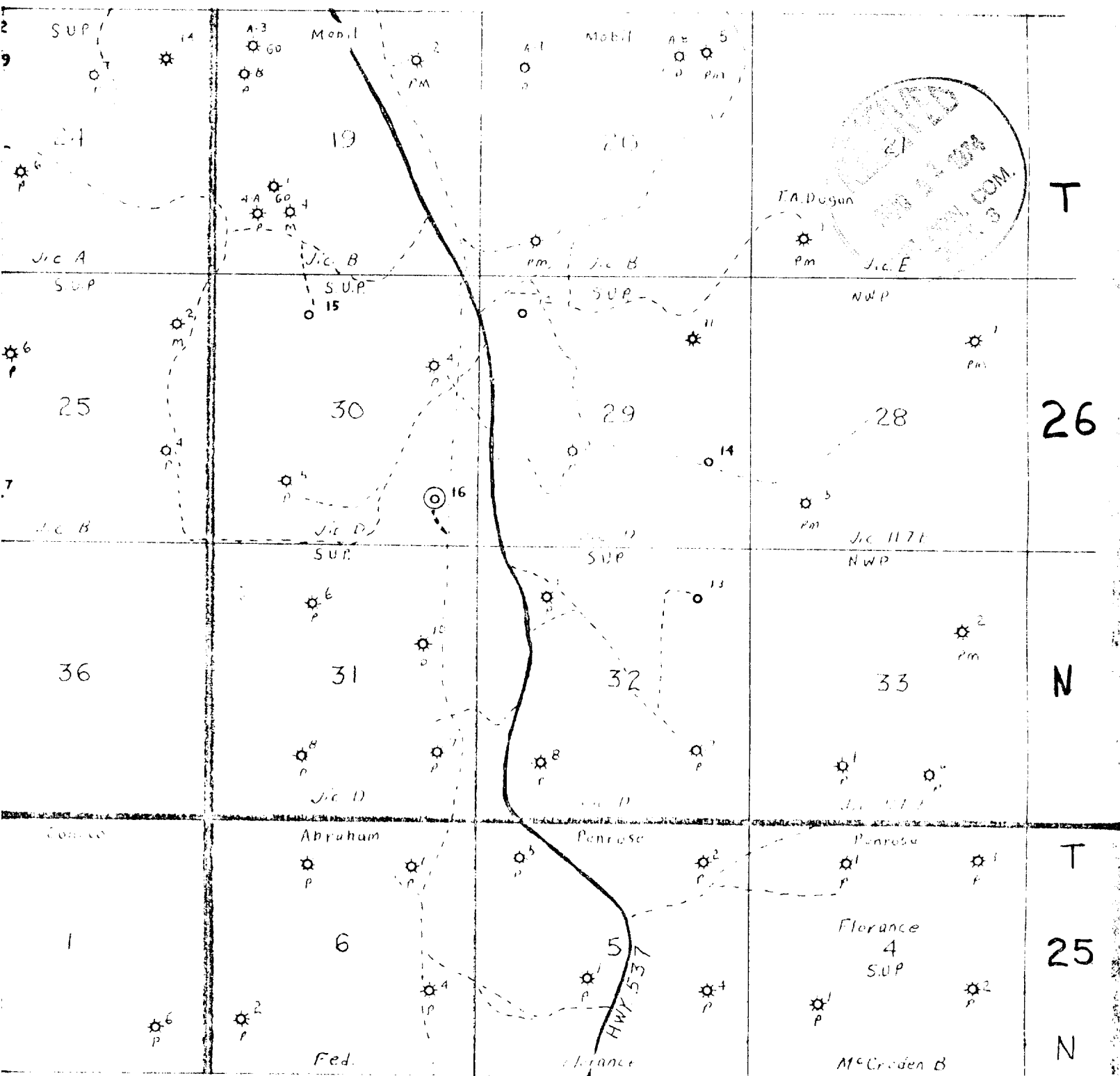

SOUTHERN UNION PRODUCTION COMPANY
 JICARILLA "D" No. 16
 910/S - 805/E, Sec. 30, T-26N, R-3W
 Rio Arriba County, New Mexico

- * Existing Well
- ⊙ Proposed Location
- Existing Road
- - - - Proposed Access Road

RECEIVED
 AUG 20 1974
 U. S. GEOLOGICAL SURVEY
 DENVER, COLO.