

SOUTHERN UNION PRODUCTION COMPANY

POST OFFICE BOX 808
FARMINGTON, NEW MEXICO 87401

August 15, 1974



United States Geological Survey
P. O. Box 1809
Durango, Colorado 81301

Dear Sir:

Southern Union Production Company proposes to drill its Jicarilla "D" No. 15 Pictured Cliffs well located 790 feet from the North line and 1850 feet from the West line of Section 30, Township 26 North, Range 3 West, N.M.P.M., Rio Arriba County, New Mexico.

Attached are maps showing the following data:

AUG 20 1974
U. S. GEOLOGICAL SURVEY
DURANGO, CO.

1. Existing roads.
2. Planned access roads.
3. Location of existing wells.
4. Lateral roads to well locations.
5. The location of tank batteries and flow lines are not presently known. After the well has been drilled and the location has been cleaned this equipment will then be installed on the existing location. It is requested that a subsequent map be submitted after determining the exact location.
6. Drilling and completion water will be obtained from our water well located in the SW/4, Section 23, Township 26 North, Range 4 West and from a sump on the Tapacito wash located in the SE/4 of Section 16, Township 26 North, Range 4 West.
7. Waste will be disposed of by being placed in the reserve pit and buried. Some will be burned in burn pit which will be covered after the well has been completed.
8. There will be no camp at or near the proposed well site.
9. There will be no airstrip.
10. A map is attached showing the location of the rig, mud tanks, reserve pit, burn pit, pipe racks, etc. The access road and location will be compacted.
11. After the well is completed the location will be cleaned and bladed. The reserve pit will be fenced until it has dried and then it will be filled and restored to its natural state. The access road will be left as is for well maintenance.
12. The location is on a low rolling hill. The vegetation is predominately pinon with some sparse range grass.

Yours very truly,

SOUTHERN UNION PRODUCTION COMPANY
ORIGINAL SIGNED BY
B. R. VANDERSLICE

Bill Vanderslice
Area Superintendent

BV:ml

JICARTILLA "D" NO. 15

Rio Arriba County, New Mexico

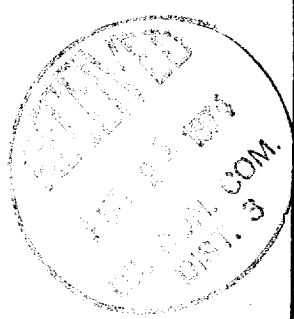

LATRINE
2'x4'x4'Deep

BURN PIT

8'x12'x4' L : P

REC'D 1974
U.S. GOVERNMENT PRINTING OFFICE

1974-02-02

R - 3 - W

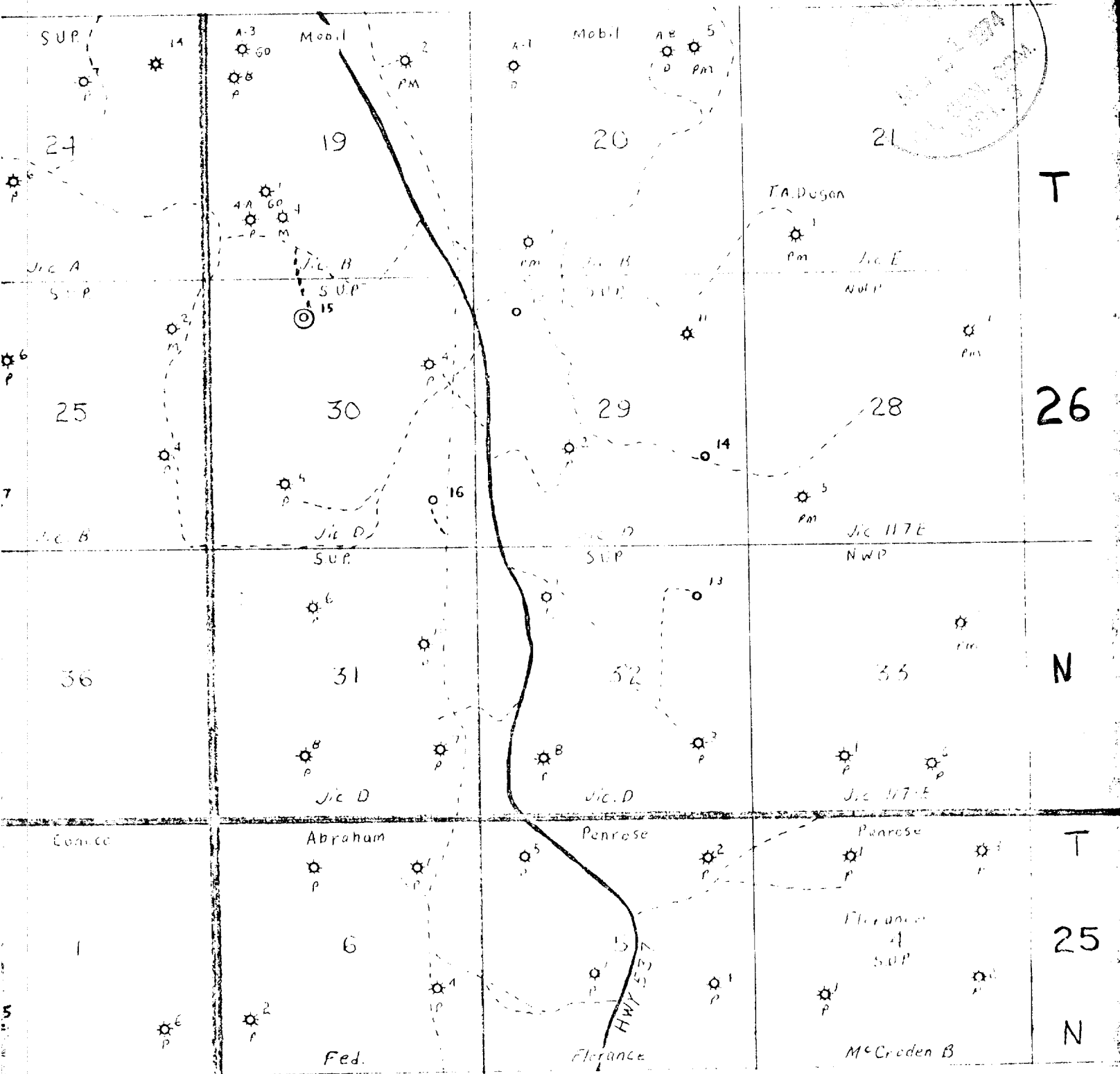

SOUTHERN UNION PRODUCTION COMPANY

JICARILLA "D" No. 15

790/N - 1850/W, Sec. 30, T-26N, R-3W

Rio Arriba County, New Mexico



Existing Well



Proposed Location



Existing Road



Proposed Access Road

AUG 20 1974

U. S. GEOLOGICAL SURVEY
DENVER, COLO.