

*Denny E. Faust*  
DEPUTY OIL & GAS INSPECTOR  
District I  
P.O. Box 156, Hobbs, NM  
District II  
P.O. Drawer DD, Artesia, NM 88224  
District III  
1000 Rio Brazos Rd. Aztec, NM 87410

State of New Mexico  
Energy, Minerals and Natural Resources Department

SUBMIT COPY TO  
APPROPRIATE  
DISTRICT OFFICE  
AND COPY TO  
SANTA FE OFFICE

OIL CONSERVATION DIVISION

2040 South Pacheco Street  
Santa Fe, New Mexico 87505

**PIT REMEDIATION AND CLOSURE REPORT**

Operator: PNM Gas Services (Caulkins) Telephone: 324-3764  
Address: 603 W. Elm Street Farmington, NM 87401  
Facility or Well Name: State A #116  
Location: Unit P Sec 2 T 26 N R 6 W County Rio Arriba  
Pit Type: Separator ☒ Dehydrator ☐ Other None  
Land Type: BLM ☒ State ☐ Fee ☐ Other ☐

Pit Location: Pit dimensions: length 18 width 18 depth 2  
(Attach diagram) Reference: wellhead ☒ other ☐  
Footage from reference: 60'  
Direction from reference: 5 Degrees ☐ East ☐ North ☐  
of ☒ West ☒ South

Depth to Ground Water: Less than 50 feet (20 points)  
50 feet to 99 feet (10 points)  
Greater than 100 feet (0 points) 0

(Vertical distance from contaminants to seasonal high water elevation of ground water)

Wellhead Protection Area: **RECEIVED** Yes (20 points)  
No (0 points) 0

(Less than 200 feet from a private domestic water source, or, less than 1,000 feet from all other water sources)

Distance to Surface Water: Less than 200 feet (20 points)  
200 feet to 1,000 feet (10 points)  
Greater than 1,000 feet (0 points) 10

RANKING SCORE (TOTAL POINTS): 10

State A #116

Date Remediation Started: 9/23/97

Date Completed: 9/23/97

## Remediation Method:

Excavation ☒

Approx. Cubic Yard 280

(Check all appropriate sections)

Landfarmed ☒

Amount Landfarmed (cubic yds) 280

Other \_\_\_\_\_

## Remediation Location:

Onsite ☒

Offsite \_\_\_\_\_

(i.e., landfarmed onsite, name and location of offsite facility)

## Backfill Material Location: \_\_\_\_\_

## General Description of Remedial Action:

Excavated contaminated soil to a pit size of 21' X 20' X 18' and landfarmed soil onsite within a bermed area at a depth of 6" to 12". Soil was aerated by disking/plowing until soil met regulatory levels.

## Ground Water Encountered:

No ☒

Yes \_\_\_\_\_

Depth \_\_\_\_\_

## Final Pit Closure Sampling:

Sample Location

Bottom of excavation.

(if multiple samples, attach sample result and diagram of sample locations and depths)

Sample depth

18'

Sample date

9/23/97

Sample time

2:00:00 PM

## Sample Results

Benzene (ppm) &lt; 0.5000

Total BTEX (ppm) 34.2110

Field headspace (ppm) \_\_\_\_\_

TPH (ppm)

499.00

Method

8015A

Vertical Extent (ft) \_\_\_\_\_

Risk Assessment form attached

Yes ☐No ☐

## Ground Water Sample:

Yes ☐No ☒

(If yes, see attached Groundwater Site Summary Report)

I HEREBY CERTIFY THAT THE INFORMATION ABOVE IS TRUE AND COMPLETE TO THE BEST OF MY KNOWLEDGE AND MY BELIEF

DATE January 27, 1998

SIGNATURE

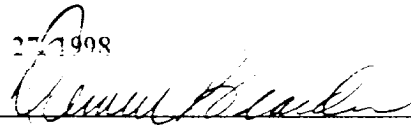

PRINTED NAME AND TITLE

Denver Bearden  
Administrator III

State A # 116

9/23/97

Caulking: C-1

Sec. 2, 26N, 6W, P

start of excavation :

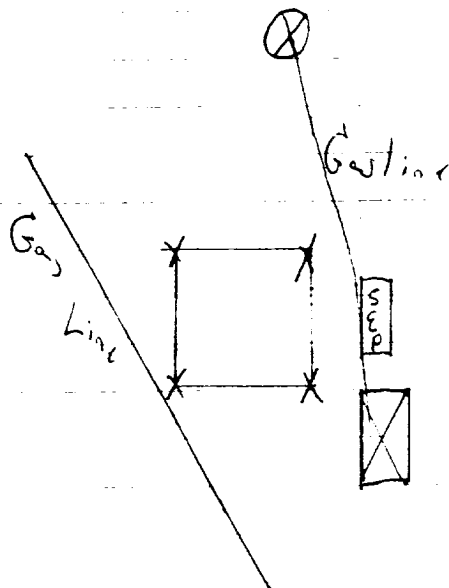

End of excavation :

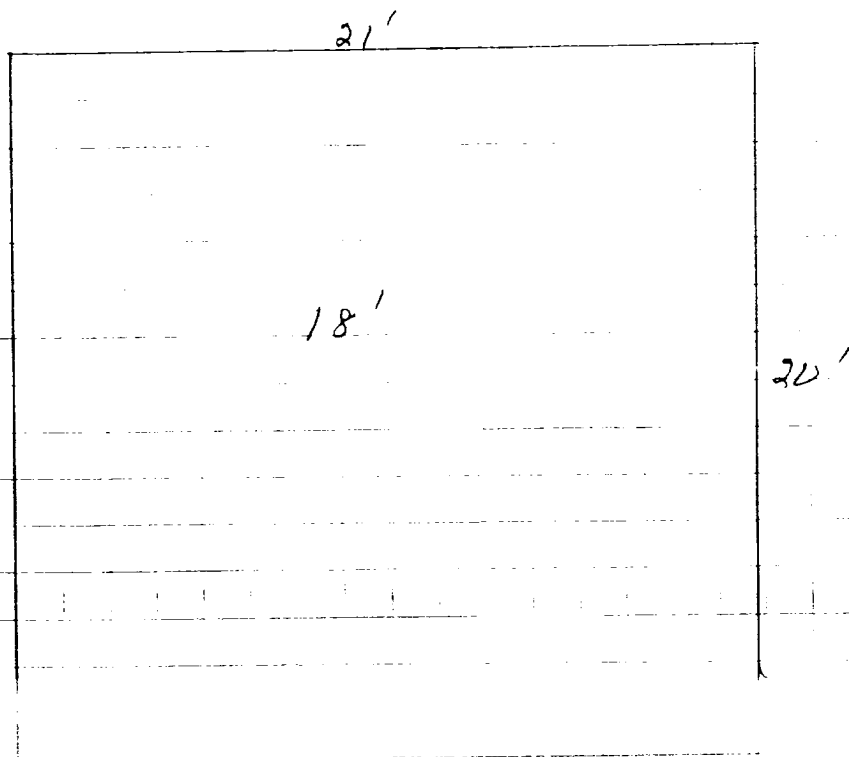

OFF: (505) 325-5667



LAB: (505) 325-1556

### ANALYTICAL REPORT

Attn: *Denver Bearden*  
Company: *PNM Gas Services*  
Address: *603 W. Elm*  
City, State: *Farmington, NM 87401*

Date: *30-Sep-97*  
COC No.: *5805*  
Sample No.: *16285*  
Job No.: *2-1000*

Project Name: *PNM Gas Services - State A #116*

Project Location: *9709231400; Bottom @ 18'*

Sampled by: *GC* Date: *23-Sep-97* Time: *14:00*

Analyzed by: *HR/DC* Date: *30-Sep-97*

Sample Matrix: *Soil*

#### Laboratory Analysis

Parameter	Results as Received	Unit of Measure	Limit of Quantitation	Unit of Measure
<i>Diesel Range Organics (C10 - C28)</i>	<i>499</i>	<i>mg/kg</i>	<i>5</i>	<i>mg/kg</i>

ND - Not Detected at Limit of Quantitation

#### Quality Assurance Report

DRO QC No.: 0555-STD

#### Continuing Calibration Verification

Parameter	Method Blank	Unit of Measure	True Value	Analyzed Value	RPD	RPD Limit
<i>Diesel Range (C10 - C28)</i>	<i>ND</i>	<i>ppm</i>	<i>200</i>	<i>205</i>	<i>2.4</i>	<i>15%</i>

#### Matrix Spike

Parameter	1- Percent Recovered	2 - Percent Recovered	Limit	RPD	RPD Limit
<i>Diesel Range (C10-C28)</i>	<i>86</i>	<i>82</i>	<i>(70-130)</i>	<i>5</i>	<i>20%</i>

Method: *ASTM D1525-97*

Approved by: *[Signature]*

Date: *9/30/97*

P.O. BOX 2606 • FARMINGTON, NM 87499

OFF: (505) 325-5667



LAB: (505) 325-1556

### ANALYTICAL REPORT

Attn: *Denver Bearden*  
Company: *PNM Gas Services*  
Address: *603 W. Elm*  
City, State: *Farmington, NM 87401*

Date: *30-Sep-97*  
COC No.: *5805*  
Sample No.: *16285*  
Job No.: *2-1000*

Project Name: *PNM Gas Services - State A #116*  
Project Location: *9709231400; Bottom @ 18'*  
Sampled by: *GC* Date: *23-Sep-97* Time: *14:00*  
Analyzed by: *DC* Date: *28-Sep-97*  
Sample Matrix: *Soil*

#### Laboratory Analysis

Parameter	Results as Received	Unit of Measure	Limit of Quantitation	Unit of Measure
<i>Benzene</i>	ND	ug/kg	500	ug/kg
<i>Toluene</i>	2619	ug/kg	500	ug/kg
<i>Ethylbenzene</i>	2395	ug/kg	500	ug/kg
<i>m,p-Xylene</i>	23495	ug/kg	500	ug/kg
<i>o-Xylene</i>	5702	ug/kg	500	ug/kg
	<i>TOTAL</i>	34211	ug/kg	

ND - Not Detected at Limit of Quantitation

**Method** - SW-846 EPA Method 8020A Aromatic Volatile Organics by Gas Chromatography

OFF: (505) 325-5667



LAB: (505) 325-1556

### ANALYTICAL REPORT

Attn: *Denver Bearden*  
Company: *PNM Gas Services*  
Address: *603 W. Elm*  
City, State: *Farmington, NM 87401*

Date: *30-Sep-97*  
COC No.: *5805*  
Sample No.: *16286*  
Job No.: *2-1000*

Project Name: *PNM Gas Services - State A #116*

Project Location: *9709231410; Walls @ 15'*

Sampled by: *GC* Date: *23-Sep-97* Time: *14:10*

Analyzed by: *HR/DC* Date: *30-Sep-97*

Sample Matrix: *Soil*

#### Laboratory Analysis

Parameter	Results as Received	Unit of Measure	Limit of Quantitation	Unit of Measure
<i>Diesel Range Organics (C10 - C28)</i>	<i>37</i>	<i>mg kg</i>	<i>5</i>	<i>mg kg</i>

ND - Not Detected at Limit of Quantitation

#### Quality Assurance Report

DRO QC No.: 0555-STD

#### Continuing Calibration Verification

Parameter	Method Blank	Unit of Measure	True Value	Analyzed Value	RPD	RPD Limit
<i>Diesel Range (C10 - C28)</i>	<i>ND</i>	<i>ppm</i>	<i>200</i>	<i>205</i>	<i>2.4</i>	<i>15%</i>

#### Matrix Spike

Parameter	1 - Percent Recovered	2 - Percent Recovered	Limit	RPD	RPD Limit
<i>Diesel Range (C10-C28)</i>	<i>86</i>	<i>82</i>	<i>(70-130)</i>	<i>5</i>	<i>20%</i>

Method -

Approved by:

Date:

*9/30/97*

P.O. BOX 2606 • FARMINGTON, NM 87499

**P.O. BOX 2606 • FARMINGTON, NM 87499**

↑  
N

10-6-97 @ 1125

State A #116

Caulkins

(P) 2-26N-6W

Rio Arriba

Sample # 9710061125

Landfarm field head space: 0 ppm

2'-12"

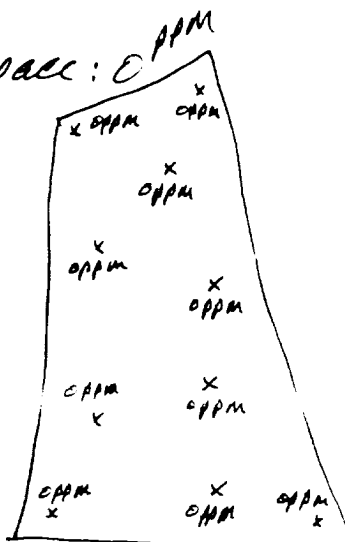

WN



SCA

MH

OFF: (505) 325-5667



LAB: (505) 325-1556

### ANALYTICAL REPORT

Attn: *Denver Bearden*  
Company: *PNM Gas Services*  
Address: *603 W. Elm*  
City, State: *Farmington, NM 87401*

Date: *8-Oct-97*  
COC No.: *5663*  
Sample No.: *16519*  
Job No.: *2-1000*

Project Name: *PNM Gas Services - State A #116 Landfarm*  
Project Location: *9710061125; Composite*  
Sampled by: *RH* Date: *6-Oct-97* Time: *11:25*  
Analyzed by: *DC/HR* Date: *7-Oct-97*  
Sample Matrix: *Soil*

#### Laboratory Analysis

Parameter	Results as Received	Unit of Measure	Limit of Quantitation	Unit of Measure
<i>Diesel Range Organics (C10 - C28)</i>	<i>35</i>	<i>mg kg</i>	<i>5</i>	<i>mg kg</i>

ND - Not Detected at Limit of Quantitation

#### Quality Assurance Report

DRO QC No.: 0555-STD

#### Continuing Calibration Verification

Parameter	Method Blank	Unit of Measure	True Value	Analyzed Value	RPD	RPD Limit
<i>Diesel Range (C10 - C28)</i>	<i>ND</i>	<i>ppm</i>	<i>200</i>	<i>214</i>	<i>6.7</i>	<i>15%</i>

#### Matrix Spike

Parameter	1- Percent Recovered	2 - Percent Recovered	Limit	RPD	RPD Limit
<i>Diesel Range (C10-C28)</i>	<i>94</i>	<i>86</i>	<i>(70-130)</i>	<i>9</i>	<i>20%</i>

Approved by: *[Signature]*  
Date: *10/8/97*

P.O. BOX 2606 • FARMINGTON, NM 87499